



HOWARD COUNTY HEALTH DEPARTMENT

72853

DATE 11/21/20

Received From

Chesapeake Geo.

PHONE #

615 910-895020

For

Well Permit 4090
Old Columbia

CASH

CHECK

NO. 41003

One hundred sixty Dollars

\$ 160 00

Received By

King

C1 63877

SEQUENCE NO. (MDE USE ONLY)

STATE OF MARYLAND WELL COMPLETION REPORT

THIS REPORT MUST BE SUBMITTED WITHIN 45 DAYS AFTER WELL IS COMPLETED.

COUNTY NUMBER

(THIS NUMBER IS TO BE PUNCHED IN COLS. 3-6 ON ALL CARDS)

ST/CO USE ONLY DATE RECEIVED

DATE WELL COMPLETED

Depth of Well

PERMIT NO. FROM "PERMIT TO DRILL WELL"

OWNER, WELL SITE ADDRESS, SUBDIVISION, SECTION, LOT

WELL LOG table with columns: DESCRIPTION, FEET (FROM, TO), check if water bearing. Includes entries for Top Soil, Silt/clay, Broken Weathered Rock, Rock Hard Blue.

GROUTING RECORD: WELL HAS BEEN GROUTED (Y), TYPE OF GROUTING MATERIAL (CEMENT CM, BENTONITE CLAY BC), NO. OF BAGS, NO. OF POUNDS, GALLONS OF WATER, DEPTH OF GROUT SEAL.

CASING RECORD: casing types insert appropriate code below (ST STEEL, CO CONCRETE, PL PLASTIC, OT OTHER), MAIN CASING TYPE, Nominal diameter, Total depth.

OTHER CASING (if used) diameter, depth (feet) from to

SCREEN RECORD: screen type or open hole (ST STEEL, BR BRASS, HO OPEN HOLE, PL PLASTIC, OT OTHER), insert appropriate code below.

NUMBER OF UNSUCCESSFUL WELLS: 0, WELL HYDROFRACTURED (Y)

CIRCLE APPROPRIATE LETTER: A WELL WAS ABANDONED AND SEALED, E ELECTRIC LOG OBTAINED, P TEST WELL CONVERTED TO PRODUCTION WELL.

I HEREBY CERTIFY THAT THIS WELL HAS BEEN CONSTRUCTED IN ACCORDANCE WITH COMAR 26.04.04 "WELL CONSTRUCTION" AND IN CONFORMANCE WITH ALL CONDITIONS STATED IN THE ABOVE CAPTIONED PERMIT...

DRILLERS LIC. NO. 1 M W D 598, DRILLERS SIGNATURE, LIC. NO. 1 D

SITE SUPERVISOR (sign. of driller or journeyman responsible for sitework if different from permittee)

DEPTH (nearest ft.) table with columns 1-21, 23-36, 38-51, SLOT SIZE 1-3, DIAMETER OF SCREEN (NEAREST INCH)

GRAVEL PACK IF WELL DRILLED WAS FLOWING WELL INSERT F IN BOX 68

MDE USE ONLY (NOT TO BE FILLED IN BY DRILLER) T (E.R.O.S.) W Q, TELESCOPE CASING, LOG INDICATOR, OTHER DATA

PUMPING TEST: HOURS PUMPED, PUMPING RATE, METHOD USED TO MEASURE PUMPING RATE, WATER LEVEL, BEFORE PUMPING, WHEN PUMPING, TYPE OF PUMP USED (for test)

PUMP INSTALLED: DRILLER INSTALLED PUMP (YES/NO), IF DRILLER INSTALLS PUMP, THIS SECTION MUST BE COMPLETED FOR ALL WELLS, TYPE OF PUMP INSTALLED, PLACE (A,C,J,P,R,S,T,O) IN BOX 29, CAPACITY: GALLONS PER MINUTE, PUMP HORSE POWER, PUMP COLUMN LENGTH, CASING HEIGHT

LATITUDE 39.259291, LONGITUDE 76.818595 (DEFAULT COORD. WGS 84)

Pursuant to §10-624 of the State Govt. Article of the Maryland Code personal info. requested on this form is used in processing this form pursuant to COMAR 26.04.04. Failure to provide the info. may result in this form not being processed.

4090 Old Columbia Pi.
Ellicott City Md 2140
Closed Loop GEO

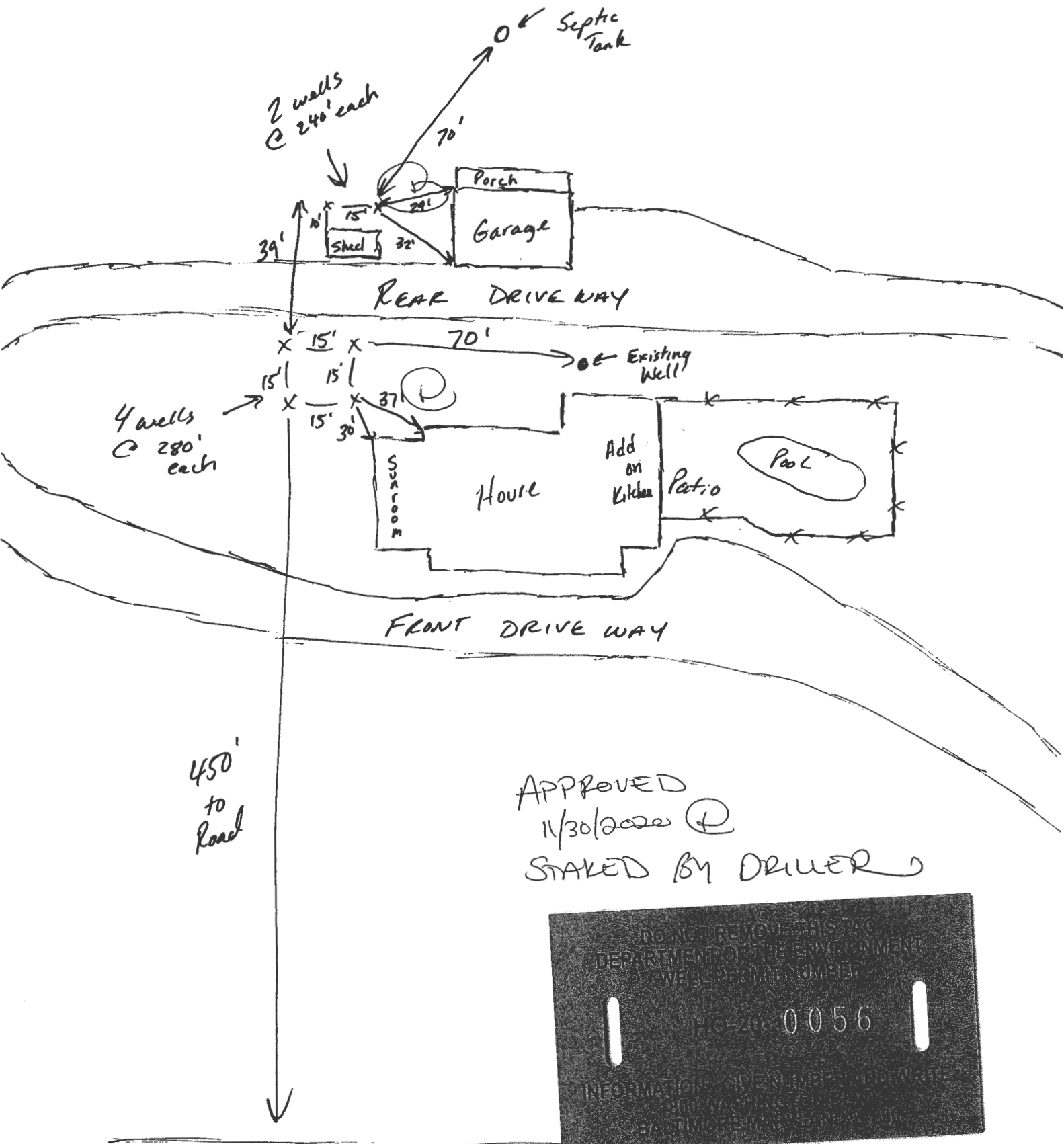

APPROVED
11/30/2000 ⊕
STAKED BY DRIVER



Old Columbia Piko

WELL SCHEMATIC FORM

POOL

GROUND SURFACE

PERMANENT OUTER CASING (if area contaminated)

MATERIAL _____

DIAMETER _____

LENGTH _____

DEPTH INTO CONFINING UNIT _____

PERMANENT OUTER CASING

TUBE CASING (if not regular, single loop)

ATTACH HORIZONTAL SCHEMATIC

NUMBER OF TUBES PER BOREHOLE _____

DIAMETER OF TUBES _____

MATERIAL _____

SHAPE AND LENGTH _____

TUBE CONNECTION METHOD _____

TUBE CONNECTION MATERIAL _____

CONFINING UNIT

LOOP PIPE CASING (regular, single loop)

MATERIAL HDPE? YES NO

DIAMETER 1.25"

LENGTH 240

GROUT

MATERIAL Bentonite

PERMEABILITY 2.5×10^{-8} cm/sec

WATER / GROUT RATIO 24 / 50

PERCENT SOLIDS 20%

TREMIE GROUTED FROM BOTTOM OF BOREHOLE? YES NO

USING A POSITIVE DISPLACEMENT PUMP? YES NO

DEPTH TO THE BOTTOM OF HOLE 240'

DIAMETER OF BOREHOLE 6"

WELL ADDRESS
4090 Old Columbia Pike
Ellicott City Md 21403

LOT NUMBER: 1

SQUARE NUMBER: _____

WELL OWNER:
Paul Regnault

OWNER ADDRESS:
4090 Old
Columbia Pike

WELL SCHEMATIC FORM

MAIN HOUSE

PERMANENT OUTER CASING (if area contaminated)

MATERIAL _____
 DIAMETER _____
 LENGTH _____
 DEPTH INTO CONFINING UNIT _____

TUBE CASING (if not regular, single loop)

ATTACH HORIZONTAL SCHEMATIC _____
 NUMBER OF TUBES PER BOREHOLE _____
 DIAMETER OF TUBES _____
 MATERIAL _____
 SHAPE AND LENGTH _____
 TUBE CONNECTION METHOD _____
 TUBE CONNECTION MATERIAL _____

LOOP PIPE CASING (regular, single loop)

MATERIAL HDPE? YES NO
 DIAMETER 1.25"
 LENGTH 280

GROUT

MATERIAL Bentonite
 PERMEABILITY 2.5×10^{-8} cm/sec
 WATER / GROUT RATIO 24 / 50
 PERCENT SOLIDS 20%

TREMIE GROUTED FROM BOTTOM OF BOREHOLE? YES NO
 USING A POSITIVE DISPLACEMENT PUMP? YES NO

DEPTH TO THE BOTTOM OF HOLE 280'
 DIAMETER OF BOREHOLE 6"

WELL ADDRESS
4090 Old Columbia Pike
Ellicott City Md 21403

LOT NUMBER: 1

SQUARE NUMBER: _____

WELL OWNER:
Paul Regnault

OWNER ADDRESS:
4090 Old
Columbia Pike

Real Property Data Search

Search Result for HOWARD COUNTY

[View Map](#) [View GroundRent Redemption](#) [View GroundRent Registration](#)

Special Tax Recapture: None

Account Identifier: District - 02 Account Number - 255278

Owner Information

Owner Name: RUYGROK ALEXANDER Use: RESIDENTIAL
 RUYGROK TERRY E T/E Principal Residence: YES
 Mailing Address: 4090 OLD COLUMBIA PIKE Deed Reference: /06164/ 00298
 ELLICOTT CITY MD 21043-5413

Location & Structure Information

Premises Address: 4090 OLD COLUMBIA PIKE Legal Description: LOT 1 10.239 A.
 ELLICOTT CITY 21043-0000 4090 OLD COLUMBIA PIKE
 JOSEPH H CLARK

Map: Grid: Parcel: Neighborhood: Subdivision: Section: Block: Lot: Assessment Year: Plat No:
 0024 0018 1092 2010101.14 1001 1 2021 Plat Ref:

Town: None

Primary Structure Built Above Grade Living Area Finished Basement Area Property Land Area County Use
 1913 3,480 SF 10.2300 AC

Stories	Basement	Type	Exterior	Quality	Full/Half Bath	Garage	Last Notice of Major Improvements
2 1/2	YES	STANDARD UNIT	WOOD SHINGLE/	5	3 full/ 1 half	1 Detached	

Value Information

	Base Value	Value	Phase-in Assessments	
		As of	As of	As of
		01/01/2018	07/01/2020	07/01/2021
Land:	210,500	210,500		
Improvements	564,300	564,300		
Total:	774,800	774,800	774,800	
Preferential Land:	0			

Transfer Information

Seller: BRUSH EDWARD J	Date: 05/09/2002	Price: \$487,500
Type: NON-ARMS LENGTH OTHER	Deed1: /06164/ 00298	Deed2:
Seller: CHESTNUTT WARREN L	Date: 06/28/1985	Price: \$340,000
Type: ARMS LENGTH IMPROVED	Deed1: /01364/ 00532	Deed2:
Seller: GELBER RENE L & WF	Date: 01/13/1984	Price: \$325,000
Type: ARMS LENGTH IMPROVED	Deed1: /01222/ 00397	Deed2:

Exemption Information

Partial Exempt Assessments:	Class	07/01/2020	07/01/2021
County:	000	0.00	
State:	000	0.00	
Municipal:	000	0.00	0.00

Special Tax Recapture: None

Homestead Application Information

Homestead Application Status: Approved 04/04/2011

Homeowners' Tax Credit Application Information

Homeowners' Tax Credit Application Status: No Application Date: