



# HOWARD COUNTY HEALTH DEPARTMENT

27810

DATE  
9/20/07

ps

Received From

Tree Center Inc PHONE #

2700 Woodburn Rd.

For

~~Fee~~ Septic Permit

CASH  
 CHECK

NO. 18932

Three hundred & sixty six

Dollars

\$ 396.00

Received By

RR

LAYOUT J 9/24/07 INSP 4 \_\_\_\_\_  
INSP 2 \_\_\_\_\_ INSP 5 \_\_\_\_\_  
INSP 3 \_\_\_\_\_ INSP 6 \_\_\_\_\_

ISSUE DATE: 8/13/2007

# PERMIT

P 527810

APPROVAL DATE: 7/20/07

A 58970

TAX ID # 04-361385

## ON-SITE SEWAGE DISPOSAL SYSTEM HOWARD COUNTY HEALTH DEPARTMENT BUREAU OF ENVIRONMENTAL HEALTH

Sunnyside Properties IS PERMITTED TO INSTALL  ALTER   
ADDRESS: 16005 Frederick Rd PHONE NUMBER: (410) 442-1041

SUBDIVISION: A.G. Warfield Property LOT NUMBER: \_\_\_\_\_

ADDRESS: 2700 Woodbine Rd PROPERTY OWNER: Sunny Side Property

SEPTIC TANK CAPACITY (GALLONS): 1000 OUTLET BAFFLE FILTER REQUIRED

PUMP CHAMBER CAPACITY (GALLONS): \_\_\_\_\_ COMPARTMENTED TANK REQUIRED

NUMBER OF BEDROOMS: 3

SQUARE FEET PER BEDROOM: \_\_\_\_\_

LINEAR FEET OF TRENCH REQUIRED: 104

TRENCHES:	Trench to be 3.0 feet wide. Inlet 3.0 feet below original grade. Bottom maximum depth 5.0 feet below original grade. Effective area begins at 4.0 feet below original grade. 2.0 feet of stone below distribution pipe.
LOCATION:	Install (2) 50'+ lengths of trench on contour in the highest possible portion of the septic easement. Install as directed by HCHD at the pre-construction layout inspection.
NOTES:	Septic area must be staked.

PLANS APPROVED: Gabriel Creighton DATE: 8/13/2007

- NOTE: PERMIT VOID AFTER 2 YEARS
- NOTE: CONTRACTOR RESPONSIBLE FOR SCHEDULING A PRE-CONSTRUCTION INSPECTION FOR ALL INSTALLATIONS
- NOTE: WATERTIGHT SEPTIC TANKS REQUIRED
- NOTE: ALL PARTS OF SEPTIC SYSTEM SHALL BE 100 FEET FROM ANY WATER WELL
- NOTE: MANHOLE RISERS REQUIRED ON ALL SEPTIC TANKS AND PUMP CHAMBERS UNLESS SPECIFICALLY AUTHORIZED

**NEITHER THE HOWARD COUNTY COUNCIL NOR THE HEALTH DEPARTMENT IS RESPONSIBLE FOR THE SUCCESSFUL OPERATION OF ANY SYSTEM PERMITTEE RESPONSIBLE FOR OBTAINING FINAL APPROVAL ON THIS PERMIT CALL 410-313-1771 FOR INSPECTION OF SEPTIC SYSTEM**

NOT TO SCALE

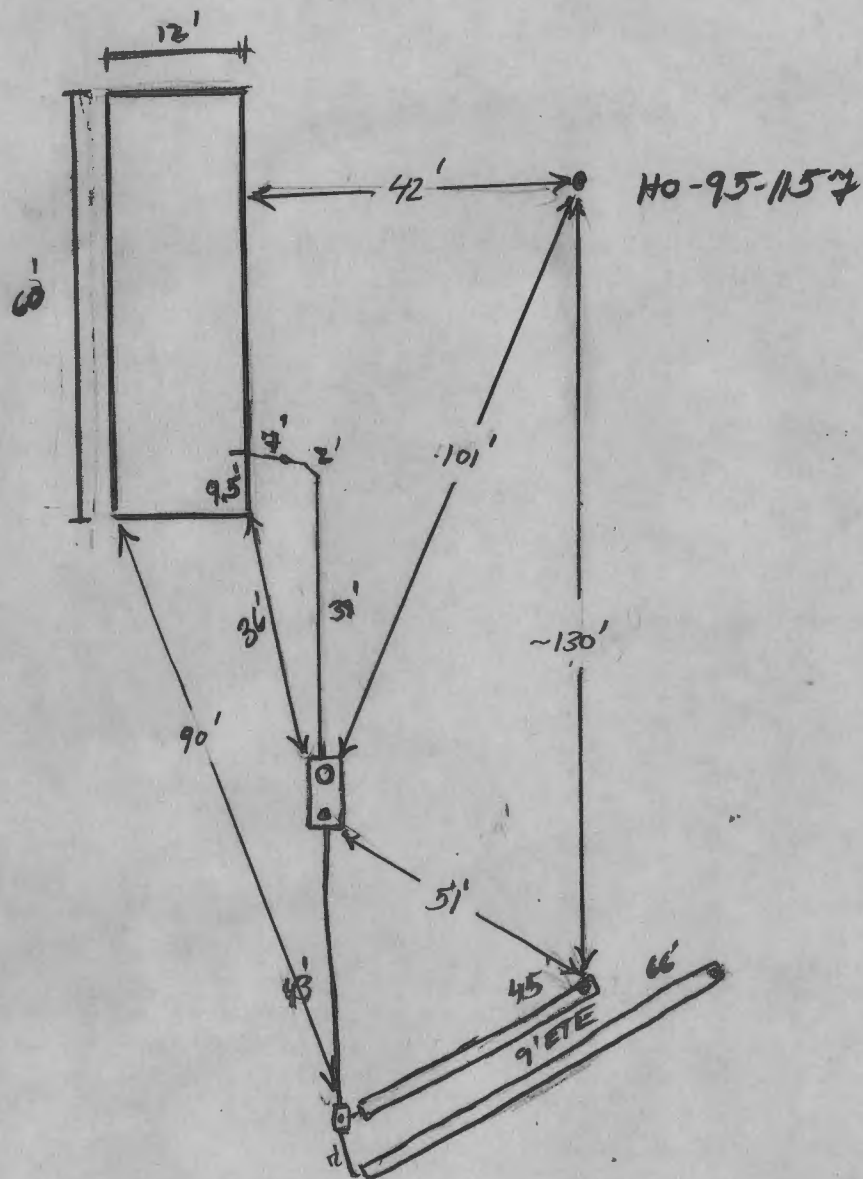

**TRENCH/DRAINFIELD DATA**

WIDTH	INLET	BOTTOM
3	3'	5-5.5
NUMBER OF TRENCHES		2
TOTAL LENGTH _____		
ABSORPTION AREA _____		
DISTRIBUTION BOX LEVEL		Lowlers
DISTRIBUTION BOX BAFFLE		Yes
DISTRIBUTION BOX PORT		Yes

**SEPTIC TANK DATA**

SEPTIC TANK 1 LEVEL	Yes
CAPACITY	1500 GAL
SEAM LOC	Top
TANK LID DEPTH	1.5'-2'
BAFFLES	Yes
BAFFLE FILTER	—
MANHOLE LOC	Front
6" PORT LOC	Reel
WATERTIGHT TEST	—
Babylon slotted 2comp	
SEPTIC TANK 2 LEVEL	N/A
CAPACITY	_____ GAL
SEAM LOC	_____
TANK LID DEPTH	_____
BAFFLES	_____
BAFFLE FILTER	_____
MANHOLE LOC	_____
6" PORT LOC	_____
WATERTIGHT TEST	_____

**PRE-CONSTRUCTION**

9/24/07 Keep tanks  
100' from well.  
Install a 45'  
and a 60' trench  
on constant.

9/28/07 system complete OK to backfill (RW)

**INSTALLATION:**

FINAL INSPECTOR

*J. Wolf*

DATE OF APPROVAL

9/28/07

SEWER INV. @ HOUSE 693.00  
 GRADE @ TANK 692.00  
 INVERT IN @ TANK 690.00  
 INVERT OUT @ TANK 689.75  
 GRADE @ DIST BOX 690.00  
 INVERT @ DIST BOX 687.00  
 3BR in Prop. Mobile Home

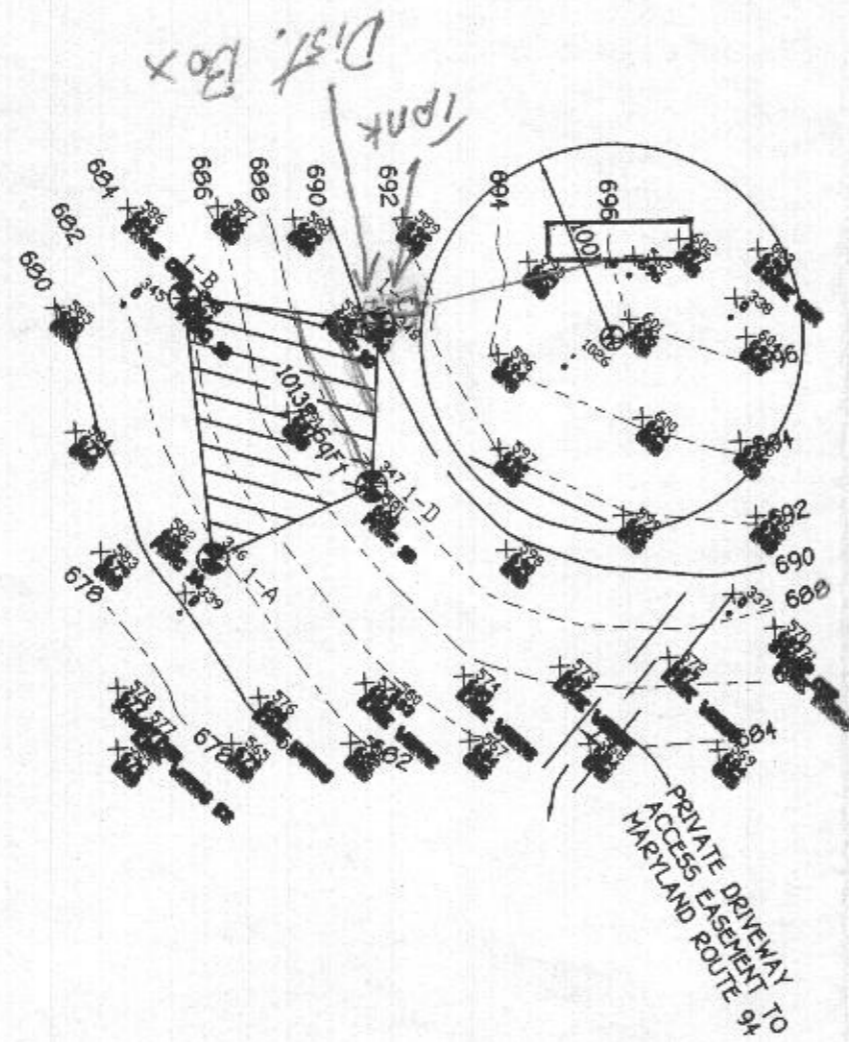

Approved Septic System Plan  
 Howard County Health Department  
 Signature: *[Signature]* Date: 8/13/2007

