

B 1 <div style="font-size: 24pt; font-weight: bold;">83401</div>	SEQUENCE NO. (MDE USE ONLY)	STATE OF MARYLAND APPLICATION FOR PERMIT TO DRILL WELL please type	STATE PERMIT NUMBER <div style="font-size: 24pt; font-weight: bold;">40-20-0146</div> <div style="font-size: 8pt;">fill in this form completely</div>
Date Received (APA) <div style="font-size: 8pt;">8 MM DD YY 13</div> <div style="font-size: 24pt; font-weight: bold;">Braglio Scott</div> <div style="font-size: 24pt; font-weight: bold;">1415 Woodstock Rd</div> <div style="font-size: 24pt; font-weight: bold;">Woodstock Md 21163</div>		B 3 LOCATION OF WELL <div style="font-size: 24pt; font-weight: bold;">Howard</div> <div style="font-size: 8pt;">8 COUNTY 21</div> <div style="font-size: 8pt;">23 SUBDIVISION 42</div> <div style="font-size: 8pt;">SECTION 44 46 LOT 48 50</div> <div style="font-size: 24pt; font-weight: bold;">Woodstock</div> <div style="font-size: 8pt;">52 NEAREST TOWN 71</div>	
OWNER INFORMATION <div style="font-size: 8pt;">15 Last Name 34</div> <div style="font-size: 8pt;">36 Street or RFD 55</div> <div style="font-size: 8pt;">57 Town 70 State 72 Zip 76</div>		B 4 SOURCES OF DRILLING WATER 1. well water 2. 3.	
DRILLER INFORMATION <div style="font-size: 8pt;">Driller's Name 76 License No. 81</div> <div style="font-size: 24pt; font-weight: bold;">Andrew Houseman MD 224</div> <div style="font-size: 24pt; font-weight: bold;">Fogles Well Drilling, LLC</div> <div style="font-size: 24pt; font-weight: bold;">P.O. Box 202 Woodbine Md 21797</div> <div style="font-size: 8pt;">Address</div> <div style="font-size: 24pt; font-weight: bold;">12-21-12</div> <div style="font-size: 8pt;">Signature Date</div>		<div style="font-size: 24pt; font-weight: bold;">1447 Woodstock Rd</div> <div style="font-size: 8pt;">11 STREET ADDRESS 30</div> <div style="text-align: center;"> ON WHICH SIDE OF ROAD (CIRCLE APPROPRIATE BOX) <div style="display: flex; justify-content: space-around;"> <div style="text-align: center;"> <div style="font-size: 8pt;">34 300 37</div> <div style="font-size: 8pt;">DISTANCE FROM ROAD</div> <div style="font-size: 8pt;">ENTER FT OR MI 38 39</div> </div> <div style="text-align: center;"> <div style="font-size: 8pt;">NORTH</div> <div style="font-size: 8pt;">WEST EAST</div> <div style="font-size: 8pt;">SOUTH</div> </div> </div> </div>	
B 2 WELL INFORMATION <div style="font-size: 8pt;">1 2</div> <div style="font-size: 8pt;">APPROX PUMPING RATE (GAL. PER MIN.)</div> <div style="font-size: 8pt;">8 500 12</div> <div style="font-size: 8pt;">AVERAGE DAILY QUANTITY NEEDED (GAL. PER DAY)</div> <div style="font-size: 8pt;">14 500 20</div>		NOT TO BE FILLED IN BY DRILLER HEALTH DEPARTMENT APPROVAL <div style="font-size: 24pt; font-weight: bold;">Howard</div> <div style="font-size: 8pt;">COUNTY NAME 13 COUNTY NO.</div> <div style="font-size: 8pt;">STATE SIGNATURE</div> <div style="font-size: 8pt;">DATE ISSUED 12/22/21</div> <div style="font-size: 8pt;">43 MM DD YY 46</div> <div style="font-size: 8pt;">CO SIGNATURE</div> <div style="font-size: 8pt;">EXP. DATE 12/22/21</div> <div style="font-size: 8pt;">41</div>	
USE FOR WATER (CIRCLE APPROPRIATE BOX) <div style="font-size: 8pt;">22</div> <div style="font-size: 8pt;"> <input checked="" type="radio"/> DOMESTIC POTABLE SUPPLY & RESIDENTIAL IRRIGATION <input type="radio"/> FARMING (LIVESTOCK WATERING & AGRICULTURAL IRRIGATION) <input type="radio"/> INDUSTRIAL, COMMERCIAL, DEWATERING <input type="radio"/> PUBLIC WATER SUPPLY WELL <input type="radio"/> TEST, OBSERVATION, MONITORING <input type="radio"/> OPEN LOOP GEOTHERMAL <input type="radio"/> CLOSED LOOP GEOTHERMAL </div>		<div style="font-size: 24pt; font-weight: bold;">300</div> <div style="font-size: 8pt;">APPROXIMATE DEPTH OF WELL 24 28 FEET</div> <div style="font-size: 24pt; font-weight: bold;">6</div> <div style="font-size: 8pt;">APPROXIMATE DIAMETER OF WELL NEAREST INCH</div>	
METHOD OF DRILLING (circle one) <div style="font-size: 8pt;">30 BORED (or Augered) 37 CABLE</div> <div style="font-size: 8pt;">JETTET AIR-PERCUSsion REVERSE-ROTary</div> <div style="font-size: 8pt;">Jettet & DRIVEN ROTARY (Hydraulic Rotary) DRIVE-POINT</div> <div style="font-size: 8pt;">other</div>		<div style="font-size: 24pt; font-weight: bold;">1443</div> <div style="font-size: 24pt; font-weight: bold;">1447</div> <div style="font-size: 24pt; font-weight: bold;">Septic</div> <div style="font-size: 24pt; font-weight: bold;">Garage</div> <div style="font-size: 24pt; font-weight: bold;">219' Ex well</div> <div style="font-size: 24pt; font-weight: bold;">135</div> <div style="font-size: 24pt; font-weight: bold;">Property</div>	
REPLACEMENT OR DEEPEMED WELLS (CIRCLE APPROPRIATE BOX) <div style="font-size: 8pt;">39</div> <div style="font-size: 8pt;"> <input type="radio"/> THIS WELL WILL NOT REPLACE AN EXISTING WELL <input type="radio"/> THIS WELL WILL REPLACE A WELL THAT WILL BE ABANDONED AND SEALED <input checked="" type="radio"/> THIS WELL WILL REPLACE A WELL THAT WILL BE USED AS A STANDBY-CONTACT LOCAL APPROVING AUTHORITY FOR POLICY ON STANDBY WELLS <input type="radio"/> THIS WELL WILL DEEPEN AN EXISTING WELL </div> <div style="font-size: 8pt;">PERMIT NUMBER OF WELL TO BE REPLACED OR DEEPEMED (IF AVAILABLE) 41 52</div>		<div style="font-size: 8pt;">Pursuant to § 10-624 of the State Govt. Article of the Maryland Code, personal info requested on this form is used in processing this form pursuant to COMAR 26.04.04. Failure to provide the info may result in this form not being processed. You have the right to inspect, amend, or correct this form. The Maryland Department of the Environment is subject to the Maryland Public Information Act. This form may be made available on the Internet via MDE's website and is subject to inspection or copying, in whole or in part, by the public and other governmental agencies, if not protected by federal or State Law.</div>	
Not to be filled in by driller (MDE OR COUNTY USE ONLY) <div style="font-size: 8pt;">APPROP. PERMIT NUMBER</div> <div style="font-size: 24pt; font-weight: bold;">G</div> <div style="font-size: 8pt;">PERMIT No. 40-20-0146</div> <div style="font-size: 8pt;">70 71 72 73 74 75 76 77 78 79</div>			
SPECIAL CONDITIONS RADIUM SAMPLES REQUIRED <div style="font-size: 8pt;">NOTE APPROVING AUTHORITIES SHOULD USE SEPARATE SHEET IF NEEDED</div>			

SITE INSPECTION SHEET

OWNER: Scott Braglio PHONE #: _____

ADDRESS: 1447 Woodstock Rd CONTRACTOR: Fogles
Woodstock, MD 21163 WELL TAG #: H0-73-3942 ^{new} _{rep} H0-20-0146

SUBDIVISION: _____ LOT: _____ COUNTY #: 13

PROPOSAL: emergency out of water

LOCATION DIAGRAM

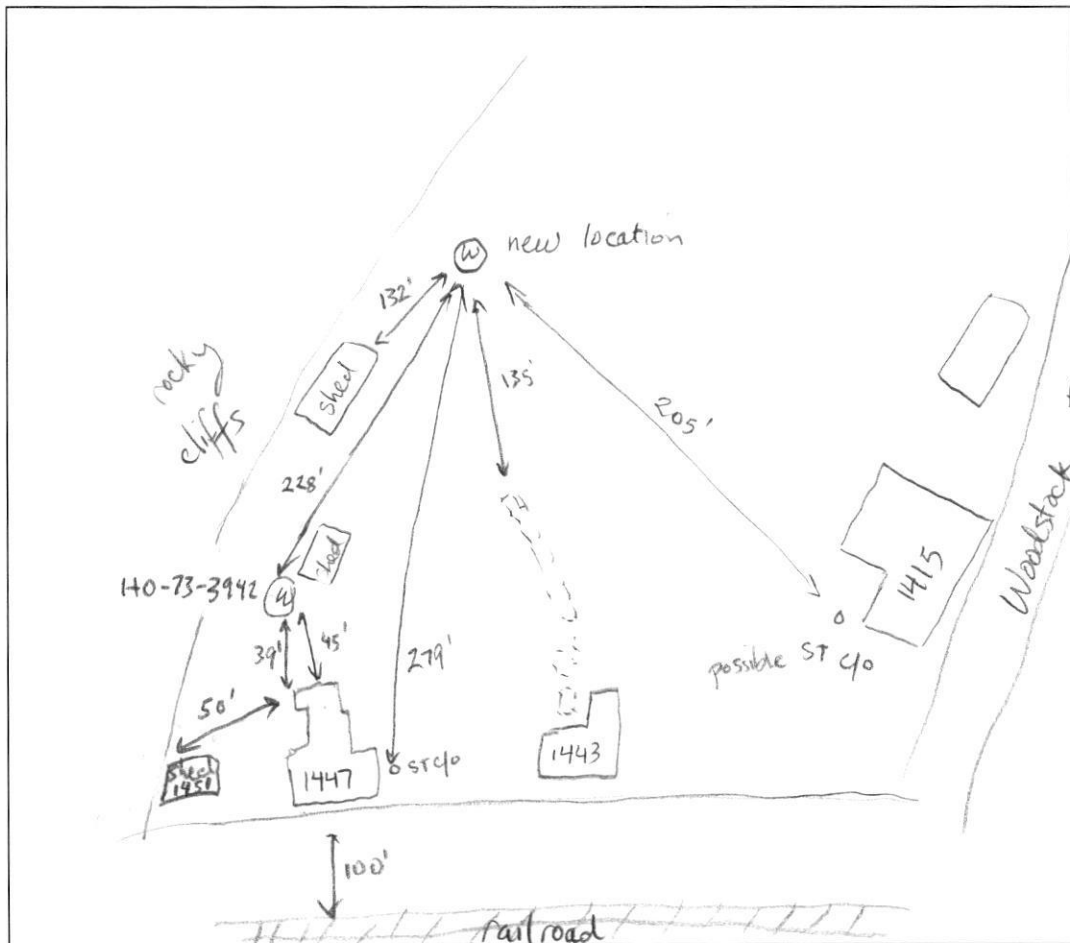

COMMENTS: Septic cleanout between house and driveway - location of drainfields or drywell unknown, no records. Neighbor (1443) septic extends through entire backyard - no location beyond house that is >100' from septic. Furthest possible location on 1451 would be 50' from probable septic replacement area. Chose location on 1415 that meets all setbacks - owner owns

DATE: 12/22/21 INSPECTOR: Juan Thomas

both properties and will need easement agreement before well line is connected.

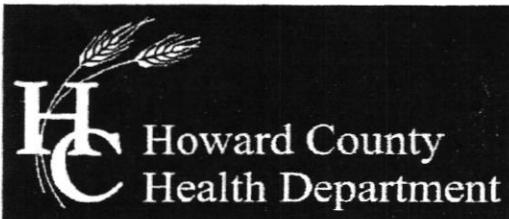

Bureau of Environmental Health

8930 Stanford Boulevard, Columbia, MD 21045

Main: 410-313-2640 | Fax: 410-313-2648

TDD 410-313-2323 | Toll Free 1-866-313-6300

www.hchealth.org

Facebook: www.facebook.com/hocohealth

Twitter: HowardCoHealthDep

Dr. Maura J. Rossman, M.D., Health Officer

TO ALL INTERESTED PARTIES

When submitting a well permit application for a proposed well for new construction, please indicate one of the following:

Well Site Location:

_____	_____	<u>1447 Woodstock Rd</u>
Subdivision/Property Name	Lot #	Road Name

☐ The well site has been staked by Andrew and Susan
(professional land surveyor or company employing professional land surveyors)
on 12-22-21 (date) and does not require a site inspection.

☐ The well driller, builder or property owner will call the Health Department to schedule a time to meet in the field to verify the proposed well site location.

Susan met Andy on site 12/21/21

This sheet, along with two copies of an acceptable well site plan, must be attached to the green well permit application.

