

C11 2418 SEQUENCE NO. (DENV USE ONLY)
 (THIS NUMBER IS TO BE PUNCHED IN COLS. 3-6 ON ALL CARDS)

STATE OF MARYLAND
 WELL COMPLETION REPORT
 FILL IN THIS FORM COMPLETELY
 PLEASE PRINT OR TYPE

THIS REPORT MUST BE SUBMITTED WITHIN 45 DAYS AFTER WELL IS COMPLETED.
 COUNTY NUMBER W 44427

DATE RECEIVED [] [] [] [] [] [] DATE WELL COMPLETED 060189
 Depth of Well 200 (TO NEAREST FOOT) PERMIT NO. HO-88-0690

OWNER James K. Kelly last name first name
 STREET OR RFD 1455 Woodward Blvd TOWN West Friendship
 SUBDIVISION [] SECTION [] LOT []

WELL LOG
 Not required for driven wells

STATE THE KIND OF FORMATIONS PENETRATED, THEIR COLOR, DEPTH, THICKNESS AND IF WATER BEARING

DESCRIPTION (Use additional sheets if needed)	FEET		Check if water bearing
	FROM	TO	
<u>Sand</u>	<u>0</u>	<u>37</u>	
<u>Grey Mica Rock</u>	<u>37</u>	<u>200</u>	

GROUTING RECORD
 WELL HAS BEEN GRROUTED (Circle Appropriate Box) Y N
 TYPE OF GRROUTING MATERIAL
 CEMENT CM BENTONITE CLAY BC
 NO. OF BAGS 9 NO. OF POUNDS 346
 GALLONS OF WATER 5.4
 DEPTH OF GROUT SEAL (to nearest foot)
 from 0 ft. to 36 ft.
 (enter 0 if from surface)

CASING RECORD
 casing types insert appropriate code below
 ST STEEL CO CONCRETE
 PL PLASTIC OT OTHER
 MAIN CASING TYPE Nominal diameter top (main) casing (nearest inch) Total depth of main casing (nearest foot)
 ST 6 42
 60 61 63 64 66 65 70

PUMPING TEST
 HOURS PUMPED (nearest hour) 3
 PUMPING RATE (gal. per min. to nearest gal.) 10
 METHOD USED TO MEASURE PUMPING RATE air
 WATER LEVEL (distance from land surface) BEFORE PUMPING 33 WHEN PUMPING 18.1
 TYPE OF PUMP USED (for test)
 A air P piston T turbine
 C centrifugal R rotary O other (describe below)
 J jet S submersible

OTHER CASING (if used)
 diameter inch depth (feet) from to
 [] [] [] [] [] []

SCREEN RECORD
 screen type or open hole insert appropriate code below
 ST STEEL BR BRASS HO OPEN HOLE
 PL PLASTIC OT OTHER

DEPTH (nearest ft.)
 EACH SCREEN
 1 HO 40 200
 8 9 11 15 17 21
 2 [] [] [] [] [] []
 23 24 26 30 32 36
 3 [] [] [] [] [] []
 38 39 41 45 47 51
 SLOT SIZE 1 2 3
 DIAMETER OF SCREEN [] [] [] [] (NEAREST INCH)
 56 60

PUMP INSTALLED
 DRILLER WILL INSTALL PUMP YES NO
 (CIRCLE) (YES or NO)
 IF DRILLER INSTALLS PUMP, THIS SECTION MUST BE COMPLETED FOR ALL WELLS EXCEPT HOME USE
 TYPE OF PUMP INSTALLED PLACE (A,C,J,P,R,S,T,O) IN BOX - SEE ABOVE: []
 CAPACITY: GALLONS PER MINUTE (to nearest gallon) [] [] [] []
 PUMP HORSE POWER [] [] [] []
 PUMP COLUMN LENGTH (nearest ft.) [] [] [] []
 CASING HEIGHT (circle appropriate box and enter casing height)
 + above } LAND SURFACE (nearest foot)
 - below } [] [] (nearest foot)
 49 50 51

CIRCLE APPROPRIATE LETTER
 A WELL WAS ABANDONED AND SEALED WHEN THIS WELL WAS COMPLETED
 E ELECTRIC LOG OBTAINED
 P TEST WELL CONVERTED TO PRODUCTION WELL

I HEREBY CERTIFY THAT THIS WELL HAS BEEN CONSTRUCTED IN ACCORDANCE WITH COMAR 10.17.13 "WELL CONSTRUCTION" AND IN CONFORMANCE WITH ALL CONDITIONS STATED IN THE ABOVE CAPTIONED PERMIT, AND THAT THE INFORMATION PRESENTED HEREIN IS ACCURATE AND COMPLETE TO THE BEST OF MY KNOWLEDGE

DRILLERS IDENT. NO. 238
 DRILLERS SIGNATURE Joseph Murphy
 (MUST MATCH SIGNATURE ON APPLICATION)

GRAVEL PACK [] [] [] [] from to
 IF WELL DRILLED WAS FLOWING WELL INSERT [] IN BOX 68

OEP USE ONLY (NOT TO BE FILLED IN BY DRILLER)
 T (E.R.O.S.) W.Q
 70 [] 72 [] 74 [] 75 [] 76 []
 TELESCOPE CASING LOG INDICATOR OTHER DATA

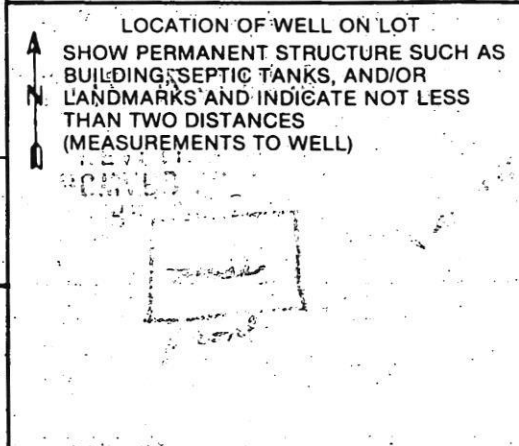

REPLACEMENT WELL SITE INSPECTION

OWNER Ridgely Jones
ADDRESS 1485 Underwood Road
West Friendship, MD

DATE REQUESTED 5-25-89
DRILLER Joe Mayne
WELL TAG# HV-88-0640
COUNTY# W 44427

LOCATION DIAGRAM

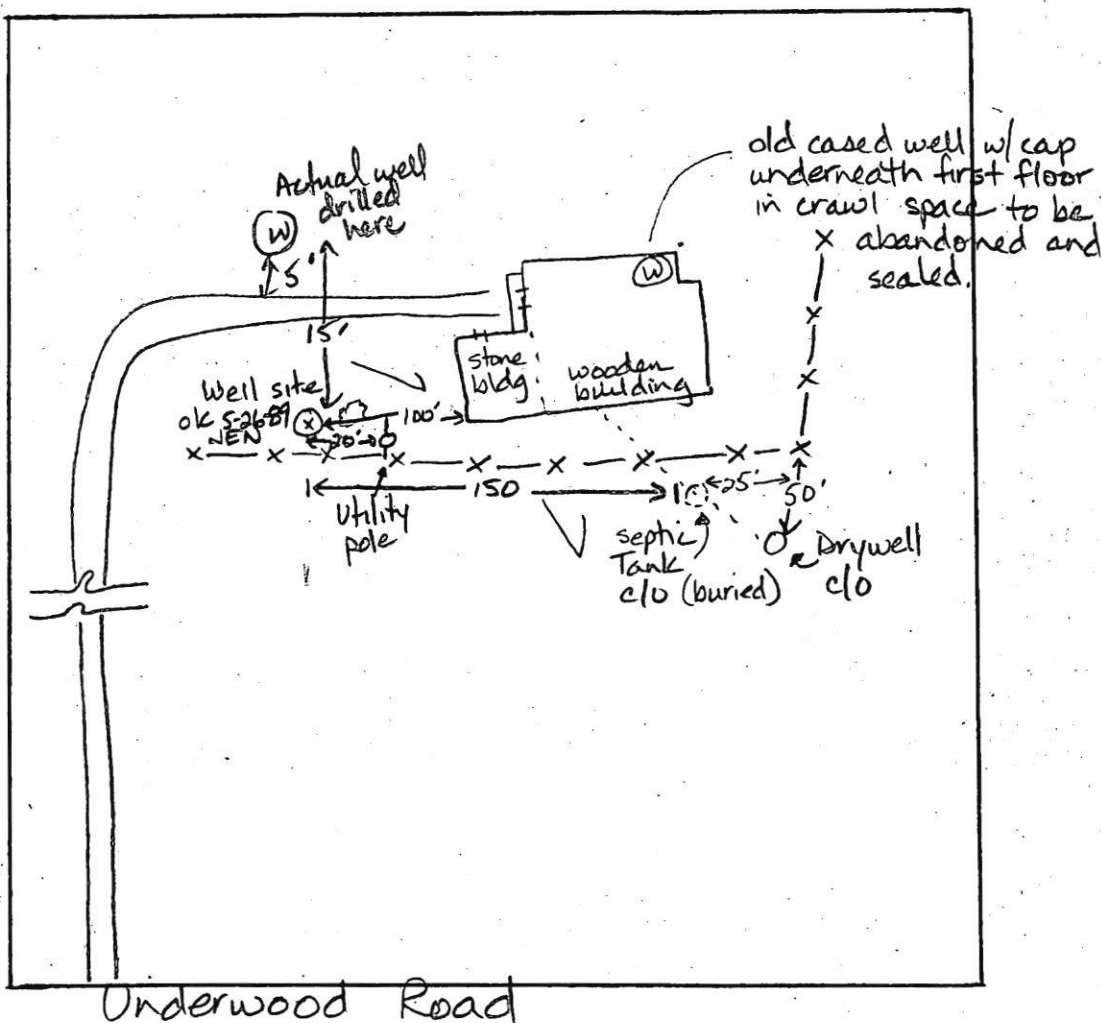

COMMENTS:

Intent is to abandon and seal old well, then spray home for termites. I informed Mrs. Jones that the existing well must be properly sealed before any insecticide treatment can begin. 5-26-89 JEN

Thomas, Susan

From: phillip leduc <leduc1pl@gmail.com>
Sent: Friday, April 29, 2022 9:22 AM
To: Thomas, Susan
Subject: Location of HO-88-0640 on 1485 Underwood Rd

[Note: This email originated from outside of the organization. Please only click on links or attachments if you know the sender.]

Hi Susan,

My name is Phillip LeDuc I'm Ann's son-in-law and live here at the house you did the perc test for. I've attached some pictures of the well you are looking for. If needed I could share an actual gps location.

Here is a rough location of a saved GPS pin....

Dropped pin

<https://goo.gl/maps/2a73eohza5F3nkoa8>

Please let me know if there is anything else you need,

Phil LeDuc
443-813-9282

----- Forwarded message -----

From: phillip leduc <leduc1pl@gmail.com>
Date: Fri, Apr 29, 2022 at 8:57 AM
Subject: Re: Location of HO-88-0640 on 1485 Underwood Rd
To: Ann jones <annholmesjones@gmail.com>
CC: Tim Jones <jonestimjim@aol.com>

44°



