

11/3/76
p.m. *pluse*

PERMIT INDEXED

SEWAGE DISPOSAL SYSTEM

P 24322

A 21192

MARYLAND STATE DEPARTMENT OF HEALTH

HOWARD COUNTY

ELLICOTT CITY

DISTRICT 38d

DATE 10/25/76

Approved
hb
11-4-76

Jack Fyock

IS PERMITTED TO INSTALL ☒ ALTER

ADDRESS 13775 Triadelphia Road, Glenelg, Md.

PHONE 988-9229 9270

A SEWAGE DISPOSAL SYSTEM LOCATED AT

SUBDIVISION ROAD Thompson Drive

LOT 1

PROPERTY OWNER Ronald F. Sines, et. ux.

ADDRESS

SPECIFICATIONS 3 bedrooms

DRAIN FIELD DEPTH FEET, BOTTOM AREA SQ. FT.

SEEPAGE PITS ABSORBENT SIDE-WALL AREA SQ. FT.

SEPTIC TANK CAPACITY 1000 GALLONS

FOR GARBAGE GRINDER, INCREASE DISPOSAL AREA 22% & TANK CAPACITY 50%.

OTHER DRY WELL AND TRENCH - Total absorbent sidewall area for drywell is 250 sq. ft. Inlet at 4 ft. and maximum depth 9 ft. below original grade. Locate dry well 110 ft. N.E. of a point on the 249 ft. lot line and 110 ft. from the 128 ft. lot line. Trench to be 25 ft. long for a sidewall area of 175 sq. ft. Inlet at 4 ft. and maximum depth 9 ft. Trench to run N.W. towards a point on the 178 ft. lot line and 110 ft. from the 249 ft. lot line.

CALL FOR INSPECTION OF TRENCH BEFORE PLACING GRAVEL IN TRENCH.

NOTE: ALL PIPE FROM HOUSE TO DISPOSAL AREA MUST BE CAST IRON. PERMIT VOID AFTER THREE YEARS. NOTE: INSTALL STAND PIPE ON SEPTIC TANK AND DRY WELL. STAND PIPES MUST BE 6

INCHES IN DIAMETER. CAST IRON, CONCRETE OR TERRA COTTA AVAILABLE.

PLANS APPROVED BY David J. O'Neill DATE 10/30/75

FILL SEPTIC TANK AND DISTRIBUTION BOX WITH WATER BEFORE CALLING FOR AN INSPECTION. COVER NO WORK UNTIL INSPECTED AND APPROVED.

NEITHER THE HOWARD COUNTY COMMISSIONERS NOR THE HEALTH DEPARTMENT IS RESPONSIBLE FOR THE SUCCESSFUL OPERATION OF ANY SYSTEM.

7010

A 21192

$\frac{4}{3} \times \frac{6}{228} = 1$

$\frac{4}{3} \times \frac{6}{228} = 1$

PT 144

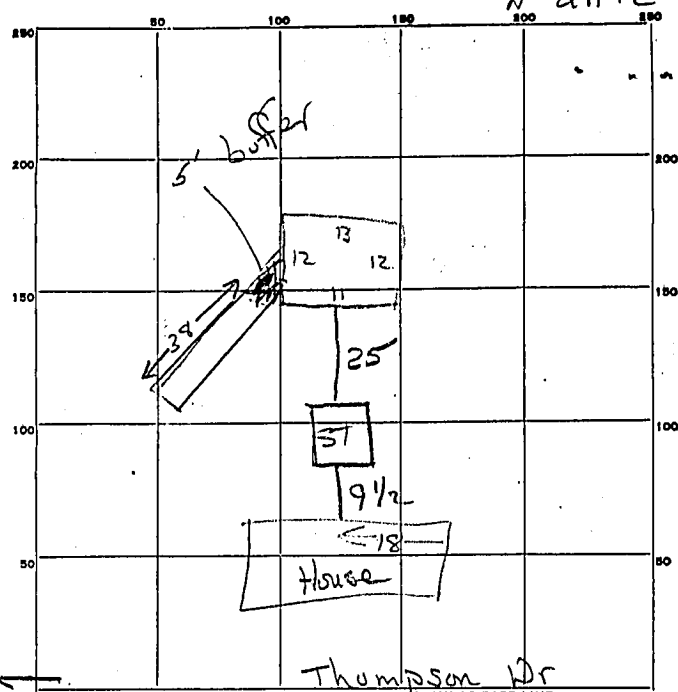

144

PERMIT CARD yes

OW	5T
✓	✓

SEPTIC TANK, LEVEL _____

CLEANOUTS _____

DISTRIBUTION BOX, LEVEL _____

TILE FIELD, DEPTH 9 FT. TRENCH WIDTH 2 FT.

GRAVEL DEPTH 6 ft TOTAL LENGTH 38 FT.

NUMBER OF TRENCHES 1 one side TOTAL-BOTTOM AREA 228

SEEPAGE PITS, INSIDE-DIAMETER Perimeter 48 FT. DEPTH BELOW INLET 6 FT. DW = 288

Total ABSORBENT AREA 516 SQ. FT.

REMARKS total lenght of trench may not
be completely in Perc area -
however trench installed in
excellent sandy soil

DATE SYSTEM APPROVED 11-4-76 INSPECTOR hal Benson