

GENERAL NOTES

1. SEPTIC EASEMENT SUBJECT TO HOWARD COUNTY HEALTH DEPARTMENT No.
2. PROPOSED 1500 GALLON SEPTIC TANK.
3. A. FIRST FLOOR ELEVATION: 509.20
 B. BASEMENT ELEVATION: 500.20
 C. INVERT OF SEPTIC SYSTEM AT HOUSE: 502.50
 D. INVERT IN AT SEPTIC TANK: 502.00
 E. INVERT OUT AT SEPTIC TANK: 501.70
 F. PROPOSED GRADE OVER SEPTIC TANK: 504.50
 G. INVERT AT DISTRIBUTION BOX: 501.50
 H. EXISTING GROUND OVER DISTRIBUTION BOX: 504.50
4. LENGTH OF TRENCH TO BE DETERMINED AT TIME OF SEPTIC PERMITS ISSUANCE.
5. CONTRACTOR / BUILDER TO VERIFY ELEVATIONS IN FIELD BEFORE ANY CONSTRUCTION.
6. THERE IS NO BASEMENT SERVICE TO SEPTIC SYSTEM.

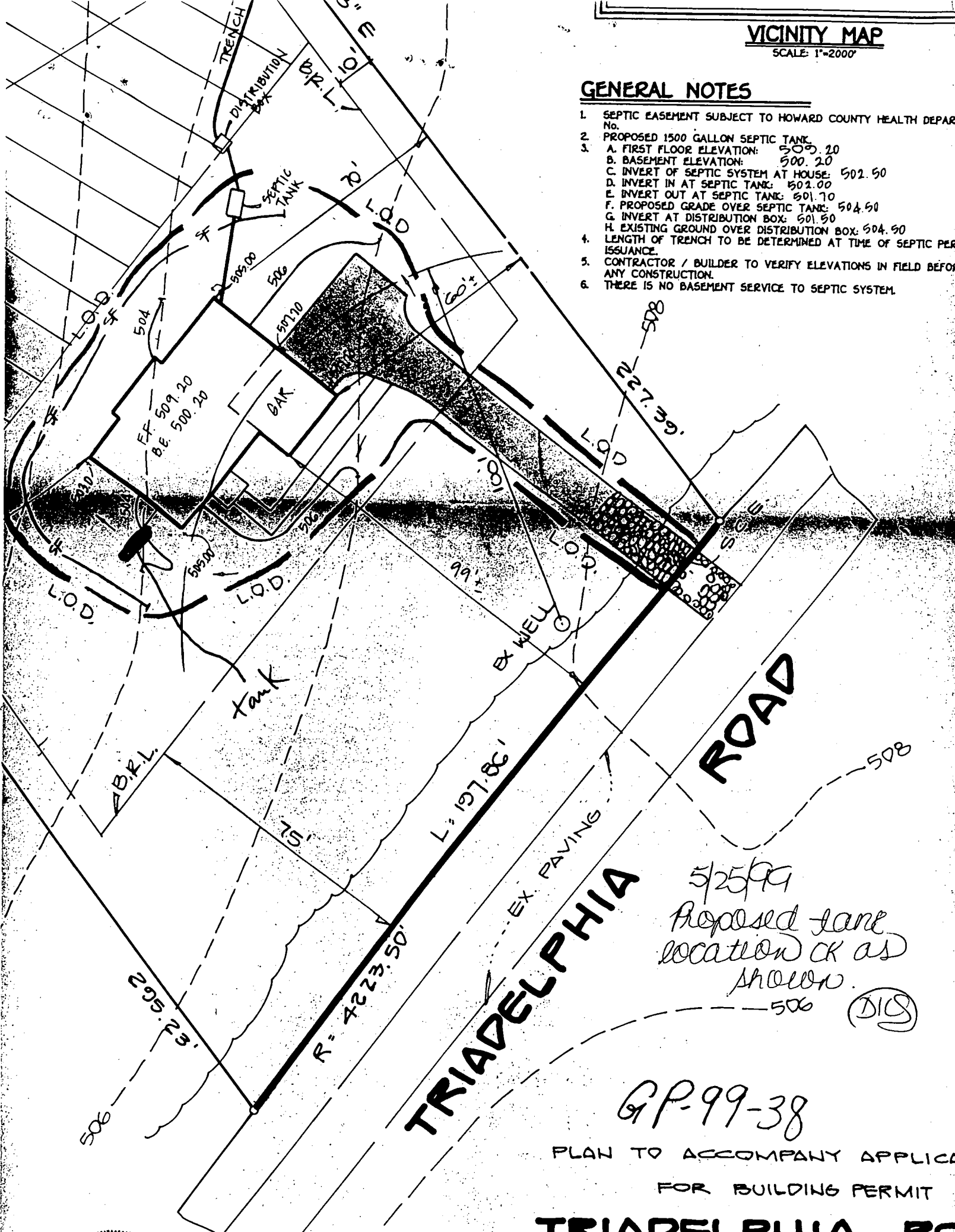

5/25/99
 Proposed lane location OK as shown.
 (DLS)

TRIADELPHIA ROAD

GP-99-38

PLAN TO ACCOMPANY APPLICATION FOR BUILDING PERMIT

TRIADELPHIA ROAD