

LAYOUT 3/4/08 INSP 4 3/12/08
 INSP 2 3/10/08 INSP 5 _____
 INSP 3 3/11/08 INSP 6 _____

ISSUE DATE: 12/26/2007

P 528421

APPROVAL DATE: 3/13/08

PERMIT

Logged Into Permit Manager
 TAX ID # _____

516063

**ON-SITE SEWAGE DISPOSAL SYSTEM
 HOWARD COUNTY HEALTH DEPARTMENT
 BUREAU OF ENVIRONMENTAL HEALTH**

Fogles Septic Clean, Inc IS PERMITTED TO INSTALL ALTER

ADDRESS: _____ PHONE NUMBER: 410-795-5670

SUBDIVISION: Turnbury Grove LOT NUMBER: 1

ADDRESS: ~~6220~~ 6206 Heather Glen Way PROPERTY OWNER: Dayton Oaks LLC

SEPTIC TANK CAPACITY (GALLONS): 2000 OUTLET BAFFLE FILTER REQUIRED

PUMP CHAMBER CAPACITY (GALLONS): _____ COMPARTMENTED TANK REQUIRED

NUMBER OF BEDROOMS: 5

SQUARE FEET PER BEDROOM: _____

LINEAR FEET OF TRENCH REQUIRED: 310

TRENCHES:	Trench to be 2.0 feet wide. Inlet 3.0 feet below original grade. Bottom maximum depth 8.0 feet below original grade. Effective area begins at 6.5 feet below original grade. 5.0 feet of stone below distribution pipe.
LOCATION:	
NOTES:	Install system per plan unless directed by Health Department. Layout inspection required prior to installation.

PLANS APPROVED: Sara Sappington DATE: 4/10/07

- NOTE: PERMIT VOID AFTER 2 YEARS
- NOTE: CONTRACTOR RESPONSIBLE FOR SCHEDULING A PRE-CONSTRUCTION INSPECTION FOR ALL INSTALLATIONS
- NOTE: WATERTIGHT SEPTIC TANKS REQUIRED
- NOTE: ALL PARTS OF SEPTIC SYSTEM SHALL BE 100 FEET FROM ANY WATER WELL
- NOTE: MANHOLE RISERS REQUIRED ON ALL SEPTIC TANKS AND PUMP CHAMBERS UNLESS SPECIFICALLY AUTHORIZED

NEITHER THE HOWARD COUNTY COUNCIL NOR THE HEALTH DEPARTMENT IS RESPONSIBLE FOR THE SUCCESSFUL OPERATION OF ANY SYSTEM PERMITTEE RESPONSIBLE FOR OBTAINING FINAL APPROVAL ON THIS PERMIT CALL 410-313-1771 FOR INSPECTION OF SEPTIC SYSTEM

NOT TO SCALE

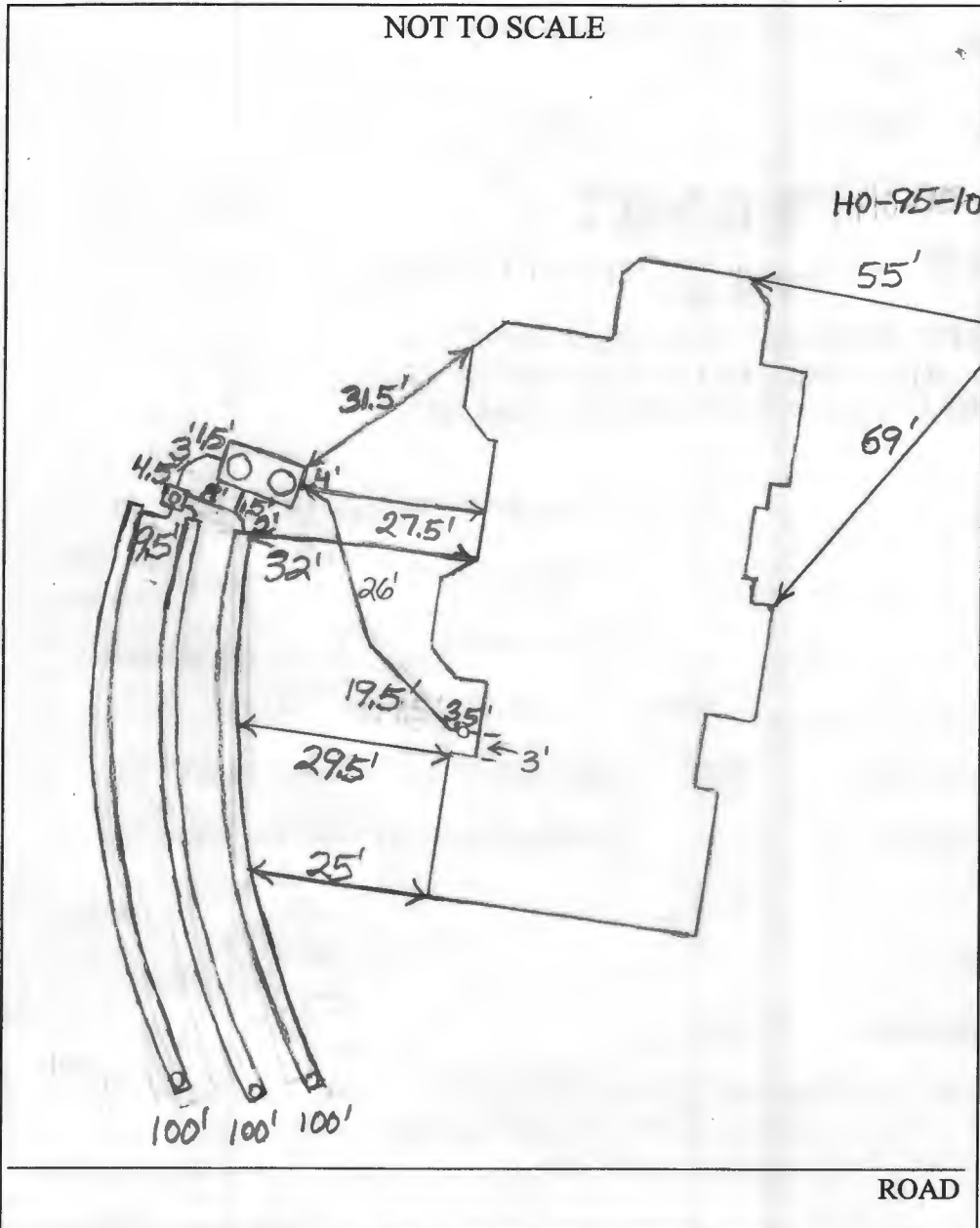

TRENCH/DRAINFIELD DATA		
WIDTH	INLET	BOTTOM
2'	25'-3'	8'
NUMBER OF TRENCHES 3		
TOTAL LENGTH 300'		
ABSORPTION AREA 900+Sidewalk		
DISTRIBUTION BOX LEVEL Levelers		
DISTRIBUTION BOX BAFFLE Yes		
DISTRIBUTION BOX PORT Yes		

SEPTIC TANK DATA	
SEPTIC TANK 1 LEVEL	Yes
CAPACITY	2000 GAL
SEAM LOC	Top
TANK LID DEPTH	1'-2'
BAFFLES	Yes
BAFFLE FILTER	No
MANHOLE LOC	Front+Rear
6" PORT LOC	None
WATERTIGHT TEST	No
SEPTIC TANK 2 LEVEL	N/A
CAPACITY	_____ GAL
SEAM LOC	_____
TANK LID DEPTH	_____
BAFFLES	_____
BAFFLE FILTER	_____
MANHOLE LOC	_____
6" PORT LOC	_____
WATERTIGHT TEST	_____

2-Comp.
Babylon

PRE-CONSTRUCTION 3/4/08 No one on site. Fill on easement. Called contractor and told them that fill had to be removed because that's where trenches are going. (BB) 3/10/08 Fill cleared off easement. Foggles restaked top of easement. Place the distribution box near where it is shown on the B.P. plan and install three 100' trenches towards lot 2. Install the tank partially in the easement on the other side of the distribution box. (BB) 3/11/08 Tank set. House connection made. Top trench mostly done. (BB) 3/12/08 Everything done except for 45' of bottom trench. (BB) 3/13/08 Everything finished. O.K. to backfill. (BB)

FINAL INSPECTOR B. Baber DATE OF APPROVAL 3/13/08



HOWARD COUNTY HEALTH DEPARTMENT

*Thom's Dev.
DIL PL
FAXL*

25 28421

DATE
12 / 26 / 07

Received From Hogles

PHONE # 410-795-5670

CASH
 CHECK
NO.
22753

For Septic / count
6206 Heather Glen Way, Turnbury Grove, Lot 1
the curve at Marksville

Three hundred ninety six and 00/100 Dollars

\$ 396 / 00

Received By Mary F. Brugga