

7/15/85
ASAP
7/12/85
before noon
2nd

7-15-85
approved
SAB

PERMIT

SEWAGE DISPOSAL SYSTEM

MARYLAND STATE DEPARTMENT OF HEALTH*

P 35758

A REPAIR

HOWARD COUNTY
BUREAU OF ENVIRONMENTAL HEALTH
992-2330

ELLICOTT CITY
DISTRICT _____

INDEXED

DATE 7/10/85

Jack Fyock IS PERMITTED TO INSTALL _____ ALTER

ADDRESS _____ PHONE 988-9270

SUBDIVISION Turf Valley ROAD 2609 Turf Valley Dr. LOT 11, Block B, sect 1

PROPERTY OWNER Robert F. Steiner
2609 Turf Valley Road

ADDRESS _____

IF GARBAGE GRINDER IS USED INCREASE SEPTIC TANK CAPACITY BY 50% AND ABSORPTION AREA BY 22%.

GARBAGE GRINDER? YES _____ NO _____

SEPTIC TANK CAPACITY _____ GALLONS NUMBER OF BEDROOMS _____

REPAIR - CALL FOR INSPECTION WHEN GROUND IS OPENED UP SO SANITARIAN CAN RECOMMEND REPAIR.

PLANS APPROVED BY C. Williams DATE 7/9/85

COVER NO WORK UNTIL INSPECTED AND APPROVED.

NEITHER THE HOWARD COUNTY COUNCIL NOR THE HEALTH DEPARTMENT IS RESPONSIBLE FOR THE SUCCESSFUL OPERATION OF ANY SYSTEM.

NOTE: IF TRENCH IS USED CALL FOR INSPECTION BEFORE AND AFTER PLACING GRAVEL IN TRENCH.

NOTE: NO DRY WELL SHALL EXCEED 15 FOOT IN DIAMETER. NO ABSORPTION TRENCH TO EXCEED 100 FEET IN LENGTH.

NOTE: ALL PIPE FROM HOUSE TO SEPTIC TANK MUST BE CAST IRON OR SCHEDULE 40 PVC OR ABS.

PERMIT VOID AFTER THREE YEARS.

NOTE: INSTALL STAND PIPE ON SEPTIC TANK AND DRY WELL. STAND PIPES MUST BE 6 INCHES IN DIAMETER. CAST IRON, CONCRETE OR TERRA COTTA, OR PVC OR ABS ACCEPTED. IF TOP OF SEPTIC TANK IS DEEPER THAN 3 FEET MANHOLE TO GRADE REQUIRED.

***INSTALLER IS RESPONSIBLE FOR OBTAINING FINAL APROVAL ON THIS PERMIT**

*CALL 992-2330 FOR INSPECTION OF SEPTIC SYSTEMS.

EH - 2-1082

A 35758

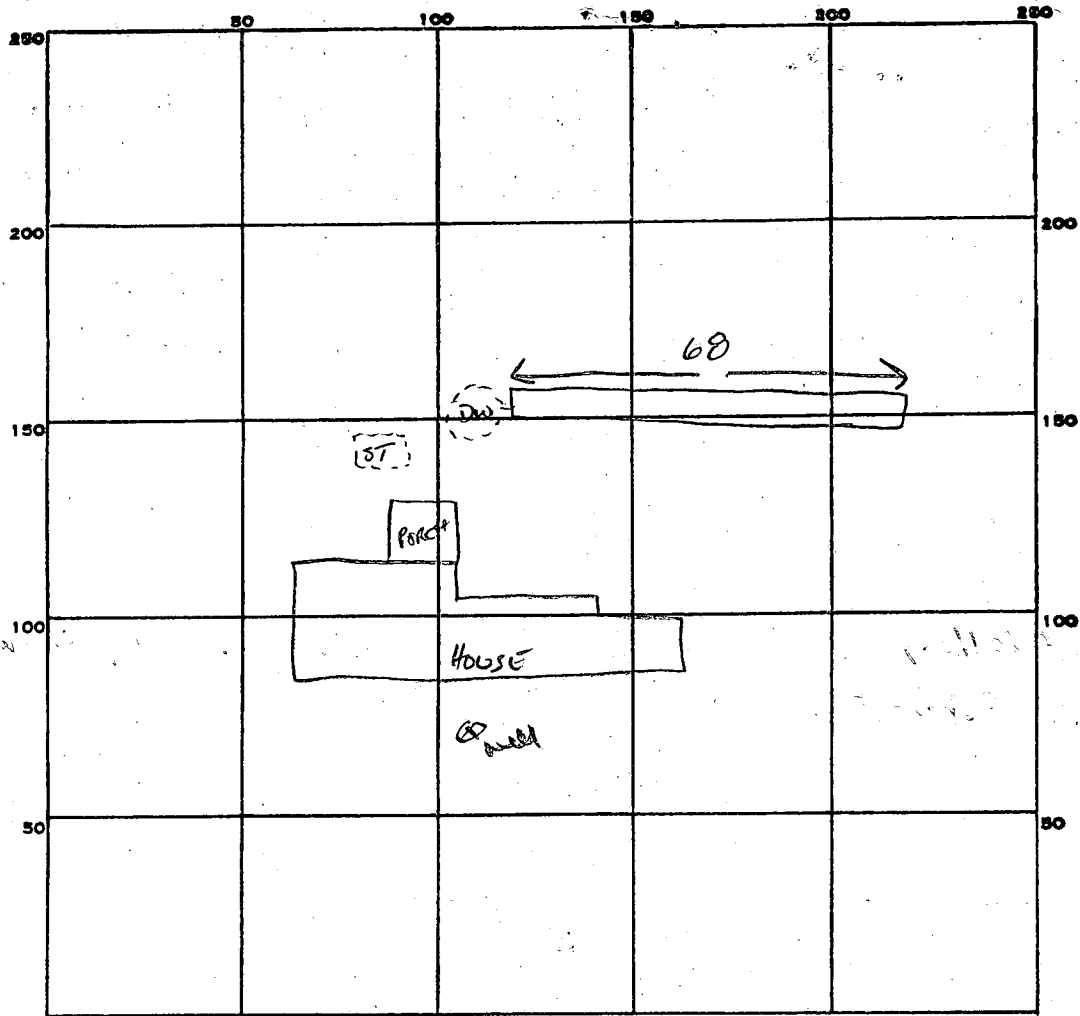

INDICATE NORTH. - NAME ADJOINING ROADWAY AS BASE LINE.

TURF VALLEY Rd

PERMIT CARD

SEPTIC TANK, LEVEL EXISTING

CLEANOUTS EXISTING

DISTRIBUTION BOX, LEVEL N/A

TILE FIELD, DEPTH 11 FT. TRENCH WIDTH 2 FT.

INLET 3' L

GRAVEL DEPTH 8 FT IN. TOTAL LENGTH 68 FT.

68
8
544

NUMBER OF TRENCHES 1 TOTAL BOTTOM AREA 544 \square

SEEPAGE PITS, INSIDE DIAMETER — FT. DEPTH BELOW INLET — FT.

ABSORBENT AREA 544 SQ. FT.

REMARKS 1100 AM 7/12/85 NOTHING DONE NO ONE HOME LEFT PERMIT
NEAR FRONT DOOR RH

DATE SYSTEM APPROVED 7-15-85

INSPECTOR S. Abel