

Maura J. Rossman, M.D., Health Officer

**Information Form for the Installation of the Well Pump, Pitless Adapter, and Supply Piping**

**NOTE: The installer is responsible for requesting an inspection prior to 9 am on the day of the desired inspection. No work is to be covered until approved by the Health Department. All installations must comply with the National Standard Plumbing Code (NSPC, as amended locally) and COMAR 26.04.04 (MD Well Construction Regulations). Submission of a complete form is required prior to Use and Occupancy approval.**

Company Name: ATLANTIC BLUE, LLC Telephone #: 410-840-2583  
 Address: 1862 Baltimore Blvd  
WELLMINSTER MD 21157

Must circle one:  Licensed Plumber /  Licensed Well Driller /  Licensed Well Pump Installer  
 License # and name of individual responsible for the field installation:

Name (Print): Kirk Sweeney License# 70788

\*A licensed individual must perform the actual installation. Apprentices must be under the supervision of a licensed journeyman or master plumber, pump installer or well driller. Licenses may be subjected to field verification. Unlicensed individuals may be reported to the appropriate licensing agency.

Name of Property Owner: Michelle Male Miller Telephone #: 443-306-3486  
 Subdivision: Logan Trust Property Lot #: 2 Well Tag #: HO-73-4200  
 Site Address: 1965 Long Point Road  
MOUNT AIRY, MD 21771

**Submersible Pump Data**

Make: Goulds  
 Model #: 10CS07  
 Pump Capacity: 10gpm  
 Well Yield: 30'  
 Depth of well encountered at time of pump installation: 115 (feet)

**Pitless Adapter**

Make: Campbell+  
 Model#: \_\_\_\_\_  
 GPM Depth: 42" (36" min)  
 GPM NSF/WSC approved:

**Well Cap and Electric Conduit**

Two piece watertight cap:   
 Screened, vented well cap:   
 Cap secured to casing:   
 Conduit min 18" B.G.:   
 Conduit secured to well cap:

If pump capacity exceeds well yield, a low water cut off switch is required by NSPC 1990 Section 17.8.4

Must circle one: Torque arrestors   Cable guards / Other acceptable method used

Safety rope, if used, attached to brass rope adapter or other acceptable method inside of well casing N/A

**Piping to house**

Type: PVC  
 PSI: 200 (160 psi min)  
 Depth of supply line: 36" (36" min)

**House Connection**

PVC sleeve to undisturbed soil at wall penetration:   
 Length of sleeve (5' minimum from foundation):   
 Sleeve scaled properly:

The water supply line is required to be at least ten feet from the septic tank, pump chamber, sewage piping, distribution box, drainfields, and sewage reserve area. If this cannot be accomplished, contact this office for approval prior to installation.

[Signature]  
 Signature of company representative responsible for installation

10/5/2023  
 date

**For Health Department Use Only - Not to be completed by Installer**

Date Insp. Requested: 8/29/2023 Date Insp. Approved: 10/6/2023 Inspector: \_\_\_\_\_  
 Inspection Data: Pitless adapter watertight & water supply line at least 36" below grade  
 Two piece cap installed and attached to casing securely  
 Elec. conduit extends at least 18" below grade/attached to cap properly  
 Safety rope not outside of well cap/casing  
 Correct well tag attached properly and casing 8" above finished grade  
 Water supply line sleeved adequately at house connection  
 Adequate grout observed below pitless adapter

<input checked="" type="checkbox"/>	SP
<input checked="" type="checkbox"/>	40"
<input checked="" type="checkbox"/>	40"
<input checked="" type="checkbox"/>	12"
<input checked="" type="checkbox"/>	
<input checked="" type="checkbox"/>	
<input checked="" type="checkbox"/>	

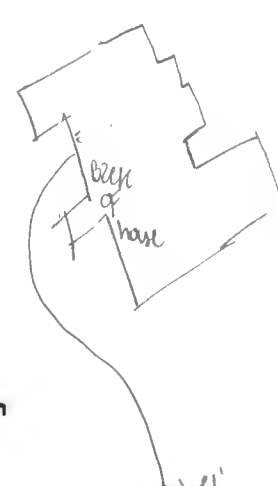

8/30/2023 -  
 1 inspect for well + 25  
 attached to casing &  
 2 piece cap  
 Entire well line sealed  
 due to proximity to  
 septic... SP

(Revised form 10/24/2018)