

LAYOUT 7/16/03 10AM INSP 4 _____
INSP 2 7/17/03 1:30pm INSP 5 _____
INSP 3 _____ INSP 6 _____

ISSUE DATE: 7/15/2003

PERMIT

P 519053

APPROVAL DATE: 7/17/03

A 514916

ON-SITE SEWAGE DISPOSAL SYSTEM
HOWARD COUNTY HEALTH DEPARTMENT
BUREAU OF ENVIRONMENTAL HEALTH
3525-H ELLICOTT MILLS DRIVE, ELLICOTT CITY, MD 21043

RPS# 339599

Farm & Homes Excavating, Inc IS PERMITTED TO INSTALL ☒ ALTER ☐

ADDRESS: 901 Driver Road, Marriottsville PHONE NUMBER: 410-442-2139

SUBDIVISION: Jones Tract LOT NUMBER: 1

ADDRESS: 1451 ~~405~~ Underwood Road PROPERTY OWNER: Philip Dorsey

SEPTIC TANK CAPACITY (GALLONS): 1250 OUTLET BAFFLE FILTER REQUIRED ☐

PUMP CHAMBER CAPACITY (GALLONS): N/A COMPARTMENTED TANK REQUIRED ☐

NUMBER OF BEDROOMS: 4

SQUARE FEET PER BEDROOM: 180

LINEAR FEET OF TRENCH REQUIRED: 180 HOUSE SERVED BY PUBLIC WATER ☐

TRENCHES:	Trench to be 2.0 feet wide. Inlet 2.0 feet below original grade. Bottom maximum depth 7.0 feet below original grade. Effective area begins at 3.0 feet below original grade. <u>4.0</u> feet of stone below distribution pipe.
LOCATION:	Note the 100 foot distance from the well to the septic area. Place the distribution box on 20' from the corner of the house, and run 2 90' trenches on countour.
NOTES:	Basement gravity service is proposed.

PLANS APPROVED: RP/KN *OK* 11/22/02 (SC) DATE: 11/21/02

NOTES: PERMIT VOID AFTER 2 YEARS
CONTRACTOR IS RESPONSIBLE FOR SCHEDULING A PRE-CONSTRUCTION INSPECTION FOR ALL INSTALLATIONS
WATERTIGHT SEPTIC TANKS REQUIRED
ALL PARTS OF SEPTIC SYSTEM SHALL BE 100 FEET FROM ANY WATER WELL UNLESS SPECIFICALLY AUTHORIZED
MANHOLE RISERS REQUIRED ON ALL SEPTIC TANKS AND PUMP CHAMBERS UNLESS SPECIFICALLY AUTHORIZED
CONTRACTOR RESPONSIBLE FOR COMPLIANCE WITH APPLICABLE REGULATIONS, GUIDELINES AND THE TERMS OF THIS PERMIT

**NEITHER THE HOWARD COUNTY COUNCIL NOR THE HEALTH DEPARTMENT IS
RESPONSIBLE FOR THE SUCCESSFUL OPERATION OF ANY SYSTEM
PERMITTEE RESPONSIBLE FOR OBTAINING FINAL APPROVAL ON THIS PERMIT
BUILDING PERMIT SIGNED 410-313-2640 FOR INSPECTION OF SEPTIC SYSTEM
AND RETURNED DO NOT LEAVE ANY REQUEST FOR INSPECTION ON VOICEMAIL**

3/8/06-600158441-DECK

4514916

NOT TO SCALE

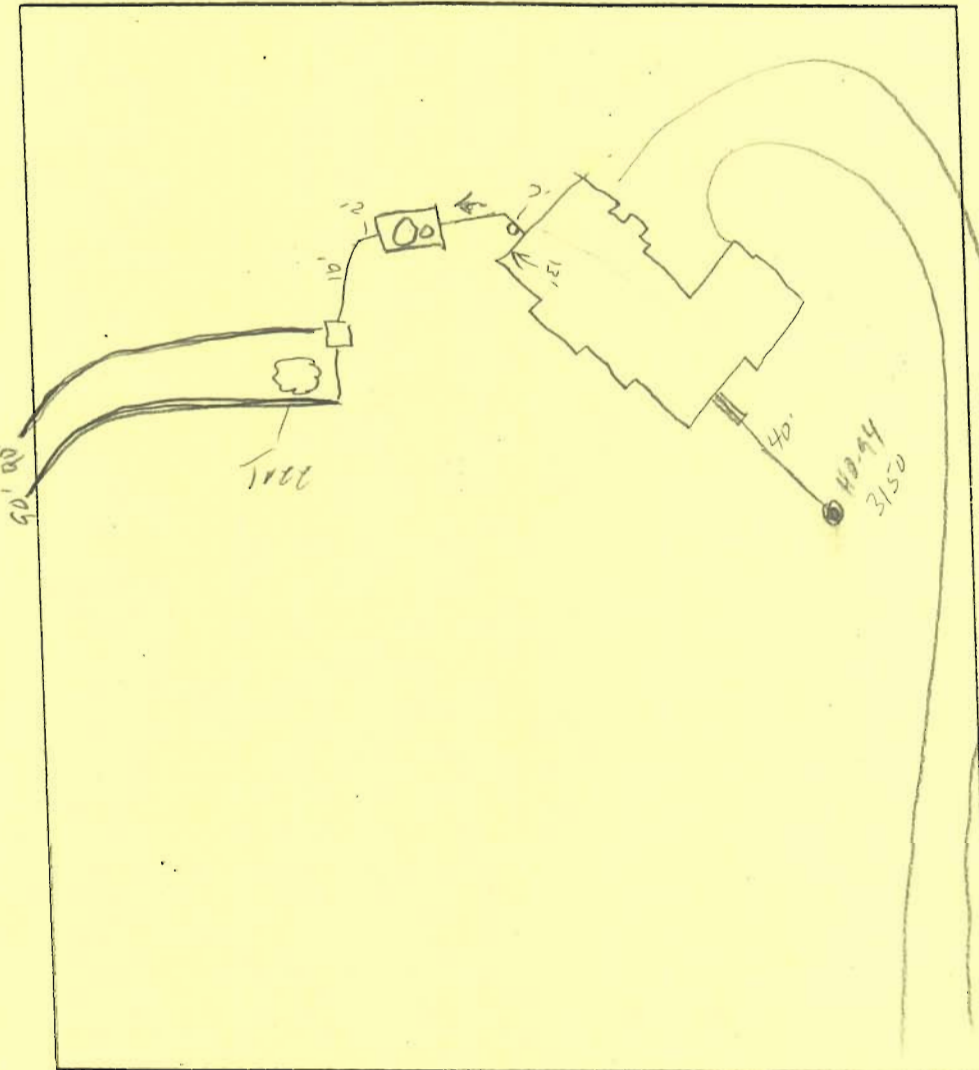

TRENCH DATA

TRENCH WIDTH _____
TRENCH INLET DEPTH _____
TRENCH BOTTOM DEPTH _____
DEPTH OF STONE _____
NUMBER OF TRENCHES _____
TOTAL TRENCH LENGTH _____
ABSORBENT AREA _____
DISTRIBUTION BOX LEVEL _____
BAFFLE IN DISTRIBUTION BOX _____

SEPTIC TANK DATA

SEPTIC TANK 1250 TS GALLONS
MANHOLE RISER 6"-1"
6 INCH INSPECTION PORT _____

PUMP CHAMBER DATA

PUMP CHAMBER
GALLONS _____
MANHOLE RISER N/A
ALARM _____
PUMP PERFORMANCE TEST _____

PRE-CONSTRUCTION INSPECTION: 7/16/03 SRA staked, contour accurate

Install (2) 90's per B.P. (SO)

INSPECTION COMMENTS: 7/16/03 Tank set, 1st trench installed

OK to cover (SO) 7/17/03 OK to cover all work (SO)

INSPECTOR [Signature]

DATE SYSTEM APPROVED 7/21/03

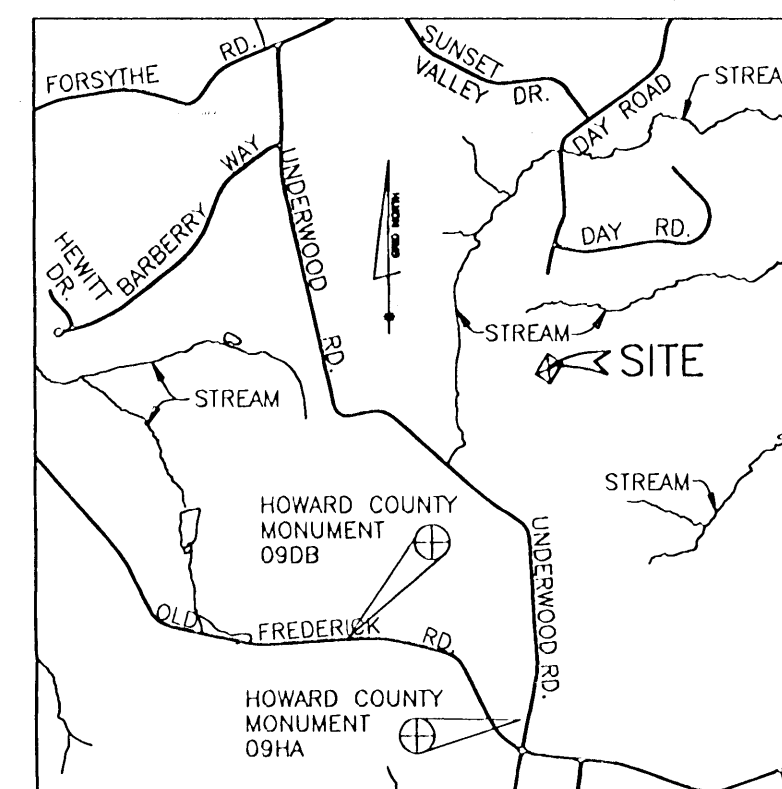

SITE VICINITY MAP

SCALE: 1" = 2000'

EXISTING GROUND
AT DISTRIBUTION BOX 581.7
INV. DISTR. BOX 578.7
INV. SEPTIC TANK OUT 578.9
INV. SEPTIC TANK IN 580.2
INV. HOUSE 581.1
EJECTOR PUMP REQ.

LEGEND

EXISTING CONTOURS	---
PROPOSED CONTOURS	---
EXISTING WOODS LINE	~~~~~
PROPOSED WOODS LINE	~~~~~
EXISTING STRUCTURE	□
PROPOSED STRUCTURE	□
PRIVATE SEWERAGE EASEMENT	▨

BENCHMARK

ENGINEERS Δ LAND SURVEYORS Δ PLANNERS

ENGINEERING, INC.

8480 BALTIMORE NATIONAL PIKE Δ SUITE 418
ELLICOTT CITY, MARYLAND 21043
PHONE: 410-465-6105 FAX: 410-465-6644

PROJECT:	JONES TRACT LOT 1		
LOCATION:	UNDERWOOD ROAD SYKESVILLE, MD 21784 TAX MAP NO. 9 - GRID 15 - P/O PARCEL 12 5th ELECTION DISTRICT, HOWARD COUNTY, MARYLAND		
TITLE:	PLOT PLAN AND PERMIT PLAN		
DATE:	OCTOBER, 2002	PROJECT NO.	PHIL JONES
SCALE:	1" = 30'	DRAWING	1 OF 1

GENERAL NOTES

- THE LOTS SHOWN HEREON COMPLY WITH THE MINIMUM OWNERSHIP WIDTH AND LOT AREA AS REQUIRED BY THE MARYLAND STATE DEPARTMENT OF THE ENVIRONMENT.
- THIS AREA DESIGNATES A PRIVATE SEWERAGE EASEMENT OF 10,000 S.F. AS REQUIRED BY THE MARYLAND STATE DEPARTMENT OF THE ENVIRONMENT FOR INDIVIDUAL SEWERAGE DISPOSAL IMPROVEMENTS OF ANY NATURE IN THIS AREA ARE RESTRICTED UNTIL PUBLIC SEWER IS AVAILABLE. THIS EASEMENT SHALL BECOME NULL AND VOID UPON CONNECTION TO A PUBLIC SEWER SYSTEM. THE COUNTY HEALTH OFFICER SHALL HAVE THE AUTHORITY TO GRANT ADJUSTMENTS TO THE PRIVATE SEWERAGE EASEMENT. RECORDATION OF A MODIFIED SEWERAGE EASEMENT PLAT SHALL NOT BE REQUIRED.
- UNLESS OTHERWISE SHOWN NO WELLS OR SEWERAGE EASEMENTS ARE LOCATED WITHIN 100 FEET OF THE PROPERTY.
- EXACT LENGTH OF SEPTIC TRENCHES IS TO BE DETERMINED BY THE HEALTH DEPARTMENT AT THE TIME OF TRENCH LAYOUT AND INSPECTION.
- TOPOGRAPHY SHOWN HEREON WAS FIELD RUN BY BENCHMARK ENGINEERING, INC. ON OR ABOUT NOVEMBER, 2000.
- NO DRIVEWAY CULVERT IS REQUIRED PER F-02-088 SUPPLEMENTAL INFORMATION.

PLAN

SCALE: 1" = 30'

