

approved 3/17/86  
Stuy

# PERMIT

P 36203  
A 17126

SEWAGE DISPOSAL SYSTEM  
MARYLAND STATE DEPARTMENT OF HEALTH\*

HOWARD COUNTY  
BUREAU OF ENVIRONMENTAL HEALTH  
92-2300  
461-9933

ELLICOTT CITY  
DISTRICT 4th

DATE 11/13/85

INDEXED

Fogbe Septic Cleaners IS PERMITTED TO INSTALL X ALTER \_\_\_\_\_

ADDRESS 1115 Streaker Road, Sykesville, Maryland 21784 PHONE 795-5670

SUBDIVISION Daisy Hill Estates ROAD 15748 Union Chapel LOT Parcel "D"

PROPERTY OWNER W 891-5799 Douglas Eurrill 854-6869  
795-9145

ADDRESS \_\_\_\_\_

IF GARBAGE GRINDER IS USED INCREASE SEPTIC TANK CAPACITY BY 50% AND ABSORPTION AREA BY 22%.

GARBAGE GRINDER? YES \_\_\_\_\_ NO X

SEPTIC TANK CAPACITY 1000 GALLONS NUMBER OF BEDROOMS 3

TRENCHES - 180 sq. ft. per bedroom. Trench to be 2 feet wide. Inlet 3 1/2 feet below original grade. Bottom maximum depth 3 1/2 feet below original grade. Effective area begins at 3 1/2 feet below original grade. 5 feet of stone below distribution pipe. LOCATION: Start first trench 230 feet from the rear lot line and 90 feet from the left lot line as seen when facing lot from Union Chapel Road. Run trench(s) along contour toward right side of property.  
NOTE: No trench to exceed 100 feet in length. If more than one trench used, adistribution box is required. Call for inspection of trench(s) before and after gravel is installed. Provide 6" - 8" diameter cleanout and cap to grade or above on septic tank. ok/cw

PLANS APPROVED BY C. Williams DATE 0/05/85

COVER NO WORK UNTIL INSPECTED AND APPROVED.

NEITHER THE HOWARD COUNTY COUNCIL NOR THE HEALTH DEPARTMENT IS RESPONSIBLE FOR THE SUCCESSFUL OPERATION OF ANY SYSTEM.

NOTE: IF TRENCH IS USED CALL FOR INSPECTION BEFORE AND AFTER PLACING GRAVEL IN TRENCH.

NOTE: NO DRY WELL SHALL EXCEED 15 FOOT IN DIAMETER. NO ABSORPTION TRENCH TO EXCEED 100 FEET IN LENGTH.

NOTE: ALL PIPE FROM HOUSE TO SEPTIC TANK MUST BE CAST IRON OR SCHEDULE 40 PVC OR ABS.

PERMIT VOID AFTER THREE YEARS.

NOTE: INSTALL STAND PIPE ON SEPTIC TANK AND DRY WELL. STAND PIPES MUST BE 6 INCHES IN DIAMETER CAST IRON, CONCRETE OR TERRA COTTA. OR PVC OR ABS ACCEPTED IF TOP OF SEPTIC TANK IS DEEPER THAN 3 FEET MANHOLE TO GRADE REQUIRED

\*INSTALLER IS RESPONSIBLE FOR OBTAINING FINAL APROVAL ON THIS PERMIT

\*CALL 992-2330 FOR INSPECTION OF SEPTIC SYSTEMS.

EH - 2-1082

A 17126

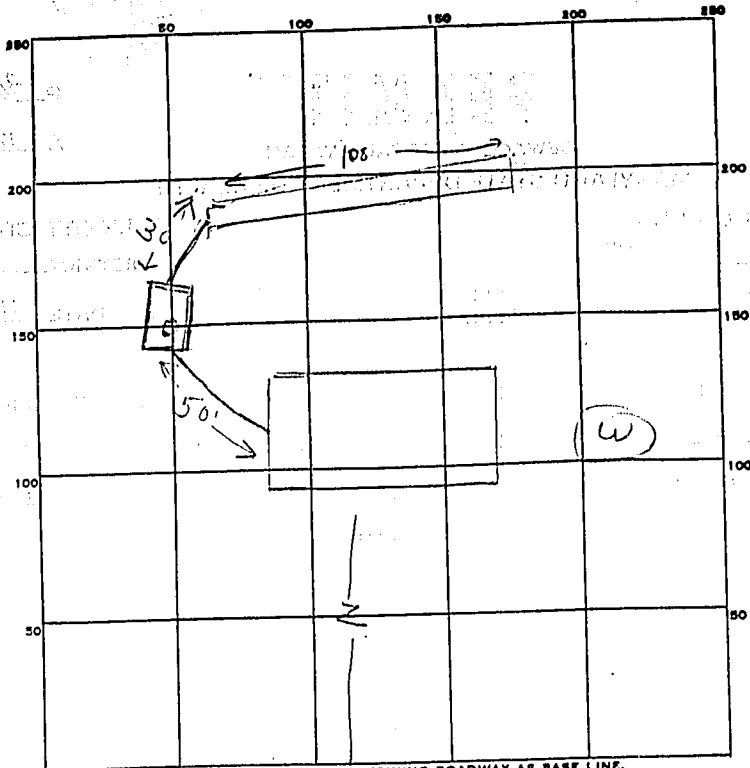

INDICATE NORTH. - NAME ADJOINING ROADWAY AS BASE LINE.

UNION CHAPEL

PERMIT CARD \_\_\_\_\_

SEPTIC TANK, LEVEL 1000 gal

CLEANOUTS ST

DISTRIBUTION BOX, LEVEL \_\_\_\_\_

TILE FIELD, DEPTH 2 1/2 FT. TRENCH WIDTH 2 FT.

GRAVEL DEPTH 5 IN. TOTAL LENGTH 108 FT.

NUMBER OF TRENCHES 1 TOTAL BOTTOM AREA 540

SEEPAGE PITS, INSIDE DIAMETER \_\_\_\_\_ FT. DEPTH BELOW INLET \_\_\_\_\_ FT.

ABSORBENT AREA \_\_\_\_\_ SQ. FT.

REMARKS 3/11/86 15' of trench dig. continue to 100 and add 30' of

3/17/86 - OK to connect trench

DATE SYSTEM APPROVED 3/17/86

INSPECTOR Stamps

# PERMIT

SEWAGE DISPOSAL SYSTEM

MARYLAND STATE DEPARTMENT OF HEALTH

HOWARD COUNTY  
BUREAU OF ENVIRONMENTAL HEALTH  
461-9933

INDEXED  
INDEXED

ELLICOTT CITY  
DISTRICT 4th  
DATE 11/13/85

36203  
36203  
A 17126

IS PERMITTED TO INSTALL  ALTER   
ADDRESS 1115 Streaker Road, Eukoville, Maryland 21784 PHONE 795-5670  
SUBDIVISION Daisy Hill Estates ROAD 15750 Union Chapel LOT Parcel "D"  
PROPERTY OWNER W 891-2129 Douglas Murray/Smith 854-6869  
ADDRESS 795-9145

IF GARBAGE GRINDER IS USED INCREASE SEPTIC TANK CAPACITY BY 50% AND ABSORPTION AREA BY 22%.

GARBAGE GRINDER? YES  NO

SEPTIC TANK CAPACITY 1000 GALLONS NUMBER OF BEDROOMS 3

TRENCHES - 180 sq. ft. per bedroom. Trench to be 2 feet wide. Inlet 3/4 feet below original grade. Bottom maximum depth 3 feet below original grade. Effective area begins at 3/4 feet below original grade, 5 feet of stone below distribution pipe. LOCATION: Start first trench 230 feet from the rear lot line and 90 feet from the left lot line as seen when facing lot from Union Chapel Road. Run trench(s) along contour toward right side of property. NOTE: No trench to exceed 100 feet in length. If more than one trench used, distribution box is required. Call for inspection of trench(s) before and after gravel is installed. Provide 6" - 8" diameter cleanout and cap to grade or above on septic tank. ok/cw

BLDG. PERMIT SIGNED

AND RETURNED 1-29-98

Serial # 100109688  
Bellevue P.W. Inspecting Station

PLANS APPROVED BY C. Williams DATE 8/05/85

COVER NO WORK UNTIL INSPECTED AND APPROVED

NEITHER THE HOWARD COUNTY COUNCIL NOR THE HEALTH DEPARTMENT IS RESPONSIBLE FOR THE SUCCESSFUL OPERATION OF ANY SYSTEM.

NOTE IF TRENCH IS USED CALL FOR INSPECTION BEFORE AND AFTER PLACING GRAVEL IN TRENCH

NOTE NO DRY WELL SHALL EXCEED 15 FOOT IN DIAMETER NO ABSORPTION TRENCH TO EXCEED 100 FEET IN LENGTH

NOTE ALL PIPE FROM HOUSE TO SEPTIC TANK MUST BE CAST IRON OR SCHEDULE 40 PVC OR ABS

PERMIT VOID AFTER THREE YEARS

NOTE INSTALL STAND PIPE ON SEPTIC TANK AND DRY WELL. STAND PIPES MUST BE 6 INCHES IN DIAMETER CAST IRON, CONCRETE OR TERRA COTTA, OR PVC OR ABS ACCEPTED IF TOP OF SEPTIC TANK IS DEEPER THAN 3 FEET MANHOLE TO GRADE REQUIRED

\*INSTALLER IS RESPONSIBLE FOR OBTAINING FINAL APPROVAL ON THIS PERMIT

\*CALL 992-2330 FOR INSPECTION OF SEPTIC SYSTEMS.

EH - 2-1082

A 17126

A 36203

# PERMIT

4/8/97  
 Proposal:  
 Add a 2 bedroom detached addition to the existing one bedroom house. There will be no need for repair or upgrade to the existing system. The builder was told to put his proposal in writing prior to applying for the BP ALM

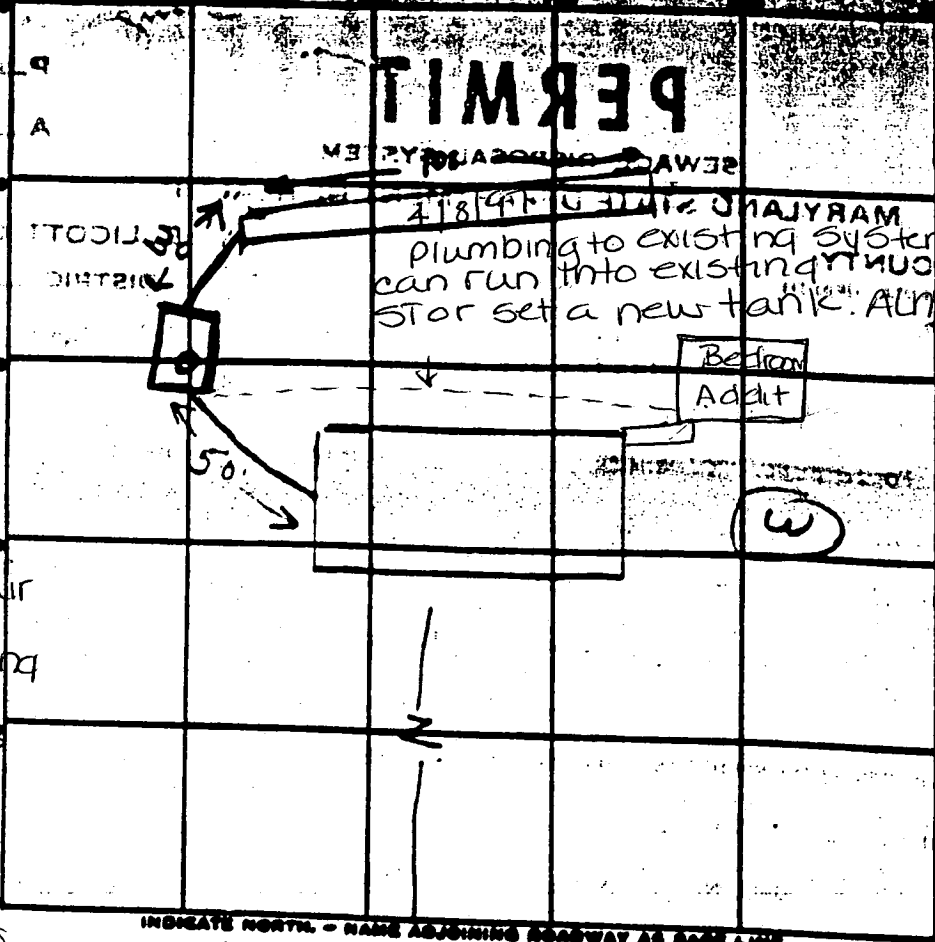

180  
 144  
 5720  
 5  
 22  
 20  
 70

INDICATE NORTH - NAME ADJOINING ROADWAY AS BASE LINE.

UNION CHAPEL

PERMIT CARD

SEPTIC TANK, LEVEL 1000 gal

CLEANOUTS ST

DISTRIBUTION BOX, LEVEL \_\_\_\_\_

TILE FIELD, DEPTH \_\_\_\_\_ FT. TRENCH WIDTH 2 FT.

GRAVEL DEPTH 5 IN. TOTAL LENGTH 108 FT.

NUMBER OF TRENCHES 1 TOTAL BOTTOM AREA 540

SEEPAGE PITS, INSIDE DIAMETER \_\_\_\_\_ FT. DEPTH BELOW INLET \_\_\_\_\_ FT.

ABSORBENT AREA \_\_\_\_\_ SQ. FT.

REMARKS 3/11/86 - 10' to 12' trench 10' deep and 40' long  
- 112/86 - 0' to 10' trench 10' deep

DATE SYSTEM APPROVED 3/17/86

INSPECTOR SE