

Building Address <u>13499 VillaDest DR.</u> <u>Highland Md.</u> Suite/Apt. #: _____ SDP/WP/Petition #: _____ Census Tract _____ Subdivision _____ Section _____ Area _____ EOT _____ Tax Map _____ Parcel _____ Grid _____ Zoning _____ Map Coordinates _____ Lot size _____	Property Owner's Name <u>Peng Chow</u> Address <u>13499 VillaDest Dr.</u> City <u>Highland</u> State <u>Md.</u> Zip Code <u>20777</u> Home Phone <u>443 677 8985</u> Work Phone _____ Applicant's Name & Mailing Address, (if other than stated hereon): _____ Phone _____ Fax _____
--	---

Existing Use <u>Residence</u> Proposed Use _____ Estimated Construction Cost \$ <u>812,000</u> Description of Work <u>Screen existing 10'x20' deck</u> <u>build additional 8x13' decks</u>	Contractor Company <u>moore Contracting LLC</u> Contact Person <u>Erick A. Moore</u> Address <u>6905 ALLVIEW DR.</u> City <u>Columbia</u> State <u>Md.</u> Zip Code <u>21046</u> License No. <u>26305</u> Phone <u>410-997-1405</u> Fax _____
--	--

Occupant or Tenant: _____ Contact Name: _____ Address: _____ City _____ State _____ Zip Code _____ Phone _____ Fax _____	Engineer or Architect Company _____ Contact Person _____ Address _____ City _____ State _____ Zip Code _____ Phone _____ Fax _____
--	--

BUILDING DESCRIPTION - <u>COMMERCIAL</u>		BUILDING DESCRIPTION - <u>RESIDENTIAL</u>									
<u>Building Characteristics</u> Height: _____ No. of stories: _____ Gross area, sq. ft. per floor: _____ Use group: _____ Construction type: <input type="checkbox"/> Reinforced Concrete <input type="checkbox"/> Structural Steel <input type="checkbox"/> Masonry <input type="checkbox"/> Wood Frame <input type="checkbox"/> State Certified Modular	<u>Utilities</u> Water Supply: <input type="checkbox"/> Public <input type="checkbox"/> Private Sewage Disposal: <input type="checkbox"/> Public <input type="checkbox"/> Private Electric Yes <input type="checkbox"/> No <input type="checkbox"/> Gas Yes <input type="checkbox"/> No <input type="checkbox"/> Heating System: Electric <input type="checkbox"/> Oil <input type="checkbox"/> Natural Gas <input type="checkbox"/> Propane Gas <input type="checkbox"/> Sprinkler system: N/A <input type="checkbox"/> <input type="checkbox"/> Full <input type="checkbox"/> Partial <input type="checkbox"/> Other Suppression # of Heads _____	<u>Building Characteristics</u> SF Dwelling <input checked="" type="checkbox"/> SF Townhouse <input type="checkbox"/> <table style="width:100%; border-collapse: collapse;"> <tr> <td style="text-align: center;">Depth</td> <td style="text-align: center;">Width</td> </tr> <tr> <td>1st floor: <u>32'</u></td> <td><u>39'</u></td> </tr> <tr> <td>2nd floor: <u>32'</u></td> <td><u>39'</u></td> </tr> <tr> <td>Basement: <u>32'</u></td> <td><u>39'</u></td> </tr> </table> Finished Basement <input checked="" type="checkbox"/> Unfinished Basement <input type="checkbox"/> Crawl space <input type="checkbox"/> Slab on Grade <input type="checkbox"/> No. of Bedrooms _____ Multi-family dwellings: No. of efficiency units: _____ No. of 1 BR units: _____ No. of 2 BR units: _____ No. of 3 BR units: _____ Other Structure: _____ Dimensions: _____ Footings: _____ Roof: _____ <input type="checkbox"/> State Certified Modular <input type="checkbox"/> Manufactured Home	Depth	Width	1st floor: <u>32'</u>	<u>39'</u>	2nd floor: <u>32'</u>	<u>39'</u>	Basement: <u>32'</u>	<u>39'</u>	<u>Utilities</u> Water Supply: <input type="checkbox"/> Public <input checked="" type="checkbox"/> Private Sewage Disposal: <input type="checkbox"/> Public <input checked="" type="checkbox"/> Private Electric Yes <input checked="" type="checkbox"/> No <input type="checkbox"/> Gas Yes <input type="checkbox"/> No <input type="checkbox"/> Heating System: Electric <input checked="" type="checkbox"/> Oil <input type="checkbox"/> Natural Gas <input type="checkbox"/> Propane Gas <input type="checkbox"/> Sprinkler system: N/A <input type="checkbox"/> <input type="checkbox"/> NFPA #13D <input type="checkbox"/> NFPA #13R <input type="checkbox"/> Other: _____
Depth	Width										
1st floor: <u>32'</u>	<u>39'</u>										
2nd floor: <u>32'</u>	<u>39'</u>										
Basement: <u>32'</u>	<u>39'</u>										

THE UNDERSIGNED HEREBY CERTIFIES AND AGREES AS FOLLOWS: (1) THAT HE/SHE IS AUTHORIZED TO MAKE THIS APPLICATION; (2) THAT THE INFORMATION IS CORRECT; (3) THAT HE/SHE WILL COMPLY WITH ALL REGULATIONS OF HOWARD COUNTY WHICH ARE APPLICABLE THERETO; (4) THAT HE/SHE WILL PERFORM NO WORK ON THE ABOVE REFERENCED PROPERTY NOT SPECIFICALLY DESCRIBED IN THIS APPLICATION; (5) THAT HE/SHE GRANTS COUNTY OFFICIALS THE RIGHT TO ENTER ONTO THIS PROPERTY FOR THE PURPOSE OF INSPECTING THE WORK PERMITTED AND POSTING NOTICES.

<u>Erick A. Moore</u> Applicant's Signature	<u>Erick A. Moore</u> Print Name
--	-------------------------------------

Title/Company _____ Date _____

Checks payable to: **DIRECTOR OF FINANCE OF HOWARD COUNTY**
**** PLEASE WRITE NEATLY AND LEGIBLY. ****
- FOR OFFICE USE ONLY -

AGENCY	DATE	SIGNATURE APPROVAL
Land Development, DPZ	10/5/06	<u>Debra A. Cyler</u>
State Highways		
Building Official		
Dev. Engineering, DPZ		
Health		
Fire Protection		

Is Sediment Control approval required prior to issuance?
 YES NO

CONTINGENCY CONSTRUCTION START:

ONE STOP SHOP:

DPZ SETBACK INFORMATION	PROPERTY ID#:
Front: _____	Filing fee \$ _____
Rear: _____	Permit fee \$ _____
Side: _____	Excise tax \$ _____
Side St.: _____	Add'l per. fee \$ _____
All minimum setbacks met? YES <input type="checkbox"/> NO <input type="checkbox"/>	TOTAL FEES \$ _____
Is Entrance Permit required? YES <input type="checkbox"/> NO <input type="checkbox"/>	Sub-total paid \$ _____
Historic District? YES <input type="checkbox"/> NO <input type="checkbox"/>	Balance due \$ _____
Lot Coverage for NewTown Zone _____	Check # _____
SDP/Red-line approval date _____	Validation # _____
	Accepted by _____

Distribution of Copies- White: Building Official Green: LDD, DPZ Yellow: DED, DPZ Pink: Health Gold: SHA

shown on the R.E.M.A.P. FROM
 Rate Map, Community-Panel
 No. 24009, revised 12.4.86
 0032B

9

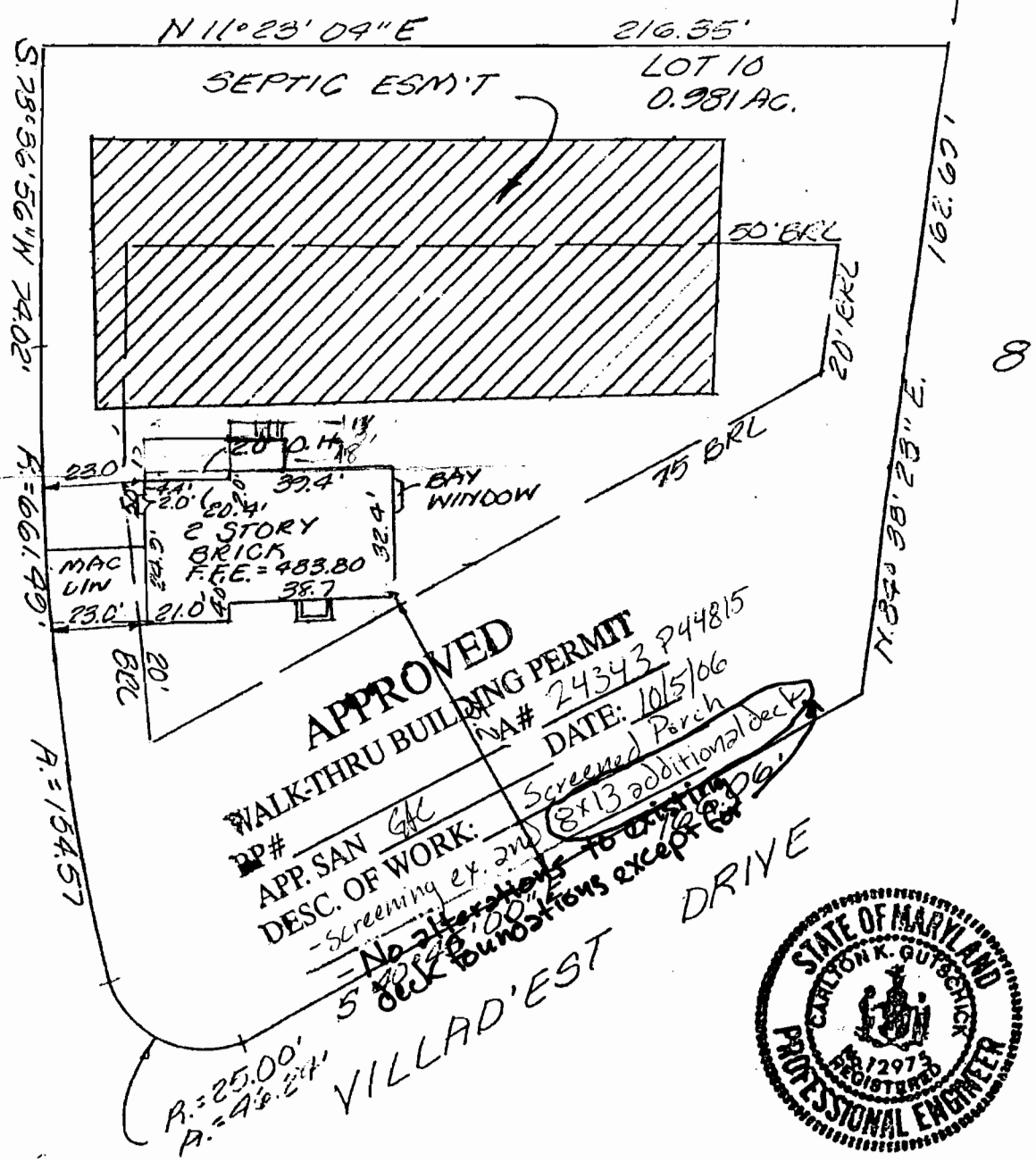

ENGINEERS CERTIFICATE

I hereby certify that the position of all existing improvements on the above described property have been carefully established by accepted field practices and that unless otherwise shown, there are no encroachments.

CK Gutserick 6-28-89
 10-30-89

GLW GUTSCHICK LITTLE & WEBER, P.A.
 ENGINEERS, PLANNERS, SURVEYORS
 3909 NATIONAL DRIVE · SUITE 250 · BURTONSVILLE OFFICE PARK
 BURTONSVILLE, MD. 20866
 TEL. (301) 421-4024

REFERENCE: PLAT BOOK _____ PLAT No. 4538

DRAWN BY: <i>lbj</i>	DATE: <u>6-28-89</u>	G.L.W. FILE NO.
CHECKED BY: <i>TOC/des</i>	SCALE: <u>1"=40'</u>	<u>87-093</u>