

SEQUENCE NO. (MDE USE ONLY)
 (THIS NUMBER IS TO BE PUNCHED IN COLS. 3-6 ON ALL CARDS)
 ST/CO USE ONLY DATE RECEIVED: **10/13/24**
 DATE WELL COMPLETED: **5/21/24**
 Depth of Well: **200** (TO NEAREST FOOT)
 PERMIT NO. FROM "PERMIT TO DRILL WELL": **HO-22-0125**

OWNER: **Williams Stephanie - Clover Luck Studios**
 WELL SITE ADDRESS: **4913 Manor Lane** TOWN: **Ellicott City**
 SUBDIVISION: _____ SECTION: _____ LOT: _____

WELL LOG
 Not required for driven wells

STATE THE KIND OF FORMATIONS PENETRATED, THEIR COLOR, DEPTH, THICKNESS AND IF WATER BEARING

DESCRIPTION (Use additional sheets if needed)	FEET		check if water bearing
	FROM	TO	
Clay	0	12	
Sand	12	40	
Gray Limestone	40	62	
Fractures	62	75	✓
Sand/Quartz	75	85	
White & Gray Limestone	85	120	
Yellow Sandstone	120	140	
Fracture	140	150	✓
Yellow Sandstone	150	170	
Fracture	170	175	✓
Gray Limestone	175	200	

GROUTING RECORD
 WELL HAS BEEN GROUTED (Circle Appropriate Box) **Y**
 TYPE OF GROUTING MATERIAL (Circle one)
 CEMENT **CM** BENTONITE CLAY **BC**
 NO. OF BAGS **20** NO. OF POUNDS **1000**
 GALLONS OF WATER **500**
 DEPTH OF GROUT SEAL (to nearest foot)
 from **0** ft. to **49** ft.
 (enter 0 if from surface)

CASING RECORD
 casing types insert appropriate code below
ST STEEL **CO** CONCRETE
PL PLASTIC **OT** OTHER
 MAIN CASING TYPE **ST** Nominal diameter top (main) casing (nearest inch): **6** Total depth of main casing (nearest foot): **51**

OTHER CASING (if used)
 diameter inch depth (feet) from to
3 _____

SCREEN RECORD
 screen type or open hole (insert appropriate code below)
ST STEEL **BR** BRASS **HO** OPEN HOLE
PL PLASTIC **OT** OTHER

NUMBER OF UNSUCCESSFUL WELLS: **0**

WELL HYDROFRACTURED **Y** **N**

CIRCLE APPROPRIATE LETTER
A A WELL WAS ABANDONED AND SEALED WHEN THIS WELL WAS COMPLETED
E ELECTRIC LOG OBTAINED
P TEST WELL CONVERTED TO PRODUCTION WELL

I HEREBY CERTIFY THAT THIS WELL HAS BEEN CONSTRUCTED IN ACCORDANCE WITH COMAR 26.04.04 "WELL CONSTRUCTION" AND IN CONFORMANCE WITH ALL CONDITIONS STATED IN THE ABOVE CAPTIONED PERMIT, AND THAT THE INFORMATION PRESENTED HEREIN IS ACCURATE AND COMPLETE TO THE BEST OF MY KNOWLEDGE.

DRILLERS LIC. NO.: **M 5 D 224**
 DRILLERS SIGNATURE: _____
 (MUST MATCH SIGNATURE ON APPLICATION)

LIC. NO.: **D**

SITE SUPERVISOR (sign. of driller or journeyman responsible for sitework if different from permittee)

DEPTH (nearest ft.)
ST **53** **200**
E A C H S C R E E N
 1 9 11 15 17 21
 2 23 24 26 30 32 36
 3 38 39 41 45 47 51
 SLOT SIZE 1 **1/8"** 2 _____ 3 _____
 DIAMETER OF SCREEN **5** (NEAREST INCH)
 from _____ to _____

GRAVEL PACK IF WELL DRILLED _____
 WAS FLOWING WELL INSERT F IN BOX 68 _____

MDE USE ONLY (NOT TO BE FILLED IN BY DRILLER)
 T _____ (E.R.O.S.) W Q _____

70 _____ 72 _____ 74 75 76 _____
 TELESCOPE CASING LOG INDICATOR OTHER DATA

PUMPING TEST
 HOURS PUMPED (nearest hour) **3**
 PUMPING RATE (gal. per min.) **15***
 METHOD USED TO MEASURE PUMPING RATE **log**
 WATER LEVEL (distance from land surface)
 BEFORE PUMPING **29** ft.
 WHEN PUMPING **42** ft.
 TYPE OF PUMP USED (for test)
A air **P** piston **T** turbine
C centrifugal **R** rotary **O** other (describe below)
J jet **S** submersible

PUMP INSTALLED
 DRILLER INSTALLED PUMP YES **NO**
 IF DRILLER INSTALLS PUMP, THIS SECTION MUST BE COMPLETED FOR ALL WELLS.
 TYPE OF PUMP INSTALLED PLACE (A,C,J,P,R,S,T,O) IN BOX 29: **29**
 CAPACITY: GALLONS PER MINUTE (to nearest gallon) 31 _____ 35 _____
 PUMP HORSE POWER 37 _____ 41 _____
 PUMP COLUMN LENGTH (nearest ft.) 43 _____ 47 _____
 CASING HEIGHT (circle appropriate box and enter casing height)
+ above } LAND SURFACE
- below } **2** (nearest foot)

LATITUDE **39.241050**
 LONGITUDE **76.886599**
 (DEFAULT COORD. WGS 84)

Pursuant to §10-624 of the State Govt. Article of the Maryland Code personal info. requested on this form is used in processing this form pursuant to COMAR 26.04.04. Failure to provide the info. may result in this form not being processed. You have the right to inspect, amend, or correct this form. The Maryland Department of the Environment is subject to the Maryland Public Information Act. This form may be made available on the Internet via MDE's website and is subject to inspection or copying, in whole or in part, by the public and other governmental agencies, if not protected by federal or state law.

B 1	SEQUENCE NO. (MDE USE ONLY)	STATE OF MARYLAND APPLICATION FOR PERMIT TO DRILL WELL please type	STATE PERMIT NUMBER H0-22-0125 <small>70 fill in this form completely 79</small>
1 2 3 4 5 6	OWNER INFORMATION 8 MM DD YY 13 <u>Williams, Stephanie - Clover Luck Stables</u> 15 Last Name Owner First Name 34 <u>4713 Manor Lane</u> 36 Street or RFD 55 <u>Ellicott City Md. 21042</u> 57 Town 70 State 72 Zip 76		B 3 LOCATION OF WELL <u>Howard</u> 8 COUNTY 21 23 SUBDIVISION 42 SECTION 44 46 LOT 48 50 <u>Ellicott City</u> 52 NEAREST TOWN 71
DRILLER INFORMATION <u>Andrew Housenken M S O 224</u> Driller's Name 76 License No. 81 <u>Fogles Well Drilling, LLC</u> Firm Name <u>P.O. Box 202 Woodbine Md 21797</u> Address <u>[Signature]</u> 2-22-24 Signature Date		B 4 SOURCES OF DRILLING WATER 1. Well water 2. 5/16/2024 - 3. Drilled well At 113' set 50' casing hit rock @ 40'. Driller setting liner due to void.	
B 2	WELL INFORMATION APPROX. PUMPING RATE <u>5</u> (GAL. PER MIN.) 8 12 AVERAGE DAILY QUANTITY NEEDED <u>500</u> (GAL. PER DAY) 14 20		ON WHICH SIDE OF ROAD (CIRCLE APPROPRIATE BOX) NORTH <input type="checkbox"/> N <input checked="" type="checkbox"/> S <input type="checkbox"/> E <input type="checkbox"/> W SOUTH 34 1000 37 DISTANCE FROM ROAD ENTER FT OR MI 38 39 <u>FT</u> TAX MAP: <u>29</u> BLK: <u>5</u> PARCEL <u>8</u>
USE FOR WATER (CIRCLE APPROPRIATE BOX) <input type="checkbox"/> D DOMESTIC POTABLE SUPPLY & RESIDENTIAL IRRIGATION <input checked="" type="checkbox"/> F FARMING (LIVESTOCK WATERING & AGRICULTURAL IRRIGATION) <input type="checkbox"/> I INDUSTRIAL, COMMERCIAL, DEWATERING <input type="checkbox"/> P PUBLIC WATER SUPPLY WELL <input type="checkbox"/> T TEST, OBSERVATION, MONITORING <input type="checkbox"/> O OPEN LOOP GEOTHERMAL <input type="checkbox"/> C CLOSED LOOP GEOTHERMAL		NOT TO BE FILLED IN BY DRILLER HEALTH DEPARTMENT APPROVAL <u>Howard</u> 13 COUNTY NAME COUNTY NO. STATE SIGNATURE INSERT S → DATE ISSUED <u>4/14/2024</u> <u>84-24</u> <u>4/14/2025</u> 43 MM DD YY 48 CO SIGNATURE EXP. DATE	
APPROXIMATE DEPTH OF WELL <u>300</u> FEET 24 28		APPROXIMATE DIAMETER OF WELL <u>6</u> INCH NEAREST	
METHOD OF DRILLING (circle one) BORED (or Augered) JETTED Jetted & DRIVEN 30 <input checked="" type="checkbox"/> AIR-ROTARY AIR-PERCussion ROTARY (Hydraulic Rotary) 37 <input type="checkbox"/> CABLE REVERSE-ROTARY DRIVE-POINT other _____			
REPLACEMENT OR DEEPEMED WELLS (CIRCLE APPROPRIATE BOX) <input checked="" type="checkbox"/> N THIS WELL WILL NOT REPLACE AN EXISTING WELL <input type="checkbox"/> Y THIS WELL WILL REPLACE A WELL THAT WILL BE ABANDONED AND SEALED 39 <input type="checkbox"/> S THIS WELL WILL REPLACE A WELL THAT WILL BE USED AS A STANDBY-CONTACT LOCAL APPROVING AUTHORITY FOR POLICY ON STANDBY WELLS <input type="checkbox"/> D THIS WELL WILL DEEPEAN AN EXISTING WELL PERMIT NUMBER OF WELL TO BE REPLACED OR DEEPEMED (IF AVAILABLE) 41 _____ 52 (conf)			
Not to be filled in by driller (MDE OR COUNTY USE ONLY) APPROP. PERMIT NUMBER _____ <u>G</u> _____ PERMIT No. <u>H0-22-0125</u> 70 71 72 73 74 75 76 77 78 79			
SPECIAL CONDITIONS <small>NOTE APPROVING AUTHORITIES SHOULD USE SEPARATE SHEET IF NEEDED</small>			

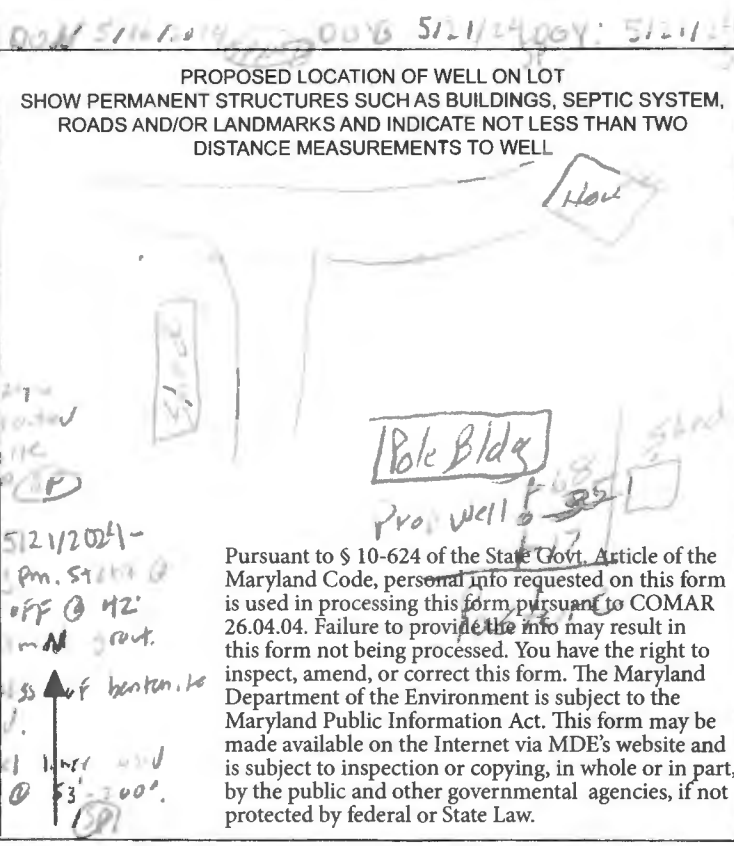

4713 Manor Ln

Well SAE
Approved
8/1/2024

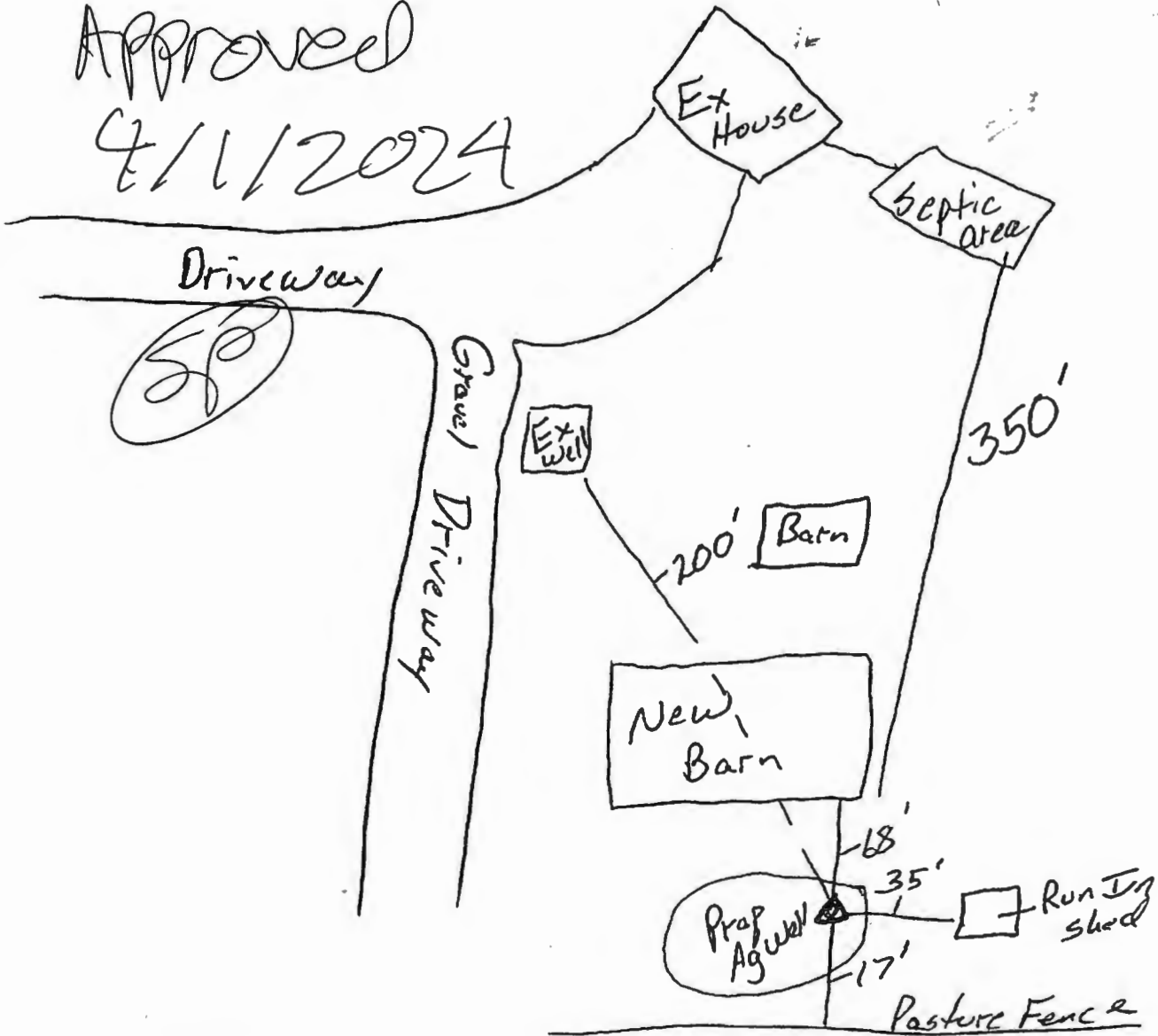

DO NOT REMOVE THIS TAG
DEPARTMENT OF THE ENVIRONMENT
WELL PERMIT NUMBER

HO-22-0125

INFORMATION - GIVE NUMBER AND WRITE
1800 WASHINGTON BLVD
BALTIMORE MARYLAND 21230



Bureau of Environmental Health

8930 Stanford Boulevard, Columbia, MD 21045 Main: 410-313-2640 | Fax: 410-313-2648 TDD 410-313-2323 | Toll Free 1-866-313-6300 www.hchealth.org

Facebook: www.facebook.com/hocohealth

Twitter: HowardCoHealthDep

Dr. Maura J. Rossman, M.D., Health Officer

TO ALL INTERESTED PARTIES

When submitting a well permit application for a proposed well for new construction, please indicate one of the following:

Well Site Location:

_____ 4913 Manor Lane
Subdivision/Property Name Lot # Road Name

The well site has been staked by _____
(professional land surveyor or company employing professional land surveyors)
on _____ (date) and does not require a site inspection.

The well driller, builder or property owner will call the Health Department to schedule a time to meet in the field to verify the proposed well site location.
Andy Staked well 2/20/24 - let me know if he needs to meet on site

This sheet, along with two copies of an acceptable well site plan, must be attached to the green well permit application.

RECEIPT

Howard County, MD
HOWARD COUNTY HEALTH DEPARTMENT
ASCEND ONE BUILDING
Columbia, MD 21045
8930 STANFORD BLVD

Application: WS-WP-24-00483
Application Type: EnvHealth/Well and Septic/Installation/Application
Address: 4713 Manor LN, Ellicott City, MD 21042

Receipt No.	Ref Number	Amount Paid	Payment Date	Cashier ID	Received	Comments
8998	014465	\$160.00	02/27/2024	ATAYLOR		

Owner Info.: William & Stephanie -Clover Luck Stables
4713 Manor Lane
Ellicott City, MD 21042

Work Description:

Page, Shepsura

From: CloverLuck Stables <cloverluckstables@gmail.com>
Sent: Monday, April 1, 2024 3:50 PM
To: Page, Shepsura
Subject: Re: 4713 Manor Lane Appropriations Permit

[Note: This email originated from outside of the organization. Please only click on links or attachments if you know the sender.]

Thank you!

Our water usage will be less than 10,000 gpd.

Let me know if you need that information confirmed by Howard Soil Conservation as well.

On Mon, Apr 1, 2024 at 3:48 PM Page, Shepsura <spage@howardcountymd.gov> wrote:

Stephanie,

Great! I was just about to reach out for updates. Do you mind sending an email stating your water usage is to be less than 10,000 gpd.

Your permit is currently still under review, I've just emailed Fogles asking for revisions to the well site plan.

Thanks,

Shepsura Page, EH Specialist

Well & Septic Program

Howard County Health Department

8930 Stanford Blvd.

Columbia, MD 21045

410-313-1789 (Office)

410-313-2648 (Fax)

www.hchealth.org

spage@howardcountymd.gov



twitter.com/HoCoHealth



facebook.com/HoCoHealth



instagram.com/hocohealth

CONFIDENTIALITY NOTICE

This message and the accompanying documents are intended only for the use of the individual or entity to which they are addressed and may contain information that is privileged, confidential, or exempt from disclosure under applicable law. If the reader of this email is not the intended recipient, you are hereby notified that you are strictly prohibited from reading, disseminating, distributing, or copying this communication. If you have received this email in error, please notify the sender immediately and destroy the original transmission.

From: CloverLuck Stables <cloverluckstables@gmail.com>
Sent: Monday, April 1, 2024 3:33 PM
To: Page, Shepsura <spage@howardcountymd.gov>
Subject: Re: 4713 Manor Lane Appropriations Permit

[Note: This email originated from outside of the organization. Please only click on links or attachments if you know the sender.]

Hi there-

I wanted to check on the status of the permit. We will not need the appropriations permit. Let me know if any additional information is needed.

Thanks in advance,

Stephanie

--

Stephanie Williams, Owner/Trainer

Clover Luck Stables

www.cloverluckstables.com

On Tue, Mar 5, 2024 at 8:21 AM Page, Shepsura <spage@howardcountymd.gov> wrote:

Morning Stephanie,

Thank you for the updates. I'll note the use for your permit and will wait on info for the appropriations permit.

Thanks,

Shepsura Page, EH Specialist

Well & Septic Program

Howard County Health Department

8930 Stanford Blvd.

Columbia, MD 21045

410-313-1789 (Office)

410-313-2648 (Fax)

www.hchealth.org

spage@howardcountymd.gov





twitter.com/HoCoHealth



facebook.com/HoCoHealth



instagram.com/hocohealth

CONFIDENTIALITY NOTICE

This message and the accompanying documents are intended only for the use of the individual or entity to which they are addressed and may contain information that is privileged, confidential, or exempt from disclosure under applicable law. If the reader of this email is not the intended recipient, you are hereby notified that you are strictly prohibited from reading, disseminating, distributing, or copying this communication. If you have received this email in error, please notify the sender immediately and destroy the original transmission.

From: CloverLuck Stables <cloverluckstables@gmail.com>

Sent: Monday, March 4, 2024 3:23 PM

To: Page, Shepsura <spage@howardcountymd.gov>

Subject: Re: 4713 Manor Lane Appropriations Permit

[Note: This email originated from outside of the organization. Please only click on links or attachments if you know the sender.]

Hi Shep-

Thanks for the email. The main use is for horses drinking water; secondary use would be bathing horses. I cannot imagine we use more than 10,000 gallons per day, but I am going to confirm with the engineer from Soil Conservation that designed the plans.

Best,

Stephanie

On Fri, Mar 1, 2024 at 1:59 PM Page, Shepsura <spage@howardcountymd.gov> wrote:

Hey Stephanie,

Thanks for showing me around your property today. The groundwater appropriations permit is required if you plan on using more than 10,000 gallons a day. Are you using more than 10,000 gal/day? If so, please fill out the attached form. Also, is the intended use of the well just for the horses drinking water? I just need to note its use for your file.

Thanks,

Shepsura Page, EH Specialist

Well & Septic Program

Howard County Health Department

8930 Stanford Blvd.

Columbia, MD 21045

410-313-1789 (Office)

410-313-2648 (Fax)

www.hchealth.org

spage@howardcountymd.gov



twitter.com/HoCoHealth



facebook.com/HoCoHealth



instagram.com/hocohealth

CONFIDENTIALITY NOTICE

This message and the accompanying documents are intended only for the use of the individual or entity to which they are addressed and may contain information that is privileged, confidential, or exempt from disclosure under applicable law. If the reader of this email is not the intended recipient, you are hereby notified that you are strictly prohibited from reading, disseminating, distributing, or copying this communication. If you have received this email in error, please notify the sender immediately and destroy the original transmission.

--

Stephanie Williams, Owner/Trainer

Clover Luck Stables

www.cloverluckstables.com

--

Stephanie Williams, Owner/Trainer

Clover Luck Stables

www.cloverluckstables.com

Page, Shepsura

From: Page, Shepsura
Sent: Friday, March 1, 2024 2:48 PM
To: Theresa Miller; Wolf, Kevin
Subject: RE: 4713 Manor Lane | Well permit
Attachments: 4713 Manor Hill Prop.pdf; 4713 Manor Hill Septic System.pdf

Hey Theresa,

Here's a aerial picture of 4713 Manor Ln that Andy can use. I've also included a copy of the current septic system location.

I've talked with the owner about the appropriations permit, she should be getting back to me soon about how many gallons a day they'll need.

Thanks,

Shepsura Page, EH Specialist
Well & Septic Program
Howard County Health Department
8930 Stanford Blvd.
Columbia, MD 21045
410-313-1789 (Office)
410-313-2648 (Fax)
www.hchealth.org
spage@howardcountymd.gov



twitter.com/HoCoHealth



facebook.com/HoCoHealth



instagram.com/hocohealth

CONFIDENTIALITY NOTICE

This message and the accompanying documents are intended only for the use of the individual or entity to which they are addressed and may contain information that is privileged, confidential, or exempt from disclosure under applicable law. If the reader of this email is not the intended recipient, you are hereby notified that you are strictly prohibited from reading, disseminating, distributing, or copying this communication. If you have received this email in error, please notify the sender immediately and destroy the original transmission.

From: Theresa Miller <Theresa@foglesinc.com>
Sent: Thursday, February 29, 2024 12:03 PM

To: Wolf, Kevin <KWolf@howardcountymd.gov>
Cc: Page, Shepsura <spage@howardcountymd.gov>
Subject: RE: 4713 Manor Lane | Well permit

[Note: This email originated from outside of the organization. Please only click on links or attachments if you know the sender.]

Andy has hand drawn the sitesorry!!! I will watch for that from Shep and have Andy take care of it for me and I will get it over to you.

Do you need me to find out how many gallons a day they will need?

From: Wolf, Kevin <KWolf@howardcountymd.gov>
Sent: Thursday, February 29, 2024 12:00 PM
To: Theresa Miller <Theresa@foglesinc.com>
Cc: Page, Shepsura <spage@howardcountymd.gov>
Subject: RE: 4713 Manor Lane | Well permit

It can be hand drawn. You can also use an existing plat that the owners might have. I can have Shep send you an aerial of the property too if that will help. She is in the field but can send it to you when she gets back in the office.

We have always needed some kind of a site plan for all well permit applications. New construction are more detailed oriented because they are usually accompanied with an engineer. Let me know what you come up with.

Kevin

From: Theresa Miller <Theresa@foglesinc.com>
Sent: Thursday, February 29, 2024 11:56 AM
To: Wolf, Kevin <KWolf@howardcountymd.gov>
Cc: Page, Shepsura <spage@howardcountymd.gov>
Subject: RE: 4713 Manor Lane | Well permit

[Note: This email originated from outside of the organization. Please only click on links or attachments if you know the sender.]

Really? We do not usually have a site plan for replacement Wells and Andy just takes the measurements. So they are going have to hire a surveyor to do a site plan with the AG Well location on it?

From: Wolf, Kevin <KWolf@howardcountymd.gov>
Sent: Thursday, February 29, 2024 11:46 AM
To: Theresa Miller <Theresa@foglesinc.com>
Cc: Page, Shepsura <spage@howardcountymd.gov>
Subject: RE: 4713 Manor Lane | Well permit

Yes, Clover Luck Stables I believe is correct. We would require the site plan showing all details of the lot, similar to a replacement well.

From: Theresa Miller <Theresa@foglesinc.com>
Sent: Thursday, February 29, 2024 11:19 AM
To: Wolf, Kevin <KWolf@howardcountymd.gov>
Subject: RE: 4713 Manor Lane | Well permit

[Note: This email originated from outside of the organization. Please only click on links or attachments if you know the sender.]

Hi Kevin. Are you talking about Clover Luck Stables on Manor Lane? It is for the horses but I will have to ask about gallons per day use. I don't believe there is a site plan. Do they need one?

From: Wolf, Kevin <KWolf@howardcountymd.gov>
Sent: Thursday, February 29, 2024 10:28 AM
To: Theresa Miller <Theresa@foglesinc.com>
Cc: Page, Shepsura <spage@howardcountymd.gov>
Subject: 4713 Manor Lane | Well permit

Theresa,
We received this well permit for an irrigation well. Do you have a site plan showing the location? Can you tell me what they need this well for and for how much gallons per day use?

Thanks,

Kevin M. Wolf, LEHS, REHS/RS
Groundwater Mgmt. Sec. Supervisor
Well & Septic Program
Howard County Health Department
8930 Stanford Blvd.
Columbia, MD 21045
410-313-2645 (Office)
410-313-2648 (Fax)
www.hchealth.org
kwolf@howardcountymd.gov



twitter.com/HoCoHealth



facebook.com/HoCoHealth



instagram.com/hocohealth

CONFIDENTIALITY NOTICE

This message and the accompanying documents are intended only for the use of the individual or entity to which they are addressed and may contain information that is privileged, confidential, or exempt from disclosure under applicable law. If the reader of this email is not the intended recipient, you are hereby notified that you are strictly prohibited from reading, disseminating, distributing, or copying this communication. If you have received this email in error, please notify the sender immediately and destroy the original transmission.

Page, Shepsura

From: Page, Shepsura
Sent: Friday, March 1, 2024 2:00 PM
To: cloverluckstables@gmail.com
Cc: Wolf, Kevin
Subject: 4713 Manor Lane Appropriations Permit
Attachments: Groundwater Appropriation Permit.pdf

Hey Stephanie,

Thanks for showing me around your property today. The groundwater appropriations permit is required if you plan on using more than 10,000 gallons a day. Are you using more than 10,000 gal/day? If so, please fill out the attached form. Also, is the intended use of the well just for the horses drinking water? I just need to note its use for your file.

Thanks,

Shepsura Page, EH Specialist
Well & Septic Program
Howard County Health Department
8930 Stanford Blvd.
Columbia, MD 21045
410-313-1789 (Office)
410-313-2648 (Fax)
www.hchealth.org
spage@howardcountymd.gov



twitter.com/HoCoHealth



facebook.com/HoCoHealth



instagram.com/hocohealth

CONFIDENTIALITY NOTICE

This message and the accompanying documents are intended only for the use of the individual or entity to which they are addressed and may contain information that is privileged, confidential, or exempt from disclosure under applicable law. If the reader of this email is not the intended recipient, you are hereby notified that you are strictly prohibited from reading, disseminating, distributing, or copying this communication. If you have received this email in error, please notify the sender immediately and destroy the original transmission.