

Bureau of Environmental Health
8930 Stanford Boulevard, Columbia, MD 21045
Main: 410-313-2640 | Fax: 410-313-2648
TDD 410-313-2323 | Toll Free 1-866-313-6300
www.hchealth.org
Facebook: www.facebook.com/hocohealth

Maura J. Rossman, M.D., Health Officer

RECEIPT DATE: 3/11/2024 ONSITE SEWAGE DISPOSAL SYSTEM P 586608
APPROVAL DATE: 4/23/24 PERMIT: REPAIR A
PROPERTY ADDRESS: 6726 Montell Court
SUBDIVISION: Green Hill Manor LOT: 3 TAX ID: 05-343143
CONTRACTOR: Hatfield's Equipment EMAIL: Ken@harfieldsequipment.com
CONTRACTOR ADDRESS: PO Box 519 Annapolis Junction PHONE: 410-984-4880

PROPERTY OWNER: Christopher Fridlund EMAIL: chrisfridlund@yahoo.com
OWNER ADDRESS: Same as above PHONE: 301-395-6637

SEPTIC TANK SIZE: 1500g PUMP SIZE: n/a PUMP TANK CAPACITY: n/a

DISTRIBUTION SYSTEM: [X] GRAVITY [] LPD BEDROOMS: 4 APPLICATION RATE: 1.2

Table with 2 columns: Field Name, Value. Includes TRENCHES (Linear feet required: 84, Inlet depth: 3.5), LOCATION (System staked by installer...), and NOTES (Install system per approved design plans...).

ISSUED BY: Kevin M. Wolf, L.E.H.S. ISSUE DATE: 3/14/2024 EXPIRATION DATE: 3/14/2025

- NOTE: CONTRACTOR MUST SCHEDULE A PRE-CONSTRUCTION INSPECTION PRIOR TO BEGINNING ANY INSTALLATION
NOTE: CONTRACTOR REGISTERED WITH THE STATE OF MD ON-SITE WASTEWATER PROFESSIONALS BOARD: CONFIRMED [X]
NOTE: CONTRACTOR MUST SCHEDULE AN INSPECTION AND GAIN APPROVAL OF ALL COMPONENTS PRIOR TO COVERING
NOTE: STONE MUST BE APPROVED BY HEALTH DEPARTMENT AND GRAVEL TICKET MUST BE AVAILABLE FOR REVIEW.
NOTE: WATERTIGHT SEPTIC TANKS REQUIRED
NOTE: ALL PARTS OF SEPTIC SYSTEM SHALL BE AT LEAST 100 FEET DOWNGRADIENT FROM ANY WATER WELL
NOTE: MANHOLE RISERS REQUIRED ON ALL SEPTIC TANKS AND PUMP CHAMBERS
NOTE: AN ELECTRICAL PERMIT IS REQUIRED FOR INSTALLATION OF ANY ELECTRICAL COMPONENTS OF THE SYSTEM
[X] ELECTRICAL PERMIT ISSUED E n/a
NOTE: THE HCHD DOES NOT WARRANTY ANY SYSTEM AND CANNOT GUARANTEE THE PERFORMANCE OF THIS SYSTEM AS DESIGNED. BY ACCEPTING THIS PERMIT, THE OWNER AND/OR APPLICANT ACKNOWLEDGE THAT THE SPECIFICATIONS DETAILED IN THIS DESIGN ARE ONE POSSIBLE OPTION AND THAT THE HCHD WILL REVIEW OTHER PROPOSALS. YOU HAVE THE OPTION TO SEEK THE ADVICE OF A QUALIFIED DESIGN CONSULTANT OR PROFESSIONAL ENGINEER FOR FURTHER GUIDANCE.
NOTE: AN INDIVIDUAL CERTIFIED BY MDE AND THE MANUFACTURER FOR BAT INSTALLATION MUST BE PRESENT AT ALL TIMES DURING BAT INSTALLATION.
NOTE: MDE RECOMMENDS SEPTIC TANKS, BAT, AND OTHER PRETREATMENT UNITS BE PUMPED AT A FREQUENCY ADEQUATE TO ENSURE THAT SOLIDS ARE NOT DISCHARGED TO THE DISPOSAL AREA

NEITHER THE HOWARD COUNTY COUNCIL NOR THE HEALTH DEPARTMENT IS RESPONSIBLE FOR THE SUCCESSFUL OPERATION OF ANY SYSTEM.
PERMITTEE RESPONSIBLE FOR OBTAINING FINAL APPROVAL ON THIS PERMIT.
CALL 410-313-1771 TO SCHEDULE INSPECTIONS.

- Montell Ct -

NOT TO SCALE

Ex. Drilled well

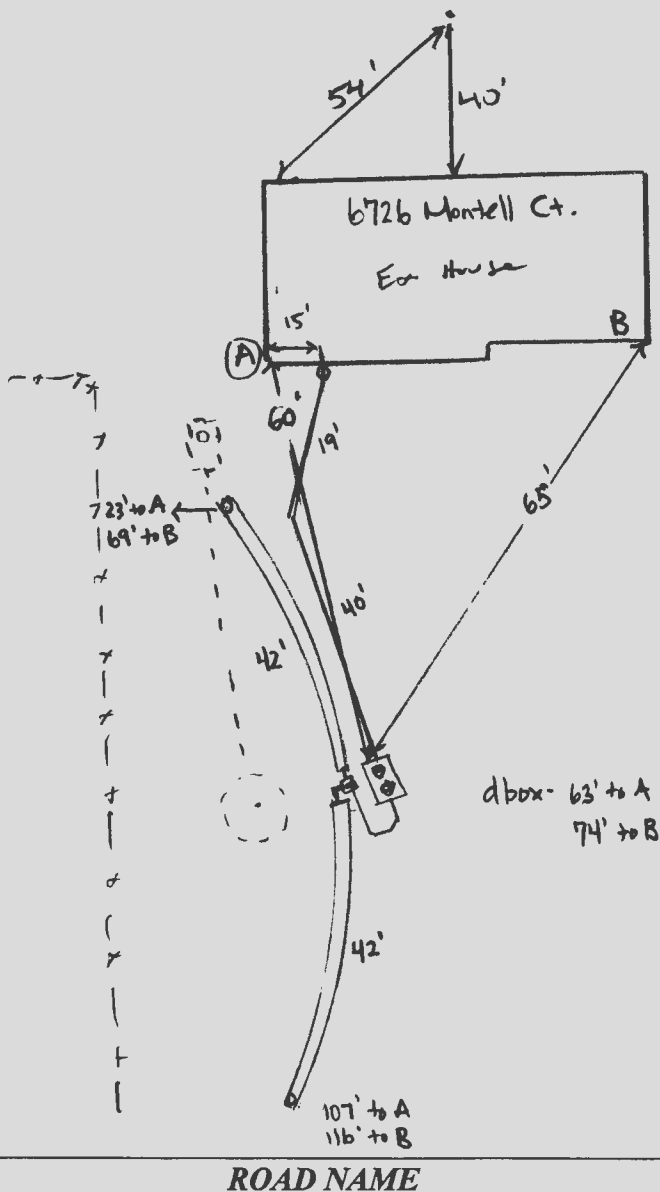

TRENCH/DRAINFIELD DATA

WIDTH	INLET	BOTTOM
3'	3.5'	8'
NUMBER OF TRENCHES		2
TOTAL LENGTH		84'
ABSORPTION AREA		252 sqft + sidewall
DISTRIBUTION BOX LEVEL		yes
DISTRIBUTION BOX BAFFLE		yes
DISTRIBUTION BOX PORT		yes

SEPTIC TANK DATA

SEPTIC TANK 1 LEVEL	yes
MANUFACTURER	Babylon
CAPACITY	1500 GAL
SEAM LOC	top
TANK LID DEPTH	3'
BAFFLES	6" front / 4" back
BAFFLE FILTER	-
MANHOLE LOC	front / back
6" PORT LOC	-
WATERTIGHT TEST	-
SLOTTED	yes
DATE ON LID	3/21/24

PUMP/SEPTIC TANK LEVEL

MANUFACTURER	
CAPACITY	GAL
SEAM LOC	
TANK LID DEPTH	
BAFFLES	
BAFFLE FILTER	
MANHOLE LOC	
6" PORT LOC	
WATERTIGHT TEST	
SLOTTED	
DATE ON LID	

SEPTIC CONTRACTOR ONSITE INSTALLING SYTEM: Nathan Heath (Hatfields)
SEPTIC CONTRACTOR ONSITE LICENSED WITH THE STATE OF MD: YES/NO

PRE-CONSTRUCTION NOTES:

3/11/2024 Permit paid for, plans approved 3/14/2024

CONTROL PANEL DATA

CONTROL PANEL HEIGHT	
(MIN 30")	
INSPECTION DATE	
INSPECTION: PASS/FAIL (CIRCLE ONE)	

INSTALLATION NOTES:

4/22/24 - contractor onsite, stone delivery in process. Stone looks ok & freshly washed, sewer line contracted, septic tank installed, baffles/risers ok, 3' cover, dbox and one trench complete, inlet @ 3.5', geo textile fabric & stone in place, obs. port installed at end of trench, ok to backfill & continue. 4/23/24 - dbox levelers look good, dbox w/ obs port & 2nd trench completed w/ fabric stone, obs port, 3.5' inlet, contractor pumping out the drywell during inspection, drywell & ST collapsed and filled in w/ stone & clean fill. Soils are consistent w/ perc data, ok to backfill. (initials)

FINAL INSPECTOR R. Rappaport DATE OF APPROVAL 4/23/24

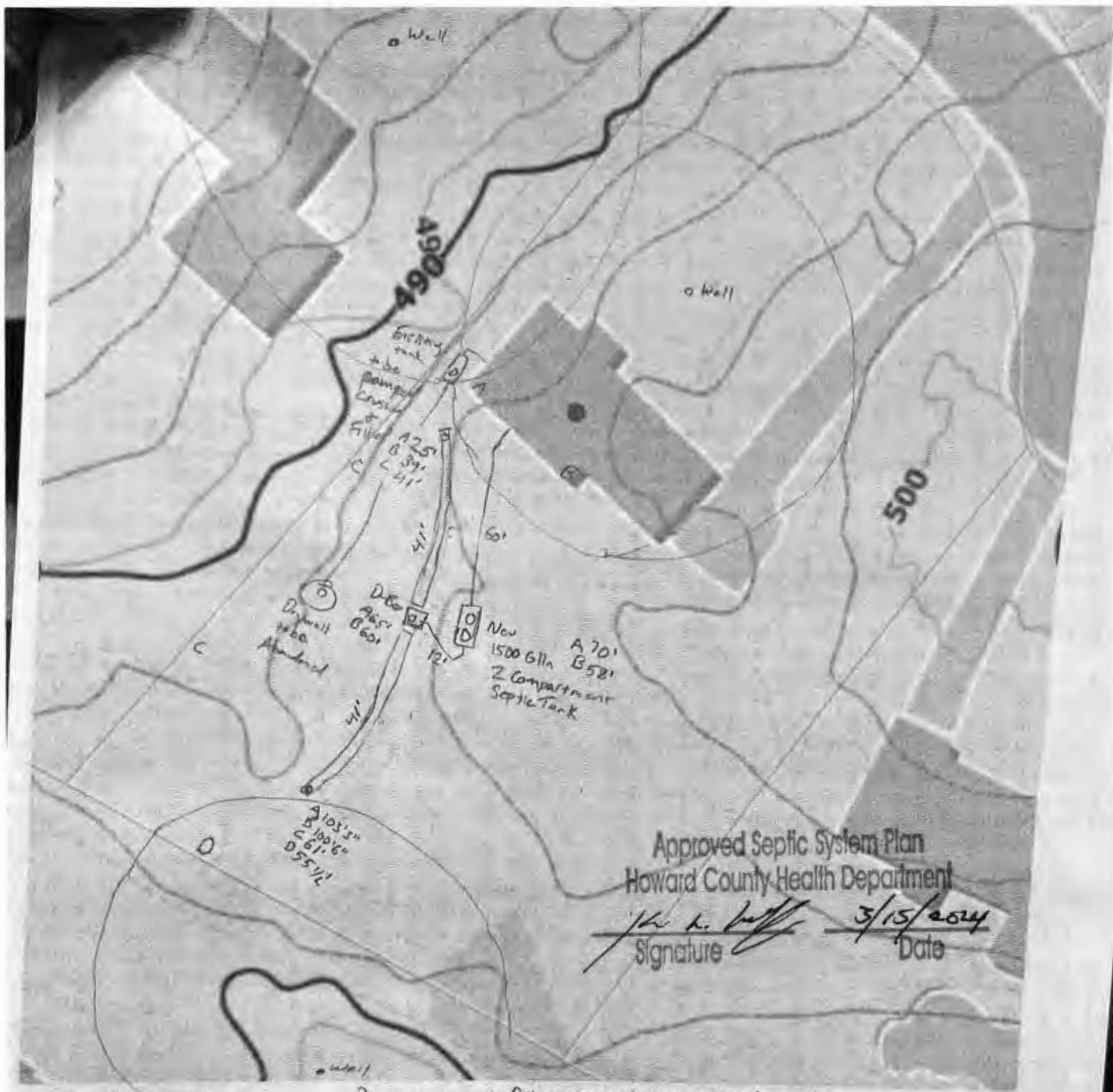

Approved Septic System Plan
Howard County Health Department

[Signature]
Signature

3/15/2024
Date

6726 Montell Court
Highland, MD 20777

- Pump, crush and fill existing septic tank & Drywell
- New 1500gln 2 Comp. Septic tank
- New Distribution Box
- 2 trenches 41' minus 3' buffer for D-Box
- 3' wide
- 3.5 to 4' Inlet
- 8' Bottom
- New 5/4\"/>

Emailed to
Kerin Wolf
on 1-26-24
-Paldon 3-11-2024

Hatfields Equipment

6726 Montell Ct. 4/23/24

{ - Septic tank collapsed
- dry well pumped out
} both to be filled in w/
Stone & Clean fill.





HOWARD COUNTY HEALTH DEPARTMENT

75746

P5115

DATE
12/2/26

Received From

Hutfields

PHONE #

301 490-4207

For

Repair/Peric 6/26
Montell Ct.

CASH

CHECK

NO.

4481

Two hundred fifty-five

Dollars

\$

2105100

Received By

King