

11/10/87 11 AM

PERMIT

SEWAGE DISPOSAL SYSTEM

MARYLAND STATE DEPARTMENT OF HEALTH*

P 40399

A 31273

DISTRICT 4th

HOWARD COUNTY

BUREAU OF ENVIRONMENTAL HEALTH

461-9933

DATE 11/04/87

DATE SYSTEM APPROVED 11/10/87

INSPECTOR *C. W. [signature]*

INDEXED

TAX ID# 04-345734

Fogles Septic

IS PERMITTED TO INSTALL ☒ ALTER ☐

ADDRESS 6430 Woodbine Road, Woodbine, Maryland 21797 PHONE 795-5670

SUBDIVISION Patapsco Overlook ROAD 751 Weller Drive LOT 42, Sec. 2

PROPERTY OWNER Joseph Spurrier

BUILDING PERMIT SIGNED

ADDRESS _____

AND RETURNED

IF GARBAGE GRINDER IS USED INCREASE SEPTIC TANK CAPACITY BY 50% AND ABSORPTION AREA BY 22%.

3-1-04 800146279 - BRKST RM + Family Rm

101581 800150615 - UG LP TANK

5-4-05 800153544 - DECK

GARBAGE GRINDER? YES ☐ NO ☒

SEPTIC TANK CAPACITY 1000 GALLONS NUMBER OF BEDROOMS 3

TRENCHES - 194 sq. ft. per bedroom. Trench to be 3 feet wide. Inlet maximum 2½ feet below original grade. Bottom maximum depth 4½ feet below original grade. Effective area begins at 2½ feet below original grade. 2 feet of stone below distribution pipe.

LOCATION - SHALLOW SYSTEM ONLY (Due to fractured rock) Beginning with the left front lot corner, start 1st trench 475' down the left (661.10') lot line and 100 feet off the left lot line as seen when facing property from Weller Drive. Run trenches along contour towards the right (367.67 & 501.07) lot marker. NOTE: LOT LINES DIMENSIONS OFF FINAL PLAT.

NOTE - No trench to exceed 100 feet in length. Provide 6" - 8" diameter cleanout and cap to grade or above on septic tank.

PLANS APPROVED BY B. Nixon DATE 12/02/86

COVER NO WORK UNTIL INSPECTED AND APPROVED.

NEITHER THE HOWARD COUNTY COUNCIL NOR THE HEALTH DEPARTMENT IS RESPONSIBLE FOR THE SUCCESSFUL OPERATION OF ANY SYSTEM.

NOTE: CLEANOUT REQUIRED EVERY 70 FEET OF SEWER LINE AND/OR AT 90° SWEEPS IN LINES FROM HOUSE TO DRAIN FIELDS.

NOTE: ALL PARTS OF SEPTIC SYSTEMS (I.E., TANK, DISTRIBUTION BOX, TRENCHES) TO BE 100 FEET FROM WELL (UNLESS OTHERWISE SPECIFICALLY AUTHORIZED)

NOTE: IF DEEP TRENCH(ES) ARE USED CALL FOR INSPECTION BEFORE AND AFTER PLACING GRAVEL IN TRENCH(ES).

NOTE: NO DRY WELL SHALL EXCEED 15 FOOT IN DIAMETER. NO ABSORPTION TRENCH TO EXCEED 100 FEET IN LENGTH.

NOTE: ALL PIPE FROM HOUSE TO SEPTIC TANK MUST BE CAST IRON OR SCHEDULE 40 PVC OR ABS.

PERMIT VOID AFTER TWO YEARS.

NOTE: INSTALL STAND PIPE ON SEPTIC TANK AND DRY WELL. STAND PIPES MUST BE 6 INCHES IN DIAMETER. CAST IRON, CONCRETE OR TERRA COTTA OR PVC OR ABS ACCEPTED. IF TOP OF SEPTIC TANK IS DEEPER THAN 3 FEET, MANHOLE TO GRADE REQUIRED.

NOTE: DISTRIBUTION BOXES MUST HAVE BAFFLES.

BEG. PERMIT SIGNED

AND RETURNED 7/10/89

Serial # 28524 - gazette

*INSTALLER IS RESPONSIBLE FOR OBTAINING FINAL APPROVAL ON THIS PERMIT

*CALL 461-9933 FOR INSPECTION OF SEPTIC SYSTEMS.

EH - 2-1186

BUILDING PERMIT SIGNED
AND RETURNED

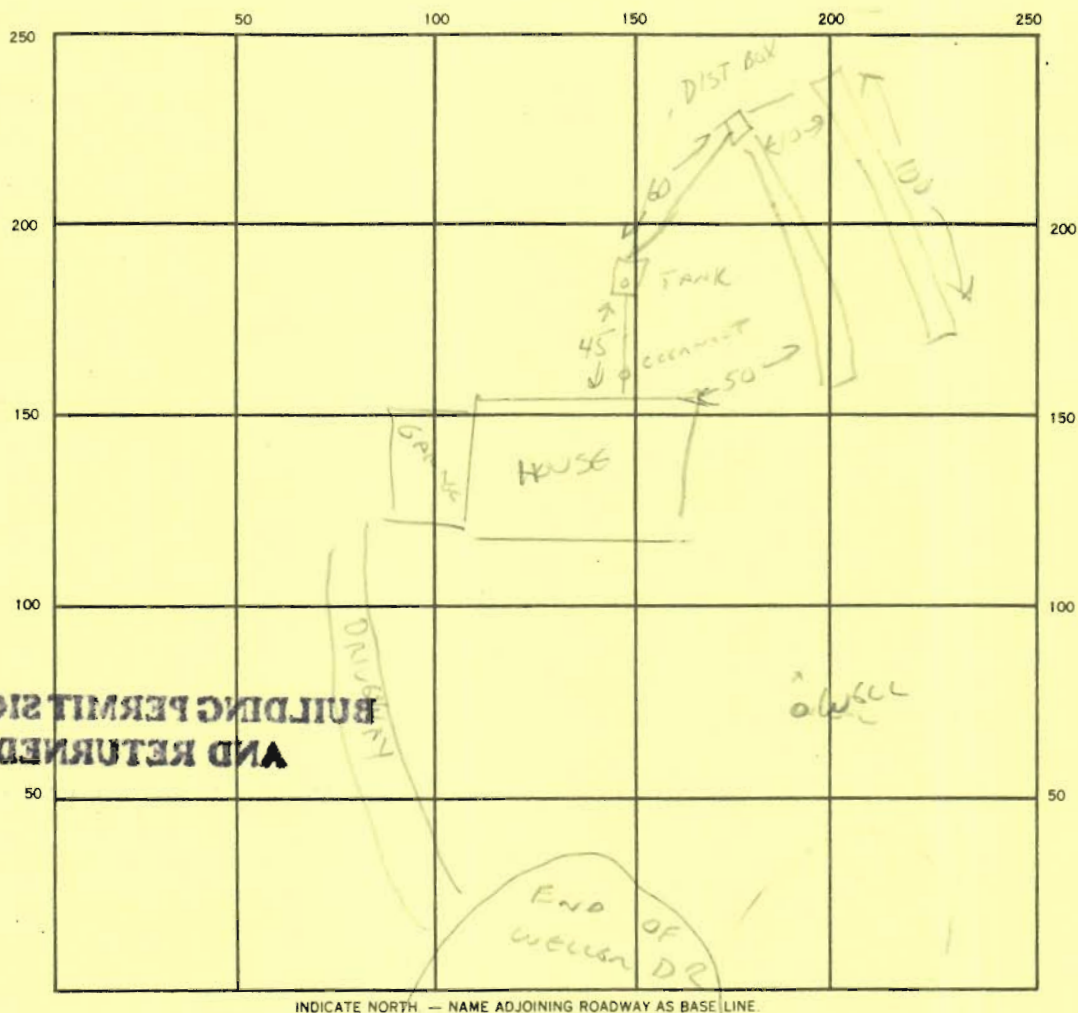

SEPTIC TANK, LEVEL ✓

CLEANOUTS STV IN LINGSU

DISTRIBUTION BOX, LEVEL _____

DRAIN FIELD/TILE FIELD, DEPTH 4 1/2 FT. TRENCH WIDTH 3 FT. INLET DEPTH 2 1/2 FT.

EFFECTIVE GRAVEL DEPTH 2 FT FT. TOTAL LENGTH 200 FT.

NUMBER OF TRENCHES 2-100' ea. ONE SIDEWALL/BOTTOM AREA 600 SQ. FT.

DRYWELL INSIDE DIAMETER _____ FT. EFFECTIVE DEPTH BELOW INLET _____ FT.

ABSORBENT AREA _____ SQ. FT.

REMARKS OK TO COVER all work 11/10/87 CW

DATE SYSTEM APPROVED 11/10/87

INSPECTOR Chandler

30' BRL 30' BRL

LOT 41
7.059 AC.

LEE L. CONDON
747/290
P. 81

6.833 AC.

House Out 386.0
Tank In 385.75
Tank Out 385.5
Trench In 385
July 2 1987

LOT 39
3.476 AC.

EVELYN M. COOPER & HERBERT KEGLEY, JR.
P. 33

SILT FENCE

2 STORY FRAME
F.F. ELEV. 401
B.F. ELEV. 391

LOT 43
3.007 AC.

4 OF
SHEET

SEE

BP 72612
7-2-87

LINE

MATCH LINE
SEE SHEET

ATIONS THIS SHEET: