

PERMIT

SEWAGE DISPOSAL SYSTEM

MARYLAND STATE DEPARTMENT OF HEALTH

HOWARD COUNTY

ELLICOTT CITY

DISTRICT 4

DATE 4/2/76

INDEXED

P 23069
A 21638

6/30/76 - app'd J.S.

Pat Lendrim

IS PERMITTED TO INSTALL X ALTER

ADDRESS Forsythe Road, Sykesville, Maryland PHONE 442-2416

A SEWAGE DISPOSAL SYSTEM LOCATED AT

SUBDIVISION 740 ROAD West Watersville Rd. LOT 16

PROPERTY OWNER William C. Birely, Jr.

ADDRESS 6603 Copper Ridge Drive, Baltimore, Md. 21209 Phone: 484-4623

SPECIFICATIONS - 3 bedrooms

DRAIN FIELD DEPTH FEET, BOTTOM AREA SQ. FT.

SEEPAGE PITS ABSORBENT SIDE-WALL AREA SQ. FT.

SEPTIC TANK CAPACITY 1,000 GALLONS

FOR GARBAGE GRINDER, INCREASE DISPOSAL AREA 22% & TANK CAPACITY 50%.

OTHER Dry well - 140 sq. ft. absorbent sidewall area per bedroom to begin below
the first 4 ft. of original grade. Max. depth permitted for dry well is 11 ft. below
original grade. Place dry well 148 ft. from left side line and 100 ft. from rear lot
line as seen when facing lot from W. Watersville Road. Manhole type cleanout to grade level

on septic tank must be provided.

NOTE: ALL PIPE FROM HOUSE TO DISPOSAL AREA MUST BE CAST IRON.

PLANS APPROVED BY D. W. Monaghan DATE 7/29/75
PERMIT VOID AFTER THREE YEARS.

FILL SEPTIC TANK AND DISTRIBUTION BOX WITH WATER BEFORE CALLING FOR AN INSPECTION. COVER NO WORK
UNTIL INSPECTED AND APPROVED.

NOTE: INSTALL STAND PIPE ON SEPTIC TANK AND DRY WELL. STAND PIPE MUST BE 6" IN DIA.,

NEITHER THE HOWARD COUNTY COMMISSIONERS NOR THE HEALTH DEPARTMENT IS RESPONSIBLE FOR THE
SUCCESSFUL OPERATION OF ANY SYSTEM.

CONCRETE, CAST IRON OR TERRA COTTA ACCEPTED.

BLDG. PERMIT SIGNED
AND RETURNED 5/18/76

BLDG. PERMIT SIGNED
AND RETURNED 2/1/83

Serial #53474
perm.

Swing No. 35839
Garage

A 21638

A 21638

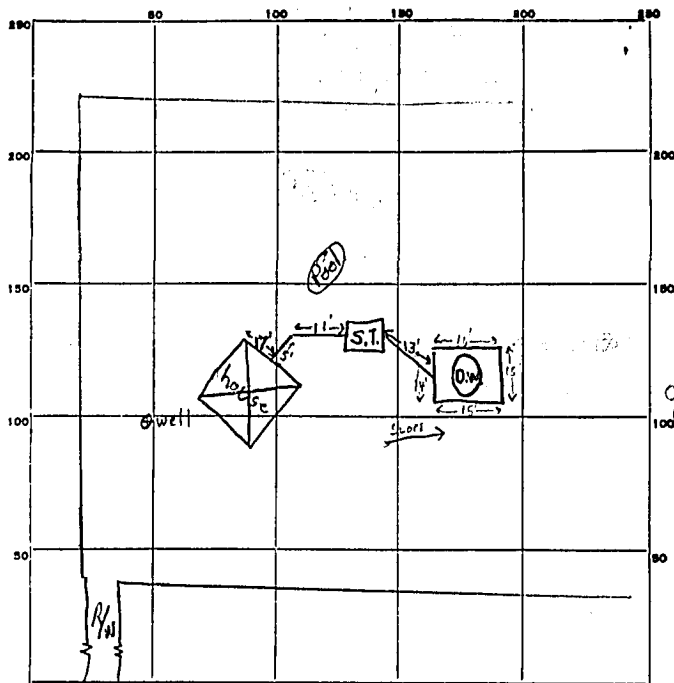

INDICATE NORTH - NAME ADJOINING ROADWAY AS BASE LINE.
West Watersville Rd.

PERMIT CARD Signed final O.K. F.S.

SEPTIC TANK, LEVEL 1000 gal.

S.T.	D.W.
<u>manhole</u>	<u>O.K.</u>

DISTRIBUTION BOX, LEVEL _____

TILE FIELD, DEPTH _____ FT. TRENCH WIDTH _____ FT.

GRAVEL DEPTH _____ IN. TOTAL LENGTH _____ FT.

NUMBER OF TRENCHES _____ TOTAL BOTTOM AREA _____

SEEPAGE PITS, INSIDE DIAMETER 60 FT. DEPTH BELOW INLET 8 (7 usable) FT.

ABSORBENT AREA ± 420 SQ. FT.

REMARKS 6/30/76 Drywell inlet at 4 ft. below grade; location appears O.K. F.S.

DATE SYSTEM APPROVED 6/30/76

INSPECTOR J. Skinner