

C1 31851

SEQUENCE NO. (MDE USE ONLY)

STATE OF MARYLAND WELL COMPLETION REPORT

FILL IN THIS FORM COMPLETELY PLEASE TYPE

THIS REPORT MUST BE SUBMITTED WITHIN 45 DAYS AFTER WELL IS COMPLETED.

COUNTY NUMBER 13

(THIS NUMBER IS TO BE PUNCHED IN COLS. 3-6 ON ALL CARDS)

ST/CO USE ONLY DATE RECEIVED

DATE WELL COMPLETED

Depth of Well

PERMIT NO. FROM "PERMIT TO DRILL WELL"

OWNER Bandera Mark T & Margaret A WELL SITE ADDRESS 1023 Winding Dr Clarksville, MD 21029 TOWN Highland SUBDIVISION 1023 Winding 1303 Wayside SECTION LOT

WELL LOG

Not required for driven wells

GROUTING RECORD

WELL HAS BEEN GROUTED (Circle Appropriate Box)

YES NO Y N 44 44

TYPE OF GROUTING MATERIAL (Circle one)

CEMENT CM BENTONITE CLAY BC

NO. OF BAGS 45 46 10 NO. OF POUNDS 45 46 500

GALLONS OF WATER 190

DEPTH OF GROUT SEAL (to nearest foot) from 0' TOP 52' ft. to 400' ft. BOTTOM 58'

CASING RECORD

casing types insert appropriate code below ST STEEL CO CONCRETE PL PLASTIC OT OTHER

MAIN CASING TYPE Nominal diameter top (main) casing (nearest inch) Total depth of main casing (nearest foot) PL 6" 63'

OTHER CASING (if used) diameter depth (feet) inch from to

screen type or open hole SCREEN RECORD ST STEEL BR BRASS BRONZE PL PLASTIC HO OPEN HOLE OT OTHER

DEPTH (nearest ft.) H O 63' 400' 1 2 8 9 11 15 17 21 23 24 26 30 32 36 38 39 41 45 47 51 SLOT SIZE 1 2 3 DIAMETER OF SCREEN (NEAREST INCH) 56 60 from to

C 3

RUMPING TEST

HOURS PUMPED (nearest hour) N/A 8 9

PUMPING RATE (gal. per min.) N/A 11 15

METHOD USED TO MEASURE PUMPING RATE N/A

WATER LEVEL (distance from land surface)

BEFORE PUMPING N/A 17 20 ft.

WHEN PUMPING N/A 22 25 ft.

TYPE OF PUMP USED (for test) A air P piston T turbine C centrifugal R rotary O other (describe below) J jet S submersible

PUMP INSTALLED

DRILLER INSTALLED PUMP (CIRCLE) YES NO

IF DRILLER INSTALLS PUMP, THIS SECTION MUST BE COMPLETED FOR ALL WELLS.

TYPE OF PUMP INSTALLED PLACE (A,C,J,P,R,S,T,O) IN BOX 29. N/A 29

CAPACITY: GALLONS PER MINUTE (to nearest gallon) N/A 31 36

PUMP HORSE POWER N/A 37 41

PUMP COLUMN LENGTH (nearest ft.) N/A 43 47

CASING HEIGHT (circle appropriate box and enter casing height) + above LAND SURFACE - below - 3 (nearest foot) 49 50 51

LATITUDE 39.191324 LONGITUDE 76.995915 (DEFAULT COORD. WGS 84)

NOTES:

NUMBER OF UNSUCCESSFUL WELLS: 0

WELL HYDROFRACTURED YES NO Y N

CIRCLE APPROPRIATE LETTER A A WELL WAS ABANDONED AND SEALED WHEN THIS WELL WAS COMPLETED E ELECTRIC LOG OBTAINED P TEST WELL CONVERTED TO PRODUCTION WELL

I HEREBY CERTIFY THAT THIS WELL HAS BEEN CONSTRUCTED IN ACCORDANCE WITH COMAR 26.04.04 "WELL CONSTRUCTION" AND IN CONFORMANCE WITH ALL CONDITIONS STATED IN THE ABOVE CAPTIONED PERMIT, AND THAT THE INFORMATION PRESENTED HEREIN IS ACCURATE AND COMPLETE TO THE BEST OF MY KNOWLEDGE.

DRILLERS LIC. NO. 1 MWD 5877 DRILLERS SIGNATURE (MUST MATCH SIGNATURE ON APPLICATION)

LIC. NO. 1 MWD 1111

SITE SUPERVISOR (sign. of driller or journeyman responsible for sitework if different from permittee)

GRAVEL PACK IF WELL DRILLED WAS FLOWING WELL INSERT F IN BOX 68

MDE USE ONLY (NOT TO BE FILLED IN BY DRILLER) T (E.R.O.S.) W Q

70 72 74 75 76 TELESCOPE CASING LOG INDICATOR OTHER DATA

TAL-650

B 1 94100

SEQUENCE NO. (MDE USE ONLY)

STATE OF MARYLAND APPLICATION FOR PERMIT TO DRILL WELL

STATE PERMIT NUMBER

572192 please type

HO-20-0236 fill in this form completely

OWNER INFORMATION: Date Received (APA) 10-5-22, Owner: Bandera Mark T & Margaret A, Address: 13813 Wayside Drive, Clarksville MD 21029

LOCATION OF WELL: Howard County, 1002 3.020AR 13813 Wayside by Clarksville, Highland NEAREST TOWN

DRILLER INFORMATION: Driller's Name: Stephen DeLosh, License No. MWD 587, Firm Name: Connelly & Associates Inc., Address: 1513 Tilco Dr. Frederick, Md. 21704, Date: 10-4-2022

SOURCES OF DRILLING WATER: 1. private, 13813 Wayside Dr. STREET ADDRESS, ON WHICH SIDE OF ROAD (CIRCLE APPROPRIATE BOX), DISTANCE FROM ROAD 88 FT, TAX MAP: 0034 BLK: PARCEL 0193

WELL INFORMATION: APPROX. PUMPING RATE (GAL. PER MIN.) N/A, AVERAGE DAILY QUANTITY NEEDED (GAL. PER DAY) N/A

USE FOR WATER (CIRCLE APPROPRIATE BOX): [D] DOMESTIC POTABLE SUPPLY & RESIDENTIAL IRRIGATION, [F] FARMING, [I] INDUSTRIAL, COMMERCIAL, DEWATERING, [P] PUBLIC WATER SUPPLY WELL, [T] TEST, OBSERVATION, MONITORING, [O] OPEN LOOP GEOTHERMAL, [C] CLOSED LOOP GEOTHERMAL

NOT TO BE FILLED IN BY DRILLER HEALTH DEPARTMENT APPROVAL: Howard County, STATE SIGNATURE, DATE ISSUED 10/12/2022, CO SIGNATURE, EXP. DATE 10/12/2023

APPROXIMATE DEPTH OF WELL 400 FEET, APPROXIMATE DIAMETER OF WELL 6 INCH, NEAREST INCH

METHOD OF DRILLING (circle one): BORED (or Augered), JETTED, Jetted & DRIVEN, AIR-ROTary, AIR-PERcussion, ROTARY (Hydraulic Rotary), CABLE, REVerse-ROTary, DRive-POINT

REPLACEMENT OR DEEPEINED WELLS (CIRCLE APPROPRIATE BOX): [N] THIS WELL WILL NOT REPLACE AN EXISTING WELL, [Y] THIS WELL WILL REPLACE A WELL THAT WILL BE ABANDONED AND SEALED, [S] THIS WELL WILL REPLACE A WELL THAT WILL BE USED AS A STANDBY-CONTACT LOCAL APPROVING AUTHORITY FOR POLICY ON STANDBY WELLS, [D] THIS WELL WILL DEEPEIN AN EXISTING WELL

Not to be filled in by driller (MDE OR COUNTY USE ONLY): APPROP. PERMIT NUMBER G, PERMIT No. HO-20-0236

SPECIAL CONDITIONS: Grant bottom to top

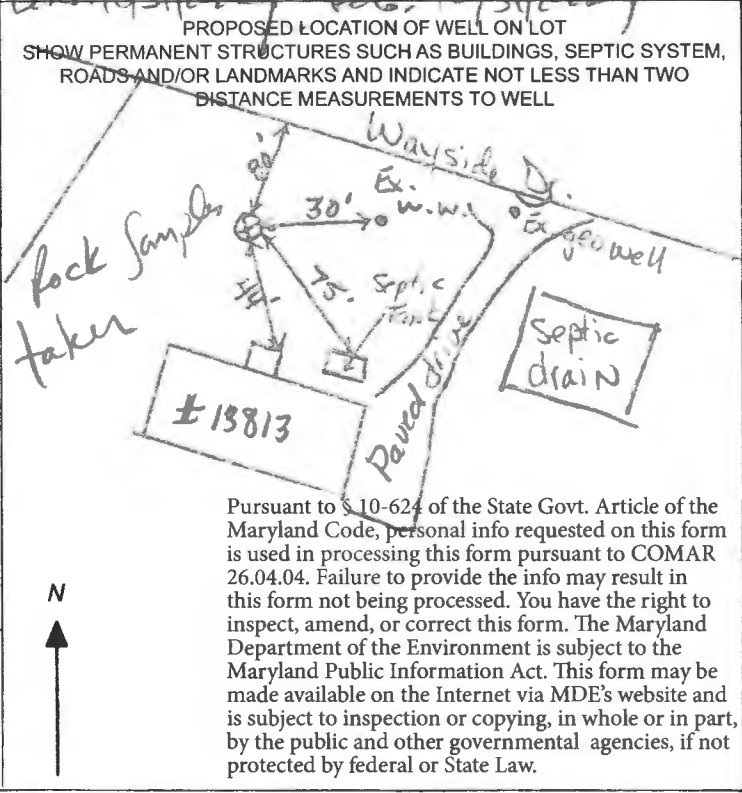

Pursuant to § 10-624 of the State Govt. Article of the Maryland Code, personal info requested on this form is used in processing this form pursuant to COMAR 26.04.04. Failure to provide the info may result in this form not being processed. You have the right to inspect, amend, or correct this form. The Maryland Department of the Environment is subject to the Maryland Public Information Act. This form may be made available on the Internet via MDE's website and is subject to inspection or copying, in whole or in part, by the public and other governmental agencies, if not protected by federal or State Law.

INS-WP-20-03223

P. 371569  
 INST-1-DE-16  
 " -1-CODES  
 REM-1-HG

FROM/
1-2
1-2

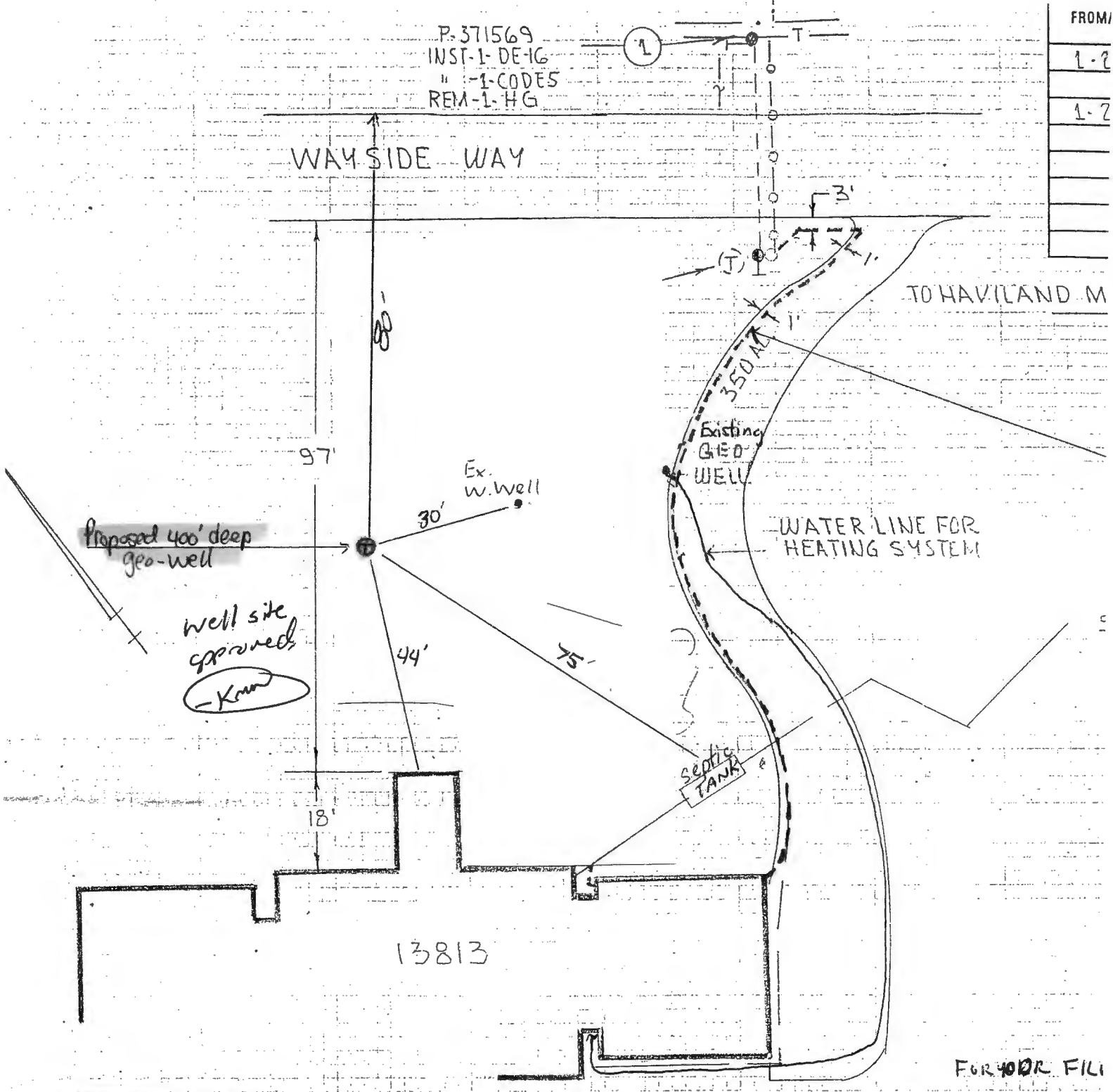

FOR YOUR FILE

**DO NOT REMOVE THIS TAG**  
 DEPARTMENT OF THE ENVIRONMENT  
 WELL PERMIT NUMBER  
**HO-20- 0236**  
 INFORMATION - GIVE NUMBER AND WRITE  
 1800 WASHINGTON BLVD  
 BALTIMORE MARYLAND 21230

LOCATION OF GAS & ELECTRIC FACILITIES APPROV

BY \* PHONE DATE

TEST		PSIG		DESIGNER N. CORRIERI	
50 PSIG	HOURS	RADIOGRAPHIC REQUIRED	%	PERMITS	REQ'D
BOOK FOR DETAILS				CITY	CONSTR. DESIGN
PROPOSED GAS AND/OR ELECTRIC TRENCH				HOW CO.	CONSTR. DESIGN
EXISTING GAS AND/OR ELECTRIC FACILITIES				STATE	ENGINEERING C
REVISION		BY	DATE	ST. LT. CERTIF.	RIGHT-OF-WAY.C
					CORROSION CONTROL

Bandera Residence: 13813 Wayside Drive Clarksville, Md. Geothermal Closed Loop

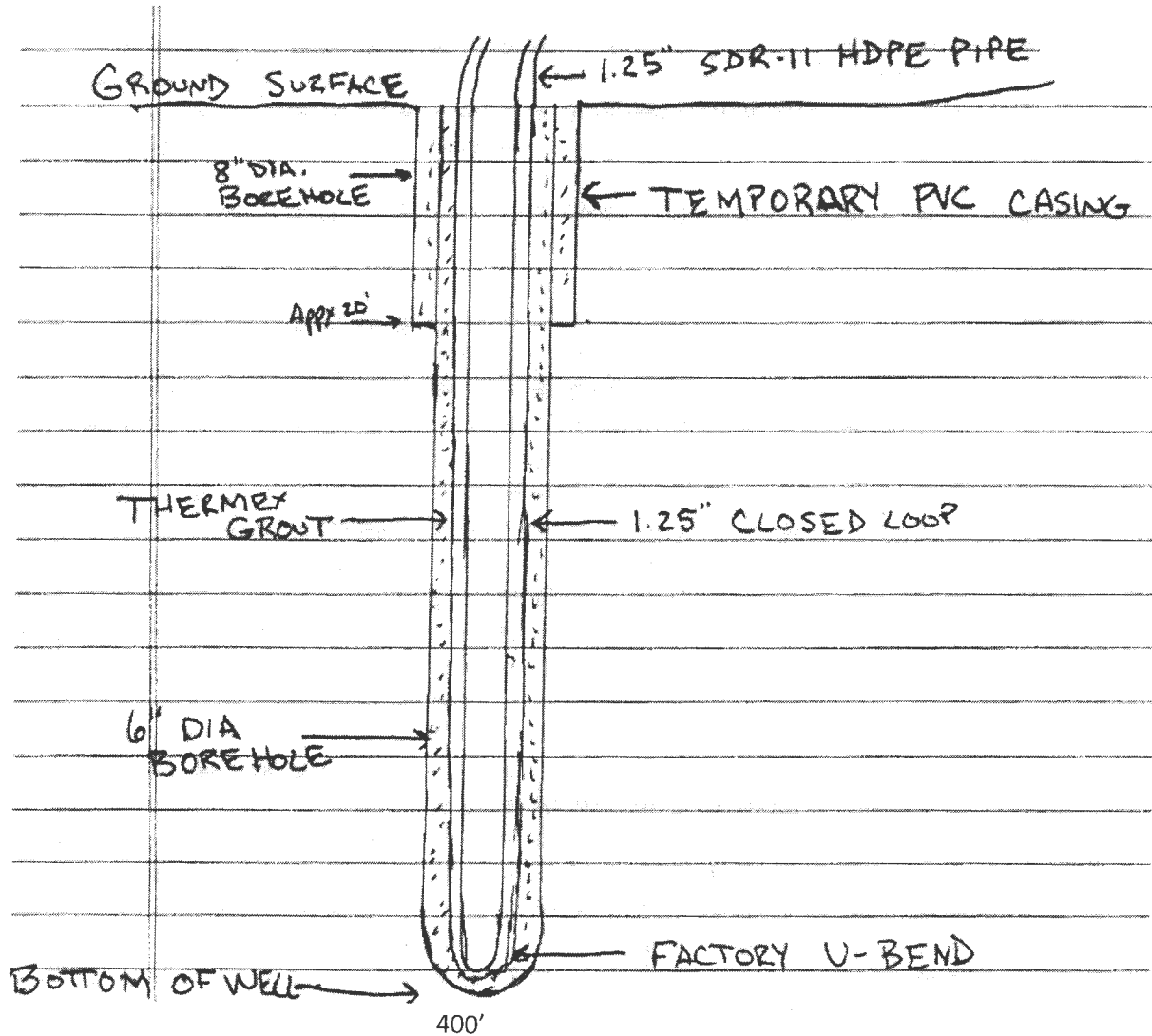

Grout information for this property is as follows:

Well Grout DF grout mixture of 50 lb. grout to 19 gallons water, placed in the well using the tremie method, from bottom to top.



Bureau of Environmental Health

8930 Stanford Boulevard, Columbia, MD 21045

Main: 410-313-2640 | Fax: 410-313-2648

TDD 410-313-2323 | Toll Free 1-866-313-6300

www.hchealth.org

Facebook: www.facebook.com/hocohealth

Twitter: HowardCoHealthDep

Dr. Maura J. Rossman, M.D., Health Officer

TO ALL INTERESTED PARTIES

When submitting a well permit application for a proposed well for new construction, please indicate one of the following:

Well Site Location:

1002 3.020AR 13813 Wayside Dr. Clarksville      Wayside Dr.  
Subdivision/Property Name      Lot #      Road Name

- The well site has been staked by \_\_\_\_\_  
(professional land surveyor or company employing professional land surveyors)  
on \_\_\_\_\_ (date) and does not require a site inspection.
- The well driller, builder or property owner will call the Health Department to schedule a time to meet in the field to verify the proposed well site location.

This sheet, along with two copies of an acceptable well site plan, must be attached to the green well permit application.

**RECEIPT**

Howard County, MD  
HOWARD COUNTY HEALTH DEPARTMENT  
ASCEND ONE BUILDING  
Columbia, MD 21045  
8930 STANFORD BLVD

**Application:** WS-WP-22-03223

**Application Type:** EnvHealth/Well and Septic/Installation/Application

**Address:**

<b>Receipt No.</b>	5061					
<b>Payment Method</b>	<b>Ref Number</b>	<b>Amount Paid</b>	<b>Payment Date</b>	<b>Cashier ID</b>	<b>Received</b>	<b>Comments</b>
Credit Card		\$160.00	10/05/2022	JUKING		Well Permit/ 13813 Wayside Dr
<b>Work Description:</b>	Well Permit/ 13813 Wayside Dr					