

APPLICATION

PERCOLATION TESTING

A 50520 U

P _____

HOWARD COUNTY HEALTH DEPARTMENT
BUREAU OF ENVIRONMENTAL HEALTH
3525-H ELLICOTT MILLS DRIVE/ELLICOTT CITY, MARYLAND 21043
TELEPHONE: 313-2640

DISTRICT _____

DATE 3/3/95

TO: THE COUNTY HEALTH OFFICER
ELLICOTT CITY, MARYLAND

I HEREBY APPLY FOR THE NECESSARY TEST PRIOR TO APPLICATION FOR PERMIT TO CONSTRUCT (OR RECONSTRUCT) A SEWAGE DISPOSAL SYSTEM.

PROPERTY OWNER Annelore Stiegler

ADDRESS 2151 Route 32
Sykesville, Maryland 21784 PHONE _____

AGENT OR PROSPECTIVE BUYER SDC Group, Inc.

ADDRESS P.O. Box 417
Ellicott City, Maryland 21041 PHONE (410) 465-4244

PROPERTY LOCATION:

SUBDIVISION Stiegler Property LOT NO. 29130

ROAD AND DESCRIPTION 2100 block Maryland Route 32; northeast quadrant I-70
and Maryland Route 32

TAX MAP 15 PARCEL # 40

SIZE OF LOT 60,000 SF TYPE BLDG. Single Family
(SINGLE FAMILY DWELLING OR COMMERCIAL)

THE SYSTEM INSTALLED UNDER THIS APPLICATION IS ACCEPTABLE ONLY UNTIL PUBLIC FACILITIES BECOME AVAILABLE. I FULLY UNDERSTAND THE FEE CONNECTED WITH THE FILING OF THIS PERC TEST APPLICATION IS NON-REFUNDABLE UNDER ANY CIRCUMSTANCES. I ALSO AGREE TO COMPLY WITH ALL M.O.S.H.A. REQUIREMENTS IN TESTING THIS LOT.

[Signature]
(SIGNATURE OF APPLICANT)

APPROVED BY _____ FOR _____ DATE _____

DISAPPROVED BY _____ FOR _____ DATE _____

HOLD PENDING FURTHER TESTS _____

REASONS FOR REJECTION OR HOLDING _____

PERCOLATION TEST PLAT/PRELIMINARY PLAT - TITLE OR I.D. # _____ DATE _____

SITE DEVELOPMENT PLAN/FINAL PLAT - TITLE OR I.D. # _____ DATE _____

THIS IS NOT A PERMIT

5056011

COUNTY #

562
SOIL PROFILE
560

0' dark red silm
2.5' lgt orange brn silm
4' verticle bedding of saprolite on high end of test hole
5' lgt tan micaceous silm

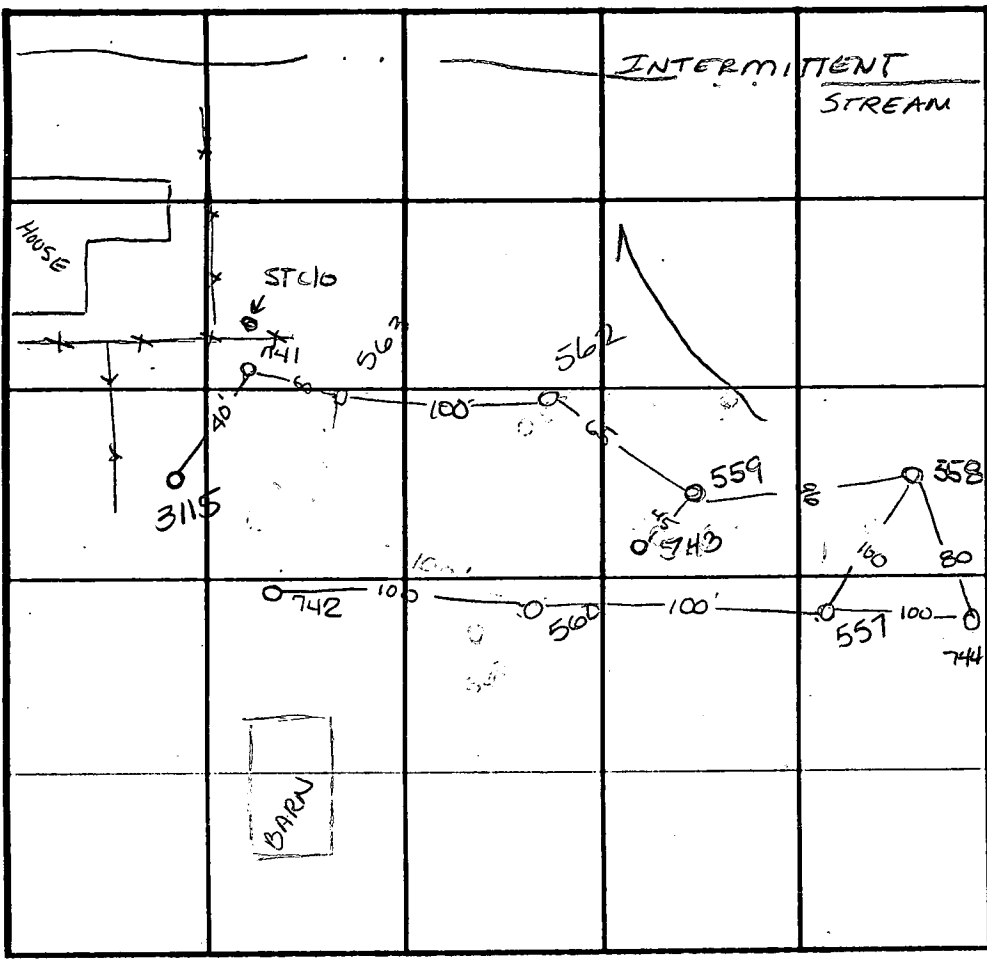

SOIL PROFILE
742

0' dark orange silm
5.5' lgt yellow tan silm
5a silm
20% shale frags

559
bright red silm

4.5' beigh sil very micaceous

6' lgt yellow tan silm
8' greyish brn sil
30% saprolite

741, 563
dark orange red silm
5.5' grey beigh silm
20% micaceous saprolite

INDICATE NORTH - NAME ADJOINING ROADWAY AS BASE LINE.

DATE	TEST NO.	DEPTH	PRE-WET		TEST - 1" DROP		TIME
			START	STOP	START	STOP	
3-30-95	560	5' / V12'	10:24	10:27	10:27	10:29 ³⁰	2 1/2 min
	562	4.5' / VII'	10:36	10:36 ⁴⁵	10:36 ⁴⁵	10:38 ³⁰	1 1/4 min
	562	re pour	10:40	10:41 ³⁰	10:41 ³⁰	10:43 ³⁰	2 min
	559	NOT TESTED - CAVING NOT SAFE TO TEST					F
	563	5' / V12'	10:47	10:47 ³⁰	10:47 ³⁰	10:48 ³⁰	1 min
	563	re pour	10:50	10:51 ³⁰	10:51 ³⁰	10:53 ⁴⁵	2 1/4 min
	557	5' / V2.5'	10:12 ³⁰	10:14 ³⁰	10:14 ³⁰	10:17 ³⁰	2 1/2 min
	558	5' / VII'	1:36	1:42	1:42	1:55	13 min
2-23-96	741	Visual	only	see profile			OK
	742	5.5' / VII.0'	12:01	12:07	12:07	12:15	8 min

557 558
red silm micaceous

2.5' red brn silm

5' lgt tan silm
20% saprolite
verticle bedding

REMARKS _____

TYPE OF SOIL _____

TESTED BY Amy McMillen ALSO PRESENT Larry

TRENCH DESIGN DATA: AVERAGE PERCOLATION TIME 741, 742, 563, 3115 TRENCH WIDTH _____

INLET DEPTH _____ MAXIMUM BOTTOM DEPTH _____ SQ. FT./BEDROOM _____

