

HOWARD COUNTY
PERMIT APPLICATION

PERMIT NUMBER

B06004318

Building Address 12067 Windsor Moss
Elliott City, Md 21042
Suite/Apt #: _____ SDP/WP/Petition #: _____
Census Tract _____ Subdivision Elliott Meadows
Section _____ Area _____ Lot 0110
Tax Map 116 Parcel _____ Grid _____
Zoning _____ Map Coordinates _____ Lot size _____

Property Owner's Name NK Hermes, Inc.
Address 6085 Marshakee Drive
City Elkridge State Md Zip Code 21075
Home Phone _____ Work Phone 410 319 9996
Applicant's Name & Mailing Address, (if other than stated hereon):
Phone _____ Fax _____

Existing Use SFD
Proposed Use deck
Estimated Construction Cost \$ 8,000
Description of Work 14x10 deck w/
steps to grade

Contractor Company Pro-Built Const., Inc.
Contact Person Edward Pacylowski
Address 13453 Long Days Ct
City Highland State Md Zip Code 21077
License No. 20347
Phone 301 854 0821 Fax 301 854 9632

Occupant or Tenant _____
Contact Name _____
Address _____
City _____ State _____ Zip Code _____
Phone _____ Fax _____

Engineer or Architect Company _____
Contact Person _____
Address _____
City _____ State _____ Zip Code _____
Phone _____ Fax _____

BUILDING DESCRIPTION - COMMERCIAL

BUILDING DESCRIPTION - RESIDENTIAL

Building Characteristics
Height: _____
No. of stories: _____
Gross area, sq. ft. per floor: _____
Use group: _____
Construction type:
 Reinforced Concrete
 Structural Steel
 Masonry
 Wood Frame
 State Certified Modular

Utilities
Water Supply:
 Public
 Private
Sewage Disposal:
 Public
 Private
Electric Yes No
Gas Yes No
Heating System:
Electric Oil
Natural Gas
Propane Gas
Sprinkler system: N/A
 Full
 Partial
 Other Suppression
of Heads _____

Building Characteristics
SF Dwelling SF Townhouse
Depth _____ Width _____
1st floor: _____
2nd floor: _____
Basement: _____
Finished Basement Unfinished Basement
Crawl space Slab on Grade
No. of Bedrooms _____
Height: _____
Multi-family dwellings:
No. of efficiency units: _____
No. of 1 BR units: _____
No. of 2 BR units: _____
No. of 3 BR units: _____
Other Structure: deck
Dimensions: 14x10
Footings: post & pier
Roof Height _____
 State Certified Modular
 Manufactured Home

Utilities
Water Supply:
 Public
 Private
Sewage Disposal:
 Public
 Private
Electric Yes No
Gas Yes No
Heating System:
Electric Oil
Natural Gas
Propane Gas
Sprinkler system: N/A
 NFPA #13D
 NFPA #13R
 Other:

THE UNDERSIGNED HEREBY CERTIFIES AND AGREES AS FOLLOWS: (1) THAT HE/SHE IS AUTHORIZED TO MAKE THIS APPLICATION; (2) THAT THE INFORMATION IS CORRECT; (3) THAT HE/SHE WILL COMPLY WITH ALL REGULATIONS OF HOWARD COUNTY WHICH ARE APPLICABLE THERETO; (4) THAT HE/SHE WILL PERFORM NO WORK ON THE ABOVE REFERENCED PROPERTY NOT SPECIFICALLY DESCRIBED IN THIS APPLICATION; (5) THAT HE/SHE GRANTS COUNTY OFFICIALS THE RIGHT TO ENTER ONTO THE PROPERTY FOR THE PURPOSE OF INSPECTING THE WORK PERMITTED AND POSTING NOTICES.

[Signature]
Applicant's Signature
President
Title/Company

Edward Pacylowski
Print Name
9/7/06
Date

Checks payable to: **DIRECTOR OF FINANCE OF HOWARD COUNTY**
** PLEASE WRITE NEATLY AND LEGIBLY. **

FOR OFFICE USE ONLY

AGENCY	DATE	SIGNATURE APPROVAL
Land Development, DPZ		
State Highways		
Building Official		
Dev. Engineering, DPZ		
Health	<u>9/7/06</u>	<u>[Signature]</u>
Fire Protection		
Is Sediment Control approval required prior to issuance? YES <input type="checkbox"/> NO <input type="checkbox"/>		
CONTINGENCY CONSTRUCTION START: <input type="checkbox"/>		
ONE STOP SHOP: <input type="checkbox"/>		
Distribution of Copies - White: Building Official Green: LDD, DPZ Yellow: DED, DPZ Pink: Health Gold: SHA		

DPZ SETBACK INFORMATION	PROPERTY ID#
Front: _____	Filing fee \$ _____
Rear: _____	Permit fee \$ _____
Side: _____	Excise tax \$ _____
Side St: _____	Add'l per. fee \$ _____
All minimum setbacks met? YES <input type="checkbox"/> NO <input type="checkbox"/>	TOTAL FEES \$ _____
Is Entrance Permit required? YES <input type="checkbox"/> NO <input type="checkbox"/>	Sub-total paid \$ _____
Historic District? YES <input type="checkbox"/> NO <input type="checkbox"/>	Balance due \$ _____
Lot Coverage for New Town Zone _____	Check # _____
SDP/Red-line approval date _____	Validation # _____
Accepted by _____	

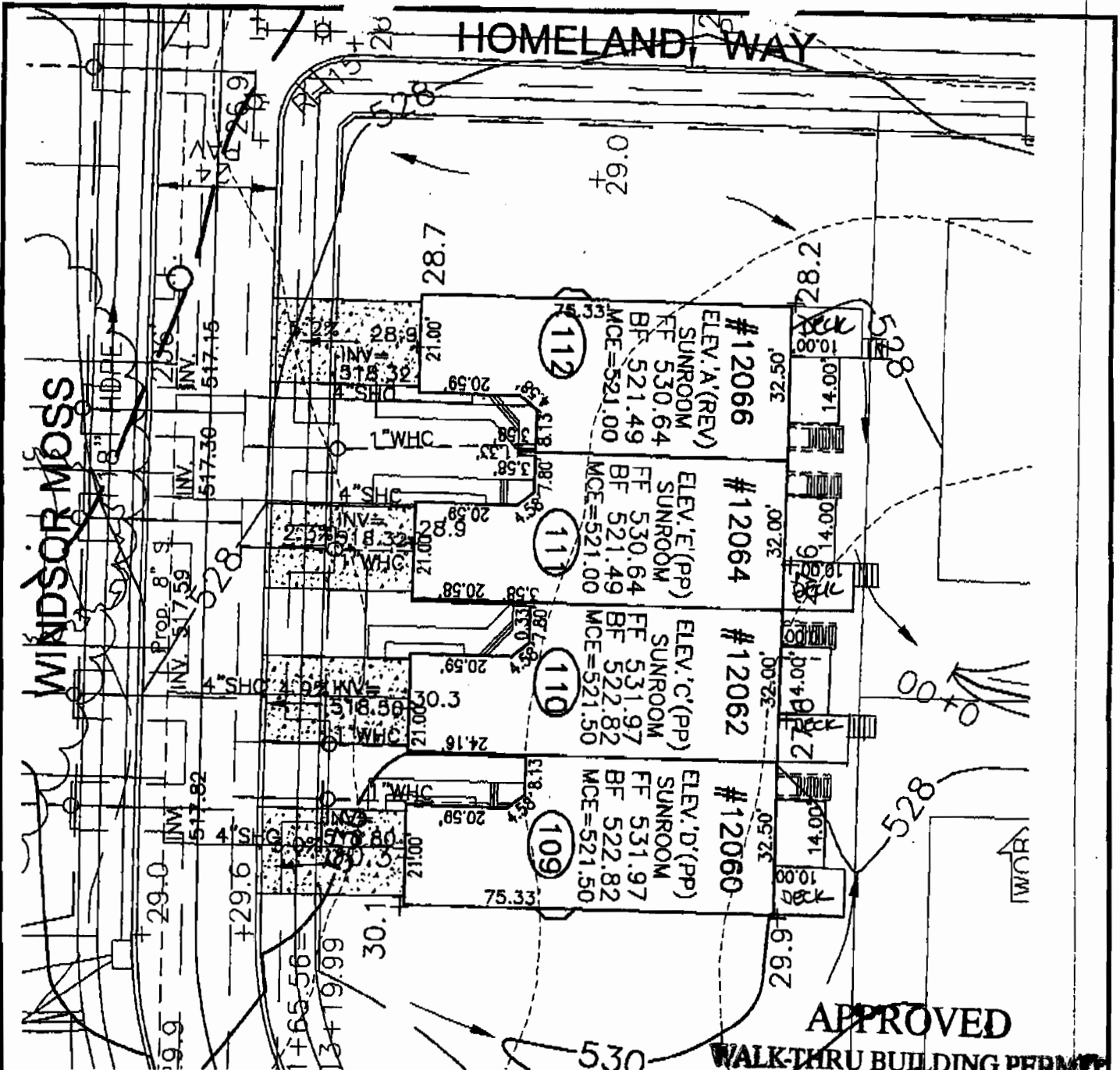

VA ROBERT H. VOGEL ENGINEERING, INC.
 ENGINEERS • SURVEYORS • PLANNERS
 8407 MAIN STREET TEL: 410.461.7666
 ELLICOTT CITY, MD 21043 FAX: 410.461.8981

APPROVED WALK-THRU BUILDING PERMIT
 # 006004318 A# 525129-A
 APP. SAN GAC DATE: 1/17/06
 DESC. OF WORK: DECK AS SHOWN

SCALE 1"=30'
 DRAWN BY MY
 CHECKED BY RHV
 DATE FEB. 2006
 W. O. # 04-87.00
 SHEET# 1 OF 1

**NV HOMES
 ELLICOTT MEADOWS
 UNITS 109-112**

HOMELAND SDP-03-30
 TAX MAP 18
 3RD ELECTION DISTRICT

PARCEL 53,86,185&204
 HOWARD COUNTY, MARYLAND

Handwritten signatures and date:
 Date: 3/18/06

APPROVED FOR CONSTRUCTION