

**Bureau of Environmental Health**  
 8930 Stanford Boulevard, Columbia, MD 21045  
 Main: 410-313-2640 | Fax: 410-313-2648  
 TDD 410-313-2323 | Toll Free 1-866-313-6300  
[www.hchealth.org](http://www.hchealth.org)  
 Facebook: [www.facebook.com/hocohealth](http://www.facebook.com/hocohealth)

Maura J. Rossman, M.D., Health Officer

RECEIPT DATE: 9/4/25 **ONSITE SEWAGE DISPOSAL SYSTEM** P 589195

APPROVAL DATE: 9/19/2025 **PERMIT: MINOR REPAIR** A Repair

PROPERTY ADDRESS: 3589 Folly Quarter Road

SUBDIVISION: Cameron Tract LOT: 3 TAX ID: 03-305325

CONTRACTOR: JET Septic (Trey Garrett) EMAIL: Jetseptic23@gmail.com

CONTRACTOR ADDRESS: 440 Bear Branch Road, Westminster, MD 21157 PHONE: 410-875-2311

PROPERTY OWNER: Jeff Hines EMAIL: n/a

OWNER ADDRESS: Same as above PHONE: n/a

SEPTIC TANK SIZE: Existing PUMP SIZE: n/a PUMP TANK CAPACITY: n/a

DISTRIBUTION SYSTEM:  GRAVITY  LPD BEDROOMS: 4 APPLICATION RATE: n/a

TRENCHES:	LINEAR FEET REQUIRED: <u>n/a</u>	INLET DEPTH: _____
	TRENCH WIDTH: _____	MAXIMUM BOTTOM DEPTH: _____
	MINIMUM SPACE BETWEEN TRENCHES: _____	EFFECTIVE AREA BEGINNING DEPTH: _____
LOCATION:	SYSTEM STAKED BY INSTALLER/DESIGNER AND VERIFIED BY APPROVING AUTHORITY DURING PRE-CONSTRUCTION INSPECTION.	
NOTES:	Install system per approved design plans. Drywell to be disconnected, pumped and collapsed.	

ISSUED BY: Kevin M. Wolf, L.E.H.S. ISSUE DATE: 9/4/2025 EXPIRATION DATE: 9/4/2026

- NOTE: CONTRACTOR MUST SCHEDULE A PRE-CONSTRUCTION INSPECTION PRIOR TO BEGINNING ANY INSTALLATION
- NOTE: CONTRACTOR REGISTERED WITH THE STATE OF MD ON-SITE WASTEWATER PROFESSIONALS BOARD: CONFIRMED
- NOTE: CONTRACTOR MUST SCHEDULE AN INSPECTION AND GAIN APPROVAL OF ALL COMPONENTS PRIOR TO COVERING
- NOTE: STONE MUST BE APPROVED BY HEALTH DEPARTMENT AND GRAVEL TICKET MUST BE AVAILABLE FOR REVIEW.
- NOTE: WATERTIGHT SEPTIC TANKS REQUIRED
- NOTE: ALL PARTS OF SEPTIC SYSTEM SHALL BE AT LEAST 100 FEET DOWNGRADIENT FROM ANY WATER WELL
- NOTE: MANHOLE RISERS REQUIRED ON ALL SEPTIC TANKS AND PUMP CHAMBERS
- NOTE: AN ELECTRICAL PERMIT IS REQUIRED FOR INSTALLATION OF ANY ELECTRICAL COMPONENTS OF THE SYSTEM  
 ELECTRICAL PERMIT ISSUED E n/a
- NOTE: THE HCHD DOES NOT WARRANTY ANY SYSTEM AND CANNOT GUARANTEE THE PERFORMANCE OF THIS SYSTEM AS DESIGNED. BY ACCEPTING THIS PERMIT, THE OWNER AND/OR APPLICANT ACKNOWLEDGE THAT THE SPECIFICATIONS DETAILED IN THIS DESIGN ARE ONE POSSIBLE OPTION AND THAT THE HCHD WILL REVIEW OTHER PROPOSALS. YOU HAVE THE OPTION TO SEEK THE ADVICE OF A QUALIFIED DESIGN CONSULTANT OR PROFESSIONAL ENGINEER FOR FURTHER GUIDANCE.
- NOTE: AN INDIVIDUAL CERTIFIED BY MDE AND THE MANUFACTURER FOR BAT INSTALLATION MUST BE PRESENT AT ALL TIMES DURING BAT INSTALLATION.
- NOTE: MDE RECOMMENDS SEPTIC TANKS, BAT, AND OTHER PRETREATMENT UNITS BE PUMPED AT A FREQUENCY ADEQUATE TO ENSURE THAT SOLIDS ARE NOT DISCHARGED TO THE DISPOSAL AREA

**NEITHER THE HOWARD COUNTY COUNCIL NOR THE HEALTH DEPARTMENT IS RESPONSIBLE FOR THE SUCCESSFUL OPERATION OF ANY SYSTEM.  
 PERMITTEE RESPONSIBLE FOR OBTAINING FINAL APPROVAL ON THIS PERMIT.  
 CALL 410-313-1771 TO SCHEDULE INSPECTIONS.**

NOT TO SCALE

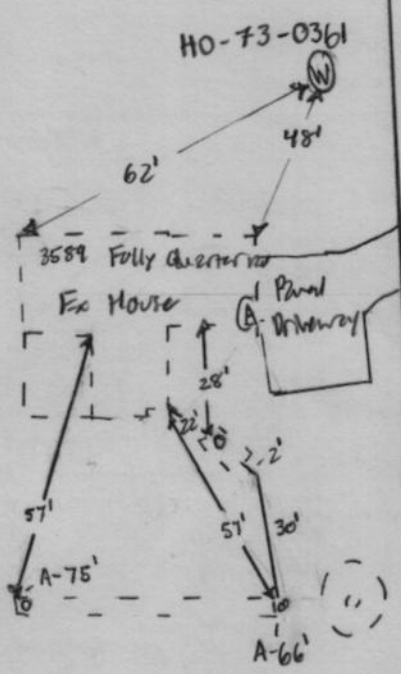

ROAD NAME

**TRENCH/DRAINFIELD DATA**

WIDTH	INLET	BOTTOM
Existing		
NUMBER OF TRENCHES		
TOTAL LENGTH		
ABSORPTION AREA		
DISTRIBUTION BOX LEVEL		
DISTRIBUTION BOX BAFFLE		
DISTRIBUTION BOX PORT		

**SEPTIC TANK DATA**

SEPTIC TANK I LEVEL Existing

MANUFACTURER \_\_\_\_\_

CAPACITY \_\_\_\_\_ GAL

SEAM LOC \_\_\_\_\_

TANK LID DEPTH \_\_\_\_\_

BAFFLES \_\_\_\_\_

BAFFLE FILTER \_\_\_\_\_

MANHOLE LOC NEW TANK

6" PORT LOC \_\_\_\_\_

WATERTIGHT TEST \_\_\_\_\_

SLOTTED \_\_\_\_\_

DATE ON LID \_\_\_\_\_

PUMP/SEPTIC TANK LEVEL N/A

MANUFACTURER \_\_\_\_\_

CAPACITY \_\_\_\_\_ GAL

SEAM LOC \_\_\_\_\_

TANK LID DEPTH \_\_\_\_\_

BAFFLES \_\_\_\_\_

BAFFLE FILTER \_\_\_\_\_

MANHOLE LOC \_\_\_\_\_

6" PORT LOC \_\_\_\_\_

WATERTIGHT TEST \_\_\_\_\_

SLOTTED \_\_\_\_\_

DATE ON LID \_\_\_\_\_

SEPTIC CONTRACTOR ONSITE INSTALLING SYTEM: Charles Gennett III

SEPTIC CONTRACTOR ONSITE LICENSED WITH THE STATE OF MD: YES/NO

PRE-CONSTRUCTION NOTES:

9/4/2025 - Design Plan Approval. (N/A)

**CONTROL PANEL DATA**

CONTROL PANEL HEIGHT N/A  
(MIN 30")

INSPECTION DATE \_\_\_\_\_

INSPECTION: PASS/FAIL (CIRCLE ONE)

INSTALLATION NOTES:

9/9/2025 - Installer onsite for inspection verified adequate fall from tank to trench.

4" PVC used; Ductwell adequately installed, see attached pictures. New C/O installed @ end of trench, ok to backfill. (SP)

FINAL INSPECTOR S. Pose DATE OF APPROVAL 9/9/2025



# Folly Quarter Rd

Septic System Repair Plan  
4BR.

INSTALLER: JET SEPTIC INC  
CHARLES GARRETT III  
440 BEAR BRANCH RD  
WESTMINSTER MD 21157  
410-875-2311  
jetseptic23@gmail.com

Note: No wells within  
100ft of existing system

HOMEOWNER: JEFFREY HINES  
3589 FOLLY QUARTER RD  
ELLCOTT CITY MD 21042  
443-956-7013  
jjh@gdldlaw.com

EW C

HINES JEFFREY

Existing Septic  
Tank/ New Manhole  
Riser  
to be added

Existing 70ft Trench,  
make tie-in from septic  
tank. Adding two site  
pipes at beginning &  
end of trench

Existing Drywell -  
Pump, Crush, & Fill

GRESHAM

25ft from  
property line

15ft from  
property line

115ft from property line



