

SEPTIC SYSTEM TO BE INSTALLED.  
FIRST BEFORE BUILDING PERMIT  
CAN BE SIGNED.

File

# PERMIT

P 27967  
A 27553

SEWAGE DISPOSAL SYSTEM

MARYLAND STATE DEPARTMENT OF HEALTH\*

HOWARD COUNTY

ELLICOTT CITY

*SUBDIVIDED AS  
LOT 1 - GARDEN PROPERTY  
F-91-88*

*04-337263*

DISTRICT 4th

**INDEXED**

DATE 4/28/78

Costello Builders IS PERMITTED TO INSTALL X ALTER

ADDRESS Box 2201 Route 94, Woodbine, Md. PHONE \_\_\_\_\_

SUBDIVISION \_\_\_\_\_ ROAD 2910 Route 94 LOT \_\_\_\_\_  
*WOODBINE, MD. 21797*

PROPERTY OWNER Michael J. Mulcahey

ADDRESS \_\_\_\_\_

SPECIFICATIONS 3 bedrooms

SEPTIC TANK CAPACITY 1000 GALLONS

DRAIN FIELD \_\_\_\_\_ DEPTH \_\_\_\_\_ FEET. BOTTOM AREA \_\_\_\_\_ SQ. FT.

DEEP TRENCH \_\_\_\_\_ DEPTH \_\_\_\_\_ FEET. BOTTOM AREA \_\_\_\_\_ SQ. FT.

SEEPAGE PITS \_\_\_\_\_ ABSORBENT SIDE-WALL AREA 160 SQ. FT. effective sidewall absorption area per bedroom

INLET PIPE 3 FT. BELOW ORIGINAL GRADE. MAXIMUM DEPTH 10 FT. BELOW ORIGINAL GRADE

EFFECTIVE DEPTH AT \_\_\_\_\_ FT. BELOW ORIGINAL GRADE.

LOCATE DISPOSAL AREA 425 FT. FROM front LOT LINE AND 260 FT. FROM left LOT LINE AS SEEN WHEN

FACING LOT FROM Maryland Route #94

TRENCH - to start after a 5 foot earth buffer with the dry well and proceed to dig it on level ground the necessary distance.

NOTE: TRENCHES NOT TO BE CONNECTED IN SERIES. MUST USE DISTRIBUTION BOX OR T'S AND CONNECT TO END NEAREST SEPTIC TANK.

PLANS APPROVED BY Frank Skinner DATE 4/10/78

COVER NO WORK UNTIL INSPECTED AND APPROVED.

NEITHER THE HOWARD COUNTY COUNCIL NOR THE HEALTH DEPARTMENT IS RESPONSIBLE FOR THE SUCCESSFUL OPERATION OF ANY SYSTEM.

NOTE: IF TRENCH IS USED CALL FOR INSPECTION BEFORE PLACING GRAVEL IN TRENCH.

NOTE: NO DRY WELL SHALL EXCEED 15 FOOT IN DIAMETER.

NOTE: ALL PIPE FROM HOUSE TO DISPOSAL AREA MUST BE CAST IRON.

PERMIT VOID AFTER THREE YEARS.

NOTE: INSTALL STAND PIPE ON SEPTIC TANK AND DRY WELL. STAND PIPES MUST BE 6 INCHES IN DIAMETER. CAST IRON, CONCRETE OR TERRA COTTA ACCEPTED.

BLDG. PERMIT SIGNED  
AND RETURNED 5/3/78  
*Serial No. 35595*

27553

\*INSTALLER IS RESPONSIBLE FOR OBTAINING FINAL APPROVAL ON THIS PERMIT.

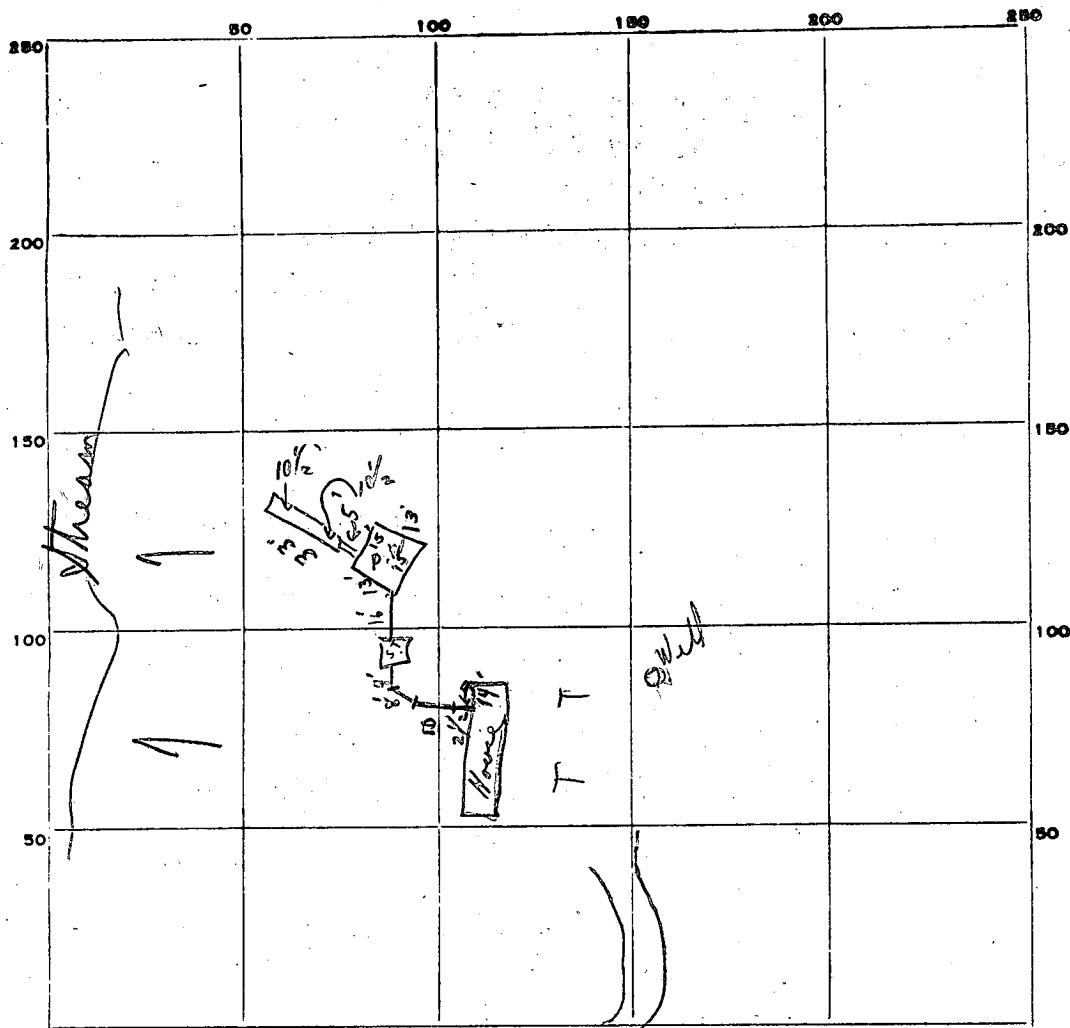

INDICATE NORTH. - NAME ADJOINING ROADWAY AS BASE LINE.

480  
336  
180  
516

PERMIT CARD

① Not seen ② Not seen P# 94

SEPTIC TANK, LEVEL

ok

CLEANOUTS

S.T. / P.W.  
✓ / ✓

DISTRIBUTION BOX, LEVEL

N/A

TILE FIELD, DEPTH 10 1/2 FT. TRENCH WIDTH - FT.

GRAVEL DEPTH 6 1/2 IN. TOTAL LENGTH 33 FT.

① 215

NUMBER OF TRENCHES 1 TOTAL BOTTOM AREA 198 3

SEEPAGE PITS, INSIDE DIAMETER 56 FT. DEPTH BELOW INLET 6' FT. ② 336

ABSORBENT AREA 551 ± SQ. FT.

REMARKS

5/1/78 ① ok for gravel (cast iron all the way to P.W.)  
② paper on trench to 4' of surface. C.B.D.

DATE SYSTEM APPROVED

5/1/78 as per above INSPECTOR

C. B. D. Steak