

10/23/92 11:00

# PERMIT

## SEWAGE DISPOSAL SYSTEM

### DEPARTMENT OF HEALTH AND MENTAL HYGIENE

P \_\_\_\_\_

A REPAIR

DISTRICT \_\_\_\_\_

DATE \_\_\_\_\_

**HOWARD COUNTY HEALTH DEPARTMENT**  
**BUREAU OF ENVIRONMENTAL HEALTH**  
461-9933

DATE SYSTEM APPROVED \_\_\_\_\_

INSPECTOR \_\_\_\_\_

IS PERMITTED TO INSTALL \_\_\_\_\_ ALTER

ADDRESS \_\_\_\_\_ PHONE \_\_\_\_\_

SUBDIVISION Patuxent River State Park LOT \_\_\_\_\_ ROAD 3770 Route 94

PROPERTY OWNER State of Maryland - Contact- Kindall Mott-1-301-924-2127

ADDRESS 3770 Route 94 Seneca Creek State Park  
(Tenant - Robert Mathis)

SEPTIC TANK CAPACITY 1000 GALLONS

NUMBER OF BEDROOMS 2/3

\_\_\_\_\_ SQUARE FEET PER BEDROOM

LINEAR FEET OF TRENCH REQUIRED \_\_\_\_\_

REPAIR - PURPOSE - SEPTIC SYSTEM HAS FAILED.

Call for inspection when ground is opened so sanitarian can recommend repair. 8/19/92

PLANS APPROVED BY \_\_\_\_\_ DATE \_\_\_\_\_

COVER NO WORK UNTIL INSPECTED AND APPROVED

NEITHER THE HOWARD COUNTY COUNCIL NOR THE HEALTH DEPARTMENT IS RESPONSIBLE FOR THE SUCCESSFUL OPERATION OF ANY SYSTEM

NOTE: CLEANOUT REQUIRED EVERY 70 FEET OF SEWER LINE AND/OR AT 90° SWEEPS IN LINES FROM HOUSE TO DRAIN FIELDS, 90° ELBOWS NOT ACCEPTABLE.

NOTE: ALL PARTS OF SEPTIC SYSTEMS (I.E. TANK, DISTRIBUTION BOX TRENCHES) TO BE 100 FEET FROM WELL (UNLESS OTHERWISE SPECIFICALLY AUTHORIZED)

NOTE: IF DEEP TRENCH(ES) ARE USED CALL FOR INSPECTION BEFORE AND AFTER PLACING GRAVEL IN TRENCH(ES)

NOTE: NO DRY WELL SHALL EXCEED 15 FOOT IN DIAMETER NO ABSORPTION TRENCH TO EXCEED 100 FEET IN LENGTH

NOTE: ALL PIPE FROM HOUSE TO SEPTIC TANK MUST BE CAST IRON OR SCHEDULE 35/40 PVC OR ABS

PERMIT VOID AFTER TWO YEARS

NOTE: INSTALL STAND PIPE ON SEPTIC TANK AND DRY WELL STAND PIPES MUST BE 6 INCHES IN DIAMETER CAST IRON, CONCRETE OR TERRA COTTA OR PVA OR ABS ACCEPTED. IF TOP OF SEPTIC TANK IS DEEPER THAN 3 FEET. MANHOLE TO GRADE REQUIRED.

NOTE: DISTRIBUTION BOXES MUST HAVE BAFFLES

**\*INSTALLER IS RESPONSIBLE FOR OBTAINING FINAL APPROVAL ON THIS PERMIT**

A

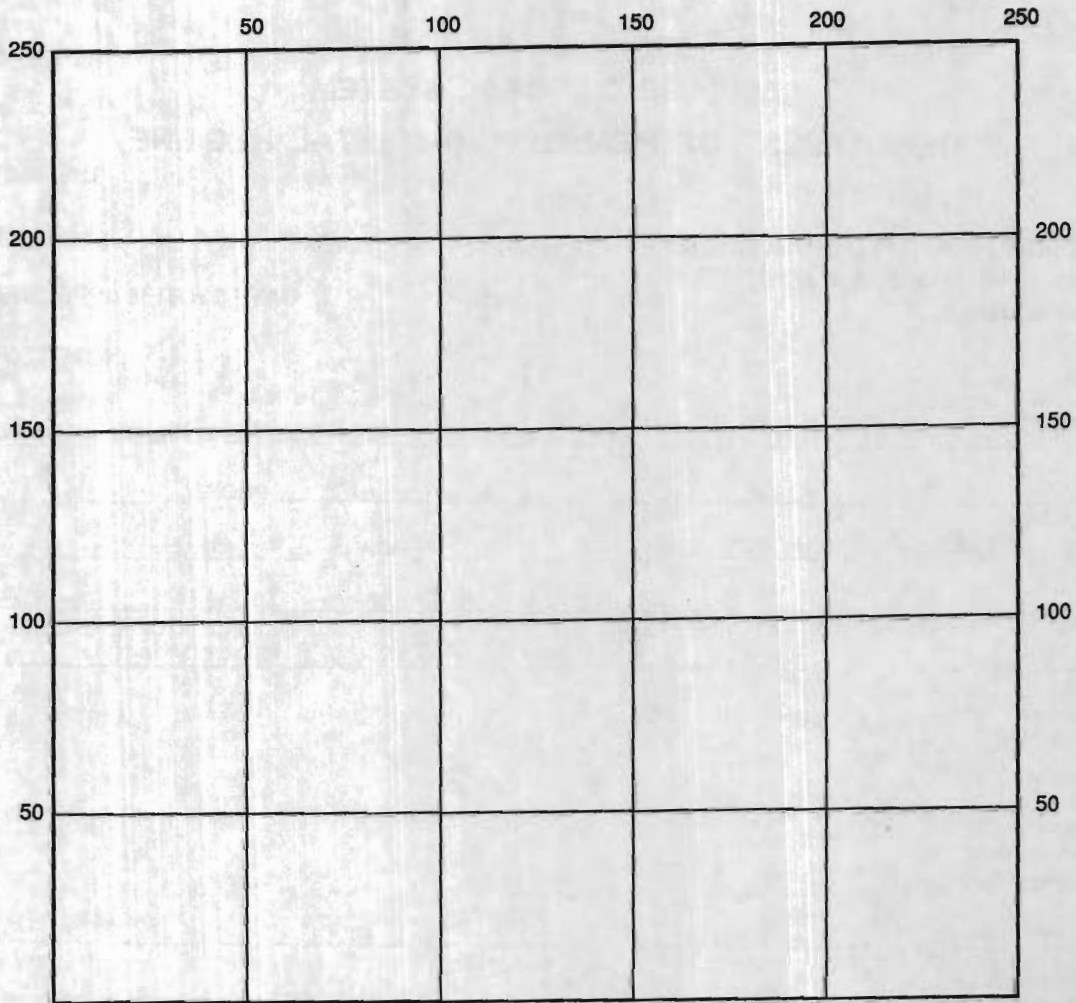

INDICATE NORTH - NAME ADJOINING ROADWAY AS BASE LINE

SEPTIC TANK LEVEL \_\_\_\_\_ CLEANOUTS \_\_\_\_\_

DISTRIBUTION BOX LEVEL \_\_\_\_\_

DRAIN FIELD/TITLE DEPTH \_\_\_\_\_ FT. TRENCH WIDTH \_\_\_\_\_ FT. INLET DEPTH \_\_\_\_\_ FT.

EFFECTIVE GRAVEL DEPTH \_\_\_\_\_ FT. TOTAL LENGTH \_\_\_\_\_ FT.

NUMBER OF TRENCHES \_\_\_\_\_ ONE SIDEWALL/BOTTOM AREA \_\_\_\_\_ SQ. FT.

DRYWALL INSIDE DIAMETER \_\_\_\_\_ FT. EFFECTIVE DEPTH BELOW INLET \_\_\_\_\_ FT.

ABSORBENT AREA \_\_\_\_\_ SQ. FT.

REMARKS: \_\_\_\_\_

\_\_\_\_\_

\_\_\_\_\_

\_\_\_\_\_

\_\_\_\_\_

DATE SYSTEM APPROVED \_\_\_\_\_ INSPECTOR \_\_\_\_\_

House is visible  
from R.P.

Near ANNAPOLIS ROCK  
- OPPOSITE SIDE OF STREET.

7/14/97  
ANYTIME

REPLACEMENT WELL SITE INSPECTION - SEPTIC REPAIR

OWNER SENECA STATE PARK

DATE REQUESTED 10/23/92 11:00

ADDRESS 3770 ROUTE 94

CONTRACTOR  
DRILLER \_\_\_\_\_

WELL TAG# \_\_\_\_\_

COUNTY# \_\_\_\_\_

DIRECTIONS - ROUTE 94 S.  
DRIVEWAY ON RIGHT  
JUST BEFORE ANNAPOLIS ROCK R.D.

LOCATION DIAGRAM

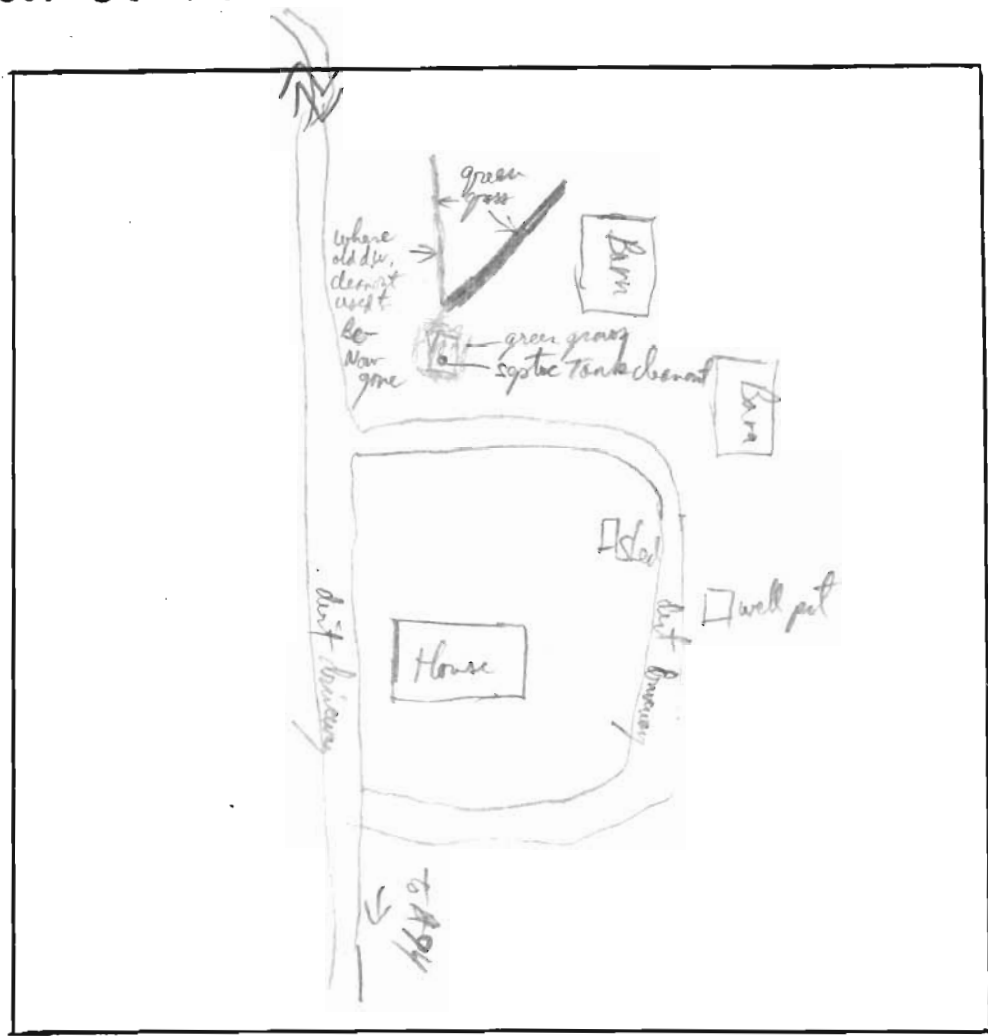

COMMENTS: Diagonal area of green grass in otherwise dry lawn may indicate where a repair septic  
trench or a runoff drain pipe may have been installed. Old cleanout pipe to old drywell has been removed,  
but septic tank cleanout is apparent to 6" and is dry. No sewage seepage observable. Nov. PJP 7/15/95

REPLACEMENT WELL SITE INSPECTION - SEPTIC REPAIR

OWNER SENECA STATE PARK

DATE REQUESTED 10/23/92 11:00

ADDRESS 3770 ROUTE 94

CONTRACTOR  
DRILLER \_\_\_\_\_

WELL TAG# \_\_\_\_\_

COUNTY# \_\_\_\_\_

DIRECTIONS - ROUTE 94 S.  
DRIVEWAY ON RIGHT  
JUST BEFORE ANNAPOLIS ROCK RD.

LOCATION DIAGRAM

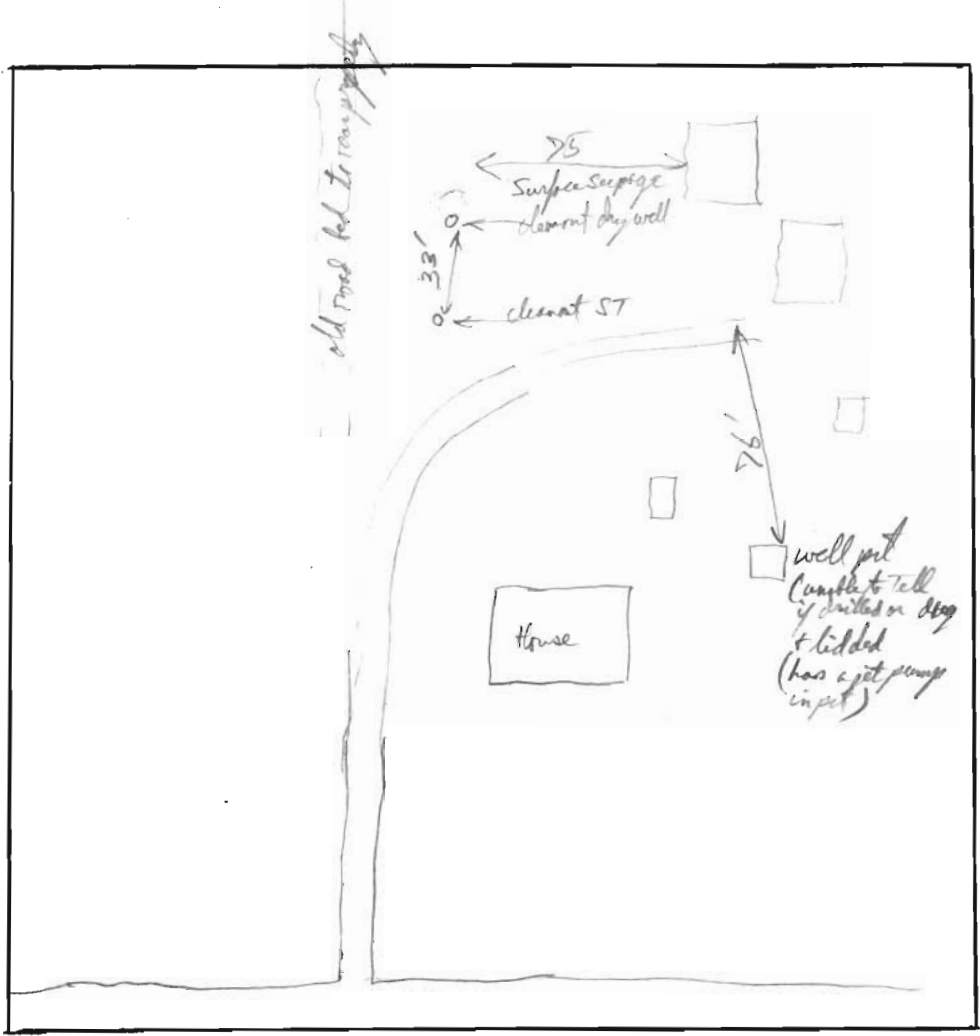

COMMENTS: Need to have pit test (area is 75'x75')

---

---

---

---

---

# Howard County Health Department

Bureau of Environmental Health, Ellicott City, Md. [REDACTED] 313-2640

SEWAGE DISPOSAL PERMIT NO. A-Repair P-\_\_\_\_\_

PERMITTEE \_\_\_\_\_

LOCATION 3770 Route 94  
(Tenant-Mathis - Contact - Kendall Math)

Do Not Cover Work Until Health Department Approval Appears On This Card

## NOTICE

**STOP ALL CONSTRUCTION ON SEWAGE DISPOSAL SYSTEM AND CONTACT HEALTH DEPARTMENT BEFORE CONTINUING**

\_\_\_\_\_  
Inspector Date

**WORK IS SATISFACTORY, CONTINUE**

\_\_\_\_\_  
Inspector Date

**FINAL INSPECTION MADE,  
COVER ALL WORK**

\_\_\_\_\_  
Inspector Date

\_\_\_\_\_  
\_\_\_\_\_  
\_\_\_\_\_

**POST THIS CARD WHERE IT CAN BE SEEN FROM ROAD**

Howards County Health Department

POW NEXT TIME YOU'RE IN THE FIELD...

To: Inspector

CW

Repair was scheduled in 1992. Reason for investigation appears to be a request by maintenance chief at State Park. Because it was never repaired - system may be failing - please confirm

Thanks

From: ALM

POW TO Insp.

Date: 7/14/97

7/15/97

HD-170

IMPORTANT MESSAGE

TO: CW

DATE: 8/19/92 TIME: A.M. P.M.

WHILE YOU WERE OUT

Mr. Kendall Mott

OF

Area Code & Exchange: 1-301-924-2127

Table with 4 columns: TELEPHONED, PLEASE CALL, CALLED TO SEE YOU, WILL CALL AGAIN, WANTS TO SEE YOU, URGENT, RETURNED YOUR CALL

Message: Concerning repair at the existing house in the park.

DISCUSSED 8/21/92

Operator: Will arrange for contractor and call to schedule.

ROUTAL HOUSE - FEE EXPECTED

G. Kendall Mott Maintenance Chief

Office (301) 924-2127 Fax (301) 258-9607



Maryland Department of Natural Resources

Seneca Creek State Park 11950 Clopper Road Gaithersburg, Maryland 20878

24 Hour Violations: Call 1-800-825-PARK