

**Bureau of Environmental Health**  
 8930 Stanford Boulevard, Columbia, MD 21045  
 Main: 410-313-2640 | Fax: 410-313-2648  
 TDD 410-313-2323 | Toll Free 1-866-313-6300  
[www.hchealth.org](http://www.hchealth.org)  
 Facebook: [www.facebook.com/hocohealth](https://www.facebook.com/hocohealth)

Maura J. Rossman, M.D., Health Officer

RECEIPT DATE: 4/15/2026 **ONSITE SEWAGE DISPOSAL SYSTEM** P 591016

APPROVAL DATE: 4/22/2026 **PERMIT: REPAIR - Minor** A Repair  
*Kmw*  
**Repair**

PROPERTY ADDRESS: 925 Sunset Valley Drive

SUBDIVISION: n/a LOT: n/a TAX ID: 03-307875

CONTRACTOR: South Carroll Backhoe EMAIL: skbackhoe@comcast.net

CONTRACTOR ADDRESS: 4410 Salem Bottom Road, Wesminster MD 21157 PHONE: 410-596-3618

PROPERTY OWNER: Bruce Lynch EMAIL: n/a

OWNER ADDRESS: \_\_\_\_\_ PHONE: n/a

SEPTIC TANK SIZE: Existing PUMP SIZE: n/a PUMP TANK CAPACITY: n/a

DISTRIBUTION SYSTEM:  GRAVITY  PRESSURE DOSED BEDROOMS: 4 APPLICATION RATE: n/a

TRENCHES:	LINEAR FEET REQUIRED: <u>n/a</u>	INLET DEPTH: <u>n/a</u>
	TRENCH WIDTH: <u>n/a</u>	MAXIMUM BOTTOM DEPTH: <u>n/a</u>
	MINIMUM SPACE BETWEEN TRENCHES: <u>n/a</u>	EFFECTIVE AREA BEGINNING DEPTH: <u>n/a</u>

LOCATION: **TO BE STAKED BY SANITARIAN DURING PRE-CONSTRUCTION INSPECTION.**

NOTES: Replace existing sewer line from existing septic tank with new sch40 pipe. Install new distribution box in same location.

ISSUED BY: K. Wolf, L.E.H.S. ISSUE DATE: 4/22/2026 EXPIRATION DATE: 4/22/2027

- NOTE: CONTRACTOR MUST SCHEDULE A PRE-CONSTRUCTION INSPECTION PRIOR TO BEGINNING ANY INSTALLATION
- NOTE: CONTRACTOR MUST SCHEDULE AN INSPECTION AND GAIN APPROVAL OF ALL COMPONENTS PRIOR TO COVERING
- NOTE: STONE MUST BE APPROVED BY HEALTH DEPARTMENT AND GRAVEL TICKET MUST BE AVAILABLE FOR REVIEW.
- NOTE: WATERTIGHT SEPTIC TANKS REQUIRED
- NOTE: ALL PARTS OF SEPTIC SYSTEM SHALL BE AT LEAST 100 FEET DOWNGRADIENT FROM ANY WATER WELL
- NOTE: MANHOLE RISERS REQUIRED ON ALL SEPTIC TANKS AND PUMP CHAMBERS
- NOTE: AN ELECTRICAL PERMIT IS REQUIRED FOR INSTALLATION OF ANY ELECTRICAL COMPONENTS OF THE SYSTEM  
 ELECTRICAL PERMIT ISSUED E n/a
- NOTE: THE HCHD DOES NOT WARRANT ANY SYSTEM AND CANNOT GUARANTEE THE PERFORMANCE OF THIS SYSTEM AS DESIGNED. BY ACCEPTING THIS PERMIT, THE OWNER AND/OR APPLICANT ACKNOWLEDGE THAT THE SPECIFICATIONS DETAILED IN THIS DESIGN ARE ONE POSSIBLE OPTION AND THAT THE HCHD WILL REVIEW OTHER PROPOSALS. YOU HAVE THE OPTION TO SEEK THE ADVICE OF A QUALIFIED DESIGN CONSULTANT OR PROFESSIONAL ENGINEER FOR FURTHER GUIDANCE.
- NOTE: AN INDIVIDUAL CERTIFIED BY MDE AND THE MANUFACTURER FOR BAT INSTALLATION MUST BE PRESENT AT ALL TIMES DURING BAT INSTALLATION.
- NOTE: MDE RECOMMENDS SEPTIC TANKS, BAT, AND OTHER PRETREATMENT UNITS BE PUMPED AT A FREQUENCY ADEQUATE TO ENSURE THAT SOLIDS ARE NOT DISCHARGED TO THE DISPOSAL AREA

**NEITHER THE HOWARD COUNTY COUNCIL NOR THE HEALTH DEPARTMENT IS RESPONSIBLE FOR THE SUCCESSFUL OPERATION OF ANY SYSTEM. PERMITTEE RESPONSIBLE FOR OBTAINING FINAL APPROVAL ON THIS PERMIT. CALL 410-313-1771 TO SCHEDULE INSPECTIONS.**

NOT TO SCALE

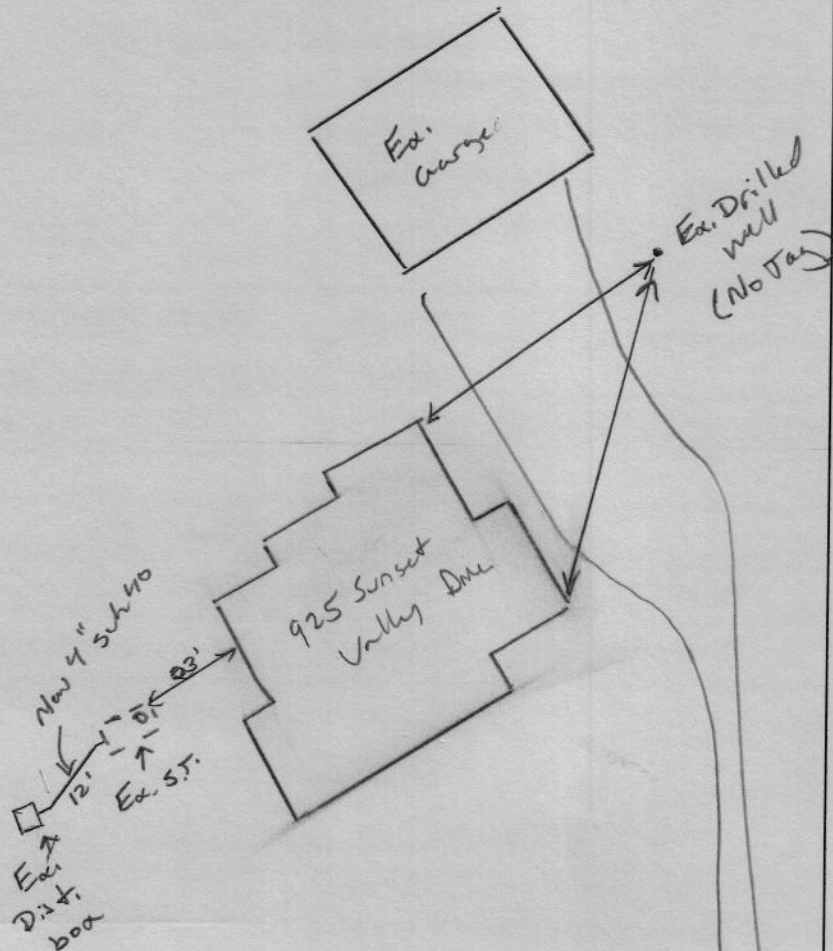

ROAD NAME \_\_\_\_\_

**TRENCH/DRAINFIELD DATA**

WIDTH	INLET	BOTTOM
_____	_____	_____
NUMBER OF TRENCHES _____		
TOTAL LENGTH _____		
ABSORPTION AREA _____		
DISTRIBUTION BOX LEVEL _____		
DISTRIBUTION BOX BAFFLE _____		
DISTRIBUTION BOX PORT _____		

**SEPTIC TANK DATA**

SEPTIC TANK 1 LEVEL \_\_\_\_\_

MANUFACTURER \_\_\_\_\_

CAPACITY \_\_\_\_\_ GAL

SEAM LOC \_\_\_\_\_

TANK LID DEPTH \_\_\_\_\_

BAFFLES \_\_\_\_\_

BAFFLE FILTER \_\_\_\_\_

MANHOLE LOC \_\_\_\_\_

6" PORT LOC \_\_\_\_\_

WATERTIGHT TEST \_\_\_\_\_

SLOTTED \_\_\_\_\_

DATE ON LID \_\_\_\_\_

PUMP/SEPTIC TANK LEVEL \_\_\_\_\_

MANUFACTURER \_\_\_\_\_

CAPACITY \_\_\_\_\_ GAL

SEAM LOC \_\_\_\_\_

TANK LID DEPTH \_\_\_\_\_

BAFFLES \_\_\_\_\_

BAFFLE FILTER \_\_\_\_\_

MANHOLE LOC \_\_\_\_\_

6" PORT LOC \_\_\_\_\_

WATERTIGHT TEST \_\_\_\_\_

SLOTTED \_\_\_\_\_

DATE ON LID \_\_\_\_\_

SEPTIC CONTRACTOR ONSITE INSTALLING SYTEM: Yes Ken Schwab

SEPTIC CONTRACTOR ONSITE LICENSED WITH THE STATE OF MD: YES/NO

PRE-CONSTRUCTION NOTES:

4/22/2026 Plan approved. OK to issue permit (Ken)

**CONTROL PANEL DATA**

CONTROL PANEL HEIGHT \_\_\_\_\_ (MIN 30")

INSPECTION DATE \_\_\_\_\_

INSPECTION: PASS/FAIL (CIRCLE ONE)

INSTALLATION NOTES:

4/22/2026 Onsite for inspection. New 4" sub HO pipe installed from ex. S.T. to ex. Dbox. Distribution box cleaned out by installer. No need to replace, installer mentioned it was in good condition (Ken)

FINAL INSPECTOR K. Wolf DATE OF APPROVAL 4/22/2026

SP with CANOLI  
Backhoe  
Plan Prepare  
Ken Schissler  
installer  
11 Berem

Bruce & Ginger Lynch  
925 Sunset Valley  
Sykesville MD 21784  
Buyer Patrick Mulliney

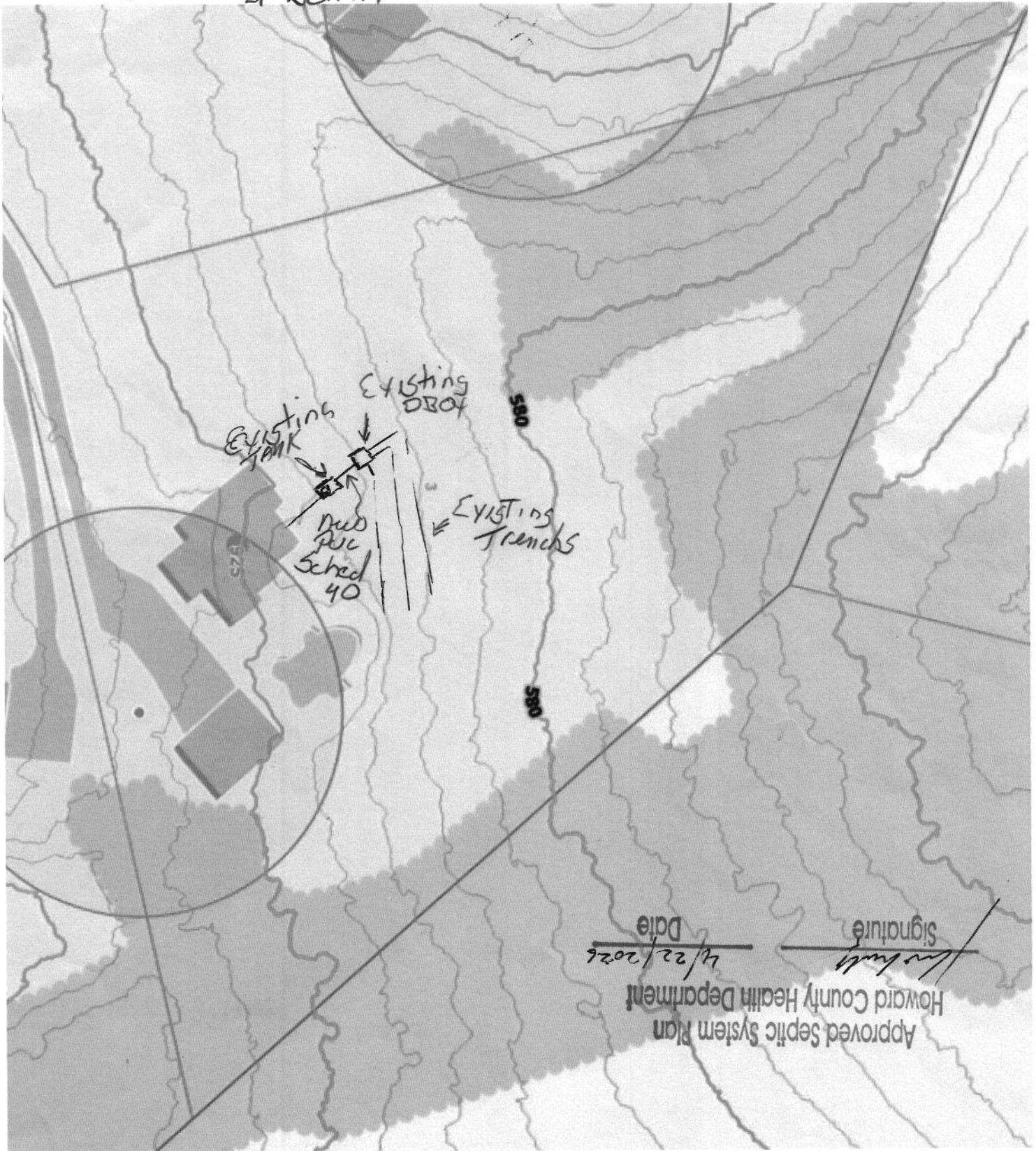

Pumping Septic Tank  
Replacing Line from back of Tank to D. Boy  
including replace D Boy due to roots

# HOME LAND

## ENVIRONMENTAL

homelandhealthyhomes.com | 443.995.5385 | [info@homelandhealthyhomes.com](mailto:info@homelandhealthyhomes.com)  
 Headquarters- 1220 East Joppa Road, Towson MD 21286

<b>Date:</b> March 31, 2026 <b>Name of Evaluator:</b> Tyler Young <b>Time:</b> 8:00 AM <b>Property Address:</b> 925 Sunset Valley Drive Sykesville, MD 21784 <b>Recent Weather Conditions:</b> Normal	<b>Ordered By:</b> Lucy Renehan  <b>Buyers:</b> Patrick Mullinex  <b>Homeowner Interview:</b> The homeowner interview was sent and received prior to the evaluation.	<b>Occupied:</b> <input checked="" type="checkbox"/> Yes <input type="checkbox"/> No <b>Length of Time Vacant:</b> N/A <b># of People Living in Home:</b> 4 <b># of People moving in:</b> 2 <b>Property Age:</b> 1990 <b>System Age:</b> 1990 <b>Last Date of Cleaning:</b> Unknown <b>Recomm'd Pumping Freq:</b> 3-4 Years
<b>Liquid level in tank is:</b> <input type="checkbox"/> Above Normal <input checked="" type="checkbox"/> Normal <input type="checkbox"/> Below Normal		<b>Bottom Solids Depth:</b> >24 Inches
<b>Depth of tank:</b> 17 Inches	<b>Type of Tank Access:</b> Cleanout	<b>Depth of tank access:</b> At Grade
<b>Maintenance appears:</b> <input type="checkbox"/> Good <input type="checkbox"/> Fair <input checked="" type="checkbox"/> Poor	<b># of Bedrooms:</b> 4	<b>Depth to Distribution Box:</b> ~45"
<b>Effluent Filter present:</b> <input type="checkbox"/> Yes <input checked="" type="checkbox"/> No	<b>Previous high liquid level:</b> <input checked="" type="checkbox"/> Yes <input type="checkbox"/> No	<b>Distance to well:</b> ~130 Feet
<b>Records Search:</b> Records were requested and received from Howard County prior to the evaluation.		
<b>Were there any impermeable surfaces above the septic system (i.e. driveway)?</b> <input type="checkbox"/> Yes <input checked="" type="checkbox"/> No		
Type of Tank	Tank Composition and Size	Type of Absorption System
<input checked="" type="checkbox"/> Septic Tank (1 Tank)	<input type="checkbox"/> Metal <input checked="" type="checkbox"/> Concrete <input type="checkbox"/> Plastic	<input checked="" type="checkbox"/> Leaching Field <input type="checkbox"/> Raised Mound
<input type="checkbox"/> Aeration System	<input type="checkbox"/> Tank Size: 1,250 gallons	<input type="checkbox"/> Drywell (Number of: ) <input type="checkbox"/> Cesspool
<input type="checkbox"/> Other:	<input type="checkbox"/> Unknown: _____	<input type="checkbox"/> _____
System Component	Condition	Comments
<b>Septic Tank</b>	<input checked="" type="checkbox"/> Acceptable <input type="checkbox"/> Unacceptable <input type="checkbox"/> Needs Further Evaluation	The septic tank is 1,250 gallons in capacity and composed of concrete. The tank is 17 inches below grade; a 6" PVC cleanout serves as access at grade. The front and back baffles are in place and composed of concrete. The solids level in the tank is greater than 24 inches, indicating poor maintenance. It is recommended that the tank be cleaned, then every 3-4 years thereafter. During the inspection, root intrusion was observed around the inlet of the tank. These roots were not causing an issue at the time of inspection but should be removed and the area around the inlet be properly sealed. Due to these roots around the inlet, this system is labeled as, "Acceptable with Concerns".
<b>Absorption System</b>	<input type="checkbox"/> Acceptable <input checked="" type="checkbox"/> Unacceptable <input type="checkbox"/> Needs Further Evaluation	Per county records, the absorption system is composed of a distribution box and 3 drainfields. The distribution box was located with a camera and found to be approximately 45 inches below grade. Each drainfield was probed and found to be dry to the top of the stone. During the hydraulic load test, a backup occurred in the d-box and back line, then slowly receded. The distribution box and surrounding piping should be assessed and remediated by a licensed septic contractor. Proper remediation may require the replacement of system components. At the time the system is remediated, a full hydraulic load test can be performed.

# HOME LAND

## ENVIRONMENTAL

homelandhealthyhomes.com | 443.995.5385 | [info@homelandhealthyhomes.com](mailto:info@homelandhealthyhomes.com)  
Headquarters- 1220 East Joppa Road, Towson MD 21286



**Picture 1:**

Showing root intrusion around the inlet of the septic tank.



**Picture 2:**

Showing a backup occurring in the back line of the septic tank.

# HOME LAND

## ENVIRONMENTAL

homelandhealthyhomes.com | 443.995.5385 | [info@homelandhealthyhomes.com](mailto:info@homelandhealthyhomes.com)  
Headquarters- 1220 East Joppa Road, Towson MD 21286



**Picture 3:**

Showing the locations of the septic tank (red arrow), distribution box (yellow arrow), and located drainfields (blue arrows). Please note the large tree near the d-box. Removal of this tree may be necessary for future repairs.

Additionally, minor depressions were observed over the drainfields. It is suggested these areas be leveled to prevent stormwater from pooling over the drainfields.



**Picture 4:**

Showing stone residue from probing the located drainfields.



# HOME LAND ENVIRONMENTAL

homelandhealthyhomes.com | 443.995.5385 | [info@homelandhealthyhomes.com](mailto:info@homelandhealthyhomes.com)  
Headquarters- 1220 East Joppa Road, Towson MD 21286

## Sketch of System

**PLEASE REFER TO SEPARATE DOCUMENT FOR DETAILED SKETCH.**

### DISCLAIMERS

- This is a subjective and visual inspection only, the conclusions of which are based on the observed condition of the system components that could reasonably be accessed, and information known about the system at the time this report was completed. There may be unknown historical problems or unseen conditions which may compromise the conclusions stated in this report.
- Suggestions or recommendations for repairs or remediation may result in the need for further repair or remediation once the system components are fully excavated.
- A 'Satisfactory' evaluation does not mean the system will meet the local approving authority's criteria for determining compliance with state code: COMAR 26.04.02.02 D(4).
- The evaluation of the Sewage Disposal System as reported is based on the conditions observed on the day of the inspection.
- This report is neither a WARRANTY nor does it GUARANTEE continued acceptable functionality or performance of the Sewage Disposal Systems operations.
- If the house has been unoccupied the findings in this report may not be accurate, as limited or no use of the system may conceal or mask problems that may be revealed under typical sewage loading.
- If the general ground condition is excessively wet at the time of inspection, the findings in this report may not be accurate, as ground moisture may cover or hide septic effluent that may be on or near the ground surface.
- If the house is vacant or the conditions excessively wet during inspection, it is recommended that the system be reevaluated at a later date and/or alternate techniques be used to address those potential issues.
- Payment and/or use of this evaluation signify understanding and acceptances of the above clauses, as well as any noted faults with the system.

Representative's Signature:		Date: 3/31/2026
-----------------------------	--	-----------------

