

DEPARTMENT OF INSPECTIONS, LICENSES AND PERMITS 3430 COURT HOUSE DRIVE ELICOTT CITY, MD 21043 PERMITS (410) 313-2455 INSPECTIONS (410) 313-1810 AUTOMATED INFORMATION (410) 313-3800		HOWARD COUNTY PERMIT APPLICATION		PERMIT NUMBER B08003330	
Building Address <u>2670 Wynfield Road</u> <u>West Friendship, MD 21794</u>			Property Owner's Name <u>Joseph & Diana Dorsch</u>		
Suite/Apt. # <u>-</u> SDP/W/P/Petition #: <u>5457</u>			Address <u>2670 Wynfield Rd.</u>		
Census Tract <u>603000</u> Subdivision <u>West Friendship</u>			City <u>West Friendship</u> State <u>MD</u> Zip Code <u>21794</u>		
Section <u>-</u> Area <u>1</u> Lot <u>3</u>			Home Phone <u>410-442-1735</u> Work Phone <u>410-644-8400</u>		
Tax Map <u>15</u> Parcel <u>243</u> Grid <u>18</u>			Applicant's Name & Mailing Address, (if other than stated hereon):		
Zoning <u>RR</u> Map Coordinates Lot size <u>6.48</u>			Phone Fax		
Existing Use <u>Residential</u>			Contractor Company <u>Wall To Wall Construction LLC</u>		
Proposed Use <u>Residential</u>			Contact Person <u>Greg Wall / Rich English</u>		
Estimated Construction Cost \$ <u>180,000.00</u>			Address <u>9 Newburg Ave., Suite 100</u>		
Description of Work <u>16x16 Morning Room,</u> <u>24x10 Covered Porch #1, 20x7 Covered</u> <u>Arch #2, 14x15 Exercise Room,</u> <u>37x3 Covered Walkway</u>			City <u>Catonsville</u> State <u>MD</u> Zip Code <u>21228</u>		
Occupant/Tenant <u>Occupant</u>			License No. <u>123700</u>		
Contact Name <u>Joseph & Diana Dorsch</u>			Phone <u>410-788-3990</u> Fax <u>410-788-5330</u>		
Address <u>2670 Wynfield Rd.</u>			Engineer or Architect Company		
City <u>West Friendship</u> State <u>MD</u> Zip Code <u>21794</u>			Contact Person		
Phone <u>410-442-1735</u> Fax <u>N/A</u>			Address <u>Same as above</u>		
			City State Zip Code		
			Phone Fax		

BUILDING DESCRIPTION - COMMERCIAL		BUILDING DESCRIPTION - RESIDENTIAL	
<u>Building Characteristics</u>	<u>Utilities</u>	<u>Building Characteristics</u>	<u>Utilities</u>
Height:	Water Supply: <input type="checkbox"/> Public <input type="checkbox"/> Private	SF Dwelling <input checked="" type="checkbox"/> SF Townhouse <input type="checkbox"/> Depth Width	Water Supply: <input type="checkbox"/> Public <input checked="" type="checkbox"/> Private
No. of stories:	Sewage Disposal: <input type="checkbox"/> Public <input type="checkbox"/> Private	1st floor:	Sewage Disposal: <input type="checkbox"/> Public <input checked="" type="checkbox"/> Private
Gross area, sq. ft. per floor:	Electric Yes <input type="checkbox"/> No <input type="checkbox"/> Gas Yes <input type="checkbox"/> No <input type="checkbox"/>	2nd floor:	Electric Yes <input checked="" type="checkbox"/> No <input type="checkbox"/> Gas Yes <input type="checkbox"/> No <input type="checkbox"/>
Use group:	Heating System: <input type="checkbox"/> Electric <input type="checkbox"/> Oil <input type="checkbox"/> <input type="checkbox"/> Natural Gas <input type="checkbox"/> Propane Gas <input type="checkbox"/>	Basement:	Heating System: <input type="checkbox"/> Electric <input type="checkbox"/> Oil <input type="checkbox"/> <input type="checkbox"/> Natural Gas <input type="checkbox"/> Propane Gas <input type="checkbox"/>
Construction type:	Sprinkler system: <input type="checkbox"/> Full <input type="checkbox"/> Partial <input type="checkbox"/> Other Suppression <input type="checkbox"/> # of Heads	Finished Basement <input checked="" type="checkbox"/> Unfinished Basement <input type="checkbox"/> Crawl space <input type="checkbox"/> Slab on Grade <input type="checkbox"/>	Sprinkler system: <input type="checkbox"/> N/A <input type="checkbox"/> NFPA #13D <input type="checkbox"/> NFPA #13R <input type="checkbox"/> Other:
<input type="checkbox"/> Reinforced Concrete		No. of Bedrooms	
<input type="checkbox"/> Structural Steel		Height:	
<input type="checkbox"/> Masonry		Multi-family dwellings:	
<input type="checkbox"/> Wood Frame		No. of efficiency units:	
<input type="checkbox"/> State Certified Modular		No. of 1 BR units:	
		No. of 2 BR units:	
		No. of 3 BR units:	
		Other Structure:	
		Dimensions:	
		Footings:	
		Roof Height:	
		<input type="checkbox"/> State Certified Modular	
		<input type="checkbox"/> Manufactured Home	

THE UNDERSIGNED HEREBY CERTIFIES AND AGREES AS FOLLOWS: (1) THAT HE/SHE IS AUTHORIZED TO MAKE THIS APPLICATION; (2) THAT THE INFORMATION IS CORRECT; (3) THAT HE/SHE WILL COMPLY WITH ALL REGULATIONS OF HOWARD COUNTY WHICH ARE APPLICABLE THERETO; (4) THAT HE/SHE WILL PERFORM NO WORK ON THE ABOVE REFERENCED PROPERTY NOT SPECIFICALLY DESCRIBED IN THIS APPLICATION; (5) THAT HE/SHE GRANTS COUNTY OFFICIALS THE RIGHT TO ENTER ONTO THIS PROPERTY FOR THE PURPOSE OF INSPECTING THE WORK PERMITTED AND POSTING NOTICES.

Applicant's Signature _____ Print Name _____
Title/Company _____ Date _____

Checks payable to: **DIRECTOR OF FINANCE OF HOWARD COUNTY**
** PLEASE WRITE NEATLY AND LEGIBLY. **
- FOR OFFICE USE ONLY -

AGENCY	DATE	SIGNATURE APPROVAL
Land Development, DPZ	11-6-08	[Signature]
State Highways		
Building Official		
Dev. Engineering, DPZ	11/6/08	[Signature]
Health		
Fire Protection		

Is Sediment Control approval required prior to issuance?
YES ☐ NO ☐

CONTINGENCY CONSTRUCTION START: ☐
ONE STOP SHOP: ☐

Distribution of Copies-
T:\forms\PERMIT.FRM

White: Building Official

Green: LDD, DPZ

Yellow: DED, DPZ

Pink: Health

Gold: SHA

DPZ SETBACK INFORMATION		PROPERTY ID#:
Front: <u>125</u>	Filing fee	\$
Rear: <u>60</u>	Permit fee	\$
Side: <u>30</u> / <u>N/A</u>	Excise tax	\$
Side St.:	Add'l per. fee	\$
All minimum setbacks met?	TOTAL FEES	\$
YES <input type="checkbox"/> NO <input type="checkbox"/>	Sub-total paid	\$
Is Entrance Permit required?	Balance due	\$
YES <input type="checkbox"/> NO <input checked="" type="checkbox"/>	Check	#
Historic District?	Validation	#
YES <input type="checkbox"/> NO <input checked="" type="checkbox"/>		
Lot Coverage for NewTown Zone		
SDP/Red-line approval date		

Accepted by _____

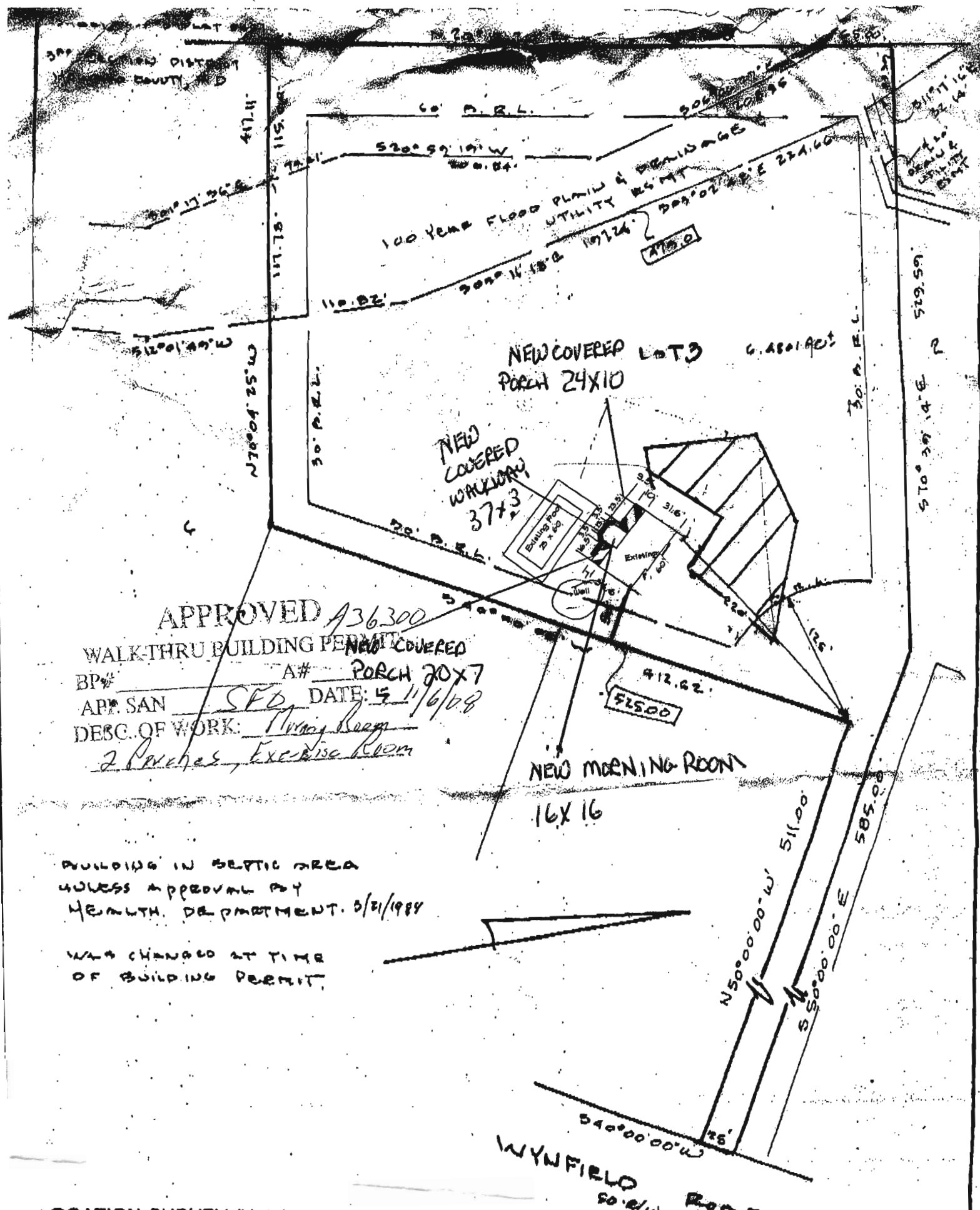

APPROVED A36300

WALK-THRU BUILDING PERMIT
 BP# _____ A# _____
 APP. SAN _____ DATE: 5/11/68
 DESC. OF WORK: Moving Room
2 Porches, Exercise Room

BUILDING IN SEPTIC AREA
 UNLESS APPROVAL BY
 HEALTH DEPARTMENT. 5/31/1988

WAS CHANGED AT TIME
 OF BUILDING PERMIT.

LOCATION SURVEY PLAT
 SUBJECT PROPERTY NOT LOCATED IN A FLOOD PLAIN AREA UNLESS OTHERWISE NOTED

CERTIFICATION	SEAL	SCALE 1"=100' DATED 5-21-1988
<p>This is to certify that I have surveyed the property known as: <u>2670</u> <u>WYNFIELD ROAD</u></p> <p>for the purpose of locating the improvements thereon, and the improvements are located as shown.</p>	 <u>Walter Park</u>	<p>Columbia: 730-9060 Towson: 828-9060</p> <p>M & H DEVELOPMENT ENGINEERS, INC. Surveyors and Subdivision Designers</p> <p>231 Harpers Choice Village Center 5485 Harpers Farm Road Columbia, Md. 21044</p> <p>WALTER PARK REG. L.S. 5539</p>