



Howard County  
Health Department

# APPLICATION

## FOR PERCOLATION TESTING AND SITE EVALUATION

TEST DATE(S) \_\_\_\_\_ TEST TIME \_\_\_\_\_ A/P 520113  
 AGENCY REVIEW: \_\_\_\_\_ DATE \_\_\_\_\_

DO NOT WRITE ABOVE THIS LINE

I HEREBY APPLY FOR THE NECESSARY TESTING/EVALUATION PRIOR TO ISSUANCE OF SEWAGE DISPOSAL SYSTEM PERMIT(S) TO:

CHECK AS NEEDED:

- CONSTRUCT NEW SEPTIC SYSTEM(S)
- REPAIR/ADD TO AN EXISTING SEPTIC SYSTEM
- REPLACE AN EXISTING SEPTIC SYSTEM

CHECK AS NEEDED:

- NEW STRUCTURE(S)
- ADDITION TO AN EXISTING STRUCTURE
- REPLACE AN EXISTING STRUCTURE

CHECK ONE:

- CREATE NEW LOT(S)
- BUILD ON AN EXISTING LOT IN A SUBDIVISION
- BUILD ON AN EXISTING PARCEL OF RECORD

IS THE PROPERTY WITHIN 2500' OF ANY RESERVOIR?

- YES
- NO

THE TYPE OF STRUCTURE IS:

- RESIDENTIAL WITH \_\_\_\_\_ PROPOSED BEDROOMS IN THE COMPLETED STRUCTURE (NOTE **UNKNOWN** IF APPROPRIATE)
- COMMERCIAL (PROVIDE DETAIL OF NUMBERS AND TYPES OF EMPLOYEES/ CUSTOMERS ON ACCOMPANYING PLAN)
- INSTITUTIONAL/GOVERNMENT (PROVIDE DETAIL OF NUMBERS AND TYPES OF EMPLOYEES/USERS ON ACCOMPANYING PLAN)

PROPERTY OWNER(S) Brown

DAYTIME PHONE \_\_\_\_\_ CELL \_\_\_\_\_ FAX \_\_\_\_\_

MAILING ADDRESS \_\_\_\_\_ STREET \_\_\_\_\_ CITY/TOWN \_\_\_\_\_ STATE \_\_\_\_\_ ZIP \_\_\_\_\_

APPLICANT FSH Assoc.

DAYTIME PHONE \_\_\_\_\_ CELL \_\_\_\_\_ FAX \_\_\_\_\_

MAILING ADDRESS \_\_\_\_\_ STREET \_\_\_\_\_ CITY/TOWN \_\_\_\_\_ STATE \_\_\_\_\_ ZIP \_\_\_\_\_

APPLICANT'S ROLE: DEVELOPER BUILDER BUYER RELATIVE/FRIEND REALTOR CONSULTANT

PROPERTY LOCATION  
 SUBDIVISION/PROPERTY NAME \_\_\_\_\_ LOT NO. 2/3

PROPERTY ADDRESS 13100 Clarksville Pike  
 STREET TOWN/POST OFFICE

TAX MAP PAGE(S) 34 GRID \_\_\_\_\_ PARCEL(S) 301 PROPOSED LOT SIZE \_\_\_\_\_

AS APPLICANT, I UNDERSTAND THE FOLLOWING: THE SYSTEM INSTALLED SUBSEQUENT TO THIS APPLICATION IS ACCEPTABLE ONLY UNTIL PUBLIC SEWERAGE IS AVAILABLE. THIS APPLICATION IS COMPLETE WHEN ALL APPLICABLE FEES AND A SUITABLE SITE PLAN HAVE BEEN RECEIVED. I ACCEPT THE RESPONSIBILITY FOR COMPLIANCE WITH ALL M.O.S.H.A. AND "MISS UTILITY" REQUIREMENTS. APPROVAL IS BASED UPON SATISFACTORY REVIEW OF A PERC CERTIFICATION PLAN. TEST RESULTS WILL BE MAILED TO APPLICANT.

\_\_\_\_\_  
 SIGNATURE OF APPLICANT

HOWARD COUNTY HEALTH DEPARTMENT, BUREAU OF ENVIRONMENTAL HEALTH, WELL AND SEPTIC PROGRAM  
 3525-H ELLICOTT MILLS DRIVE, ELLICOTT CITY, MARYLAND 21043-4544 (410) 313-1771 FAX (410) 313-2648  
 TDD (410) 313-2323 TOLL FREE 1-877-4MD-DHMH

5-20-113

AP 100  
 Strong Rd CLAY Loam  
 5 1/2'  
 V. Micac. red Loam to Sandy Loam  
 12'  
 Rv. Minimal Bottom

102  
 Red, red brn CL-SCLL  
 5 1/2'  
 rd brn Loamy SAND  
 Rock ~5%  
 12' wet soils  
 13' Bottom

103  
 RED CL  
 SLoam

12'  
 H2O Bottom

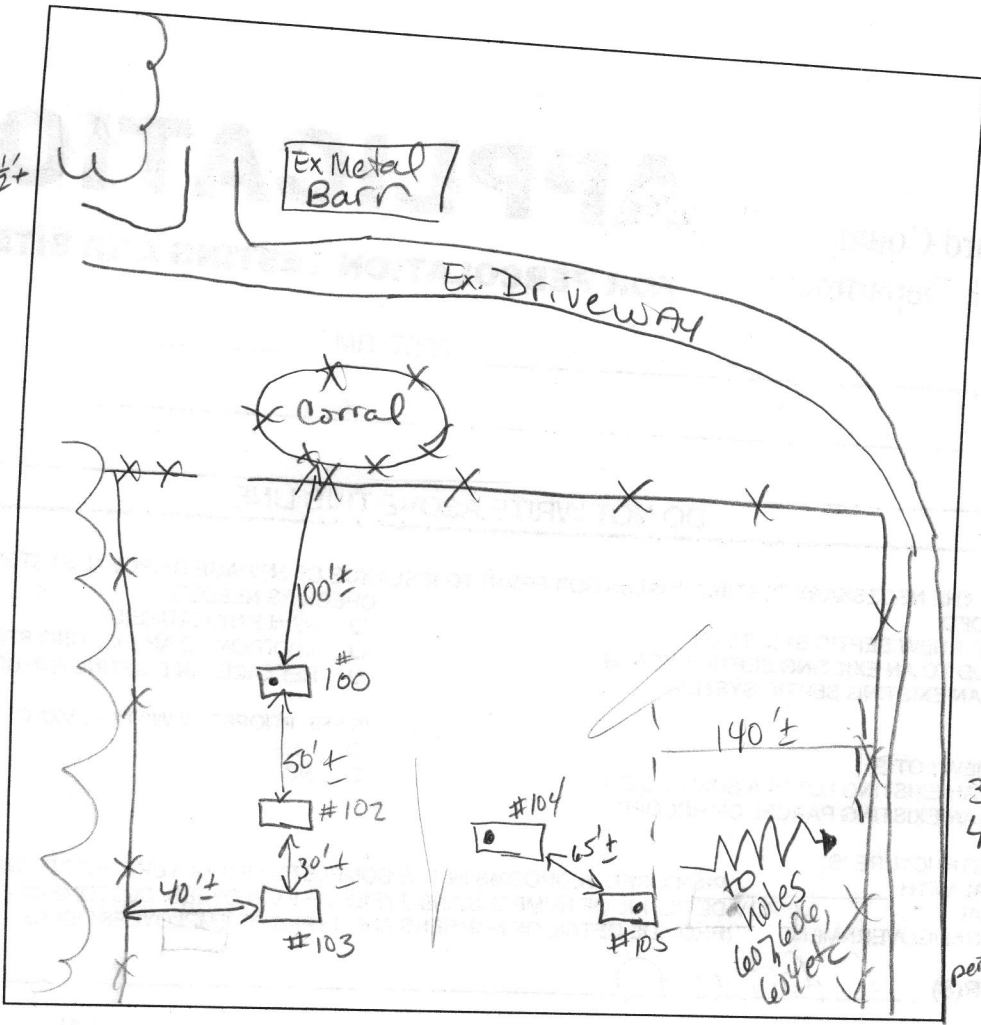

w/o SAND packet

105 / 104  
 Dense Red CLL  
 3 1/2'  
 4'  
 packets of 14 brn y brn SAND  
 Perc rate  
 Densely packed V. micac loam SIL Bottom

DATE	TEST #	DEPTH	START	BREAK 1" DROP	STOP 2" DROP	TIME OF 2nd INCH	P/F/H
4-30-04	100	6'S	1:29	1:33	1:37	5'	P
	102	5 1/2'S	1:38	1:40	1:43	3'	P
	104	4 1/2'S	2:00	2:10	2:30	20'	P
	#105	4 1/2'S	1:46 <sup>30</sup>	1:50	1:55	5'	P
		Kettermans dug hole in soil less description of most soils in this hole & surrounding holes					
		#105 soils like 104. Perc rate ~20 Min					
		ARBITRARY HOLE #s CHOSEN					
		FIELD locate NOTES					

REMARKS ADJUSTMENT TO LOT 2  
 SANITARIAN Kacie BACKHOE Ketterman OTHERS Mr. Brown  
 TEST HOLES USED IN SDA \_\_\_\_\_ AVG. PERC TIME \_\_\_\_\_ SQ. FT/BR \_\_\_\_\_  
 TRENCH WIDTH \_\_\_\_\_ INLET DEPTH \_\_\_\_\_ MAX. BOT DEPTH \_\_\_\_\_ EFFECTIVE SW \_\_\_\_\_

Lot 1 not in SDA



# APPLICATION

## FOR PERCOLATION TESTING AND SITE EVALUATION

TEST DATE(S) \_\_\_\_\_ TEST TIME \_\_\_\_\_

AP 520113-E

AGENCY REVIEW: \_\_\_\_\_

DATE 3/24/2004

DO NOT WRITE ABOVE THIS LINE

HEREBY APPLY FOR THE NECESSARY TESTING/EVALUATION PRIOR TO ISSUANCE OF SEWAGE DISPOSAL SYSTEM PERMIT(S) TO:

CHECK AS NEEDED:

- CONSTRUCT NEW SEPTIC SYSTEM(S)
- REPAIR/ADD TO AN EXISTING SEPTIC SYSTEM
- REPLACE AN EXISTING SEPTIC SYSTEM

CHECK AS NEEDED:

- NEW STRUCTURE(S)
- ADDITION TO AN EXISTING STRUCTURE
- REPLACE AN EXISTING STRUCTURE

CHECK ONE:

- CREATE NEW LOT(S)
- BUILD ON AN EXISTING LOT IN A SUBDIVISION
- BUILD ON AN EXISTING PARCEL OF RECORD

IS THE PROPERTY WITHIN 2500' OF ANY RESERVOIR?

- YES
- NO

THE TYPE OF STRUCTURE IS:

- RESIDENTIAL WITH UNKNOWN PROPOSED BEDROOMS IN THE COMPLETED STRUCTURE (NOTE UNKNOWN IF APPROPRIATE)
- COMMERCIAL (PROVIDE DETAIL OF NUMBERS AND TYPES OF EMPLOYEES/ CUSTOMERS ON ACCOMPANYING PLAN)
- INSTITUTIONAL/GOVERNMENT (PROVIDE DETAIL OF NUMBERS AND TYPES OF EMPLOYEES/USERS ON ACCOMPANYING PLAN)

PROPERTY OWNER(S) BERTRAM BROWN & NANCY BROWN

DAYTIME PHONE (301) 596-9882 CELL / FAX /

MAILING ADDRESS 13100 clarksville Pike Highland MD 20777  
STREET CITY/TOWN STATE ZIP

APPLICANT FSH ASSOCIATES c/o ZACHARIA Y. FISCH P.E.

DAYTIME PHONE (410) 750-2251 CELL / FAX (410) 750-7350

MAILING ADDRESS 8318 FORREST ST. ELLICOTT CITY MD. 21043  
STREET CITY/TOWN STATE ZIP

APPLICANT'S ROLE: DEVELOPER BUILDER BUYER RELATIVE/FRIEND REALTOR CONSULTANT

PROPERTY LOCATION  
SUBDIVISION/PROPERTY NAME BROWN PROPERTY LOT NO. 6

PROPERTY ADDRESS 13100 clarksville Pike HIGHLAND  
STREET TOWN/POST OFFICE

TAX MAP PAGE(S) 34 GRID 23 PARCEL(S) 301 PROPOSED LOT SIZE 1 AC ±

AS APPLICANT, I UNDERSTAND THE FOLLOWING: THE SYSTEM INSTALLED SUBSEQUENT TO THIS APPLICATION IS ACCEPTABLE ONLY UNTIL PUBLIC SEWERAGE IS AVAILABLE. THIS APPLICATION IS COMPLETE WHEN ALL APPLICABLE FEES AND A SUITABLE SITE PLAN HAVE BEEN RECEIVED. I ACCEPT THE RESPONSIBILITY FOR COMPLIANCE WITH ALL M.O.S.H.A. AND "MISS UTILITY" REQUIREMENTS. APPROVAL IS BASED UPON SATISFACTORY REVIEW OF A PERC CERTIFICATION PLAN.

TEST RESULTS WILL BE MAILED TO APPLICANT. Zacharia Y. Fisch  
SIGNATURE OF APPLICANT

HOWARD COUNTY HEALTH DEPARTMENT, BUREAU OF ENVIRONMENTAL HEALTH, WELL AND SEPTIC PROGRAM  
3525-H ELLICOTT MILLS DRIVE, ELLICOTT CITY, MARYLAND 21043-4544 (410) 313-1771 FAX (410) 313-2648  
TDD (410) 313-2323 TOLL FREE 1-877-4MD-DHMH

520113-D

AP \_\_\_\_\_

624B  
 Strong brn micac. SCLL  
 Rd CCL 23'  
 transition layer 4 1/2'  
 tan brn  
 Shoam  
 Very micac  
 (med gr. Sand)  
 Loamy S med lg 3' depth?  
 Sm hard frags sap. (Grave)  
 ~10-15" 13 1/2'

624C  
 highly micac  
 hvy L with SCLL packets 5'  
 H brn blue black V. micac.  
 med gr. Sand  
 Bottom 12'

624D  
 brn wk org brn SCLL  
 SBK structure  
 thin some weak plastic structure  
 med gr. black white brown  
 Loamy SAND  
 4-5' Loam transition layer highly packed  
 13'

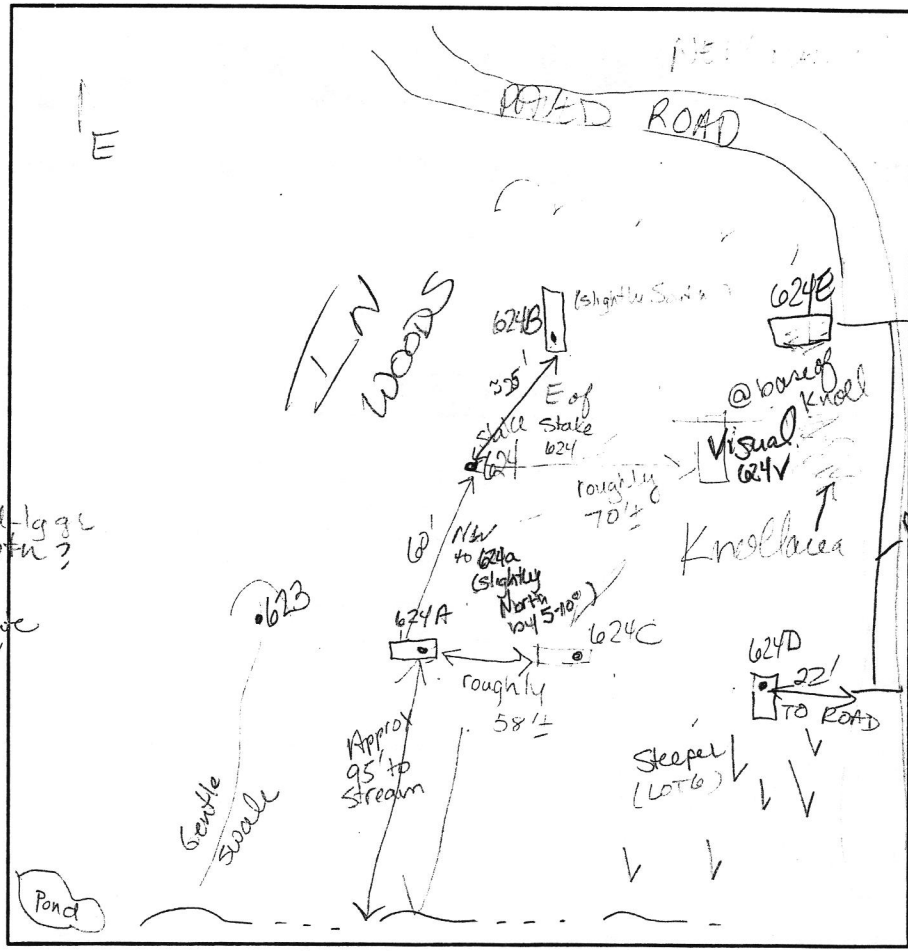

DATE	TEST #	DEPTH	START	BREAK 1" DROP	STOP 2" DROP	TIME OF 2ND INCH	P/F/H
4-30-01	624B	7'	10:17	10:22	10:27	5	P
	624C	5 1/2'	10:23	10:27	10:33	6	P
	624D	5'	10:41	10:53	11:13	19	P
	624E	Visual	OK	SEE 624C			P
	624V	Visual	OK	SOIL DESCRIPT.			
PROPOSED SDA IS UNDER DRIVEWAY TO STAY - ADJUST SDA HOLES DUG ON N SIDE OF DRIVE							

REMARKS Measurements of ADT holes taken from surveyed stake #624  
 SANITARIAN Race BACKHOE Ketlerman OTHERS Mr. Brown #  
 TEST HOLES USED IN SDA \_\_\_\_\_ AVG. PERC TIME \_\_\_\_\_ SQ. FT/BR \_\_\_\_\_  
 TRENCH WIDTH 3 INLET DEPTH 3 MAX. BOT DEPTH 1 EFFECTIVE SW \_\_\_\_\_

PESP Lot 5

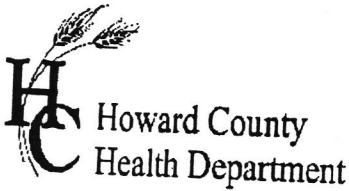

# APPLICATION

## FOR PERCOLATION TESTING AND SITE EVALUATION

TEST DATE(S) \_\_\_\_\_ TEST TIME \_\_\_\_\_

APR 5 2013-D

AGENCY REVIEW: \_\_\_\_\_

DATE 3/24/2004

DO NOT WRITE ABOVE THIS LINE

HEREBY APPLY FOR THE NECESSARY TESTING/EVALUATION PRIOR TO ISSUANCE OF SEWAGE DISPOSAL SYSTEM PERMIT(S) TO:

- CHECK AS NEEDED:
- CONSTRUCT NEW SEPTIC SYSTEM(S)
  - REPAIR/ADD TO AN EXISTING SEPTIC SYSTEM
  - REPLACE AN EXISTING SEPTIC SYSTEM

- CHECK AS NEEDED:
- NEW STRUCTURE(S)
  - ADDITION TO AN EXISTING STRUCTURE
  - REPLACE AN EXISTING STRUCTURE

- CHECK ONE:
- CREATE NEW LOT(S)
  - BUILD ON AN EXISTING LOT IN A SUBDIVISION
  - BUILD ON AN EXISTING PARCEL OF RECORD

- IS THE PROPERTY WITHIN 2500' OF ANY RESERVOIR?
- YES
  - NO

THE TYPE OF STRUCTURE IS:

- RESIDENTIAL WITH UNKNOWN PROPOSED BEDROOMS IN THE COMPLETED STRUCTURE (NOTE UNKNOWN IF APPROPRIATE)
- COMMERCIAL (PROVIDE DETAIL OF NUMBERS AND TYPES OF EMPLOYEES/ CUSTOMERS ON ACCOMPANYING PLAN)
- INSTITUTIONAL/GOVERNMENT (PROVIDE DETAIL OF NUMBERS AND TYPES OF EMPLOYEES/USERS ON ACCOMPANYING PLAN)

PROPERTY OWNER(S) BERTRAM BROWN & NANCY BROWN

DAYTIME PHONE (301) 596-9882 CELL \_\_\_\_\_ FAX \_\_\_\_\_

MAILING ADDRESS 13100 clarksville pike Highland MD 20777  
STREET CITY/TOWN STATE ZIP

APPLICANT FSH ASSOCIATES c/o ZACHARIA Y. FISCH P.E.

DAYTIME PHONE (410) 750-2251 CELL \_\_\_\_\_ FAX (410) 750-7350

MAILING ADDRESS 8318 FORREST ST. ELLCOTT CITY MD. 21043  
STREET CITY/TOWN STATE ZIP

APPLICANT'S ROLE: DEVELOPER BUILDER BUYER RELATIVE/FRIEND REALTOR CONSULTANT

PROPERTY LOCATION  
SUBDIVISION/PROPERTY NAME BROWN PROPERTY LOT NO. 5

PROPERTY ADDRESS 13100 clarksville pike HIGHLAND  
STREET TOWN/POST OFFICE

TAX MAP PAGE(S) 34 GRID 23 PARCEL(S) 301 PROPOSED LOT SIZE 1 AC. ±

AS APPLICANT, I UNDERSTAND THE FOLLOWING: THE SYSTEM INSTALLED SUBSEQUENT TO THIS APPLICATION IS ACCEPTABLE ONLY UNTIL PUBLIC SEWERAGE IS AVAILABLE. THIS APPLICATION IS COMPLETE WHEN ALL APPLICABLE FEES AND A SUITABLE SITE PLAN HAVE BEEN RECEIVED. I ACCEPT THE RESPONSIBILITY FOR COMPLIANCE WITH ALL M.O.S.H.A. AND "MISS UTILITY" REQUIREMENTS. APPROVAL IS BASED UPON SATISFACTORY REVIEW OF A PERC CERTIFICATION PLAN. TEST RESULTS WILL BE MAILED TO APPLICANT.

Zacharia Y. Fisch  
SIGNATURE OF APPLICANT

HOWARD COUNTY HEALTH DEPARTMENT, BUREAU OF ENVIRONMENTAL HEALTH, WELL AND SEPTIC PROGRAM  
3525-H ELLICOTT MILLS DRIVE, ELLICOTT CITY, MARYLAND 21043-4544 (410) 313-1771 FAX (410) 313-2648  
TDD (410) 313-2323 TOLL FREE 1-877-4MD-DHMH

AP 520113-D

LOT 53, 621 NOT DUG; USED AS REF. PT.

**620A**  
Dense to CL Loam Ribbons 2 1/2'  
5 1/2'  
NOT MUCH Rx ~ 10% or less med fine grained sand tan ybrn brn Single gr. texture tightly packed  
H. Bottom 11 1/2'  
10'  
11 1/2'  
10'

**621a**  
Str rd brn Dense CLL  
3'  
tightly compacted micac Strong brn black micac white micac med gr Sand - LSand  
5'  
Bottom 14'

**619**  
Strong brn white rd brn black fine-med gr. sand  
Bottom 12'



**621B**  
Deep dense clay  
6'  
1 1/2 br, 4 brn v. wk sap. pebbles 15-20%  
Appears as v. wk Flaty structure Old sap Now micac layered Med gr Sand 13 1/2'

**622A**  
Strong Ribbon SOCL  
2-3' SILL v. micac  
4' SIL  
5'+  
fine S.L.M  
H brn v. micac NOT as compacted as other surrounding holes  
H. Bottom 11'

**624a**  
Dense wk rd micac SOCL  
3'  
TRANS LAYER 5'  
brn ybrn fine S.L.M v. micac v. wk holds ball shape pebbles of appropriate size ~ 10-15%  
H. Bottom 11 1/2-12'

DATE	TEST #	DEPTH	START	BREAK 1' DROP	STOP 2' DROP	TIME OF 2ND INCH	PIF/H
4-30-04	620	5 1/2'	8:53	8:00 min -	Not to	Second peg re	
	619	2' 10"	8:47	8:49	8:53	4'	P
	620	@ 7'S	9:27	9:34	9:47	13'	P
			Poured 2 1/2 gal lons @ 11 1/2'			9:28-9:36 2/5 grs OK	
	621A	6'S	9:32	9:38	9:43	5 min	P
	621B	Visual	SEE	SOIL	Profile		
LOT 6	622A	7'S	9:54	9:55	9:57	2 min	P
	624a	5 1/2'	10:03	10:05	10:10	5'	P

REMARKS Holes dug off stake & re-named States done by surveyor - staked correctly.

SANITARIAN \_\_\_\_\_ BACKHOE Kettner OTHERS PH. RANKIN

TEST HOLES USED IN SDA \_\_\_\_\_ AVG. PERC TIME \_\_\_\_\_ SQ. FT/BR \_\_\_\_\_

TRENCH WIDTH \_\_\_\_\_ INLET DEPTH \_\_\_\_\_ MAX. BOT DEPTH \_\_\_\_\_ EFFECTIVE S/W \_\_\_\_\_

DUG HOLES: ADJ. OFF Field-located stakes

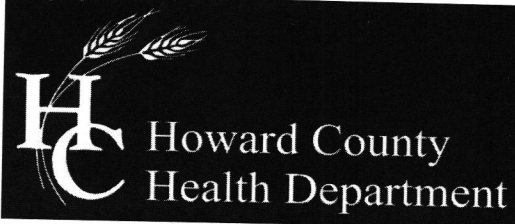

## Bureau of Environmental Health

8930 Stanford Boulevard, Columbia, MD 21045

Main: 410-313-2640 | Fax: 410-313-2648

TDD 410-313-2323 | Toll Free 1-866-313-6300

[www.hchealth.org](http://www.hchealth.org)

Facebook: [www.facebook.com/hocohealth](https://www.facebook.com/hocohealth)

Twitter: HowardCoHealthDep

Maura J. Rossman, M.D., Health Officer

---

### MEMORANDUM

TO: Benchmark Engineering, Inc.  
8480 Baltimore National Pike  
Ellicott City, Maryland 21043

FROM: Robert Freemon *RF*  
Well & Septic Program

RE: Clarksville Crossing, Phase 2, Area 2, Lot 11  
6500 Old Hilltop Ct.  
Highland, MD 20777

*"Perc Cert Comments"*

DATE: 4/7/2025

---

I have reviewed the Percolation Certification Plan and here are my comments.

1. Show the property boundary in bold for only lot 11. It is confusing to have two lots with bold boundaries when we are only referring to Lot 11 for this PC. Be sure to fix the vicinity map as well.
2. Remove all the notes that do not apply to this specific lot.
3. Label the SWM/MBR up near the street next to the proposed well sites.
4. Be sure to sign & stamp the plan.
5. Show the elevations next to the perc holes.
6. Show existing well and OSDS (general area) for 13150 Clarksville Pike.
7. The floor plans show 4 bedrooms, the OSDS plan shows 5 bedrooms. Is the guest suite option in the house going to push the total number of bedrooms to 6? If so the OSDS plan would need to be revised.