

Record Detail \* (This section is required.)

Permit Type Building/Residential/Misc/Tanks	Permit Number B26001340	Opened Date 04/28/2026
Description of Work SFD// INSTALL (1) 500GAL UNDERGROUND PROPANE TANK		

[check spelling](#)

Address \* (This section is required.)

Search Reset Clear Get Parcel & Owner

Street # 15534	Street Name FOXPAW	Street Type TRL
Unit Type -Select-	Unit #	Y Coordinate 39.31735
	X Coordinate -77.04807	
City WOODBINE	State MD	Zip Code 21797
		Primary Yes

Approved 4/30/26  

Parcel \* (This section is required.)

Search Reset Clear Get Address & Owner

GIS ID *	Parcel	Parcel Area	Land Value	Improved Value	Exemption Value	Plan Area
909923	233	3.11	317000	1149200	832200	RURAL
Legal Description IMPSLOT 14 3.1112 A[ ]15534 FOXPAW TRL[ ]FOXPORT PLANT RSB LOT 1						

[check spelling](#)

Block	Lot 14	Census Tract 605601	Council Dist 5	Inspection Dist	Supervisor Dist	Map #	DAP Zone
Plan Area	State Tax Id 1404348621	Subdivision Name FOXPORT PLANTATION					
Section	Area	Tax Map 8					
Grid	Zoning District RC-DEO	ADC Map 4692-C10					
SDP No.	Final Plan No.	WP File No.					
Record Plat No. 8430	WS Contract No.	FDP No.	Primary Yes				
Owner Occupied <input type="radio"/> Yes <input type="radio"/> No	Year Built 1990	Historic District <input type="radio"/> Yes <input checked="" type="radio"/> No					
Historic District Registry No.	Stat Area 4-06	Flood Plain <input type="radio"/> Yes <input checked="" type="radio"/> No					
Building No							

Owner \* (This section is required.)

Search Reset Clear

Name \*  
ARAUJ

Address Line 1  
15534 FOXPAW TRL

Address Line 2

Address Line 3

Mail City  
WOODBINE

Mail State  
MD

Mail Zip Code  
21797

Phone  
301-275-3232

Primary  
Yes

E-mail

Cell Number Fax Number

Professionals (This section is not required.)

**License # \***  
 68408  
**License Type \***  
 Propane Gs  
**Primary**  
 No  
**Business Name**  
 HJ POIST  
**First Name** Middle Name Last Name  
 JEFF  
**Address Line 1**  
 360 MAIN ST  
**Address Line 2**  
  
**City** State ZIP Code  
 LAUREN MD 20707  
**Phone 1** Phone 2 Fax  
 3017253232  
**E-mail**  
 JEFF@HJPOIST.COM

Applicant (This section is not required.)

Search As Owner As Lic. Prof As Contact

**Type \***  
 Applicant  
**Relationship**  
 Applicant  
**Primary**  
 Yes  
**First Name** MI Last Name  
 MICHELLE CLANCY  
**Full Name**  
 MICHELLE CLANCY  
**Organization Name**  
 APPLIED & APPROVED PERMITS LLC  
**Street Address**  
 P.O. BOX 310  
**Address Line 2**  
  
**City** State Zip Code  
 PERRY HALL MD 21128  
**Phone** Cell Fax  
 443-340-1229  
**E-mail \***  
 MICHELLE@APPLIEDANDAPPROVED.COM

Addtl Info

**Est Construction Cost \*** Housing Units \* Number of Buildings \* Public Owned  
 750 0 0 No  
**Construction Type**  
 --Select--

TANK INFORMATION

RESIDENTIAL TANK INFORMATION

**Capital Project-No Fee \*** Capital Project Number Fee Exempt \* Roadside Tree Project Permit \* Roadside Tree Permit #  
 Yes  No (Text)  Yes  No  Yes  No [Text Box] (Text)  
**Existing Use \*** Number of Tanks Installed \* Number of Tanks Removed \*  
 SFD 1 (Number) 0 (Number)  
**Water Supply** Sewage Disposal Expiration Date Relocate Existing Tank \*  
 Private Private 10/25/2026 0 (Number)

Related Records

Showing 1-2 of 2

Permit Number	Record Type Alias	Status	Number	Street Name	Opened Date	Description
B26001340	Residential Tank Permit	Review In Process	15534	FOXPAW	04/28/2026	SFD// INSTALL (1) 500GAL UNDERGROUND PRO
P26001631	Residential Plumbing Addition Alteration Permit	Incomplete	15534	FOXPAW	04/28/2026	SFD// RUN LINE FROM TANK TO GENERATOR &

Submit Cancel

THIS DOCUMENT IS CERTIFIED TO:

**J.R. Trawick**  
Company, Inc.



**J.R. Trawick**  
Company, Inc.

CASE #: \*\*\*\*

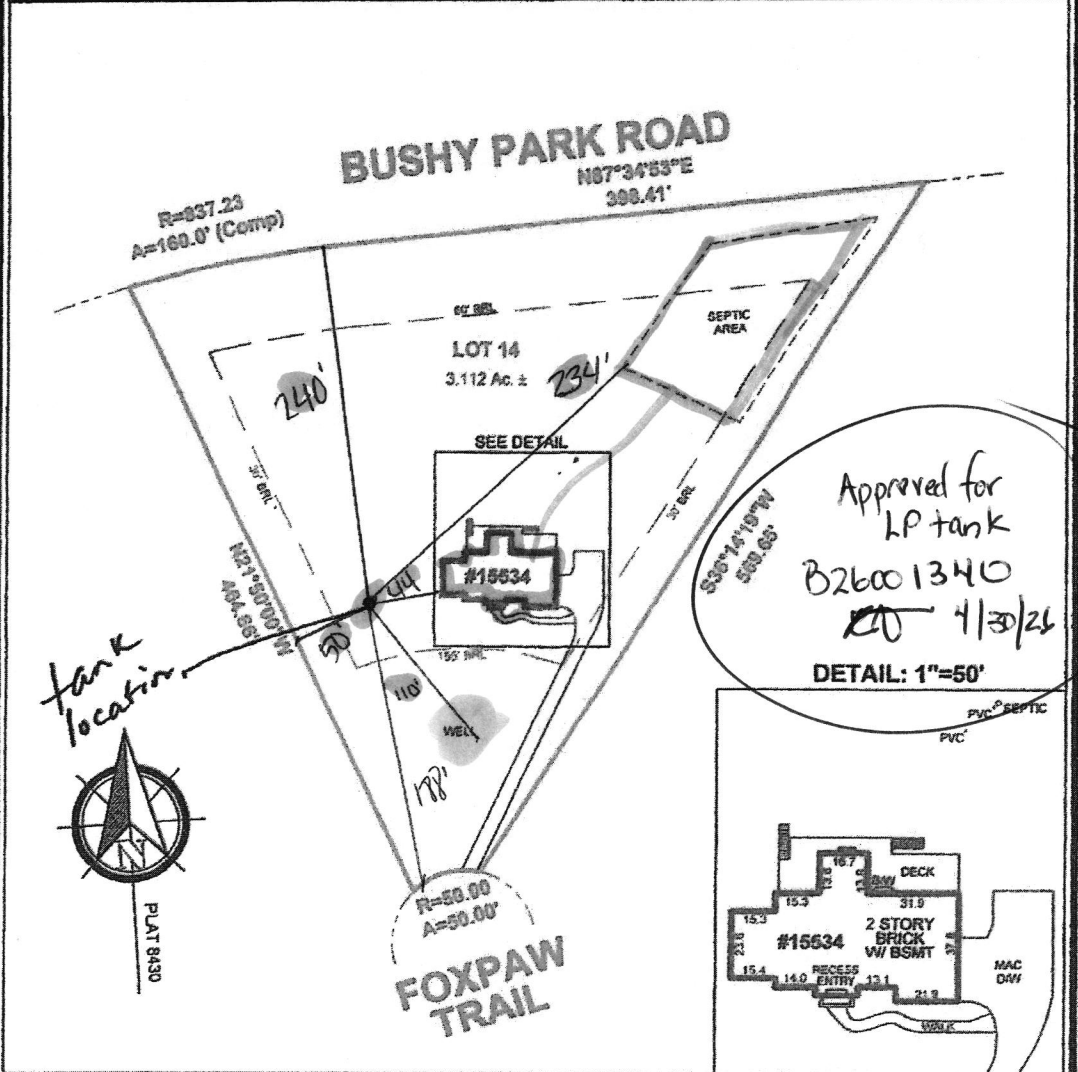

Approved for  
LP tank  
B2600 1340  
4/30/26  
DETAIL: 1"=50'

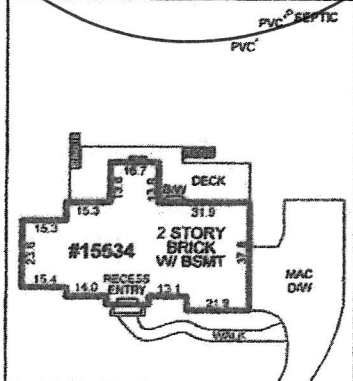

LOCATION DRAWING OF:  
**#15534 FOXPAW TRAIL**  
LOT 14  
4th ELECTION DISTRICT  
**FOXPORT PLANTATION**  
PLAT No. 8430  
HOWARD COUNTY, MARYLAND  
SCALE: 1"=100' DATE: 09-18-2020  
DRAWN BY: AP FILE #: 209212-200

- LEGEND:**
- F- FENCE
  - BE BAGMENT ENTRANCE
  - BAW BAY WINDOW
  - BR BRICK
  - DL RESTRICTION LINE
  - BSMT BASEMENT
  - C/S CONCRETE STOOP
  - CONC CONCRETE
  - DW DRIVEWAY
  - EA EAVING
  - FR FRAME
  - MAC MACADAM
  - CH CHUTE
  - OH OVERHEAD
  - PUE PUBLIC UTILITY EMIT.
  - PIE PUBLIC IMPROVEMENT EMIT.
- COLOR KEY:**
- RED RECORD INFORMATION
  - ORANGE IMPROVEMENTS
  - GREEN EASEMENTS & RESTRICTION LINES

A Land Surveying Company  
**DULEY**  
and  
Associates, Inc.  
Serving D.C. and MD.  
14604 Elm Street, Upper Marlboro, MD 20772  
Phone: 301-888-1111 Fax: 301-888-1114  
Email: orders@duley.biz On the web: www.duley.biz



**SURVEYOR'S CERTIFICATE**

I HEREBY STATE THAT I WAS IN RESPONSIBLE CHARGE OVER THE PREPARATION OF THIS DRAWING AND THE SURVEY WORK REFLECTED HEREIN AND IT IS IN COMPLIANCE WITH THE REQUIREMENTS SET FORTH IN REGULATION 12 CHAPTER 02.13 OF THE CODE OF MARYLAND ANNOTATED REGULATIONS. THIS SURVEY IS NOT TO BE USED OR RELIED UPON FOR THE ESTABLISHMENT OF FENCES, BUILDING, OR OTHER IMPROVEMENTS. THIS PLAT DOES NOT PROVIDE FOR THE ACCURATE IDENTIFICATION OF PROPERTY BOUNDARY LINES, BUT SUCH IDENTIFICATION MAY NOT BE REQUIRED FOR THE TRANSFER OF TITLE OR SECURING FINANCING OR REFUNDING. THIS PLAT IS OF BENEFIT TO A CONSUMER ONLY INsofar AS IT IS REQUIRED BY A LENDER OR A TITLE INSURANCE COMPANY OR ITS AGENTS IN CONNECTION WITH THE CONTEMPLATED TRANSFER, FINANCING OR REFUNDING. THE LEVEL OF ACCURACY FOR THIS DRAWING IS 1". NO TITLE REPORT WAS FURNISHED TO NOR DONE BY THIS COMPANY. SHD PROPERTY SUBJECT TO ALL NOTES, RESTRICTIONS AND EASEMENTS OF RECORD. BUILDING RESTRICTION LINES AND EASEMENTS MAY NOT BE SHOWN ON THIS SURVEY. IMPROVEMENTS WHICH IN THE SURVEYOR'S OPINION APPEAR TO BE IN A STATE OF DISREPAIR OR MAY BE CONSIDERED "TEMPORARY" MAY NOT BE SHOWN. IF IT APPEARS ENCROACHMENTS MAY EXIST, A BOUNDARY SURVEY IS RECOMMENDED.

**DULEY & ASSOC.**  
WILL GIVE YOU A 100%  
FULL CREDIT TOWARDS  
UPGRADING THIS  
SURVEY TO A  
"BOUNDARY/STAKE"  
SURVEY FOR ONE  
YEAR FROM THE DATE  
OF THIS SURVEY.  
(EXCLUDING D.C. & BALT. CITY)



## ABOVEGROUND/UNDERGROUND PROPANE STORAGE TANKS 120 - 1000 Gallons

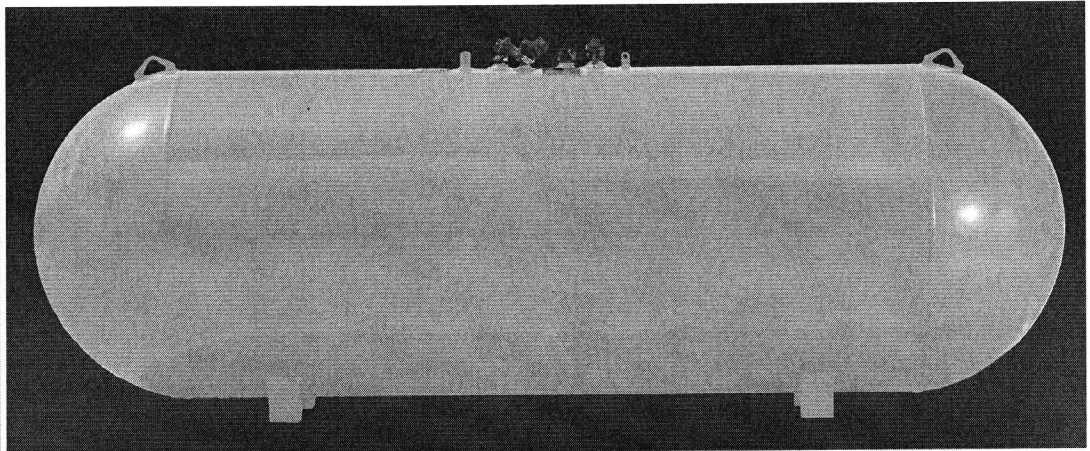
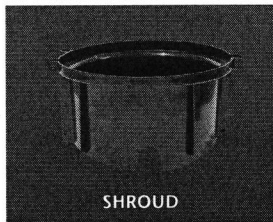
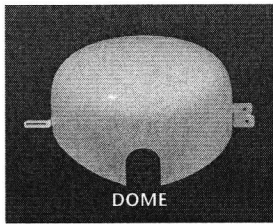

### PRESSURE VESSEL CODES & REGISTRATION

- Designed and constructed in accordance with the ASME Section VIII, Division 1 Code
- Registered with the National Board of Boiler & Pressure Vessels Inspectors
- Complies with NFPA 58
- Conforms to specifications set forth by the Railroad Commission of Texas

### VESSEL FEATURES

- Tanks fully fitted with RegO valves and Rochester liquid level gauges
- Dual service options for aboveground or underground applications
- Product supplied with steel dome (custom colors available upon request) or plastic AG/UG shroud, specify at time of order
- Container pressure rated at 250 PSI @ 400°F
- Vacuum purged
- Stainless steel data plate
- Anode bolt connection located under the dome
- #54 liquid level outage valve orifice

### PROCESS CONTROL

All welded products are x-rayed and pressure tested @ 325 PSI per ASME Sec VIII, Div I requirements, followed by rigorous leak test inspections, both pre and post valving

### STORAGE & DISTRIBUTION

Contact Propane Education & Research Council for additional resources and information at [propane.com](http://propane.com)

### PAINT SPECIFICATIONS

At the time of order, customer must specify intended application thus determining paint applied at the time of manufacturing

#### Aboveground tank applications:

- Painted Sky White with super durable TGIC polyester powder paint for maximum rust protection
- Custom colors available upon request
- If an aboveground painted tank is intended for underground use, tank must be field painted for such application

#### Underground tank applications:

- Painted gray with a "ready to bury", durable epoxy powder paint for underground applications
- Product used underground may require additional protective coating and cathodic protections, contact your federal, state or local authorities for specifications

Made With Pride



Made In the U.S.A.



**ABOVEGROUND/UNDERGROUND  
PROPANE STORAGE TANKS  
120 - 1000 Gallons**

**ABOVEGROUND/UNDERGROUND VESSEL DIMENSIONS & SPECIFICATIONS**  
(All Vessel Dimensions are Approximate)

Part Number	Description	Water Capacity Gal/l	Outside Diameter In/mm	Head Type	Overall Length In/mm	Overall Height In/mm	Leg Width In/mm	Leg Spacing In/mm	Weight Lbs/kg	Quantity	
										Full Load	Per Stack
68280.6	120 Gallon AG/UG Storage Tank, Gray	120 454.2	24" 609.6	Ellip	5' 8" 1727.2	3' 1 3/16" 944.5	10 1/8" 257.2	3' 0" 914.4	312 141.5	96	12
68281.6	250 Gallon AG/UG Storage Tank, Gray	250 946.3	30" 762	Hemi	7' 10" 2387.6	3' 6 15/16" 1090.6	12 3/4" 323.9	3' 6" 1066.8	462 209.5	54	9
68282.6	320 Gallon AG/UG Storage Tank, Gray	320 1211.3	30" 762	Hemi	9' 7" 2921	3' 6 15/16" 1090.6	12 3/4" 323.9	4' 0 1/4" 1225.6	567 257.2	45	9
68283.26**	500 Gallon AG/UG Storage Tank, Gray	500 1892.7	41" 1041.4	Hemi	8' 8 1/2" 2654.3	4' 4" 1320.8	16 1/4" 412.8	3' 6" 1066.8	987 447.7	30	5
68284.26**	1000 Gallon AG/UG Storage Tank, Gray	1000 3785.4	41" 1041.4	Hemi	15' 11" 4851.4	4' 5 3/4" 1365.3	16 1/4" 412.8	9' 0" 2743.2	1739 788.8	15	5

† Federal, state or local regulations may contain specific applicable requirements for protective coatings and cathodic protection. The purchaser and installer are responsible for compliance with such federal, state, local and NFPA industry regulations, including, but not limited to, proper purging prior to putting into service. Cathodic protection is required. Coating (s) must be continuous, uninterrupted and must comply with local, state or national codes or regulations.

\* Drain \*\*No Drain

