

Bureau of Environmental Health
 8930 Stanford Boulevard, Columbia, MD 21045
 Main: 410-313-2640 | Fax: 410-313-2648
 TDD 410-313-2323 | Toll Free 1-866-313-6300
www.hchealth.org
 Facebook: www.facebook.com/hocohealth

Maura J. Rossman, M.D., Health Officer

RECEIPT DATE: 10-7-25 **ONSITE SEWAGE DISPOSAL SYSTEM** P 590230

APPROVAL DATE: 5/21/26 **PERMIT:** Tank Replacement ^{Upgrade (RAW)} A _____

PROPERTY ADDRESS: 1200 Sugar Maple Drive

SUBDIVISION: _____ LOT: _____ TAX ID: _____

CONTRACTOR: Freedom Septic EMAIL: christy@freedomseptic.com

CONTRACTOR ADDRESS: 2809 Liberty Road, Sykesville, MD 21784 PHONE: 410-795-2947

PROPERTY OWNER: Singh Sugar Maple Farm LLC EMAIL: _____

OWNER ADDRESS: 1200 Sugar Maple Drive, Marriottsville, MD 21104 PHONE: _____

SEPTIC TANK SIZE (GALLONS): 2000 gal TANK MANUFACTURER: Babylon

PUMP MODEL: N/A PUMP SIZE: N/A PUMP TANK CAPACITY: N/A

DISTRIBUTION SYSTEM: GRAVITY PRESSURE DOSED BEDROOMS: 6 APPLICATION RATE: _____

TRENCHES:	LINEAR FEET REQUIRED: _____	INLET DEPTH: _____
	TRENCH WIDTH: _____	MAXIMUM BOTTOM DEPTH: _____
	MINIMUM SPACE BETWEEN TRENCHES: _____	EFFECTIVE AREA BEGINNING DEPTH: _____
LOCATION:	<u>New tank location per approved site plan.</u>	
NOTES:	<u>- Abandon Ex. 1500gal ST</u> <u>- Install 2000gal ST (2 compartment)</u>	

ISSUED BY: Spencer Freeman ISSUE DATE: 10-7-25 EXPIRATION DATE: 10-7-26

- NOTE: CONTRACTOR MUST SCHEDULE A PRE-CONSTRUCTION INSPECTION PRIOR TO BEGINNING ANY INSTALLATION
- NOTE: CONTRACTOR REGISTERED WITH THE STATE OF MD ON-SITE WASTEWATER PROFESSIONALS BOARD: CONFIRMED
- NOTE: CONTRACTOR MUST SCHEDULE AN INSPECTION AND GAIN APPROVAL OF ALL COMPONENTS PRIOR TO COVERING
- NOTE: STONE MUST BE APPROVED BY HEALTH DEPARTMENT AND GRAVEL TICKET MUST BE AVAILABLE FOR REVIEW.
- NOTE: WATERTIGHT TANKS REQUIRED
- NOTE: ALL PARTS OF SEPTIC SYSTEM SHALL BE AT LEAST 100 FEET DOWNGRADIENT FROM ANY WATER WELL
- NOTE: MANHOLE RISERS REQUIRED ON ALL SEPTIC TANKS AND PUMP CHAMBERS
- NOTE: AN ELECTRICAL PERMIT IS REQUIRED FOR INSTALLATION OF ANY ELECTRICAL COMPONENTS OF THE SYSTEM
 ELECTRICAL PERMIT ISSUED E N/A
- NOTE: MDE RECOMMENDS SEPTIC TANKS, BAT, AND OTHER PRETREATMENT UNITS BE PUMPED AT A FREQUENCY ADEQUATE TO ENSURE THAT SOLIDS ARE NOT DISCHARGED TO THE DISPOSAL AREA

**NEITHER THE HOWARD COUNTY COUNCIL NOR THE HEALTH DEPARTMENT IS RESPONSIBLE FOR THE SUCCESSFUL OPERATION OF ANY SYSTEM.
 PERMITTEE RESPONSIBLE FOR OBTAINING FINAL APPROVAL ON THIS PERMIT.
 CALL 410-313-1771 TO SCHEDULE INSPECTIONS.**

NOT TO SCALE

TRENCH/DRAINFIELD DATA

WIDTH	INLET	BOTTOM
<u>Existing</u>	<u>Existing</u>	<u>Existing</u>
NUMBER OF TRENCHES	_____	
TOTAL LENGTH	_____	
ABSORPTION AREA	_____	
DISTRIBUTION BOX LEVEL	_____	
DISTRIBUTION BOX BAFFLE	_____	
DISTRIBUTION BOX PORT	_____	

SEPTIC TANK DATA

SEPTIC TANK I LEVEL Yes

MANUFACTURER Babylon

CAPACITY 2000 GAL

SEAM LOC Top

TANK LID DEPTH 2 1/2'

BAFFLES 6" Front / 4" Back

BAFFLE FILTER _____

MANHOLE LOC Front/Back

6" PORT LOC _____

WATERTIGHT TEST —

SLOTTED Yes

DATE ON LID 4-1-2021

PUMP/SEPTIC TANK LEVEL N/A

MANUFACTURER _____

CAPACITY _____ GAL

SEAM LOC _____

TANK LID DEPTH _____

BAFFLES _____

BAFFLE FILTER _____

MANHOLE LOC _____

6" PORT LOC _____

WATERTIGHT TEST _____

SLOTTED _____

DATE ON LID _____

See Attached As-Built

ROAD NAME

SEPTIC CONTRACTOR ONSITE INSTALLING SYTEM: Dan Farrow
SEPTIC CONTRACTOR ONSITE LICENSED WITH THE STATE OF MD: YES/NO

PRE-CONSTRUCTION NOTES:

CONTROL PANEL DATA

CONTROL PANEL HEIGHT N/A
(MIN 30")

INSPECTION DATE N/A

INSPECTION: PASS/FAIL (CIRCLE ONE)

INSTALLATION NOTES:

5/18/26 Contractor pumped, crushed and abandoned old septic tank. Installed new tank 18' away from basement foundation. Installed 15HC and cleanout with elbow of fill to the tank. Contractor added 8' of pipe from tank to existing block line to dbox for about 20' (M)

5/21/26 JW approved 18' Setback Variance for septic tank to house basement (M)

FINAL INSPECTOR M. Burns

DATE OF APPROVAL 5/21/26

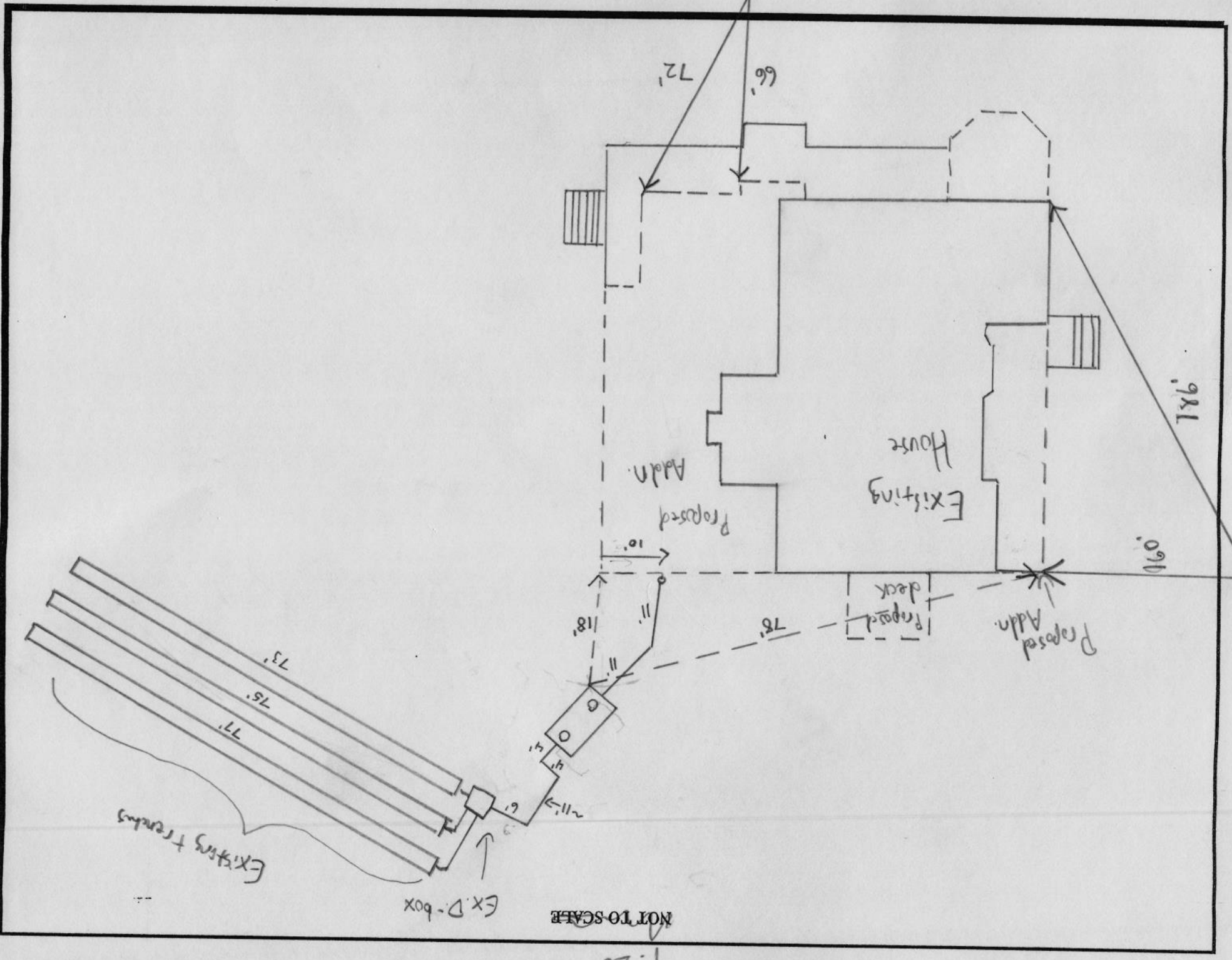

NOT TO SCALE

1:20

Existing trenches

EX. D.-box

Existing House

Proposed Addn.

Proposed deck

Proposed Addn.

981'

160'

72'

66'

73'

75'

77'

4'

4'

4'

11'

18'

10'

78'

11'

11'

11'

11'

11'

11'

11'

11'

11'

11'

11'

11'

11'

11'

11'

11'

11'

11'

11'

11'

11'

11'

11'

11'

11'

11'

11'

11'

11'

11'

11'

11'

11'

11'

11'

11'

11'

11'

11'

11'

11'

11'

11'

11'

11'

11'

11'

11'

11'

11'

11'

HO-20-0218

HO-88-1679

NOT TO SCALE

Owner Harsimran Singh
Singh Sugar Maple Farm, LLC
1200 Sugar Maple Drive
Marriottsville, MD, 21104

Architect Ronald Johnston
Ronald Johnston & Associates, Architects
11407 Barley Field Way
Marriottsville, MD, 21104

Septic Contractor Freedom Septic
2809 Liberty Road
Sykesville, MD, 21784

Total # of Bedrooms: 5

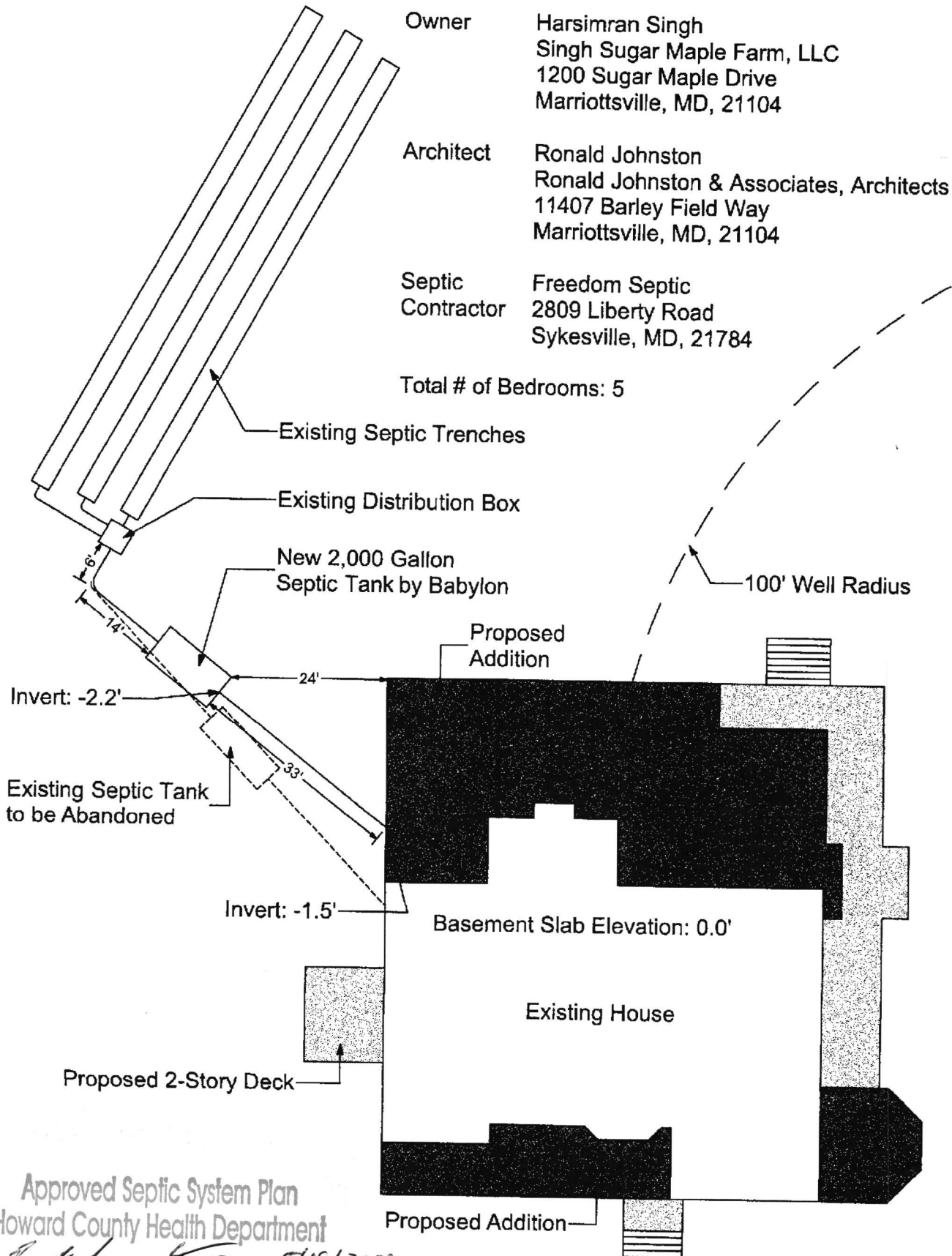

Approved Septic System Plan
Howard County Health Department

[Signature]
Signature

5/18/2020
Date
1200 Sugar Maple Drive Septic Plan

Scale: 1" = 20'

[Signature]

1210 Sugar Maple Drive - Septic tank replacement install



Maura J. Rossman, M.D., Health Officer

APPLICATION FOR WAIVER

To Howard Co Code Subtitle 8: Onsite Sewage Disposal Systems and Subtitle 9: Individual Potable Water Supply Systems

Date Submitted: 9/17/2025

Property Address: 1200 Sugar Maple Marriottsville, MD 21104

Andrew Property	N/A	0010	0004	0010	1403284514
Subdivision	Lot	Tax Map	Grid	Parcel	Tax Account #

Provide a brief site history including previously submitted and active plans with the Health Department or the County (subdivision plans, perc test applications, Building Permit applications):

B25003271: Proposing rebuild for house with fire damage. Building permit does propose increase in living space and total number of bedrooms from previous existing structure.

In the area below, list the specific section of the Howard Co Code to which a waiver is being requested and provide a brief summary of the regulation and an explanation of why the waiver is being requested (Attach a separate sheet if necessary).

Regulation Section	Summary and Explanation
1. <u>Sec. 3.805</u>	<u>Property must have Percolation Certificaton Plan designating sewage disposal area.</u>
2. _____	_____
_____	_____
_____	_____
_____	_____

Maura J. Rossman
Property Owner's Signature

Health Department Use Only

Reviewed by *[Signature]* *5/20/26*
HCHD Staff Date

Comments/Conditions: *approved - existing record shows passing perc for repair area in 1991 - plan showing area, but not signed perc cert. Also approved for new septic tank 18' from house with 3' basement.*

Approved by: *[Signature]* *5/20/26*
BEH Deputy Director Date

Freemon, Robert

From: Freemon, Robert
Sent: Thursday, September 18, 2025 11:15 AM
To: 'Ronald Johnston'; Harsimran singh
Cc: Silvast, Zackary; Williams, Jeffrey; Wolf, Kevin; Burns, Matthew; Page, Shepsura
Subject: RE: 1200 Sugar Maple Dr.

Ron,

If the main septic line leaving the house is to remain unchanged, the following will be required prior to bp approval.

1. Approved PC Waiver Request
2. Tank Upgrade Planned & Installed w/ Health Approval

If the main septic line leaving the house is changing to come out an addition, the following will be required prior to building permit approval. Based on our records and the proposed additions it does appear this maybe the case. This would be the quickest option.

1. Approved PC Waiver Request
2. Tank Upgrade Plan Approved
 - a. Will need to show new proposed outlet from addition with elevations
3. Septic Contractor Pays For Tank Upgrade Permit
 - a. Conditional BP approval can be given
 - b. No final BP inspection until tank installed & approved

Anytime the Health Dept. receives plans we have ten business days to review it and give out a response. The waiver request should take less time to complete being that Jeff is already aware of the project. I will need to make a site visit to the property as part of the waiver request process. I may be able to do a site visit tomorrow, if not, Monday I can swing out there. The property owners are not required to be there for the site visit. Let me know once the site plan for the tank upgrade has been submitted so I can expedite its review. Hope this helps.



*8930 Stanford Blvd. Columbia, MD 21045
Bureau of Environmental Health
Well and Septic Program*

*Robert "Spencer" Freemon
PHONE: 410-313-6357*

EMAIL: rfreemon@howardcountymd.gov

GIS INTERACTIVE: <https://data.howardcountymd.gov/InteractiveMap.html>

WEBSITE: <https://www.howardcountymd.gov/Departments/Health/Environmental-Health/Well-and-Septic>

From: Ronald Johnston <ron@rjarchitect.com>
Sent: Wednesday, September 17, 2025 6:47 PM
To: Freemon, Robert <rfreemon@howardcountymd.gov>; Harsimran singh <harrysingh09@hotmail.com>

Freemon, Robert

From: Freemon, Robert
Sent: Thursday, September 4, 2025 2:44 PM
To: harrysingh09@hotmail.com
Cc: RON@RJARCHITECT.COM
Subject: 1200 Sugar Maple Dr.
Attachments: HCHD BP Process.pdf; 1200 Sugar Maple Dr. BP.pdf; ENGINEERS Surveyors REV 6-28-02.pdf; SEPTIC CONTRACTORS_updated 8-14-20.pdf

Hi,

Attached are my comments regarding building permit B25003271. Additional information can be found on our website (see signature below).

- The Percolation Certification Plan (PC) will need to show a 10,000sqft sewage disposal area for each structure served by a private septic system. Previous perc locations recorded will need to be shown on the plan in order to determine where additional test will need to occur.
- Based on the Health Department's bedroom definition and your proposed floor plans, you are proposing a 6 bedroom house with a full bath rough in in the unfinished basement. The sunroom/exercise room is considered a bedroom room (see HCHD BP Process). According to our records the existing septic system is sized for 4 bedrooms. The 1250gal septic tank can accommodate 4 bedrooms max. The trenches/drain field has a max capacity of 6 bedrooms based on perc data and design. If you wish to keep the current proposed floor plans the existing septic system will need to be upgraded. If you wish to not upgrade the existing septic system the proposed floor plans will need to be altered to reduce the number of bedrooms.

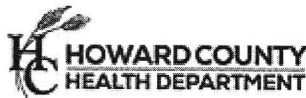

*8930 Stanford Blvd. Columbia, MD 21045
Bureau of Environmental Health
Well and Septic Program*

Robert "Spencer" Freemon

PHONE: 410-313-6357

EMAIL: rfreemon@howardcountymd.gov

GIS INTERACTIVE: <https://data.howardcountymd.gov/InteractiveMap.html>

WEBSITE: <https://www.howardcountymd.gov/Departments/Health/Environmental-Health/Well-and-Septic>

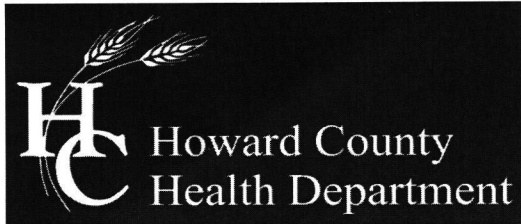

Bureau of Environmental Health

8930 Stanford Boulevard, Columbia, MD 21045

Main: 410-313-2640 | Fax: 410-313-2648

TDD 410-313-2323 | Toll Free 1-866-313-6300

www.hchealth.org

Facebook: www.facebook.com/hocohealth

Twitter: HowardCoHealthDep

Maura J. Rossman, M.D., Health Officer

MEMORANDUM

TO: SINGH SUGAR MAPLE FARM LLC
1200 Sugar Maple Dr.
Marriottsville, MD 21104

FROM: Robert Freemon *RIF*
Well & Septic Program

RE: **B25003271**
1200 Sugar Maple Dr.
Marriottsville, MD 21104

DATE: 9/4/2025

After reviewing building permit B25003271 here are my comments. Prior to building permit approval, the following is required.

1. **Percolation Certification Plan (PC)**
2. **On-Site Sewage Disposal System Evaluation (OSDS)**
 - a. On-Site Sewage Disposal System Upgrade
 - b. Abandonment of Existing Systems

Percolation Certification Plan: A percolation certification plan is a plan signed by the Health Dept. designating a sewage disposal area on the property. Before a perc cert can be created perc testing is required. Prior to testing the Health Dept. must receive a filled-out perc testing application, the perc permit fee of \$597 (payable to the Director of Finance) and a perc test plan. The fee for the perc permit covers the testing, plan review and certification. Homeowners will need to hire a septic contractor or a friend with a backhoe to dig holes 12-16ft deep. As for the test plan, homeowners will typically hire a civil/septic engineer who has worked with us before. Once the Health Dept. has received all three (application, fee, test plan) and we approve of the

test plan we will schedule a date for perc testing. Based on the test results the engineer will finalize the perc cert and submit it to the Health Dept. for review and signature.

On-Site Sewage Disposal System Evaluation (OSDS): During percolation testing portions of the existing septic system will be exposed for evaluation. If the existing system is determined to be inadequate by the Health Dept. the existing septic system will need to be properly abandoned and a new system installed.

On-site Sewage Disposal System (OSDS): An OSDS must be planned and installed with Health Dept. approval. Using the perc results and total number of bedrooms proposed the engineer will design a septic plan. Once the Health Dept. approves of the septic plan a septic contractor will need to pick up the septic permit and pay the fee of \$496 (payable to the Director of Finance) prior to installation. During installation inspections will be made and final approval may be given.

Abandonment of Existing System: The existing septic system must be properly abandoned. The existing septic system must be pumped out, crushed, and filled with clean dirt. Documentation of the septic abandonment must be submitted to the Health Dept.