

7/27/94  
Lester  
11:00

# PERMIT

03-315983

## SEWAGE DISPOSAL SYSTEM

### DEPARTMENT OF HEALTH AND MENTAL HYGIENE

P 57089C

A 41711

DISTRICT 3rd

DATE 6/14/94

DATE SYSTEM APPROVED 7/27/94

INSPECTOR DKS

HOWARD COUNTY HEALTH DEPARTMENT  
BUREAU OF ENVIRONMENTAL HEALTH  
~~461-9933~~ 313-2640

INDEXED

South Carroll Backhoe, Inc.

IS PERMITTED TO INSTALL  ALTER

ADDRESS 4410 Salem Bottom Road, Westminster, Maryland 21157 PHONE 875-4197

SUBDIVISION Spring Valley Chase LOT 15 ROAD 12169 Woodford Drive

PROPERTY OWNER Altierre Homes Roygyok

ADDRESS \_\_\_\_\_

SEPTIC TANK CAPACITY 1250 GALLONS

NUMBER OF BEDROOMS 4

180 SQUARE FEET PER BEDROOM

180  
4  
720  
180  
4  
720

LOG. PERMIT SIGNED

AND RETURNED 5-6-99

Serial # BM 117271  
Duck

LINEAR FEET OF TRENCH REQUIRED 180

TRENCHES - Trench to be 2 feet wide. Inlet 3 feet below original grade. Bottom maximum depth 7 feet below original grade. Effective area begins at 3 feet below original grade. 4 feet of stone below distribution pipe.

LOCATION - Place distribution box 95 feet down the left lot line and 90 feet off the same lot line when facing the lot from Woodford Drive. Run trenches along contour towards the left lot line.

NOTES - No trench to exceed 100 feet in length. Provide 6" - 8" diameter cleanout and cap to grade or above on septic tank. OK MR 5/6/94

PLANS APPROVED BY Donna Soe/Mark Rifkin

REVISED DATE 04/06/94

COVER NO WORK UNTIL INSPECTED AND APPROVED

NEITHER THE HOWARD COUNTY COUNCIL NOR THE HEALTH DEPARTMENT IS RESPONSIBLE FOR THE SUCCESSFUL OPERATION OF ANY SYSTEM

NOTE: CLEANOUT REQUIRED EVERY 70 FEET OF SEWER LINE AND/OR AT 90° SWEEPS IN LINES FROM HOUSE TO DRAIN FIELDS, 90° ELBOWS NOT ACCEPTABLE.

NOTE: ALL PARTS OF SEPTIC SYSTEMS (I.E. TANK, DISTRIBUTION BOX TRENCHES) TO BE 100 FEET FROM WELL (UNLESS OTHERWISE SPECIFICALLY AUTHORIZED)

NOTE: IF DEEP TRENCH(ES) ARE USED CALL FOR INSPECTION BEFORE AND AFTER PLACING GRAVEL IN TRENCH(ES)

NOTE: NO DRY WELL SHALL EXCEED 15 FOOT IN DIAMETER NO ABSORPTION TRENCH TO EXCEED 100 FEET IN LENGTH

NOTE: ALL PIPE FROM HOUSE TO SEPTIC TANK MUST BE CAST IRON OR SCHEDULE 35/40 PVC OR ABS

PERMIT VOID AFTER TWO YEARS

NOTE: INSTALL STAND PIPE ON SEPTIC TANK AND DRY WELL STAND PIPES MUST BE 6 INCHES IN DIAMETER CAST IRON. CONCRETE OR TERRA COTTA OR PVA OR ABS ACCEPTED. IF TOP OF SEPTIC TANK IS DEEPER THAN 3 FEET. MANHOLE TO GRADE REQUIRED.

NOTE: DISTRIBUTION BOXES MUST HAVE BAFFLES

**\*INSTALLER IS RESPONSIBLE FOR OBTAINING FINAL APPROVAL ON THIS PERMIT**

A 41711

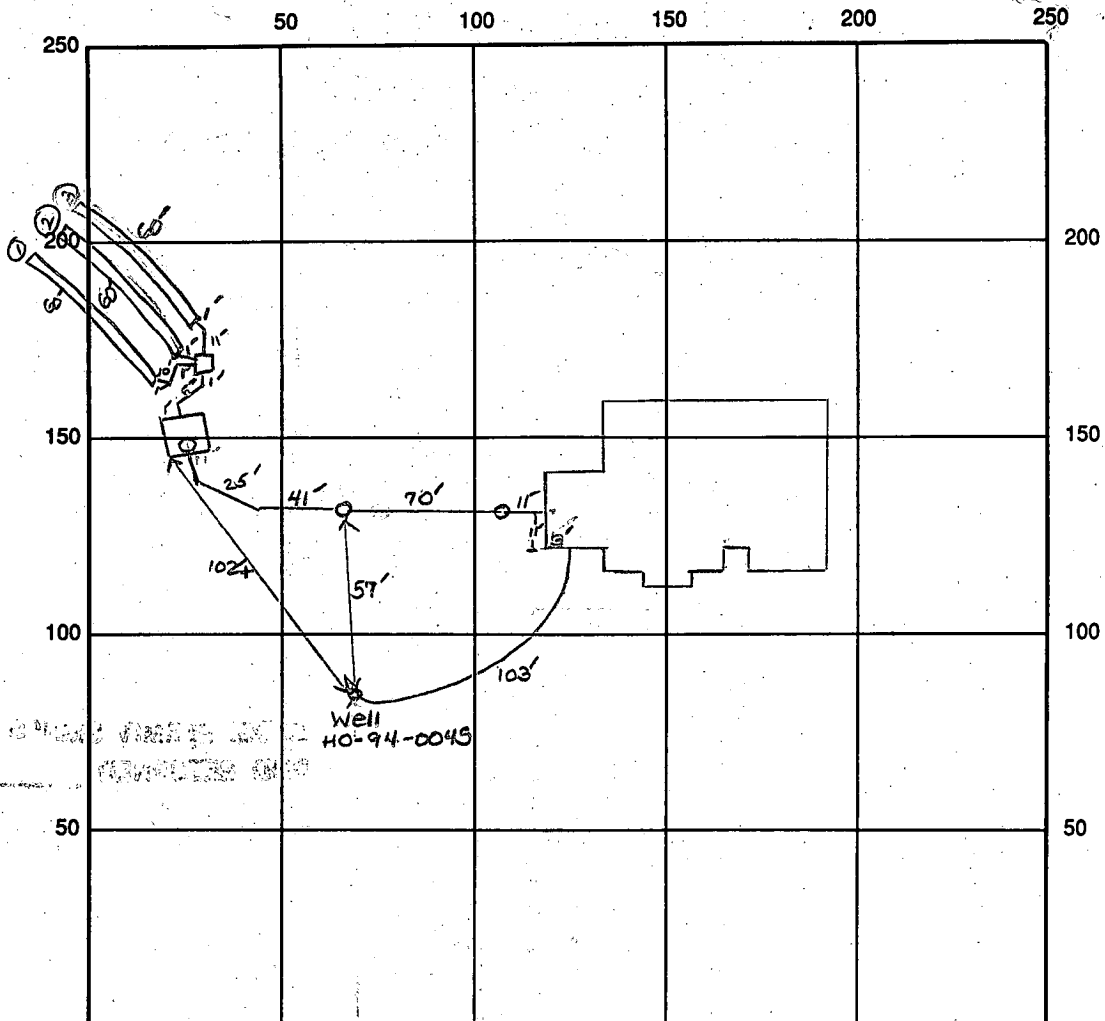

INDICATE NORTH - NAME ADJOINING ROADWAY AS BASE LINE

Woodford Drive

SEPTIC TANK LEVEL OK-1250 gal CLEANOUTS two in line, one on s.t.

DISTRIBUTION BOX LEVEL OK-baffle in

DRAIN FIELD/TITLE DEPTH 7 FT. TRENCH WIDTH 2 FT. INLET DEPTH 3 FT.

EFFECTIVE GRAVEL DEPTH 4 FT. TOTAL LENGTH ①60' ②60' FT. 180' total

NUMBER OF TRENCHES 3 ONE SIDEWALL/~~BOTTOM~~ AREA 720 SQ. FT.

DRYWALL INSIDE DIAMETER      FT. EFFECTIVE DEPTH BELOW INLET      FT.

ABSORBENT AREA 720 SQ. FT.

REMARKS: 7/27/94 A.M. OK to continue work. DKS

7/27/94 P.M. OK to cover all work. DKS

WPI 48" below grade - OK to cover. DKS

DATE SYSTEM APPROVED 7/27/94

INSPECTOR Louisa K. Sae

# APPLICATION

SEWAGE DISPOSAL TESTING

STATE OF MARYLAND - DEPARTMENT OF HEALTH AND MENTAL HYGIENE

A 41711

P \_\_\_\_\_

HOWARD COUNTY HEALTH DEPARTMENT  
ENVIRONMENTAL HEALTH SERVICES

P. O. BOX 473 ELLICOTT CITY, MARYLAND 21043  
TELEPHONE: 992-2330

DISTRICT 3RD.

DATE FEB. 16, 1988

TO: THE COUNTY HEALTH OFFICER  
ELLICOTT CITY, MARYLAND

I, HEREBY, APPLY FOR THE NECESSARY TEST IN ORDER TO CONSTRUCT (OR RECONSTRUCT) A SEWAGE DISPOSAL SYSTEM.

PROPERTY OWNER ALBEE FARM Attieri Homes

ADDRESS 12150 ROUTE 99 MARIOTTSVILLE MD. 21104 PHONE 796-5206

PROPERTY LOCATION: N/3 MD. ROUTE 99 WEST OF HENRYTON ROAD

SUBDIVISION ALBEE FARM LOT NO. 15

ROAD AND DESCRIPTION ROAD 'A' (12169 Woodford Drive)

SIZE OF LOT 3.9 Ac± TYPE BLDG. SFD  
(NUMBER OF BEDROOMS)

THE SYSTEM INSTALLED UNDER THIS APPLICATION IS ACCEPTABLE ONLY UNTIL PUBLIC FACILITIES BECOME AVAILABLE. I FULLY UNDERSTAND THE FEE CONNECTED WITH THE FILING OF THIS PERC TEST APPLICATION IS NON-REFUNDABLE UNDER ANY CIRCUMSTANCES. I ALSO AGREE TO COMPLY

WITH ALL M.O.S.H.A. REQUIREMENTS IN TESTING THIS LOT. Don D. Bal  
(SIGNATURE OF APPLICANT)

APPROVED BY \_\_\_\_\_ FOR \_\_\_\_\_ DATE \_\_\_\_\_

REJECTED BY \_\_\_\_\_ FOR \_\_\_\_\_ DATE \_\_\_\_\_

HOLD PENDING FURTHER TESTS \_\_\_\_\_ DATE \_\_\_\_\_

REASONS FOR REJECTION OR HOLDING (B) 7-14-88 Pmt Satisfactory - Hold for Subl. Plat Sdb

THIS PERMIT SIGNED  
AND RETURNED 4/2/94  
Serial # 53222  
SFD-400ms

# THIS IS NOT A PERMIT



C1 8309

SEQUENCE NO. (DENV USE ONLY)

STATE OF MARYLAND WELL COMPLETION REPORT

FILL IN THIS FORM COMPLETELY PLEASE PRINT OR TYPE

THIS REPORT MUST BE SUBMITTED WITHIN 45 DAYS AFTER WELL IS COMPLETED.

COUNTY NUMBER A # 41711

(THIS NUMBER IS TO BE PUNCHED IN COLS. 3-6 ON ALL CARDS)

ST/CO USE ONLY DATE Received

DATE WELL COMPLETED

Depth of Well

PERMIT NO. FROM "PERMIT TO DRILL WELL"

8 13

032374

22 365 26 (TO NEAREST FOOT)

28 29 30 31 32 33 34 35 36 37 H0-94-0045

OWNER ALBERTI NOMES last name WOODFORD DRIVE first name TOWN W.F. SUBDIVISION SPRING VALLEY CHASE SECTION LOT 15

WELL LOG table with columns: DESCRIPTION, FEET (FROM, TO), Check if water bearing. Includes handwritten entries: SAND @ 38, GRAYMICA Rock 38-365.

GROUTING RECORD: WELL HAS BEEN GROUTED (Y), TYPE OF GROUTING MATERIAL: CEMENT (CM), BENTONITE CLAY (BC), NO. OF BAGS 10, NO. OF POUNDS 740, GALLONS OF WATER 60, DEPTH OF GROUT SEAL 28 ft.

CASING RECORD: casing types insert appropriate code below. ST (STEEL), CO (CONCRETE), PL (PLASTIC), OT (OTHER).

MAIN CASING TYPE: ST, Nominal diameter 6 inch, Total depth 22 feet.

OTHER CASING (if used) diameter inch, depth (feet) from to.

SCREEN RECORD: screen type or open hole insert appropriate code below. ST (STEEL), BR (BRASS), HO (OPEN HOLE), PL (PLASTIC), OT (OTHER).

DEPTH (nearest ft.) table with handwritten values: 11, 15, 17, 21, 23, 24, 26, 30, 32, 36, 38, 39, 41, 45, 47, 51.

CIRCLE APPROPRIATE LETTER A WELL WAS ABANDONED AND SEALED WHEN THIS WELL WAS COMPLETED. E ELECTRIC LOG OBTAINED. P TEST WELL CONVERTED TO PRODUCTION WELL.

I HEREBY CERTIFY THAT THIS WELL HAS BEEN CONSTRUCTED IN ACCORDANCE WITH COMAR 26.04.04 "WELL CONSTRUCTION" AND IN CONFORMANCE WITH ALL CONDITIONS STATED IN THE ABOVE CAPTIONED PERMIT...

DRILLERS IDENT. NO. 24

DRILLERS SIGNATURE (MUST MATCH SIGNATURE ON APPLICATION)

SITE SUPERVISOR (sign. of driller or journeyman responsible for sitework, if different from permittee)

GRAVEL PACK IF WELL DRILLED WAS FLOWING WELL INSERT F IN BOX 68

OEP USE ONLY (NOT TO BE FILLED IN BY DRILLER) T (E.R.O.S.) W Q

TELESCOPE CASING LOG INDICATOR OTHER DATA

PUMPING TEST: HOURS PUMPED 3, PUMPING RATE 4.2 gal. per min., METHOD USED TO MEASURE PUMPING RATE Bucket, WATER LEVEL BEFORE PUMPING 43, WHEN PUMPING 199, TYPE OF PUMP USED submersible.

PUMP INSTALLED: DRILLER WILL INSTALL PUMP YES NO, TYPE OF PUMP INSTALLED, CAPACITY: GALLONS PER MINUTE, PUMP HORSE POWER, PUMP COLUMN LENGTH, CASING HEIGHT, LAND SURFACE.

LOCATION OF WELL ON LOT SHOW PERMANENT STRUCTURE SUCH AS BUILDING, SEPTIC TANKS, AND/OR LANDMARKS AND INDICATE NOT LESS THAN TWO DISTANCES (MEASUREMENTS TO WELL)

See Attached location

B 1 08734

SEQUENCE NO. (DP USE ONLY)

STATE OF MARYLAND PERMIT TO DRILL WELL please print or type

STATE PERMIT NUMBER

10-94-0045 fill in this form completely

Date Received (APA)

031694

OWNER INFORMATION

8 13 ALTIERI HOMES 15 Last Name Owner First Name 34 7347 HARDWOOD VIEW DR 36 Street or RFD 55 ELK RIDGE 57 Town 70 State 72 Zip 76

DRILLER INFORMATION

Driller's Name Joseph L. Wayne 77 License No. 24 Firm Name Joseph L. Wayne Well Drilling Address 5512 Ridge Rd. Mt. Airy Md. 21771 Signature Joseph L. Wayne Date 3/15/94

WELL INFORMATION

APPROX. PUMPING RATE (GAL. PER MIN.) 5 AVERAGE DAILY QUANTITY NEEDED (GAL. PER DAY) 500

USE FOR WATER (CIRCLE APPROPRIATE BOX)

- HOME (SINGLE OR DOUBLE HOUSEHOLD UNIT ONLY)
FARMING (LIVESTOCK WATERING & AGRICULTURAL IRRIGATION)
INDUSTRIAL, COMMERCIAL, STATE AND FEDERAL GOV. OTHER (REQUIRES APPROPRIATION PERMIT)
PUBLIC OR PRIVATE WATER COMPANY (REQUIRES APPROPRIATION PERMIT AND STATE HEALTH DEPARTMENT APPROVAL)
TEST, OBSERVATION, MONITORING (MAY REQUIRE APPROPRIATION PERMIT)

APPROXIMATE DEPTH OF WELL 300 FEET

APPROXIMATE DIAMETER OF WELL 6 INCH

METHOD OF DRILLING (circle one)

BORED (or Augered) JETTED Jetted & DRIVEN AIR-ROTARY AIR-PERCussion ROTARY (Hydraulic Rotary) CABLE REVerse-ROTary Drive-POINT other

REPLACEMENT OR DEEPEMED WELLS (CIRCLE APPROPRIATE BOX)

THIS WELL WILL NOT REPLACE AN EXISTING WELL
THIS WELL WILL REPLACE A WELL THAT WILL BE ABANDONED AND SEALED
THIS WELL WILL REPLACE A WELL THAT WILL BE USED AS A STANDBY
THIS WELL WILL DEEPEM AN EXISTING WELL
PERMIT NUMBER OF WELL TO BE REPLACED OR DEEPEMED (IF AVAILABLE)

Not to be filled in by driller (OEP USE ONLY)

APPROX. PERMIT NUMBER GAP FORCE WRITE INITIALS IN BOX PERMIT No. 10-94-0045

SPECIAL CONDITIONS

LOCATION OF WELL

HOWARD COUNTY SPRING VALLEY CHASE SUBDIVISION SECTION 44 LOT 15 WEST HAINES TOWN MILES FROM TOWN 2.5

DIRECTION OF WELL FROM TOWN (CIRCLE BOX)

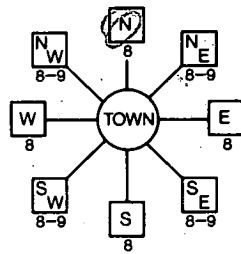

NEAR WHAT ROAD Woodland Drive

ON WHICH SIDE OF ROAD (CIRCLE APPROPRIATE BOX) NORTH WEST EAST SOUTH DISTANCE FROM ROAD 3.5 ENTER FT or MI FT

NOT TO BE FILLED IN BY DRILLER HEALTH DEPARTMENT APPROVAL

COUNTY NAME HOWARD COUNTY NO. R# 41711 STATE SIGNATURE DATE ISSUED 031794 CO SIGNATURE EXP. DATE 3/17/95 NORTH GRID 543000 EAST GRID 8218000

SHOW MAJOR FEATURES OF BOX & LOCATE WELL WITH AN X SOURCES OF DRILLING WATER 1. WELL 2. 3.

Handwritten notes: 2/23/94 9:30 above grade! 14' open hole! 38' depth casing! 42' #bags: 10

WRITE THE BOX NUMBER FROM THE MAP HERE E 828 18 N 547 3

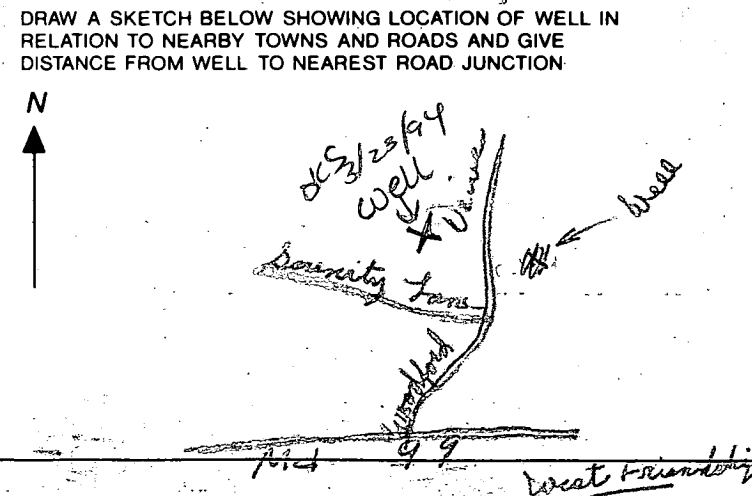



---

## HOWARD COUNTY HEALTH DEPARTMENT

---

*Joyce M. Boyd, M.D., County Health Officer*

October 4, 1995

Mr. Ruygyok  
12169 Woodford Drive  
Marriottsville, Maryland 21104

RE: Spring Valley Chase, Lot #15  
12169 Woodford Drive  
Well Permit #HO-94-0045

Dear Mr. Ruygyok:

A review of our records indicates that the water sample taken August 3, 1995 for final approval of your water supply did not include a sample for nitrate testing. Therefore, it will be necessary for you to schedule a final appointment so that a sample for nitrate testing can be taken from a tap treated for nitrates. This sample is required to verify that the nitrate treatment device is operating properly. You will receive a final approval for your well water supply, with the nitrate treatment device in use, providing that the sample results show nitrates at an acceptable level.

Please call this office at (410) 313-2640 to schedule the final water sample appointment. Thank you in advance for your prompt attention to this matter.

Sincerely,

  
Donna K. Soe, Sanitarian  
Water and Sewerage Program

DKS

ENGINEER'S CERTIFICATE

I HEREBY CERTIFY THAT THIS PLAN FOR EROSION AND SEDIMENT CONTROL REPRESENTS A PRACTICAL AND WORKABLE PLAN BASED ON MY PERSONAL KNOWLEDGE OF THE SITE CONDITION AND THAT IT WAS PREPARED IN ACCORDANCE WITH THE REQUIREMENTS OF THE HOWARD SOIL CONSERVATION DISTRICT.

SIGNATURE OF ENGINEER DATE 3/23/94

DEVELOPER'S CERTIFICATE

I/WE CERTIFY THAT ALL DEVELOPMENT AND CONSTRUCTION WILL BE DONE ACCORDING TO THIS PLAN OF DEVELOPMENT AND PLAN FOR EROSION AND SEDIMENT CONTROL AND THAT ALL RESPONSIBLE PERSONNEL INVOLVED IN THE CONSTRUCTION PROJECT WILL HAVE A CERTIFICATE OF ATTENDANCE AT A DEPARTMENT OF NATURAL RESOURCES APPROVED TRAINING PROGRAM FOR THE CONTROL OF SEDIMENT AND EROSION BEFORE BEGINNING THE PROJECT. I ALSO AUTHORIZE PERIODIC ON-SITE INSPECTION BY THE HOWARD SOIL CONSERVATION DISTRICT OR THEIR AUTHORIZED AGENTS, AS ARE DEEMED NECESSARY.

SIGNATURE OF DEVELOPER DATE 3/23/94

REVIEWED FOR HOWARD COUNTY SOIL CONSERVATION DISTRICT AND MEETS TECHNICAL REQUIREMENTS.

U.S. SOIL CONSERVATION DISTRICT DATE

THIS DEVELOPMENT IS APPROVED FOR EROSION AND SEDIMENT CONTROL BY THE HOWARD SOIL CONSERVATION DISTRICT. APPROVED:

DISTRICT HOWARD SOIL CONSERVATION DIST. DATE

SEQUENCE OF CONSTRUCTION

- 1. OBTAIN GRADING PERMIT.
2. INSTALL SEDIMENT CONTROLS AS SHOWN ON PLAN.
3. PERFORM NECESSARY GRADING AND STABILIZE THE SITE.
4. AFTER THE SITE IS STABILIZED AND PERMISSION IS GRANTED FROM THE SEDIMENT CONTROL INSPECTOR, REMOVE SEDIMENT CONTROLS AND STABILIZE ANY REMAINING DISTURBED AREAS.

TEMPORARY SEEDING NOTES

APPLY TO GRADED OR CLEARED AREAS LIKELY TO BE REDISTURBED WHERE A SHORT-TERM VEGETATIVE COVER IS NEEDED.

SEEDING PREPARATION

LOOSEN UPPER THREE INCHES OF SOIL BY RAKING, DISCING OR OTHER ACCEPTABLE MEANS BEFORE SEEDING. IF NOT PREVIOUSLY LOOSENED.

SOIL AMENDMENTS

APPLY 500 LBS. PER ACRE 10-10-10 FERTILIZER @ 1.5 LBS./1000 SQ. FT.

SEEDING

FOR THE PERIODS MARCH 1 THROUGH APRIL 30, AND AUGUST 15 THROUGH NOVEMBER 15, SEED WITH 1 1/2 BUSHEL PER ANNUAL RYE @ 3 LBS./1000 SQ.FT. FOR THE PERIOD MAY 1 THRU AUGUST 14, SEED WITH 3 LBS./ACRE OF WEEPING LOVEGRASS @ 0.7 LBS./1000 SQ.FT. FOR THE PERIOD NOVEMBER 16 THRU FEBRUARY 28, PROTECT SITE BY APPLYING 2 TONS PER ACRE OF WELL ANCHORED STRAW MULCH AND SEED AS SOON AS POSSIBLE IN THE SPRING, OR USE SOD.

MULCHING

APPLY 1 1/2 TO 2 TONS PER ACRE (70 TO 90 LBS./1000 SQ.FT.) OF UNROTTED SMALL GRAIN STRAW IMMEDIATELY AFTER SEEDING. ANCHOR MULCH IMMEDIATELY AFTER APPLICATION USING MULCH ANCHORING TOOL OR 200 GALLONS PER ACRE (5 GAL./1000 SQ.FT.) OF EMULSIFIED ASPHALT ON FLAT ACRES, ON SLOPES 0 FEET OR HIGHER, USE 340 GALLONS PER ACRE (6 GAL./1000 SQ.FT.) FOR ANCHORING.

REFER TO THE 1986 MARYLAND STANDARDS AND SPECIFICATION FOR SOIL EROSION AND SEDIMENT CONTROL FOR RATE AND METHODS NOT COVERED.

PERMANENT SEEDING NOTES

ALL DISTURBED AREAS SHALL BE STABILIZED AS FOLLOWS:

SEEDING PREPARATION

LOOSEN UPPER THREE INCHES OF SOIL BY RAKING, DISCING OR OTHER ACCEPTABLE MEANS BEFORE SEEDING.

SOIL AMENDMENTS

APPLY TWO TONS PER ACRE DOLOMITIC LIMESTONE (92 LBS./1000 SQ.FT.) AND 500 LBS. PER ACRE 0-20-20 FERTILIZER (4 LBS./1000 SQ.FT.) BEFORE SEEDING HARROW OR DISC INTO UPPER THREE INCHES OF SOIL. AT THE TIME OF SEEDING, APPLY 400 LBS. PER ACRE 38-0-0 UREAFORM FERTILIZER (9 LBS./1000 SQ.FT.) AND 500 LBS. PER ACRE (11.5 LBS./1000 SQ.FT.) OF 10-20-20 FERTILIZER.

SEEDING

FOR THE PERIODS MARCH 1 THROUGH APRIL 30, AND AUGUST 1 THROUGH OCTOBER 15, SEED WITH 100 LBS. PER ACRE (2.3 LBS./1000 SQ.FT.) OF KENTUCKY 31 TALL FESCUE. FOR THE PERIOD MAY 1 THROUGH JULY 31, SEED WITH 60 LBS./ACRE (1.4 LBS./1000 SQ.FT.) KENTUCKY 31 TALL FESCUE AND 2 LBS. PER ACRE (0.05 LBS./1000 SQ.FT.) OF WEEPING LOVEGRASS. DURING THE PERIOD OF OCTOBER 16 THROUGH FEBRUARY 28, PROJECT SITE BY OPTION (1) - TWO TONS PER ACRE OF WELL ANCHORED STRAW MULCH AND SEED AS SOON AS POSSIBLE IN THE SPRING, OPTION (2) - USE SOD, OPTION (3) - SEED WITH 100 LBS./ACRE KENTUCKY 31 TALL FESCUE AND MULCH WITH TWO TONS/ACRE WELL ANCHORED STRAW. ALL SLOPES SHOULD BE HYDROSEEDED.

MULCHING

APPLY 1 1/2 TO 2 TONS PER ACRE (70 TO 90 LBS./1000 SQ.FT.) OF UNROTTED SMALL GRAIN STRAW IMMEDIATELY AFTER SEEDING. ANCHOR MULCH IMMEDIATELY AFTER APPLICATION USING 200 GALLONS PER ACRE (5 GAL./1000 SQ.FT.) OF EMULSIFIED ASPHALT ON FLAT ACRES, ON SLOPES 0 FEET OR HIGHER USE 340 GALLONS PER ACRE (6 GAL./1000 SQ.FT.) FOR ANCHORING.

MAINTENANCE

INSPECT ALL SEEDED AREAS AND MAKE NEEDED REPAIRS, REPLACEMENTS AND RESEEDINGS.

\* FOR PUBLIC PONDS SUBSTITUTE CHEMUNG CROWNWEED AT 15 LBS./ACRE AND KENTUCKY 31 TALL FESCUE AT 40 LBS./ACRE AS THE SEEDING REQUIREMENT. OPTIMUM SEEDING DATE FOR THIS MIXTURE IS MARCH 1 TO APRIL 30.

SEDIMENT CONTROL NOTES

- 1. A MINIMUM OF 24 HOURS NOTICE MUST BE GIVEN TO THE HOWARD COUNTY OFFICE OF INSPECTIONS AND PERMITS PRIOR TO THE START OF ANY CONSTRUCTION (1992-2437).
2. ALL VEGETATIVE AND STRUCTURAL PRACTICES ARE TO BE INSTALLED ACCORDING TO THE PROVISIONS OF THIS PLAN AND ARE TO BE IN CONFORMANCE WITH THE 1983 MARYLAND STANDARDS AND SPECIFICATIONS FOR SOIL EROSION AND SEDIMENT CONTROL.
3. FOLLOWING INITIAL SOIL DISTURBANCE OR REDISTURBANCE, PERMANENT OR TEMPORARY STABILIZATION SHALL BE COMPLETED WITHIN A 7 CALENDAR DAYS FOR ALL PERIMETER SEDIMENT CONTROL STRUCTURES, DICES, PERIMETER SLOPES AND ALL GREATER THAN 30 DAY DAYS AS TO ALL OTHER DISTURBED OR GRADED AREAS ON THE PROJECT SITE. ALL SEDIMENT TRAPS/BASINS SHOWN MUST BE FENCED AND WARNING SIGNS POSTED AROUND THEIR PERIMETER IN ACCORDANCE WITH VOL. 1, CHAPTER 12, OF THE HOWARD COUNTY DESIGN MANUAL. STORM DRAINAGE.
4. ALL DISTURBED AREAS MUST BE STABILIZED WITHIN THE TIME PERIOD SPECIFIED ABOVE IN ACCORDANCE WITH THE 1983 MARYLAND STANDARDS AND SPECIFICATIONS FOR SOIL EROSION AND SEDIMENT CONTROL FOR PERMANENT SEEDINGS (SEC. 50 500 (SEC. 54), TEMPORARY SEEDING (SEC. 50) AND MULCHING (SEC. 52). TEMPORARY STABILIZATION WITH MULCH ALONE CAN ONLY BE DONE WHEN RECOMMENDED SEEDING DATES DO NOT ALLOW FOR PROPER GERMINATION AND ESTABLISHMENT OF GRASSES.
5. ALL SEDIMENT CONTROL STRUCTURES ARE TO REMAIN IN PLACE AND ARE TO BE MAINTAINED IN OPERATIVE CONDITION UNTIL PERMISSION FOR THEIR REMOVAL HAS BEEN OBTAINED FROM THE HOWARD COUNTY SEDIMENT CONTROL INSPECTOR.
7. SITE ANALYSIS:
TOTAL AREA OF SITE 4.16 ACRES
AREA DISTURBED 0.35 ACRES
AREA TO BE ROOFED OR PAVED 0.11 ACRES
AREA TO BE VEGETATIVELY STABILIZED 0.24 ACRES
TOTAL CUT 200 CU.YDS.
TOTAL FILL 200 CU.YDS.
OFFSITE WASTE/BORROW AREA LOCATION U/I CU.YDS.
8. ANY SEDIMENT CONTROL PRACTICE WHICH IS DISTURBED BY GRADING ACTIVITY FOR PLACEMENT OF UTILITIES MUST BE REPAIRED ON THE SAME DAY OF DISTURBANCE.
9. ADDITIONAL SEDIMENT CONTROLS MUST BE PROVIDED, IF DEEMED NECESSARY BY THE HOWARD COUNTY DPW SEDIMENT CONTROL INSPECTOR.
10. ON ALL SITES WITH DISTURBED AREAS IN EXCESS OF 2 ACRES, APPROVAL OF THE INSPECTION AGENCY SHALL BE REQUESTED UPON COMPLETION OF INSTALLATION OF PERIMETER EROSION AND SEDIMENT CONTROLS, BUT BEFORE PROCEEDING WITH ANY OTHER EARTH DISTURBANCE OR GRADING. OTHER BUILDING OR GRADING INSPECTION APPROVALS MAY NOT BE AUTHORIZED UNTIL THIS INITIAL APPROVAL BY THE INSPECTION AGENCY IS MADE.

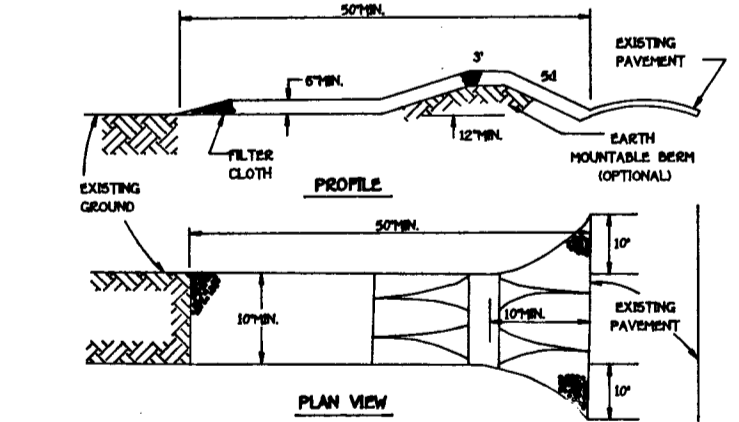

CONSTRUCTION SPECIFICATIONS

- 1. STONE SIZE - USE 2" STONE, OR RECLAIMED OR RECYCLED CONCRETE EQUIVALENT.
2. LENGTH - AS REQUIRED, BUT NOT LESS THAN 50 FEET EXCEPT ON A SINGLE RESIDENCE LOT WHERE A 30 FOOT MINIMUM LENGTH WOULD APPLY.
3. THICKNESS - NOT LESS THAN SIX (6) INCHES.
4. WIDTH - TEN (10) FOOT MINIMUM, BUT NOT LESS THAN THE FULL WIDTH AT POINTS WHERE INGRESS OR EGRESS OCCURS.
5. FILTER CLOTH - WILL BE PLACED OVER THE ENTIRE AREA PRIOR TO PLACING OF STONE. FILTER WILL NOT BE REQUIRED ON A SINGLE FAMILY RESIDENCE LOT.
6. SURFACE WATER - ALL SURFACE WATER FLOWING OR DIVERTED TOWARD CONSTRUCTION ENTRANCES SHALL BE PIPED ACROSS THE ENTRANCE. IF PIPING IS IMPRACTICAL, A PORTABLE BERM WITH 2:1 SLOPES WILL BE SET.
7. MAINTENANCE - THE ENTRANCE SHALL BE MAINTAINED IN A CONDITION WHICH WILL PREVENT TRACKING OR FLOWING OF SEDIMENT ONTO PUBLIC RIGHTS-OF-WAY. THIS MAY REQUIRE PERIODIC TOP DRESSING WITH ADDITIONAL STONE AS CONDITIONS DEMAND AND REPAIR AND/OR CLEANOUT OF ANY MEASURES USED TO TRAP SEDIMENT. ALL SEDIMENT SPILLED, DROPPED, WASHED OR TRACKED ONTO PUBLIC RIGHTS-OF-WAY MUST BE REMOVED IMMEDIATELY.
8. WASHING - WHEELS SHALL BE CLEANED TO REMOVE SEDIMENT PRIOR TO EXITING ONTO PUBLIC RIGHTS-OF-WAY. WHEN WASHING IS REQUIRED, IT SHALL BE DONE ON AN AREA STABILIZED WITH STONE AND WHICH DRAINS INTO AN APPROVED SEDIMENT TRAPPING DEVICE.
9. PERIODIC INSPECTION AND NEEDED MAINTENANCE SHALL BE PROVIDED AFTER EACH RAIN.

STABILIZED CONSTRUCTION ENTRANCE - 2 NOT TO SCALE

CONSTRUCTION NOTES FOR FABRICATED SILT FENCE

- 1. WOVEN WIRE FENCE TO BE FASTENED SECURELY TO FENCE POSTS WITH WIRE TIES OR STAPLES.
2. FILTER CLOTH TO BE FASTENED SECURELY TO WOVEN WIRE FENCE WITH TIES SPACED EVERY 24" AT TOP AND MID SECTION.
3. WHEN TWO SECTIONS OF FILTER CLOTH ADJOIN EACH OTHER THEY SHALL BE OVERLAPPED BY SIX INCHES AND FOLDED.
4. MAINTENANCE SHALL BE PERFORMED AS NEEDED AND MATERIAL REMOVED WHEN "BULGES" DEVELOP IN THE SILT FENCE.

SILT FENCE NOT TO SCALE

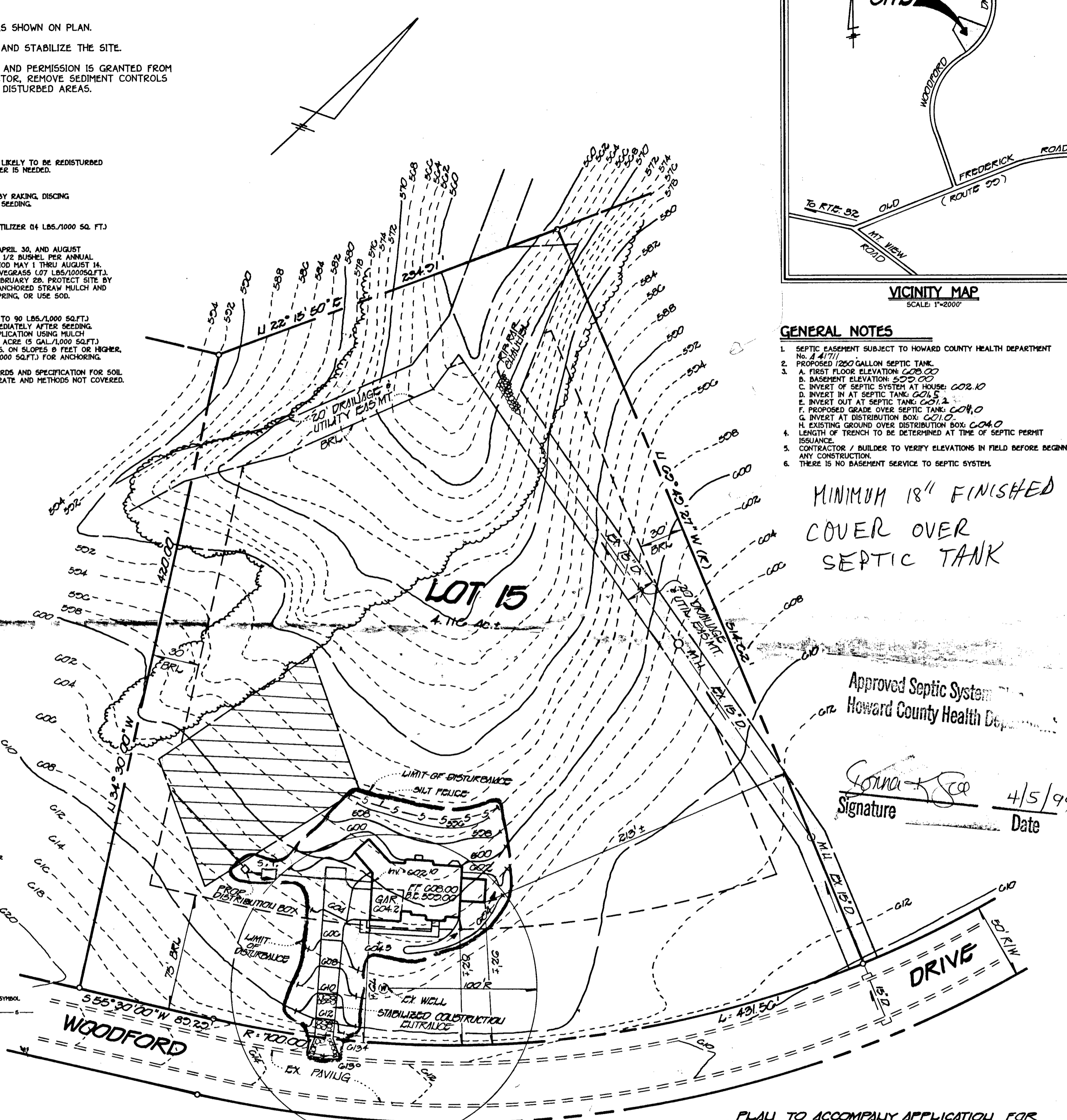

PLAN SCALE: 1" = 50'



PLAN TO ACCOMPANY APPLICATION FOR BUILDING PERMIT
'SPRING VALLEY CHASE LOT 15
3RD ELECTION DISTRICT DATE: MAR. 21, 1994
HOWARD COUNTY, MARYLAND SCALE: AS SHOWN
SUBSET 1 of 1

FISHER, COLLINS & CARTER, INC. CIVIL ENGINEERING CONSULTANTS & LAND SURVEYORS 9171 BALTIMORE NATIONAL PIKE, SUITE 100 ELLICOTT CITY, MARYLAND 21042 (410) 461 - 2855

