

P 43590

A REPAIR

MARYLAND STATE DEPARTMENT OF HEALTH

DISTRICT _____

DATE 7.6.89

DATE SYSTEM APPROVED 11/9/87

INSPECTOR M. K. H.

INDEXED

Jack Fyock

IS PERMITTED TO INSTALL _____ ALTER X

ADDRESS _____ PHONE 988-9270

SUBDIVISION _____ ROAD 12945 Triadelphia Mill LOT _____

PROPERTY OWNER William Matthews

ADDRESS _____

IF GARBAGE GRINDER IS USED INCREASE SEPTIC TANK CAPACITY BY 50% AND ABSORPTION AREA BY 22%.

GARBAGE GRINDER? YES _____ NO X

SEPTIC TANK CAPACITY 1250 GALLONS NUMBER OF BEDROOMS 4

REPAIR - CALL FOR INSPECTION WHEN GROUND IS OPENED UP SO SANITARIAN CAN RECOMMEND REPAIR.

506TH house ON LEFT OFF TEN OAKS Rd. ACROSS FROM TEN OAKS NURSERY

PLANS APPROVED BY C. Williams DATE 1/03/89

COVER NO WORK UNTIL INSPECTED AND APPROVED

NEITHER THE HOWARD COUNTY COUNCIL NOR THE HEALTH DEPARTMENT IS RESPONSIBLE FOR THE SUCCESSFUL OPERATION OF ANY SYSTEM.

NOTE. CLEANOUT REQUIRED EVERY 70 FEET OF SEWER LINE AND/OR AT 90° SWEEPS IN LINES FROM HOUSE TO DRAIN FIELDS

NOTE: ALL PARTS OF SEPTIC SYSTEMS (I.E., TANK, DISTRIBUTION BOX, TRENCHES) TO BE 100 FEET FROM WELL (UNLESS OTHERWISE SPECIFICALLY AUTHORIZED)

NOTE: IF DEEP TRENCH(ES) ARE USED CALL FOR INSPECTION BEFORE AND AFTER PLACING GRAVEL IN TRENCH(ES)

NOTE: NO DRY WELL SHALL EXCEED 15 FOOT IN DIAMETER NO ABSORPTION TRENCH TO EXCEED 100 FEET IN LENGTH

NOTE: ALL PIPE FROM HOUSE TO SEPTIC TANK MUST BE CAST IRON OR SCHEDULE 40 PVC OR ABS

PERMIT VOID AFTER TWO YEARS

NOTE: INSTALL STAND PIPE ON SEPTIC TANK AND DRY WELL. STAND PIPES MUST BE 6 INCHES IN DIAMETER. CAST IRON, CONCRETE OR TERRA COTTA OR PVC OR ABS ACCEPTED. IF TOP OF SEPTIC TANK IS DEEPER THAN 3 FEET, MANHOLE TO GRADE REQUIRED

NOTE: DISTRIBUTION BOXES MUST HAVE BAFFLES

***INSTALLER IS RESPONSIBLE FOR OBTAINING FINAL APROVAL ON THIS PERMIT**

***CALL 461-9933 FOR INSPECTION OF SEPTIC SYSTEMS.**

43590

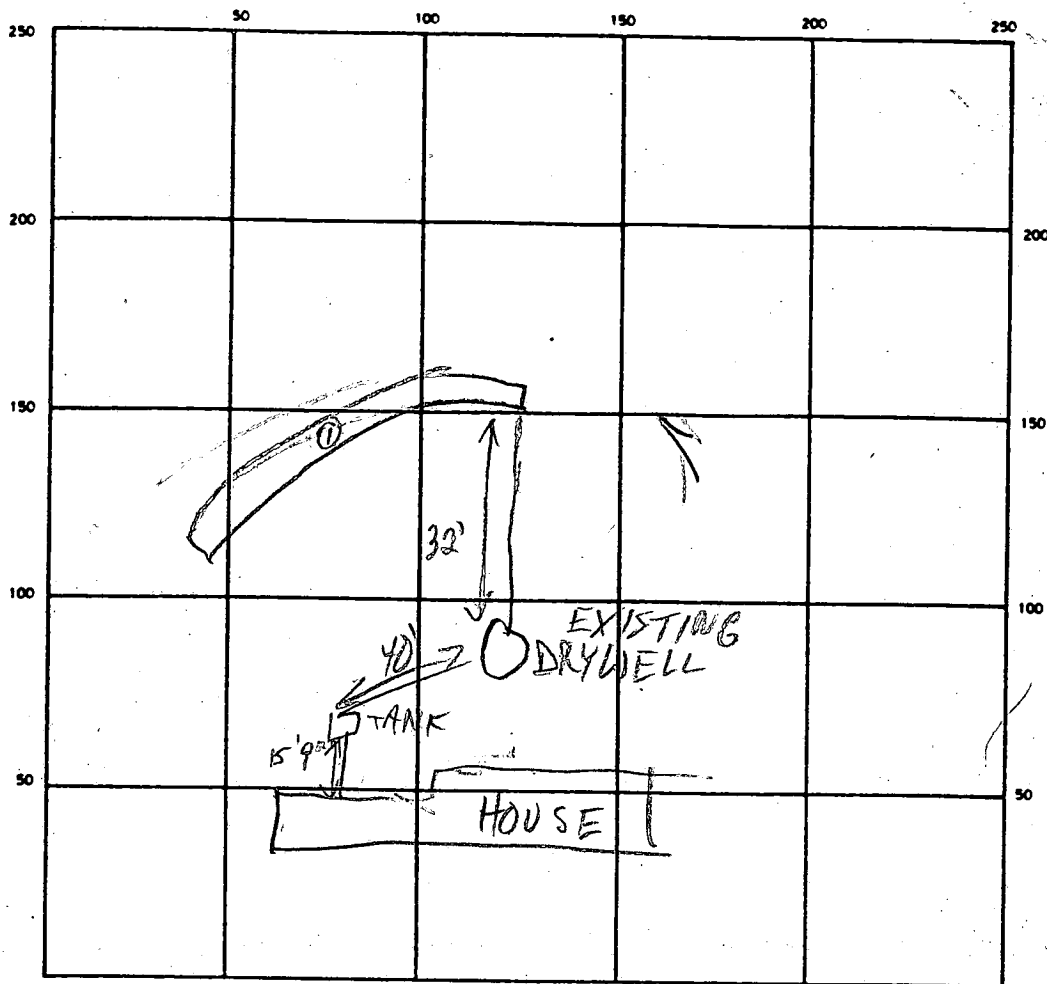

SEPTIC TANK LEVEL _____ CLEANOUTS 4/2

DISTRIBUTION BOX LEVEL _____

DRAIN FIELD/TILE FIELD DEPTH 11 FT. TRENCH WIDTH 2' FT. INLET DEPTH 3' FT.

EFFECTIVE GRAVEL DEPTH 8' FT. TOTAL LENGTH 80 FT.

NUMBER OF TRENCHES 1 ONE SIDEWALL ~~AREA~~ 640 SQ. FT.

DRYWELL INSIDE DIAMETER — FT. EFFECTIVE DEPTH BELOW INLET 8' FT.

ABSORBENT AREA 640 SQ. FT.

REMARKS 1/4/89 TRENCH DUG; STONE & PAPER IN PROCESS; FINAL
GIVEN & OK TO COVER MR

DATE SYSTEM APPROVED 1/4/89

INSPECTOR M. Rife