

4/27/89  
RM  
4/28

05-348838

# PERMIT

SEWAGE DISPOSAL SYSTEM

MARYLAND STATE DEPARTMENT OF HEALTH

P 44124  
A 19408  
REPAIR

**HOWARD COUNTY**  
BUREAU OF ENVIRONMENTAL HEALTH  
461-9933

DISTRICT 5th

DATE 5/1/89

DATE SYSTEM APPROVED 4-28-89

INSPECTOR SAHL

INDEXED

Zepp Plumbing & Heating, Inc.

IS PERMITTED TO INSTALL \_\_\_\_\_ ALTER

ADDRESS 12447 Route 108, Clarksville, Maryland 21029 PHONE 531-6712

SUBDIVISION \_\_\_\_\_ ROAD 6044 Trotter Road LOT \_\_\_\_\_

PROPERTY OWNER John Due

ADDRESS \_\_\_\_\_

IF GARBAGE GRINDER IS USED INCREASE SEPTIC TANK CAPACITY BY 50% AND ABSORPTION AREA BY 22%.

GARBAGE GRINDER? YES \_\_\_\_\_ NO \_\_\_\_\_

SEPTIC TANK CAPACITY \_\_\_\_\_ GALLONS NUMBER OF BEDROOMS \_\_\_\_\_

REPAIR - CALL FOR INSPECTION WHEN GROUND IS OPENED UP SO SANITARIAN CAN RECOMMEND

REPAIR.

PLANS APPROVED BY C. Williams DATE 4/27/89

COVER NO WORK UNTIL INSPECTED AND APPROVED

NEITHER THE HOWARD COUNTY COUNCIL NOR THE HEALTH DEPARTMENT IS RESPONSIBLE FOR THE SUCCESSFUL OPERATION OF ANY SYSTEM

NOTE: CLEANOUT REQUIRED EVERY 70 FEET OF SEWER LINE AND/OR AT 90° SWEEPS IN LINES FROM HOUSE TO DRAIN FIELDS

NOTE: ALL PARTS OF SEPTIC SYSTEMS (I.E. TANK, DISTRIBUTION BOX, TRENCHES) TO BE 100 FEET FROM WELL (UNLESS OTHERWISE SPECIFICALLY AUTHORIZED)

NOTE: IF DEEP TRENCHES ARE USED CALL FOR INSPECTION BEFORE AND AFTER PLACING GRAVEL IN TRENCHES

NOTE: NO DRY WELL SHALL EXCEED 15 FOOT IN DIAMETER NO ABSORPTION TRENCH TO EXCEED 100 FEET IN LENGTH.

NOTE: ALL PIPE FROM HOUSE TO SEPTIC TANK MUST BE CAST IRON OR SCHEDULE 40 PVC OR ABS

PERMIT VOID AFTER TWO YEARS

NOTE: INSTALL STAND PIPE ON SEPTIC TANK AND DRY WELL. STAND PIPES MUST BE 6 INCHES IN DIAMETER. CAST IRON, CONCRETE OR TERRA COTTA OR PVC OR ABS ACCEPTED. IF TOP OF SEPTIC TANK IS DEEPER THAN 3 FEET, MANHOLE TO GRADE REQUIRED

NOTE: DISTRIBUTION BOXES MUST HAVE BAFFLES

**\*INSTALLER IS RESPONSIBLE FOR OBTAINING FINAL APROVAL ON THIS PERMIT**

\*CALL 461-9933 FOR INSPECTION OF SEPTIC SYSTEMS.

P  
44124

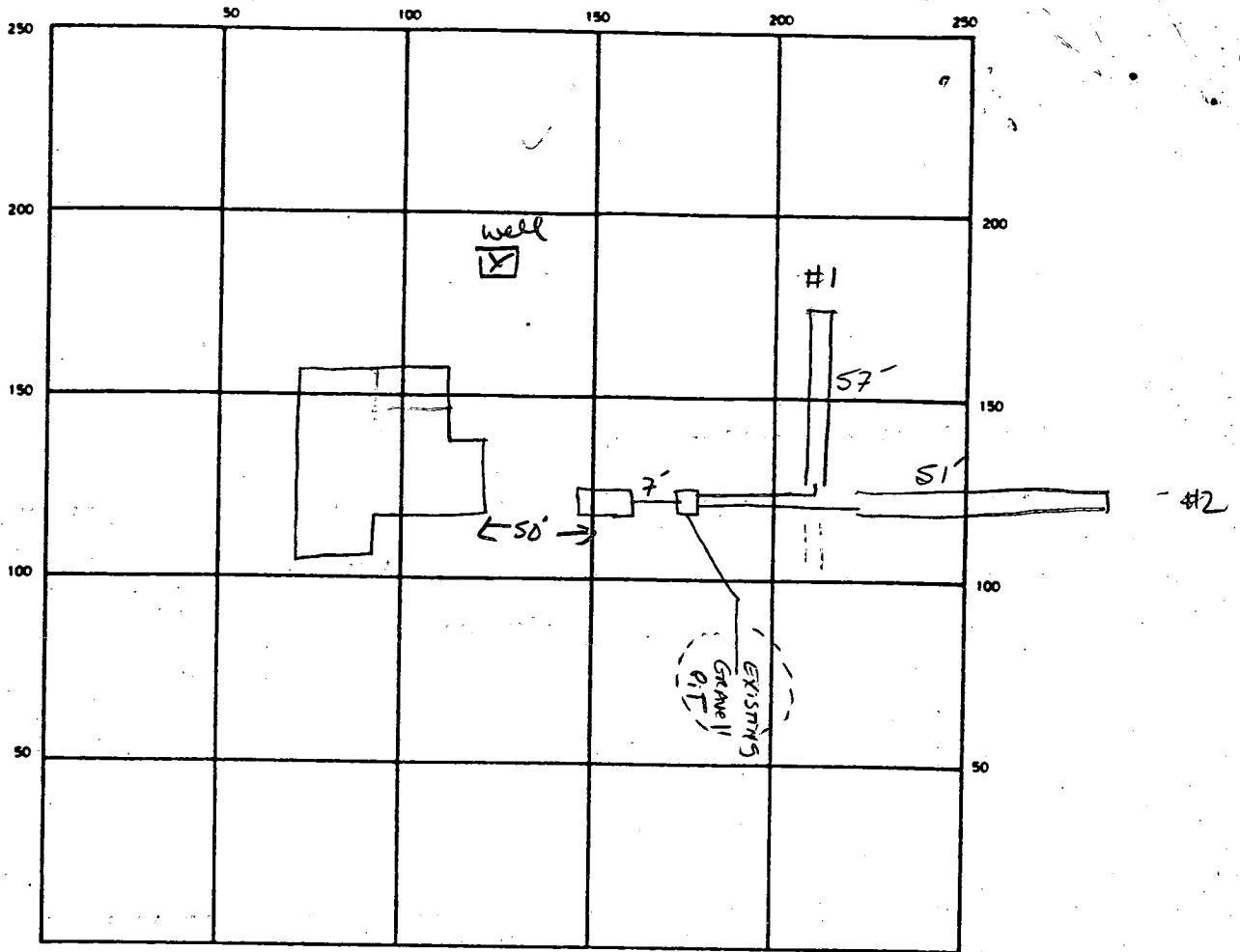

780  
3  
540

INDICATE NORTH - NAME ADJOINING ROADWAY AS BASE LINE  
TROTTER Rd.

SEPTIC TANK LEVEL EXISTING CLEANOUTS below grade

DISTRIBUTION BOX LEVEL ✓ new w/ baffel

DRAIN FIELD/TILE FIELD DEPTH #1-7' TRENCH WIDTH 2 FT. INLET DEPTH #1-3'  
#2-8' FT. #2-4' FT.

EFFECTIVE GRAVEL DEPTH 4 FT. TOTAL LENGTH 57 51 TLF 108

NUMBER OF TRENCHES 2 ONE SIDEWALL BOTTOM AREA 432 + existing PIT SQ. FT.

DRYWELL INSIDE DIAMETER \_\_\_\_\_ FT. EFFECTIVE DEPTH BELOW INLET \_\_\_\_\_ FT.

ABSORBENT AREA \_\_\_\_\_ SQ. FT.

REMARKS 4-27-89 - MAINTAIN EXISTING DRAIN FIELD - INSTALL MIN 100 LF of TRENCH WITH 4" STONE; TRENCH #1 USE A "T" AND #2 USE SEPARATE PIPE. SEE 4-28-89 - "T" IN TRENCH #1 NOT USED, OK TO COVER ALL WORK. S.A

DATE SYSTEM APPROVED 4-28-89 INSPECTOR S. Abel

Card is not on job as either weather has destroyed it or maybe kids took it.

# PERMIT

P 19408

SEWAGE DISPOSAL SYSTEM

app 1-17-74  
JLH A

MARYLAND STATE DEPARTMENT OF HEALTH

HOWARD COUNTY

ELLICOTT CITY

DISTRICT 5

DATE 1/8/74

## INDEXED

1/17/74 -  
Partial OK  
H.H.M.  
Incomp

Cecil's Backhoe Rental IS PERMITTED TO INSTALL ALTER X

ADDRESS 5454 Waterloo Road, Ellicott City, Md. PHONE 465-4772

A SEWAGE DISPOSAL SYSTEM LOCATED AT

SUBDIVISION ROAD 6044 Trotter Rd. LOT (see application for directions)

PROPERTY OWNER John Due

ADDRESS

### SPECIFICATIONS

DRAIN FIELD DEPTH FEET, BOTTOM AREA SQ. FT.

SEEPAGE PITS ABSORBENT SIDE-WALL AREA SQ. FT.

SEPTIC TANK CAPACITY GALLONS

FOR GARBAGE GRINDER, INCREASE DISPOSAL AREA 22% & TANK CAPACITY 50%.

OTHER REPAIR - 10' x 10' dry well - 11 ft. deep with inlet at 3 ft.

OR 40' trench with 8' stone, 11 ft. deep dist. pipe at 3 ft.

Tentative recommendations given on info received by Mr. Cecil Crenshaw subject to change if ground is not of very good type. To dig and call before anything installed.

NOTE: CAST IRON PIPE MUST BE USED FROM SEPTIC TANK TO DRY WELL.  
PERMIT VOID AFTER THREE YEARS.

PLANS APPROVED BY F. Frommelt DATE 1/3/74

NOTE: INSTALL STAND PIPE ON SEPTIC TANK AND DRY WELL.

FILL SEPTIC TANK AND DISTRIBUTION BOX WITH WATER BEFORE CALLING FOR AN INSPECTION. COVER NO WORK UNTIL INSPECTED AND APPROVED.

NEITHER THE HOWARD COUNTY COMMISSIONERS NOR THE HEALTH DEPARTMENT IS RESPONSIBLE FOR THE SUCCESSFUL OPERATION OF ANY SYSTEM.

19408

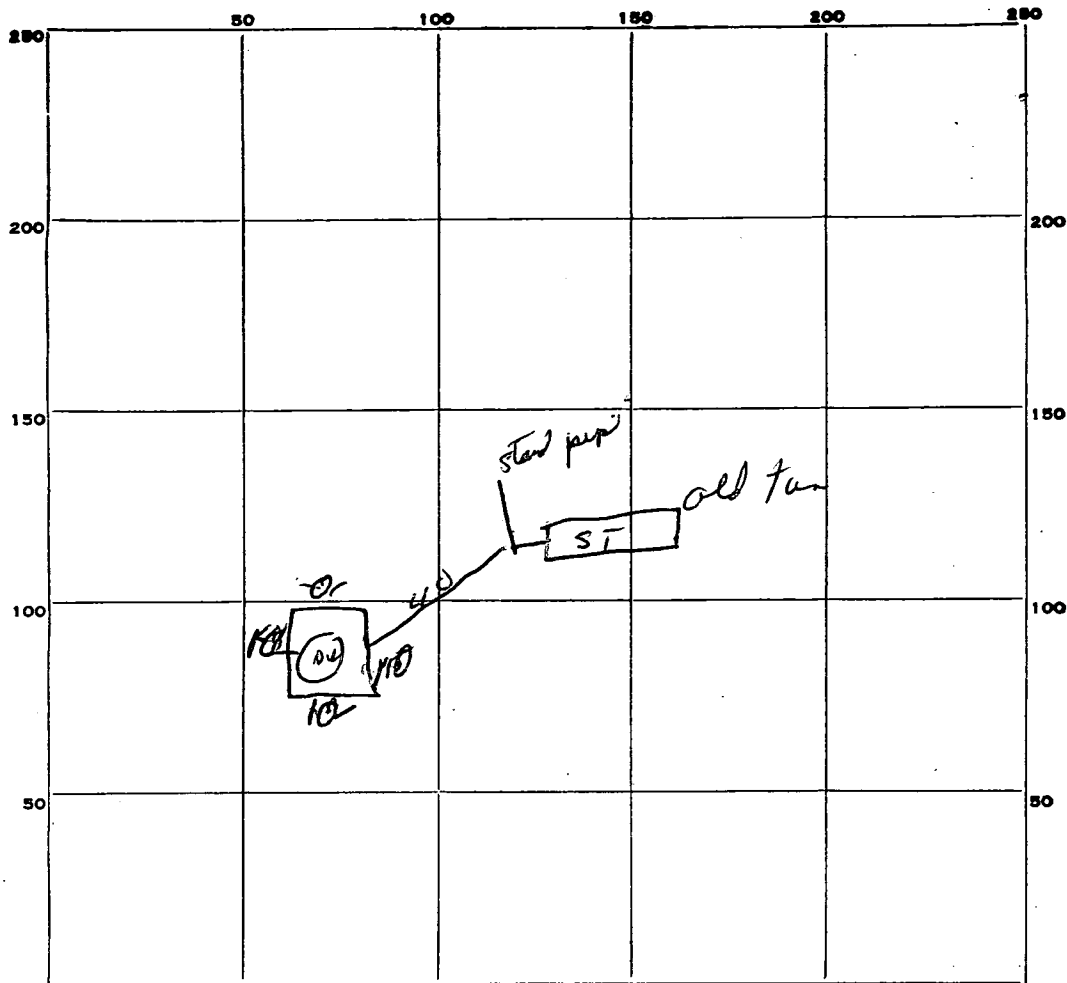

$$\begin{array}{r} 158 \\ 104 \\ \hline 54 \end{array}$$

$$\begin{array}{r} 40 \\ 8\frac{1}{2} \\ \hline 20 \\ 320 \\ \hline 340 \end{array}$$

INDICATE NORTH. — NAME ADJOINING ROADWAY AS BASE LINE.

Trotter Rd

PERMIT CARD NP  
 SEPTIC TANK, LEVEL \_\_\_\_\_ CLEANOUTS \_\_\_\_\_  
 DISTRIBUTION BOX, LEVEL \_\_\_\_\_  
 TILE FIELD, DEPTH \_\_\_\_\_ FT. TRENCH WIDTH \_\_\_\_\_ FT.  
 GRAVEL DEPTH \_\_\_\_\_ IN. TOTAL LENGTH \_\_\_\_\_ FT.  
 NUMBER OF TRENCHES \_\_\_\_\_ TOTAL BOTTOM AREA \_\_\_\_\_  
 SEEPAGE PITS, INSIDE DIAMETER ~~10~~ <sup>40+</sup> FT. DEPTH BELOW INLET 8 1/2 FT.  
 ABSORBENT AREA 340 SQ. FT.

REMARKS 1-8-74 ground OK - can continue dig well const.  
1-15-74 gravel not up to inlet pipe - will have to call for final when done. DW 74

DATE SYSTEM APPROVED 1/17/74 INSPECTOR [Signature]

Fill out in triplicate.  
Make \$15.00 check payable:  
Howard County Health Dept. - Sanitation

# APPLICATION

A \_\_\_\_\_

P \_\_\_\_\_

## SEWAGE DISPOSAL TESTING

STATE OF MARYLAND - DEPARTMENT OF HEALTH AND MENTAL HYGIENE

DISTRICT 5th

DATE 12/14/73

HOWARD COUNTY HEALTH DEPARTMENT  
ENVIRONMENTAL HEALTH SERVICES

P. O. BOX 476, ELLICOTT CITY, MARYLAND 21043  
TELEPHONE: 465-5000, EXT. 356

*Repair*  
*12/17/73*

*12/20/73 11/3/74*  
*9:30 A.M.*

*400 134*  
*320 104*

*1-3-74.*  
*repair ← 10'x10' drywell 11 ft. deep. inlet at 3 ft.*  
*or 40' trench - 8' stone, 11 ft. deep dist. pipe at 3 ft.*

*tentative recommendations given on info received by Mr. Cecil Crenshaw subject to change if ground is not of very good type. P.F. to dig & call before anything installed*

TO: THE COUNTY HEALTH OFFICER  
ELLICOTT CITY, MARYLAND

I, HEREBY, APPLY FOR THE NECESSARY TEST IN ORDER TO CONSTRUCT (OR RECONSTRUCT) A SEWAGE DISPOSAL SYSTEM.

PROPERTY OWNER Mr. John Due

ADDRESS 6044 Trotter Road, Clarksville, Maryland PHONE 531-5486

PROPERTY LOCATION:

SUBDIVISION \_\_\_\_\_ LOT NO. \_\_\_\_\_

ROAD AND DESCRIPTION 6044 Trotter Road - big farm house - right hand side of road -  
name on mail box

SIZE OF LOT \_\_\_\_\_ TYPE BLDG. Existing house  
NUMBER OF BEDROOMS \_\_\_\_\_

IF NOT SINGLE RESIDENCE DESCRIBE \_\_\_\_\_

THE SYSTEM INSTALLED UNDER THIS APPLICATION IS ACCEPTABLE ONLY UNTIL PUBLIC FACILITIES BECOME AVAILABLE.

SIGNATURE OF APPLICANT /s/ Cecil Crenshaw

APPROVED BY \_\_\_\_\_ FOR \_\_\_\_\_ DATE \_\_\_\_\_  
(KIND OF SYSTEM)

REJECTED BY \_\_\_\_\_ FOR \_\_\_\_\_ DATE \_\_\_\_\_  
(KIND OF SYSTEM)

HOLD PENDING FURTHER TESTS \_\_\_\_\_ DATE \_\_\_\_\_

REASONS FOR REJECTION OR HOLDING \_\_\_\_\_

# THIS IS NOT A PERMIT

INDICATE NORTH. - NAME ADJOINING ROADWAY AS BASE LINE.

DATE	TEST NO.	DEPTH	PRE-WET		TEST - 1" DROP		TIME
			START	STOP	START	STOP	

REMARKS \_\_\_\_\_

TYPE OF SOIL \_\_\_\_\_

FILE Replacement Well Siting DATE REPORTED 8-16-83

PROPERTY OWNER JOHN DUE

P. O. ADDRESS 6044 TROTTER RD

DIRECTIONS TO PROPERTY \_\_\_\_\_

INFORMANT JOE MAYNE

CONDITION FOUND: EXISTING CONTAMINATED HAND DUG WELL - WILL BE  
RETAINED FOR AGRICULTURAL PURPOSES

ACTION TAKEN: APPROVED SITE SHOWN ON REVERSE.  
8-16-83 Craig Willard

FINAL DISPOSITION: \_\_\_\_\_

JOHN DUE 6044 TROTTER RD.

TROTTER RD

111

ORIGINAL SEPTIC AREA

RECENT (1981?) S.T.

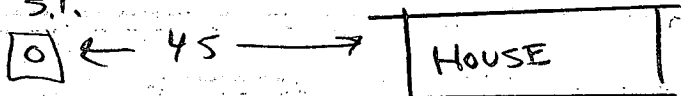

OWNER STATES 3 TRENCHES HERE - NO RECORDS AVAILABLE

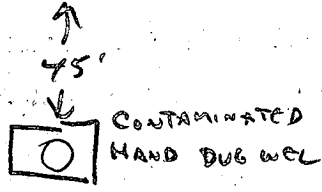

100

DRIVEWAY

90'

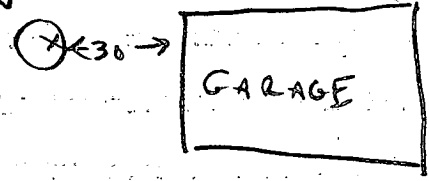

WELL SITE OK

8-16-83 Craig Williams

C1 4409

SEQUENCE NO. (OEP USE ONLY)

STATE OF MARYLAND WELL COMPLETION REPORT

THIS REPORT MUST BE SUBMITTED WITHIN 45 DAYS AFTER WELL IS COMPLETED.

(THIS NUMBER IS TO BE PUNCHED IN COLS. 3-6 ON ALL CARDS)

COUNTY NUMBER: P194082

DATE RECEIVED

DATE WELL COMPLETED

Depth of Well

PERMIT NO. FROM "PERMIT TO DRILL WELL"

DATE RECEIVED grid

DATE WELL COMPLETED: 08/19/83

Depth of Well: 163 (TO NEAREST FOOT)

PERMIT NO.: HO-81-0231

OWNER: Due (last name), John (first name) STREET OR RFD: 3044 Trotter Road TOWN: Clarksville

SUBDIVISION: tax map 35, parcel 23 SECTION: LOT:

WELL LOG Not required for driven wells STATE THE KIND OF FORMATIONS PENETRATED, THEIR COLOR, DEPTH, THICKNESS AND IF WATER BEARING

Table with columns: DESCRIPTION (Use additional sheets if needed), FEET (FROM, TO), Check if water bearing. Includes handwritten entries: Brown Shale 0-57, Coarse granite 57-163.

GROUTING RECORD WELL HAS BEEN GROUTED (Y/N) TYPE OF GROUTING MATERIAL CEMENT (CM), BENTONITE CLAY (BC) NO. OF BAGS 13, NO. OF POUNDS 1220

CASING RECORD casing types insert appropriate code below MAIN CASING TYPE PL, Nominal diameter 6, Total depth of main casing 61

OTHER CASING (if used) diameter inch, depth (feet) from to

SCREEN RECORD screen type or open hole insert appropriate code below STEEL (ST), BRASS (BR), OPEN HOLE (HO)

DEPTH (nearest ft.) grid showing H0, 60, 163

A A WELL WAS ABANDONED AND SEALED WHEN THIS WELL WAS COMPLETED E ELECTRIC LOG OBTAINED P TEST WELL CONVERTED TO PRODUCTION WELL

I HEREBY CERTIFY THAT THIS WELL HAS BEEN CONSTRUCTED IN ACCORDANCE WITH COMAR 10.17.13 "WELL CONSTRUCTION"

DRILLERS IDENT. NO. 238

DRILLERS SIGNATURE (MUST MATCH SIGNATURE ON APPLICATION)

SITE SUPERVISOR (sign. of driller or journeyman responsible for sitework if different from permittee)

GRAVEL PACK IF WELL DRILLED WAS FLOWING WELL INSERT F IN BOX 68

OEP USE ONLY (NOT TO BE FILLED IN BY DRILLER) T (E.R.O.S.), WQ

PUMPING TEST HOURS PUMPED (nearest hour) 5 PUMPING RATE (gal. per min. to nearest gal.) 12 METHOD USED TO MEASURE PUMPING RATE bucket

TYPE OF PUMP USED (for test) A air, C centrifugal, J jet, P piston, R rotary, S submersible, T turbine, O other

LOCATION OF WELL ON LOT SHOW PERMANENT STRUCTURE SUCH AS BUILDING, SEPTIC TANKS, AND/OR LANDMARKS AND INDICATE NOT LESS THAN TWO DISTANCES (MEASUREMENTS TO WELL)

