

# PERMIT

SEWAGE DISPOSAL SYSTEM

MARYLAND STATE DEPARTMENT OF HEALTH

HOWARD COUNTY

ELLICOTT CITY

DISTRICT 4th

DATE 11/3/72

## INDEXED

## INDEXED

04-316274

William Hopkins

IS PERMITTED TO INSTALL 2" ALTER

ADDRESS Jennings Chapel Road, Woodbine, Maryland

PHONE 489-4711

A SEWAGE DISPOSAL SYSTEM LOCATED AT \_\_\_\_\_

SUBDIVISION Sunset Acres

ROAD 977 Woodbine Road

LOT 3

PROPERTY OWNER Roger F. Janner & wife Charles + Barbara Cepines

ADDRESS Route 1, Woodbine, Maryland 21797 Charles M. Sharpe

SPECIFICATIONS 3 bedrooms

DRAIN FIELD \_\_\_\_\_ DEPTH \_\_\_\_\_ FEET. BOTTOM AREA \_\_\_\_\_ SQ. FT.

SEEPAGE PITS \_\_\_\_\_ ABSORBENT SIDE-WALL AREA \_\_\_\_\_ SQ. FT.

SEPTIC TANK CAPACITY 1000 GALLONS

FOR GARBAGE GRINDER, INCREASE DISPOSAL AREA 22% & TANK CAPACITY 50%.

OTHER DRY WELL - 112 sq. ft. absorbent sidewall area per bedroom to begin below the first 64 ft. of non-absorbent ground. Maximum depth permitted for dry well is 13 ft. below original grade. 3 ft. manhole clearance to grade. Place dry well 45 ft. from front lot line and 80 ft. from left side line as seen when facing from Woodbine Road.

NOTE: ALL PIPE FROM HOUSE TO SEPTIC TANK MUST BE CAST IRON.

PERMIT VOID AFTER THREE YEARS.

NOTE: INSTALL STAND PIPE ON SEPTIC TANK AND DRY WELL.

PLANS APPROVED BY Donald W. Monaghan

DATE 1/4/72

FILL SEPTIC TANK AND DISTRIBUTION BOX WITH WATER BEFORE CALLING FOR AN INSPECTION. COVER NO WORK UNTIL INSPECTED AND APPROVED.

NEITHER THE HOWARD COUNTY COMMISSIONERS NOR THE HEALTH DEPARTMENT IS RESPONSIBLE FOR THE SUCCESSFUL OPERATION OF ANY SYSTEM.

OLD PERMIT SIGNED

AND RETURNED 9-18-97

Serial # B01107938

I can attached

gases

DATE PAID IN FULL

AND RETURNED 9/11/88

Serial # 16216

include notes

FOR DEPOSIT ONLY

HOWARD COUNTY DEPARTMENT OF HEALTH

ELLICOTT CITY, MARYLAND

11/3/72

216127

A 48538-B

12/2/72  
Roger J. Bittelok  
aw

1/9/73

97 1-8-77  
aw 17631  
48538-B  
26127

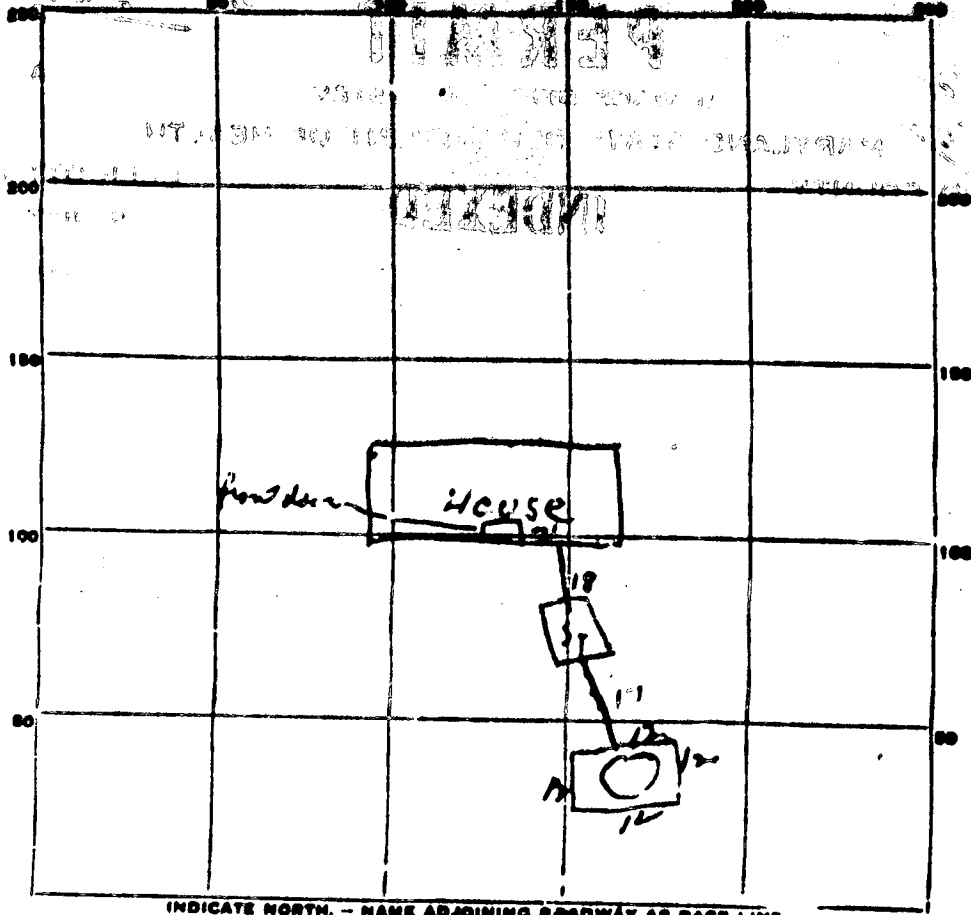

INDICATE NORTH. - NAME ADJOINING ROADWAY AS BASE LINE.

*Woodlawn Rd*

PERMIT CARD *not made*

SEPTIC TANK, LEVEL *OK*

CLEANOUTS *OK*

DISTRIBUTION BOX, LEVEL \_\_\_\_\_

TILE FIELD, DEPTH \_\_\_\_\_ FT. TRENCH WIDTH \_\_\_\_\_ FT.

GRAVEL DEPTH \_\_\_\_\_ IN. TOTAL LENGTH \_\_\_\_\_ FT.

NUMBER OF TRENCHES \_\_\_\_\_ TOTAL BOTTOM AREA \_\_\_\_\_

SEEPAGE PITS, INSIDE DIAMETER *Permits 48* FT. DEPTH BELOW INLET *7* FT.

ABSORBENT AREA *336* SQ. FT.

REMARKS \_\_\_\_\_  
 \_\_\_\_\_  
 \_\_\_\_\_  
 \_\_\_\_\_  
 \_\_\_\_\_

DATE SYSTEM APPROVED *1-8-73*

INSPECTOR *De Mangel*

1812.A

APPROXIMATE

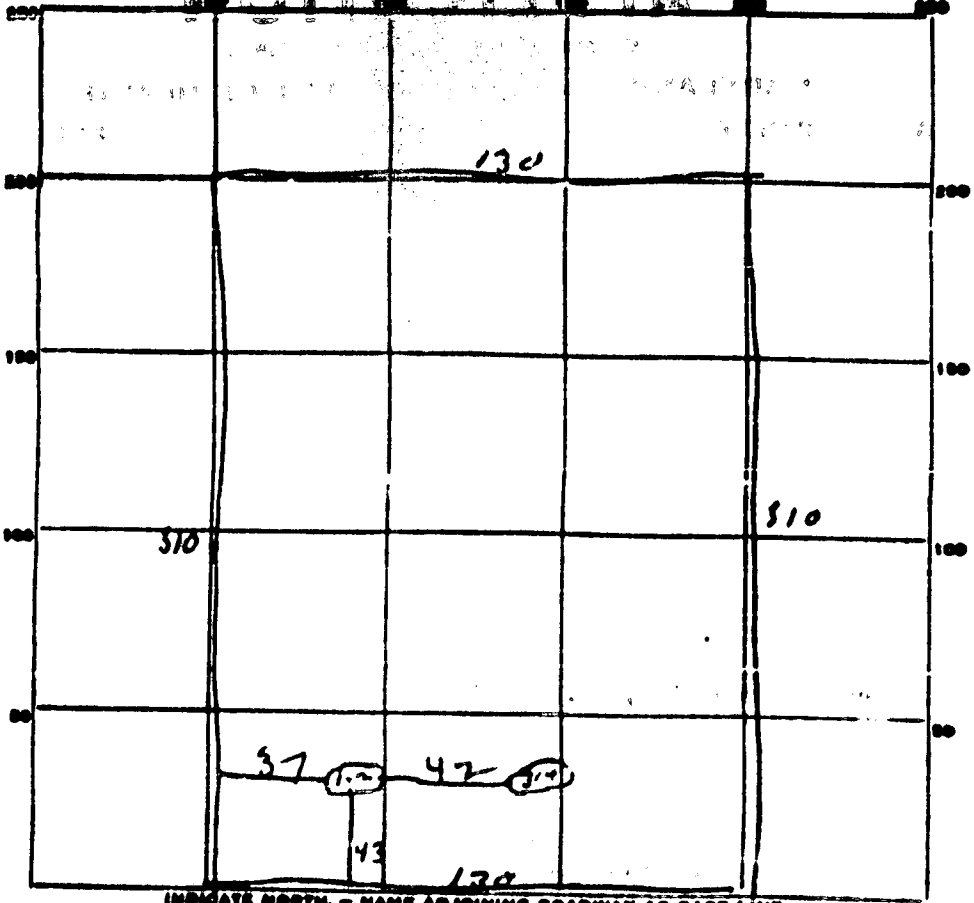

INDICATE NORTH - NAME ADJOINING ROADWAY AS BASE LINE.

*Woodlawn Rd.*

DATE	TEST NO.	DEPTH	PRE-WET		TEST - 1" DROP		TIME
			START	STOP	START	STOP	
7/27/77	1	6 1/2	10 07	10 12	10 17	10 30	13 min
	2	10 1/2	10 07	10 19	10 10	10 17	7 min
	3	10 1/2	10 10	10 14	10 14	10 21	7 min
	4	6 1/2	10 12	10 16	10 16	10 25	9 min

113

SOIL AUGER FINDING \_\_\_\_\_

TESTED BY \_\_\_\_\_

REMARKS \_\_\_\_\_



CHARLES M. SHARPE  
979 Old Woodbine Road

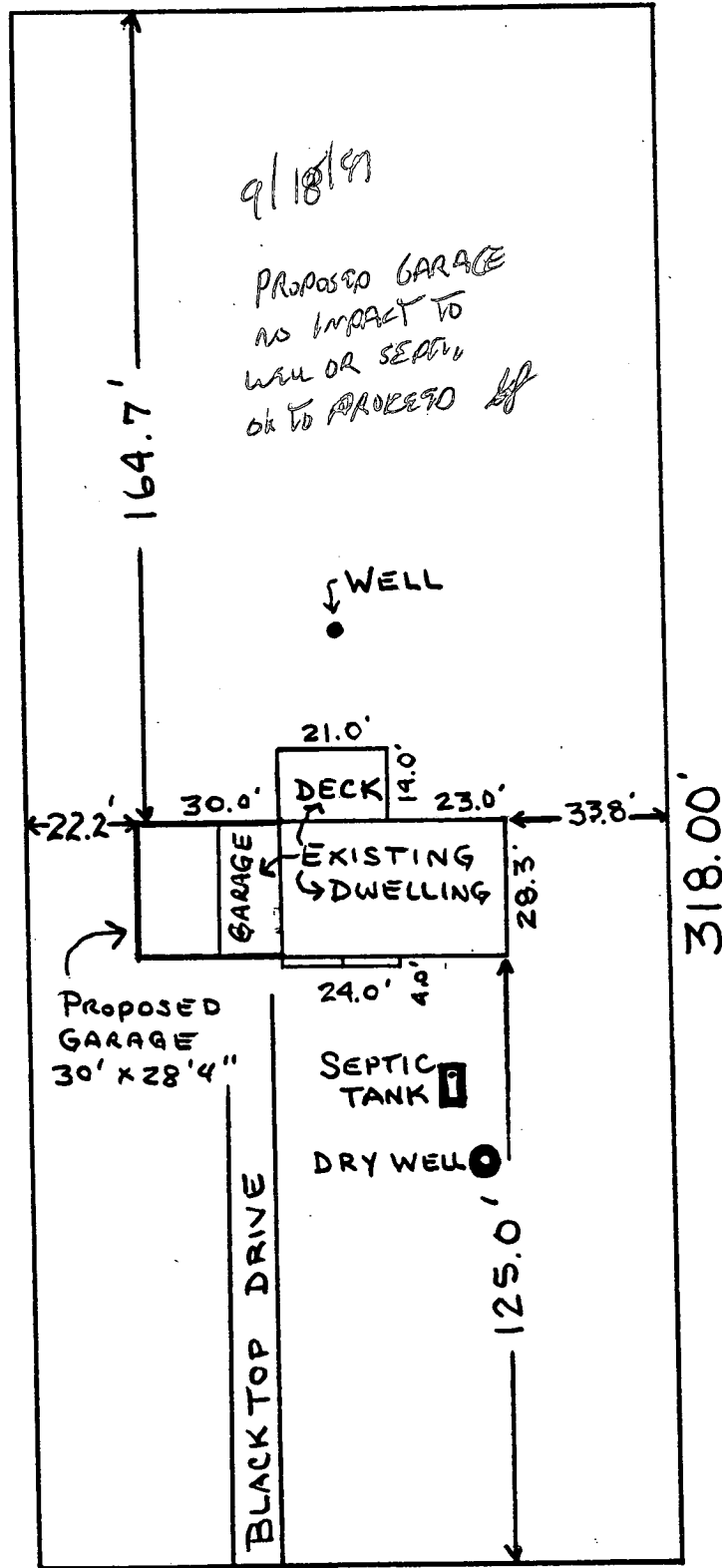

OLD WOODBINE ROAD