

4/29/86
4:00 pm

5/1/86
pm

TO BE
Rescheduled
FOR NEXT WEEK

approved 5/14/86

Stayer

P 316836

PERMIT

SEWAGE DISPOSAL SYSTEM

A REPAIR

MARYLAND STATE DEPARTMENT OF HEALTH

HOWARD COUNTY
BUREAU OF ENVIRONMENTAL HEALTH
X992-2330X
461-9933

05-364604

ELLICOTT CITY
DISTRICT _____
DATE 4/21/86

Rhodes' Sons IS PERMITTED TO INSTALL _____ ALTER X

ADDRESS _____ PHONE 531-3503

SUBDIVISION _____ ROAD 5857 Trotter Road LOT _____

PROPERTY OWNER Mary Lucille Rhodes

ADDRESS _____

IF GARBAGE GRINDER IS USED INCREASE SEPTIC TANK CAPACITY BY 50% AND ABSORPTION AREA BY 22%.

GARBAGE GRINDER? YES _____ NO _____

SEPTIC TANK CAPACITY _____ GALLONS NUMBER OF BEDROOMS _____

REPAIR - CALL FOR INSPECTION WHEN GROUND IS OPENED UP SO SANITARIAN CAN RECOMMEND

REPAIR.

Will dig visual hole - 13'-14' deep - if no sign of water

① dig 2 (two) trenches 9' deep, with 6' of stone - 100' total

② If water found back off 4' - dig 2 (two) trenches 3' wide. Dist. box needed in system.

Will call for inspection when visual dig is done. 4/29/86

PLANS APPROVED BY C. Williams DATE 4/21/86

COVER NO WORK UNTIL INSPECTED AND APPROVED.

NEITHER THE HOWARD COUNTY COUNCIL NOR THE HEALTH DEPARTMENT IS RESPONSIBLE FOR THE SUCCESSFUL OPERATION OF ANY SYSTEM.

NOTE: IF TRENCH IS USED CALL FOR INSPECTION BEFORE AND AFTER PLACING GRAVEL IN TRENCH.

NOTE: NO DRY WELL SHALL EXCEED 15 FOOT IN DIAMETER. NO ABSORPTION TRENCH TO EXCEED 100 FEET IN LENGTH.

NOTE: ALL PIPE FROM HOUSE TO SEPTIC TANK MUST BE CAST IRON OR SCHEDULE 40 PVC OR ABS.

PERMIT VOID AFTER THREE YEARS.

NOTE: INSTALL STAND PIPE ON SEPTIC TANK AND DRY WELL. STAND PIPES MUST BE 6 INCHES IN DIAMETER. CAST IRON, CONCRETE OR TERRA COTTA, OR PVC OR ABS ACCEPTED. IF TOP OF SEPTIC TANK IS DEEPER THAN 3 FEET MANHOLE TO GRADE REQUIRED.

***INSTALLER IS RESPONSIBLE FOR OBTAINING FINAL APPROVAL ON THIS PERMIT**

*CALL 992-2330 FOR INSPECTION OF SEPTIC SYSTEMS.

EH - 2-1082

A
REPAIR
36836

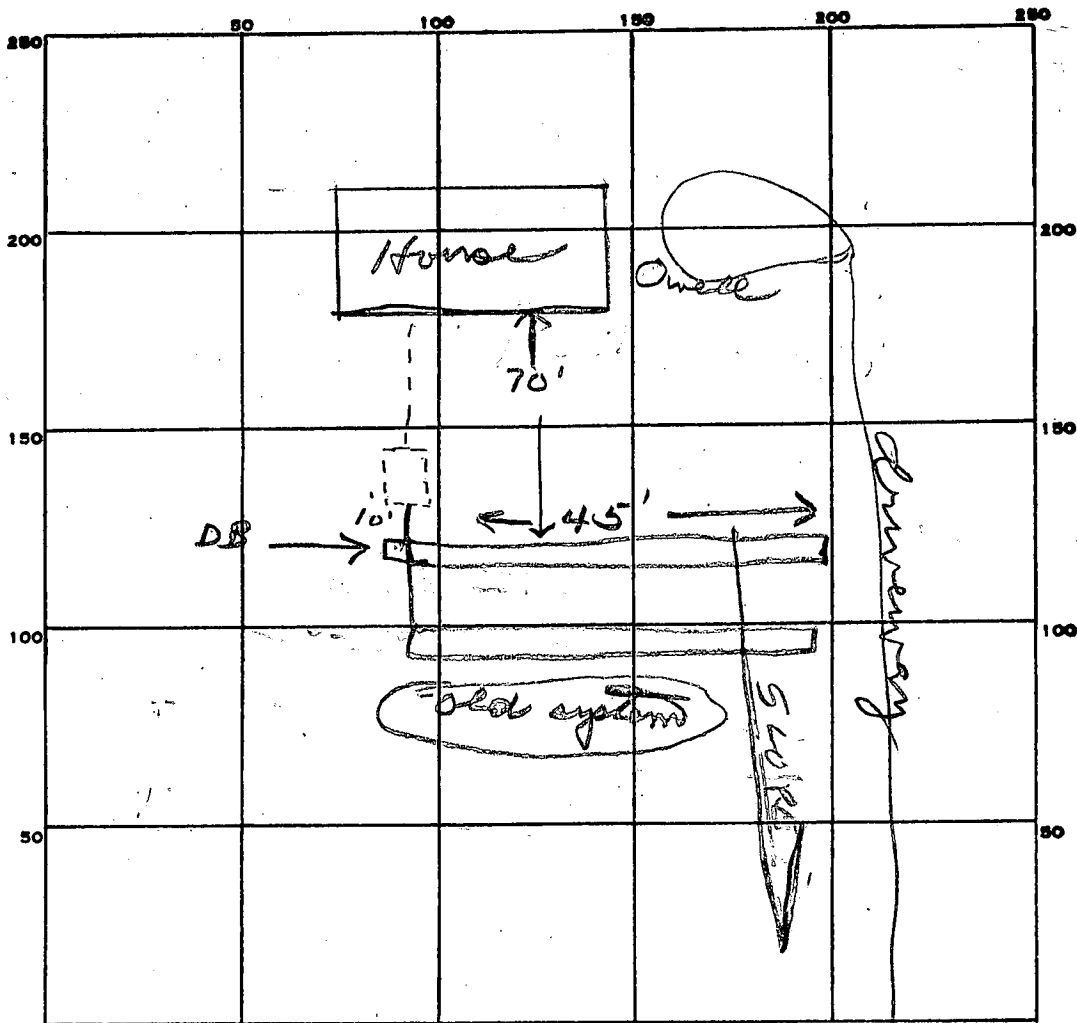

INDICATE NORTH. - NAME ADJOINING ROADWAY AS BASE LINE.

Trotter Rd

PERMIT CARD _____

SEPTIC TANK, LEVEL _____

CLEANOUTS _____

DISTRIBUTION BOX, LEVEL

TILE FIELD, DEPTH 9 FT. TRENCH WIDTH 2 FT.

GRAVEL DEPTH 6 IN. TOTAL LENGTH 90 FT.

NUMBER OF TRENCHES 2 TOTAL BOTTOM AREA 540

SEEPAGE PITS, INSIDE DIAMETER _____ FT. DEPTH BELOW INLET _____ FT.

ABSORBENT AREA 540 SQ. FT.

REMARKS 5/13/86 OK to add stone in trenches JS
5/14/86 OK to cover work JS

DATE SYSTEM APPROVED 5/14/86

INSPECTOR Stays

36836



HOWARD COUNTY HEALTH DEPARTMENT

Joyce M. Boyd, M.D., County Health Officer

October 18, 1991

Reply to:

MEMORANDUM

TO: Don Lieu, Chief
Utility Design Division
Bureau of Engineering

FROM: Craig Williams, Program Director CW
Water and Sewerage Program
Bureau of Environmental Health
Howard County Health Department

RE: Mary Rhodes
5857 Trotter Road
Clarksville, Maryland 21029

The well on the above referenced property was inspected October 9, 1991 and it was determined to have insufficient water flow and storage to provide reasonable service to the existing household. Water is currently being obtained from a temporary connection to a neighbor's property.

Emergency incorporation into the Metropolitan Service District is recommended.

CW:jr

cc: Tine D. Hackett
Mary Rhodes
File ✓



Howard County

Internal Memorandum

313-2070

October 2, 1991

MEMO TO: Craig Williams, Director
Water and Sewerage Program
Howard County Health Department

FROM: Don Lieu, Chief **ODL**
Utility Design Division
Bureau of Engineering

SUBJECT: Request for Well Test
5857 Trotter Road

We wish to request a test of the well located at 5857 Trotter Road, Clarksville, Maryland.

We have received a request from Ms. Mary Rhodes asking for an emergency incorporation of her property into the Metropolitan District due to a failed well. We will be presenting her petition for entry into the District to the Public Works Board on October 8, 1991, contingent on the recommendation of the Health Department. Your earliest response to this request would be greatly appreciated.

Should you have any questions concerning this request, please do not hesitate to contact me at 313-2070.

DL/a Attachment
cc: Tina D. Hackett
Mary Rhodes

Written statement from plumber. Hand dug well w/ 18 inches of water now. Recommend emergency inclusion into Metro District.

11:00 THURS. OCT 9

HOWE RESEARCH
992-6084

HUGH OSTRICK
NOTIFIED

SITE INSPECTION SHEET

OWNER: Mary Rhodes

DATE REQUESTED: 10-9-91

PHONE #: 531-3503

CONTRACTOR: _____

ADDRESS: 5857 Trotter Road
Clarksville, MD 21029

WELL TAG #: None - Hand dug

COUNTY #: _____

PROPOSAL: No water since Sunday, 10-6-91. Pump running all the time with no water coming in. Brown iron stains at about 15 feet below the ground. Depth of well is 26 ft 10 inches deep. Mr. Oesterreicher - developer on site (Rouse Company)

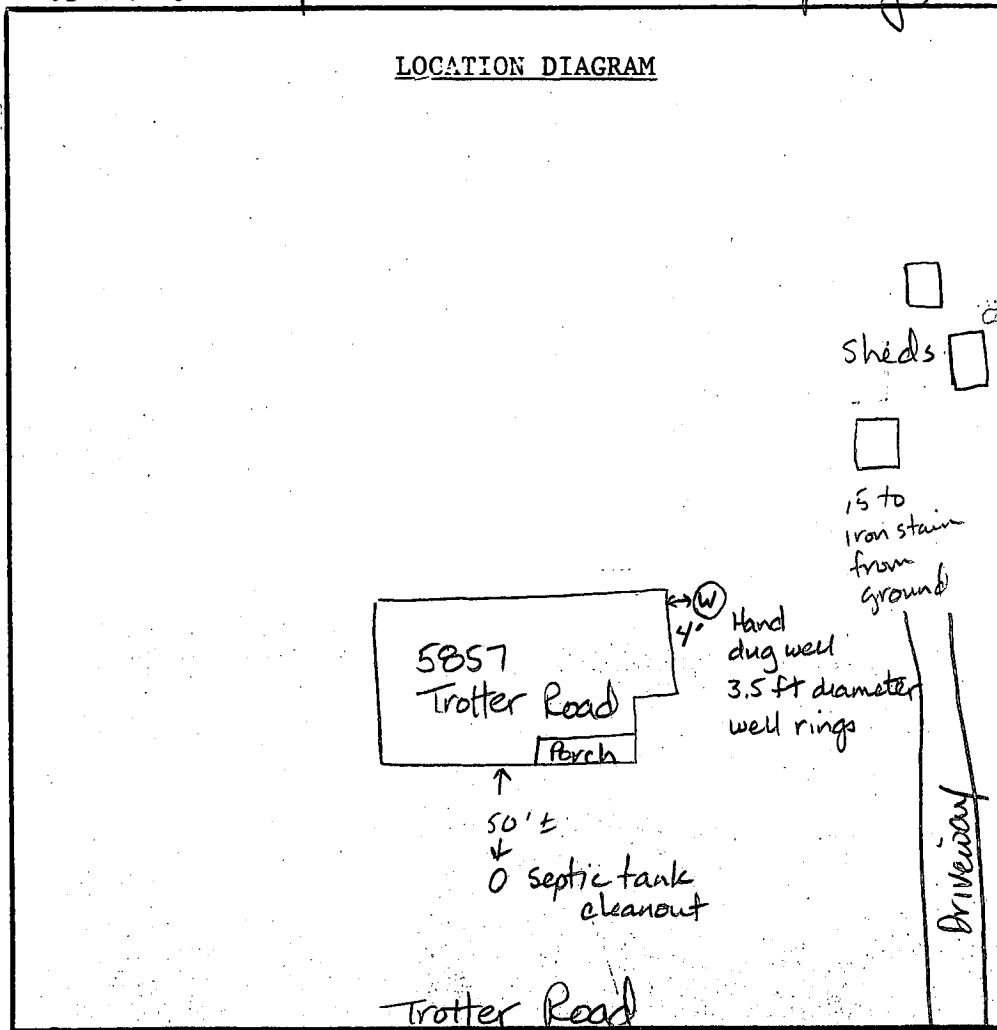

COMMENTS: 10-9-91 Measured water level at 24 feet 3 inches below ground surface with 31 inches of water in well today. Concrete well rings line well to bottom. Pump and 2 plastic lines in place. Recommend inclusion into Metropolitan District, EN

DATE: 10-9-91

INSPECTOR: Jane E. Nadeau