

127 420

6/19/85
AM before Noon
No snow.

PERMIT INDEXED

P 35657
A REPAIR

SEWAGE DISPOSAL SYSTEM

MARYLAND STATE DEPARTMENT OF HEALTH

HOWARD COUNTY
BUREAU OF ENVIRONMENTAL HEALTH
992-2330

05-343348

ELLICOTT CITY
DISTRICT _____

PURPOSE OF REPAIR -
TO STOP BACK UP IN BASEMENT

DATE 6/18/85

Jack Fyock IS PERMITTED TO INSTALL ALTER

ADDRESS _____ PHONE 988-9270

SUBDIVISION HERITAGE HEIGHTS ROAD 6107 Tulane Drive LOT ?

PROPERTY OWNER Howard Beacraft

ADDRESS _____

IF GARBAGE GRINDER IS USED INCREASE SEPTIC TANK CAPACITY BY 50% AND ABSORPTION AREA BY 22%.

GARBAGE GRINDER? YES _____ NO

SEPTIC TANK CAPACITY _____ GALLONS NUMBER OF BEDROOMS 3

REPAIR - CALL FOR INSPECTION WHEN GROUND IS OPENED UP SO SANITARIAN CAN RECOMMEND REPAIR.

TRENCH 12 FT DEEP 7 FT
STONE 360 SPT
AREA NEEDED (ONLY SMALL
SYSTEM NEEDED BECAUSE WASH
WATER GOES TO OTHER SYSTEM)
RUN TRENCH OFF TANK TOWARD
BACK LINE 6/19/85 BH

PLANS APPROVED BY C. Williams DATE 6/18/85

COVER NO WORK UNTIL INSPECTED AND APPROVED.

NEITHER THE HOWARD COUNTY COUNCIL NOR THE HEALTH DEPARTMENT IS RESPONSIBLE FOR THE SUCCESSFUL OPERATION OF ANY SYSTEM.

NOTE: IF TRENCH IS USED CALL FOR INSPECTION BEFORE AND AFTER PLACING GRAVEL IN TRENCH.

NOTE: NO DRY WELL SHALL EXCEED 15 FOOT IN DIAMETER. NO ABSORPTION TRENCH TO EXCEED 100 FEET IN LENGTH.

NOTE: ALL PIPE FROM HOUSE TO SEPTIC TANK MUST BE CAST IRON OR SCHEDULE 40 PVC OR ABS.

PERMIT VOID AFTER THREE YEARS.

NOTE: INSTALL STAND PIPE ON SEPTIC TANK AND DRY WELL. STAND PIPES MUST BE 6 INCHES IN DIAMETER. CAST IRON, CONCRETE OR TERRA COTTA. OR PVC OR ABS ACCEPTED. IF TOP OF SEPTIC TANK IS DEEPER THAN 3 FEET MANHOLE TO GRADE REQUIRED.

***INSTALLER IS RESPONSIBLE FOR OBTAINING FINAL APPROVAL ON THIS PERMIT**

*CALL 992-2330 FOR INSPECTION OF SEPTIC SYSTEMS.

EH - 2-1082

P 35-6571

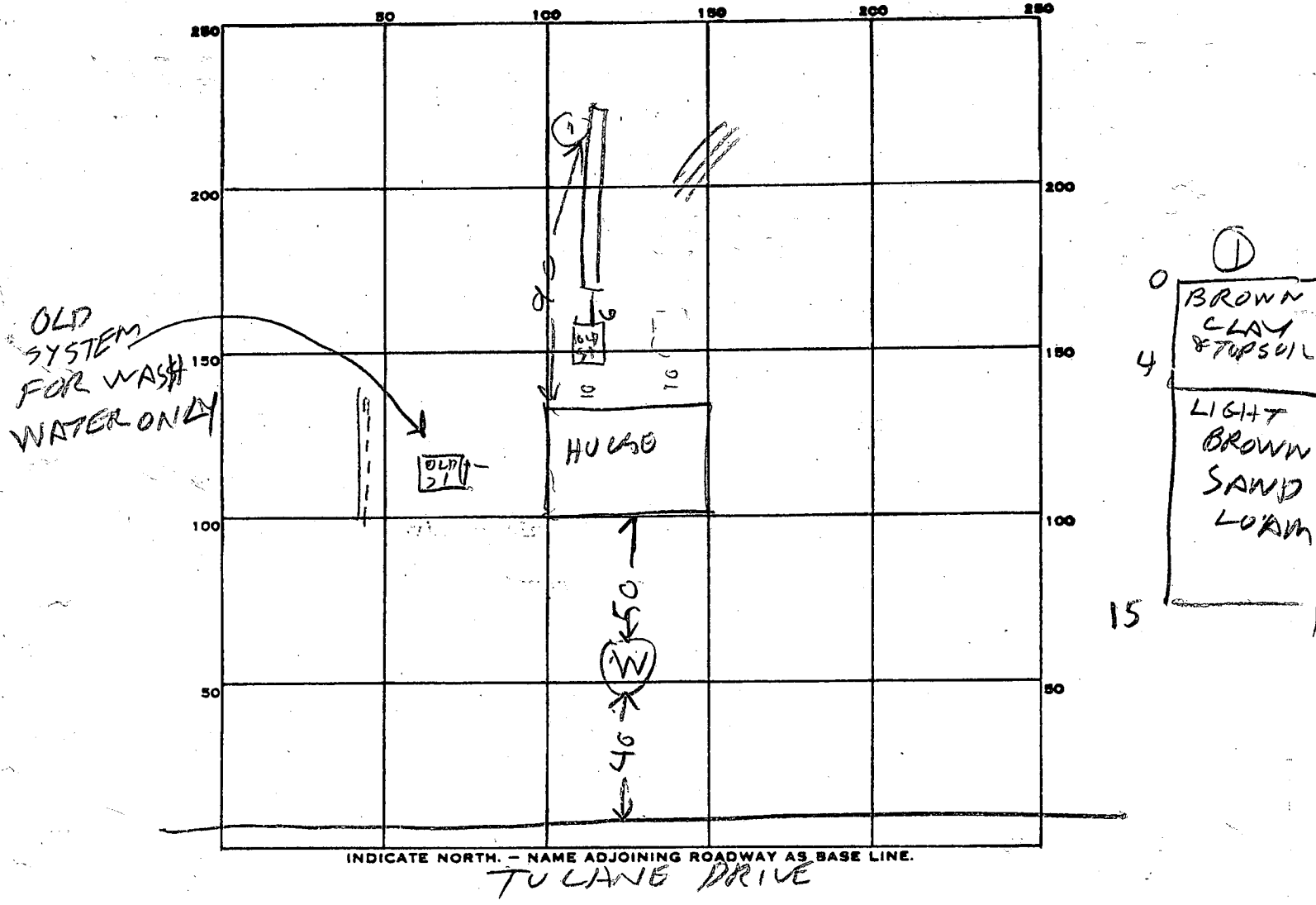

PERMIT CARD _____

SEPTIC TANK, LEVEL _____ CLEANOUTS _____

DISTRIBUTION BOX, LEVEL _____

TILE FIELD, DEPTH 12 FT. TRENCH WIDTH 2 FT.

GRAVEL DEPTH 7 FT IN. TOTAL LENGTH 61 FT.

NUMBER OF TRENCHES 1 TOTAL BOTTOM AREA 427

SEEPAGE PITS, INSIDE DIAMETER _____ FT. DEPTH BELOW INLET _____ FT.

ABSORBENT AREA _____ SQ. FT.

REMARKS 6/19/85 1030 VISUAL HOLE OK & PART OF DITCH DUG
HOUSE HAS TWO SYSTEMS; ONE FOR WASH WATER & ONE
FOR REST OF WAST WATER; DITCH DUG & SOME STONE
ADDED

6/19/85 1100 - REST OF STONE ADDED

DATE SYSTEM APPROVED 6/19/85 INSPECTOR B. Hodges