

approved 7/18/86 CW

# PERMIT

P 34757

A Repair

SEWAGE DISPOSAL SYSTEM

MARYLAND STATE DEPARTMENT OF HEALTH\*

HOWARD COUNTY  
BUREAU OF ENVIRONMENTAL HEALTH  
~~882-2330XX~~  
461-9933

05-373220

ELLICOTT CITY  
DISTRICT 5th

INDEXED

DATE 7/18/86

Jack Fyock IS PERMITTED TO INSTALL \_\_\_\_\_ ALTER

ADDRESS \_\_\_\_\_ PHONE 988-9270

SUBDIVISION \_\_\_\_\_ ROAD 6126 Tulane Drive LOT \_\_\_\_\_

PROPERTY OWNER Shah  
6126 Tulane Drive

ADDRESS \_\_\_\_\_

IF GARBAGE GRINDER IS USED INCREASE SEPTIC TANK CAPACITY BY 50% AND ABSORPTION AREA BY 22%.

GARBAGE GRINDER? YES \_\_\_\_\_ NO \_\_\_\_\_

SEPTIC TANK CAPACITY \_\_\_\_\_ GALLONS NUMBER OF BEDROOMS \_\_\_\_\_

**SHALLOW SYSTEM REQUIRED.**

Install 500 gallons pump pit and 1/2 H.P. effluent pump or replumb house sewer and install new 1000 gallons septic tank at higher elevation.

Minimum requirement: 2-90' trenches Trench to be 3 feet wide. Inlet 2 feet below original grade. Bottom maximum depth 3 1/2 feet below original grade. 1 1/2 feet of stone below distribution pipe. Additional trench <sup>RECOMMENDED</sup> as site permits.

Location: Parallel to rear lot line as seen when facing property from Tulane Drive.

ok/cw

PLANS APPROVED BY C. Williams DATE 7/18/86

COVER NO WORK UNTIL INSPECTED AND APPROVED.

NEITHER THE HOWARD COUNTY COUNCIL NOR THE HEALTH DEPARTMENT IS RESPONSIBLE FOR THE SUCCESSFUL OPERATION OF ANY SYSTEM.

NOTE: IF TRENCH IS USED CALL FOR INSPECTION BEFORE AND AFTER PLACING GRAVEL IN TRENCH.

NOTE: NO DRY WELL SHALL EXCEED 15 FOOT IN DIAMETER. NO ABSORPTION TRENCH TO EXCEED 100 FEET IN LENGTH.

NOTE: ALL PIPE FROM HOUSE TO SEPTIC TANK MUST BE CAST IRON OR SCHEDULE 40 PVC OR ABS.

PERMIT VOID AFTER THREE YEARS.

NOTE: INSTALL STAND PIPE ON SEPTIC TANK AND DRY WELL. STAND PIPES MUST BE 6 INCHES IN DIAMETER. CAST IRON, CONCRETE OR TERRA COTTA, OR PVC OR ABS ACCEPTED. IF TOP OF SEPTIC TANK IS DEEPER THAN 3 FEET MANHOLE TO GRADE REQUIRED.

**\*INSTALLER IS RESPONSIBLE FOR OBTAINING FINAL APROVAL ON THIS PERMIT**

\*CALL 992-2330 FOR INSPECTION OF SEPTIC SYSTEMS.

EH - 2-1082

834757  
A REPAIR

P34757  
Repair

X X X X X FENCE X X X X

6126 Tulane Drive

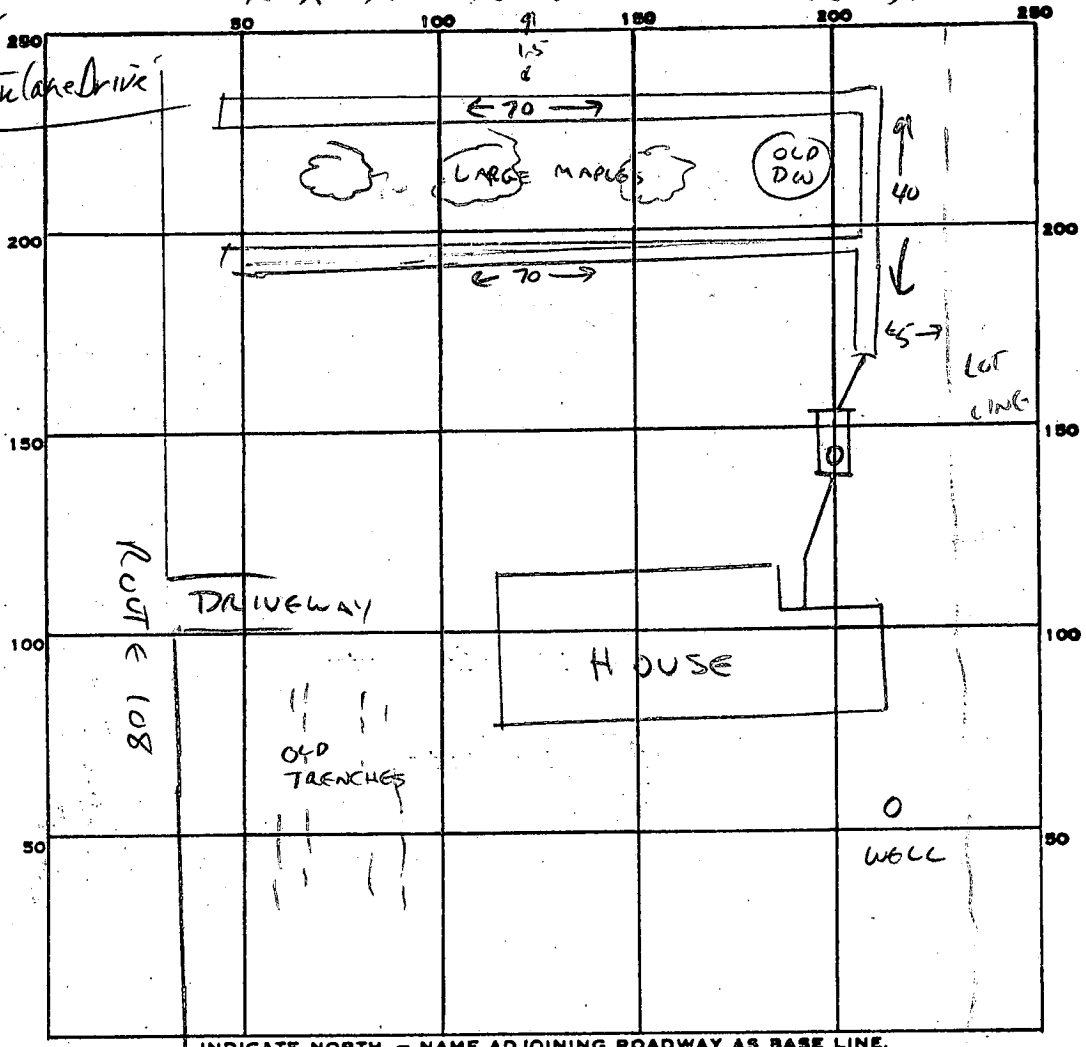

INDICATE NORTH. - NAME ADJOINING ROADWAY AS BASE LINE.

TULANE DR

PERMIT CARD

SEPTIC TANK, LEVEL

CLEANOUTS STU

DISTRIBUTION BOX, LEVEL N/A

TILE FIELD, DEPTH 4 FT. TRENCH WIDTH 3 FT.

GRAVEL DEPTH 1 FT IN. TOTAL LENGTH 180 FT.

NUMBER OF TRENCHES \_\_\_\_\_ TOTAL BOTTOM AREA \_\_\_\_\_

SEEPAGE PITS, INSIDE DIAMETER \_\_\_\_\_ FT. DEPTH BELOW INLET \_\_\_\_\_ FT.

ABSORBENT AREA \_\_\_\_\_ SQ. FT.

REMARKS OK TO FINISH GRAVEL IN TRENCHES & COVER. 7/21/86 CW

DATE SYSTEM APPROVED 7/21/86

INSPECTOR Craig W. Miller

REGION \_\_\_\_\_

AREA \_\_\_\_\_ RATING \_\_\_\_\_

ACKNOWLEDGMENT AND CONTROLS	DATE

Howard County Department of Health  
BUREAU OF ENVIRONMENTAL HEALTH

RECORD OF INVESTIGATION

DISPOSITION	DATE

LOCATION NW cor of Tulane Dr + Guilford Rd ZIP \_\_\_\_\_

OWNER  McLaughlin ADDRESS 6126 Tulane Dr PHONE \_\_\_\_\_  
 OCCUPANT  \_\_\_\_\_

COMPLAINANT Nancy/Wm. Hill ADDRESS 6215 Guilford Rd PHONE 531-2286

REASON FOR INVESTIGATION water flowing down street from corner house for extended period (weeks/months); water has at various times appeared brown, green & odorous CODES \_\_\_\_\_

RECEIVED BY M-Riffin DATE 5/14 ASSIGNED TO M-Rc DATE 5/14

DATE OF INVESTIGATION 5/14/98 TIME 3:00± WEATHER clear, warm

REPORT 5/14/98 MET COMPLAINANTS, OBS'D DISCHARGE; H<sub>2</sub>O CLEAR w/SOME ALGAE; APPEARS TO BE GROUND H<sub>2</sub>O DUE TO RECENT HEAVY RAINS, NO SEWAGE OBS'D; NEIGHBOR TO 6126 REPORTS RECENT INSTALLATION <sup>BY HATFIELD</sup> OF CURTAIN DRAIN FOR STORM FLOW OFF OF THOMPSON DR; BASED ON SEPTIC DIAGRAM OF 6126, CURTAIN DRAIN APPEARS TO BE CROSSING SEPTIC DRAINFIELD INSTALLED IN 1986

LATE ADD'N: NO INFO RE "Co. PERMIT REQUIREMENTS OR ACTIONS OF HATFIELD IN DRAIN INSTALLATION  
 FILE CLOSED MR 1/23/03

DATE SUBMITTED \_\_\_\_\_ SANITARIAN \_\_\_\_\_

SITE INSPECTION SHEET

OWNER: \_\_\_\_\_

DATE REQUESTED: \_\_\_\_\_

PHONE #: \_\_\_\_\_

CONTRACTOR: \_\_\_\_\_

ADDRESS: \_\_\_\_\_

WELL TAG #: \_\_\_\_\_

COUNTY #: \_\_\_\_\_

PROPOSAL: suspected ~~flowing~~ flowing H<sub>2</sub>O is sewage

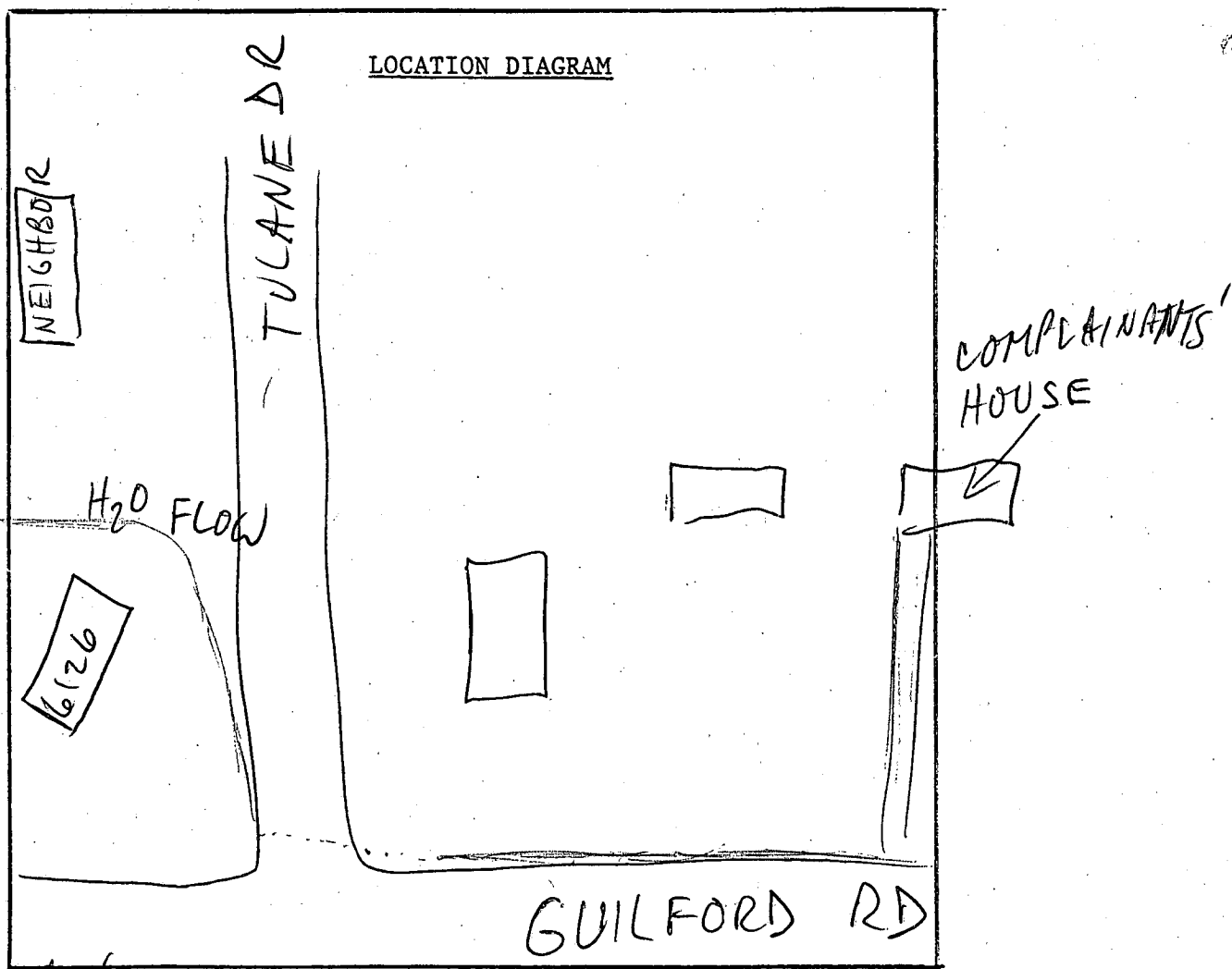

COMMENTS: 5/14/98 SEE ATTACHED COMPLAINT SHEET

DATE: \_\_\_\_\_

INSPECTOR: \_\_\_\_\_

# PERMIT

P 34757

A REPAIR

## SEWAGE DISPOSAL SYSTEM

### MARYLAND STATE DEPARTMENT OF HEALTH

HOWARD COUNTY  
BUREAU OF ENVIRONMENTAL HEALTH  
992-2330

ELLCOTT CITY  
DISTRICT 5th

INDEXED

DATE 1/8/85

Bud Arnold IS PERMITTED TO INSTALL \_\_\_\_\_ ALTER X

ADDRESS Woodbine, Maryland 21797 PHONE 795-1285

SUBDIVISION \_\_\_\_\_ ROAD 6126 Tulane Drive LOT \_\_\_\_\_

PROPERTY OWNER Ashfao Hussain Shah PHONE: 531-3084  
6126 Tulane Drive

ADDRESS \_\_\_\_\_

IF GARBAGE GRINDER IS USED INCREASE SEPTIC TANK CAPACITY BY 50% AND ABSORPTION AREA BY 22%.

GARBAGE GRINDER? YES \_\_\_\_\_ NO \_\_\_\_\_

SEPTIC TANK CAPACITY \_\_\_\_\_ GALLONS NUMBER OF BEDROOMS \_\_\_\_\_

- REPAIR (1) Use Existing Septic Tank
- (2) Add 500 gal. minimum pump pit with sump pump  
Drill 1/2" weep hole in the effluent line after the pump.
- (3) Pump to two leaching beds - each 8' x 50' (800 sq. ft. total bottom area)  
Each bed to have two perforated supply lines  
No distribution box required - "t's" OK
- (4) Leaching beds connect to common drain line which overflows to 1500 gal.  
holding tank with high water alarm device.  
(Electric Alarm or flag/float mechanism OK)

PLANS APPROVED BY Craig Williams DATE 1/8/85

COVER NO WORK UNTIL INSPECTED AND APPROVED.

NEITHER THE HOWARD COUNTY COUNCIL NOR THE HEALTH DEPARTMENT IS RESPONSIBLE FOR THE SUCCESSFUL OPERATION OF ANY SYSTEM.

NOTE: IF TRENCH IS USED CALL FOR INSPECTION BEFORE AND AFTER PLACING GRAVEL IN TRENCH.

NOTE: NO DRY WELL SHALL EXCEED 15 FOOT IN DIAMETER. NO ABSORPTION TRENCH TO EXCEED 100 FEET IN LENGTH.

NOTE: ALL PIPE FROM HOUSE TO SEPTIC TANK MUST BE CAST IRON OR SCHEDULE 40 PVC OR ABS.

PERMIT VOID AFTER THREE YEARS.

NOTE: INSTALL STAND PIPE ON SEPTIC TANK AND DRY WELL. STAND PIPES MUST BE 6 INCHES IN DIAMETER. CAST IRON, CONCRETE OR TERRA COTTA, OR PVC OR ABS ACCEPTED. IF TOP OF SEPTIC TANK IS DEEPER THAN 3 FEET MANHOLE TO GRADE REQUIRED.

**\*INSTALLER IS RESPONSIBLE FOR OBTAINING FINAL APPROVAL ON THIS PERMIT**

\*CALL 992-2330 FOR INSPECTION OF SEPTIC SYSTEMS.

EH - 2-1082

P 34757

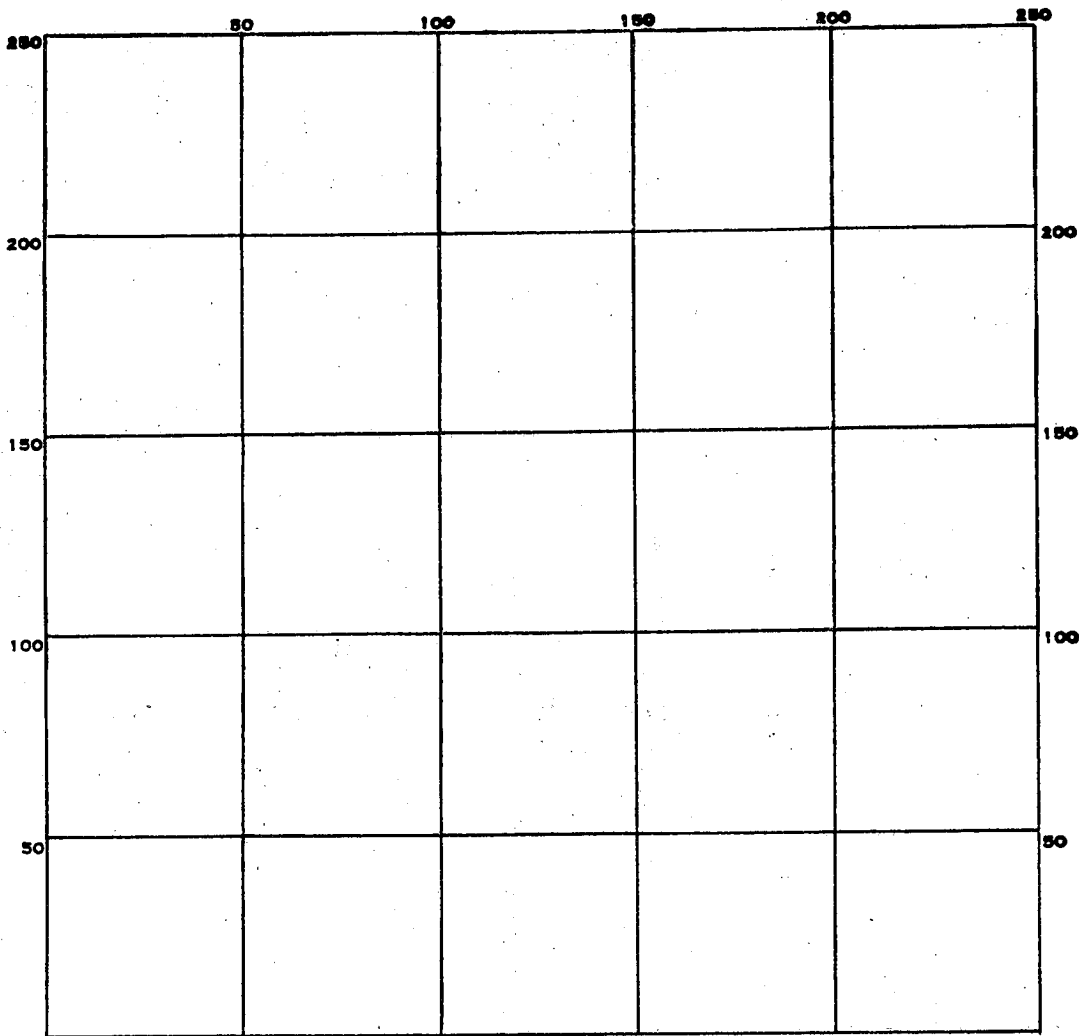

INDICATE NORTH. - NAME ADJOINING ROADWAY AS BASE LINE.

PERMIT CARD \_\_\_\_\_

SEPTIC TANK, LEVEL \_\_\_\_\_ CLEANOUTS \_\_\_\_\_

DISTRIBUTION BOX, LEVEL \_\_\_\_\_

TILE FIELD, DEPTH \_\_\_\_\_ FT. TRENCH WIDTH \_\_\_\_\_ FT.

GRAVEL DEPTH \_\_\_\_\_ IN. TOTAL LENGTH \_\_\_\_\_ FT.

NUMBER OF TRENCHES \_\_\_\_\_ TOTAL BOTTOM AREA \_\_\_\_\_

SEEPAGE PITS, INSIDE DIAMETER \_\_\_\_\_ FT. DEPTH BELOW INLET \_\_\_\_\_ FT.

ABSORBENT AREA \_\_\_\_\_ SQ. FT.

REMARKS \_\_\_\_\_  
 \_\_\_\_\_  
 \_\_\_\_\_  
 \_\_\_\_\_  
 \_\_\_\_\_  
 \_\_\_\_\_

DATE SYSTEM APPROVED \_\_\_\_\_ INSPECTOR \_\_\_\_\_

SEPTIC REPAIR SPECS - SHAH 6126 TULANE DRIVE

- ① USE EXISTING SEPTIC TANK
- ② ADD 500 GAL MINIMUM PUMP PIT WITH SUMP PUMP  
DRILL  $\frac{1}{4}$ " WEEP HOLE IN THE EFFLUENT LINE AFTER THE PUMP.
- ③ PUMP TO TWO LEACHING BEDS - EACH 8' X 50' (800 SQFT)  
EACH BED TO HAVE TWO PERFORATED SUPPLY LINES (TOTAL BOTTOM AREA)  
NO DISTRIBUTION BOX REQUIRED - "T" R OK
- ④ LEACHING BEDS CONNECT TO COMMON DRAIN LINE  
WHICH OVERFLOWS TO 1500 GAL HOLDING TANK  
WITH HIGH WATER ALARM DEVICE  
(ELECTRIC ALARM OR FLAG/FLOAT MECHANISM OK)

---

PUMP DEVICE NOT REQUIRED

AFTER REPLUMBING HOUSE SEWER  
AND SETTING ~~THE~~ NEW TANK  
AT HIGHER ELEVATION.

7/18/86 CW [Signature]

6/11/84  
1:30 PM

# PERMIT

P 33875

A REPAIR

SEWAGE DISPOSAL SYSTEM

MARYLAND STATE DEPARTMENT OF HEALTH

HOWARD COUNTY

ELLICOTT CITY

BUREAU OF ENVIRONMENTAL HEALTH

DISTRICT 5th.

992-2330

DATE 5/14/84

Ashfao Hussain Shah

IS PERMITTED TO INSTALL \_\_\_\_\_ ALTER X

ADDRESS 6126 Tulane Drive, Clarksville, Maryland PHONE 531-3084

SUBDIVISION \_\_\_\_\_ ROAD 6126 Tulane Drive LOT \_\_\_\_\_

PROPERTY OWNER Ashfao Hussain Shah PHONE: 531-3084

ADDRESS \_\_\_\_\_

IF GARBAGE GRINDER IS USED INCREASE SEPTIC TANK CAPACITY BY 50% AND ABSORPTION AREA BY 22%.

GARBAGE GRINDER? YES \_\_\_\_\_ NO \_\_\_\_\_

SEPTIC TANK CAPACITY \_\_\_\_\_ GALLONS NUMBER OF BEDROOMS \_\_\_\_\_

REPAIR - CALL FOR INSPECTION WHEN GROUND IS OPENED UP SO SANITARIAN CAN RECOMMEND REPAIR.

PREVIOUS HISTORY OF PROBLEMS PER B. STRECKER. HIS INVESTIGATION REVEALED WATER TABLE PROBLEM IN LOWER TRENCH. ANY REPAIR SHOULD BE ON HIGHER GROUND. 5/14/84 CW

WATER AT 5' IN FRONT YARD, BACK YARD <sup>AT LEAST</sup> HAS TWO PREVIOUSLY FAILING, SHORT LIVED SYSTEMS. NO POSSIBILITY OF ANY ADDITIONAL SYSTEM ANYWHERE.

HOLDING TANK REQUIRED UNTIL PUBLIC SEWER BECOMES AVAILABLE. 6/1/84 CW

PLANS APPROVED BY Frank Skinner 6/11/84 Dry per Mr. Shah DATE 5/14/84

COVER NO WORK UNTIL INSPECTED AND APPROVED. 5:00 6/11/84 T/C [ Mr. ARNOLD possibly to seal unit. and dig other places to be sealed before covering. 680 ]

NEITHER THE HOWARD COUNTY COUNCIL NOR THE HEALTH DEPARTMENT IS RESPONSIBLE FOR THE SUCCESSFUL OPERATION OF ANY SYSTEM.

NOTE: IF TRENCH IS USED CALL FOR INSPECTION BEFORE AND AFTER PLACING GRAVEL IN TRENCH.

NOTE: NO DRY WELL SHALL EXCEED 15 FOOT IN DIAMETER. NO ABSORPTION TRENCH TO EXCEED 100 FEET IN LENGTH.

NOTE: ALL PIPE FROM HOUSE TO SEPTIC TANK MUST BE CAST IRON OR SCHEDULE 40 PVC OR ABS.

PERMIT VOID AFTER THREE YEARS.

NOTE: INSTALL STAND PIPE ON SEPTIC TANK AND DRY WELL. STAND PIPES MUST BE 6 INCHES IN DIAMETER. CAST IRON, CONCRETE OR TERRA COTTA, OR PVC OR ABS ACCEPTED. IF TOP OF SEPTIC TANK IS DEEPER THAN 3 FEET MANHOLE TO GRADE REQUIRED.

**\*INSTALLER IS RESPONSIBLE FOR OBTAINING FINAL APPROVAL ON THIS PERMIT**

\*CALL 992-2330 FOR INSPECTION OF SEPTIC SYSTEMS.

EH - 2-1082

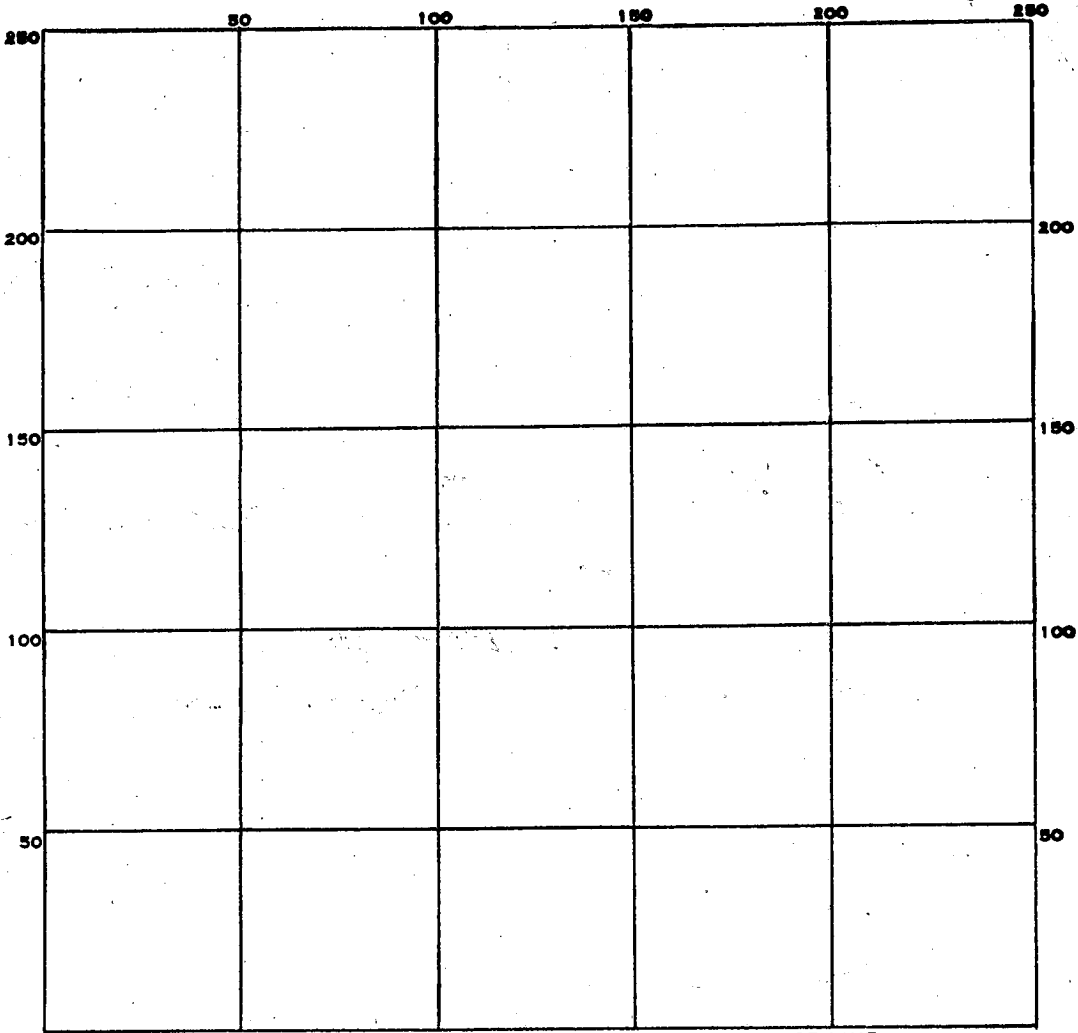

INDICATE NORTH. - NAME ADJOINING ROADWAY AS BASE LINE.

PERMIT CARD \_\_\_\_\_

SEPTIC TANK, LEVEL \_\_\_\_\_

CLEANOUTS \_\_\_\_\_

DISTRIBUTION BOX, LEVEL \_\_\_\_\_

TILE FIELD, DEPTH \_\_\_\_\_ FT. TRENCH WIDTH \_\_\_\_\_ FT.

GRAVEL DEPTH \_\_\_\_\_ IN. TOTAL LENGTH \_\_\_\_\_ FT.

NUMBER OF TRENCHES \_\_\_\_\_ TOTAL BOTTOM AREA \_\_\_\_\_

SEEPAGE PITS, INSIDE DIAMETER \_\_\_\_\_ FT. DEPTH BELOW INLET \_\_\_\_\_ FT.

ABSORBENT AREA \_\_\_\_\_ SQ. FT.

REMARKS 6-15-84 TANK PUMPED OUT & OUTLET PLUGGED. TEMPORARY

PLUG ONLY AS CONTRACTORS EQUIPMENT NOT AVAILABLE THIS DATE.

STAFF TO CONTACT THIS DEPT WHEN READY FOR PERMANENT REPAIR. CW

DATE SYSTEM APPROVED \_\_\_\_\_

INSPECTOR \_\_\_\_\_

# PERMIT

SEWAGE DISPOSAL SYSTEM

MARYLAND STATE DEPARTMENT OF HEALTH

HOWARD COUNTY

ELLICOTT CITY

DISTRICT 5th

DATE 5/29/73

app. 6-11-73  
200 P 18541  
A \_\_\_\_\_

6/11/73  
after 2 P.M.

Christopher R. Spengler

IS PERMITTED TO INSTALL \_\_\_\_\_ ALTER X

ADDRESS 8928-F Town and Country Blvd., Ellicott City, Md. PHONE 465-9217

A SEWAGE DISPOSAL SYSTEM LOCATED AT \_\_\_\_\_

SUBDIVISION Heritage Heights

ROAD Route 32 = Tulare Road LOT \_\_\_\_\_

PROPERTY OWNER Mr. Lee Wymer

286-2627

ADDRESS Route 32, Clarksville, Md.

### SPECIFICATIONS

DRAIN FIELD \_\_\_\_\_ DEPTH \_\_\_\_\_ FEET, BOTTOM AREA \_\_\_\_\_ SQ. FT.

SEEPAGE PITS \_\_\_\_\_ ABSORBENT SIDE-WALL AREA \_\_\_\_\_ SQ. FT.

SEPTIC TANK CAPACITY \_\_\_\_\_ GALLONS

FOR GARBAGE GRINDER, INCREASE DISPOSAL AREA 22% & TANK CAPACITY 50%.

OTHER REPAIR - Call for inspection when ground is opened up and Sanitarian

will recommend repair system.

down to 11' -

2 1/2" grand under pipe - if only 1 1/2" gravel make them 80' long  
2 trunks - 50' long - 2' wide 4 1/2' to 5' deep with  
some off blinding sys

PLANS APPROVED BY Palmer F. Wine

DATE 5/29/73

6/7/73

FILL SEPTIC TANK AND DISTRIBUTION BOX WITH WATER BEFORE CALLING FOR AN INSPECTION. COVER NO WORK UNTIL INSPECTED AND APPROVED.

NEITHER THE HOWARD COUNTY COMMISSIONERS NOR THE HEALTH DEPARTMENT IS RESPONSIBLE FOR THE SUCCESSFUL OPERATION OF ANY SYSTEM.

P-18541

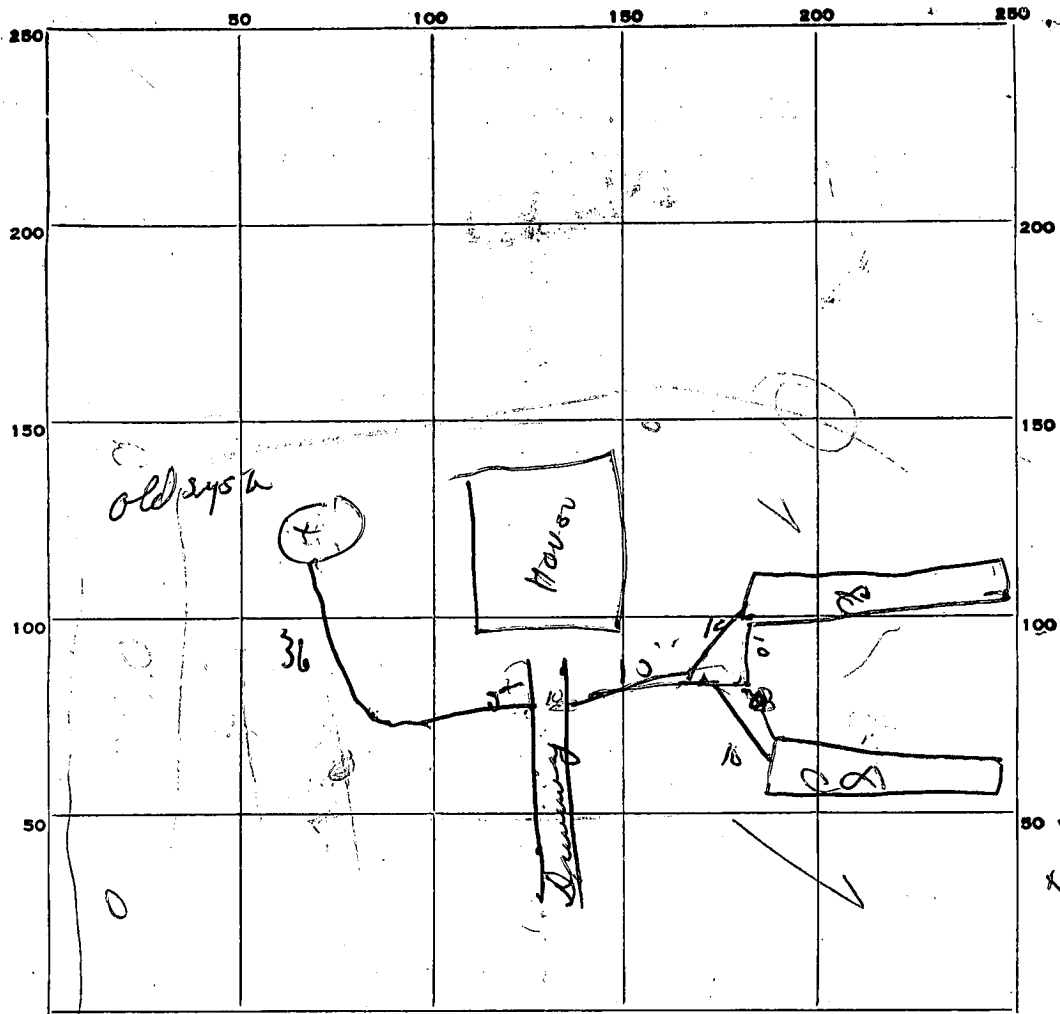

INDICATE NORTH. - NAME ADJOINING ROADWAY AS BASE LINE.

PERMIT CARD OK

RT 32

SEPTIC TANK, LEVEL \_\_\_\_\_

CLEANOUTS \_\_\_\_\_

DISTRIBUTION BOX, LEVEL \_\_\_\_\_

TILE FIELD, DEPTH 4 1/2 FT. TRENCH WIDTH 2 FT.

GRAVEL DEPTH 18 to 24 IN. TOTAL LENGTH 80 FT.

NUMBER OF TRENCHES 2 TOTAL BOTTOM AREA 160 feet trench

SEEPAGE PITS, INSIDE DIAMETER \_\_\_\_\_ FT. DEPTH BELOW INLET \_\_\_\_\_ FT.

ABSORBENT AREA 480 SQ. FT. subwall in

REMARKS trench

DATE SYSTEM APPROVED 6-11-73

INSPECTOR Dw. Monaghan

- **SENDER:** Complete items 1, 2, 3, and 4.  
Add your address in the "RETURN TO" space  
on reverse.

**(CONSULT POSTMASTER FOR FEES)**

1. The following service is requested (check one).

 Show to whom and date delivered..... — Show to whom, date, and address of delivery.. —

- 2.
- 
- RESTRICTED DELIVERY**
- 

*(The restricted delivery fee is charged in addition to the return receipt fee.)***TOTAL \$** \_\_\_\_\_

- 3.
- ARTICLE ADDRESSED TO:**

*Mrs. Naomi C. Wyer*  
*6126 Tulane Drive*  
*Clarksville, Maryland 21029*

- 4.
- TYPE OF SERVICE:**

 REGISTERED     INSURED CERTIFIED     COD EXPRESS MAIL**ARTICLE NUMBER**

4557849

**(Always obtain signature of addressee or agent)**

I have received the article described above.

**SIGNATURE**  Addressee     Authorized agent5. *Naomi Wyer***DATE OF DELIVERY**

5-4-84

**POSTMARK**

- 6.
- ADDRESSEE'S ADDRESS**
- (Only if requested)*

- 7.
- UNABLE TO DELIVER BECAUSE:**

**7a. EMPLOYEE'S INITIALS**

S

RETURN RECEIPT, REGISTERED, INSURED AND CERTIFIED MAIL

**UNITED STATES POSTAL SERVICE**  
OFFICIAL BUSINESS

**SENDER INSTRUCTIONS**

Print your name, address, and ZIP Code in the space below.

- Complete items 1, 2, 3, and 4 on the reverse.
- Attach to front of article if space permits, otherwise affix to back of article.
- Endorse article "Return Receipt Requested" adjacent to number.

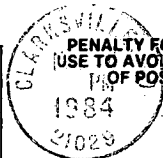

**PENALTY FOR PRIVATE  
USE TO AVOID PAYMENT  
OF POSTAGE, \$300**



RECEIVED  
HOWARD COUNTY  
HEALTH DEPT.  
ELLICOTT CITY, MD

MAY 8 9 29 AM  
RETURN



*Howard County Health Department*

(Name of Sender)

*Bureau of Environmental Health*

*P. O. Box 476*

(Street or P.O. Box)

*Ellicott City, Maryland 21043*

(City, State, and ZIP Code)

Recall May 30 6/4/84  
#4090

## HOWARD COUNTY HEALTH DEPARTMENT

JOYCE M. BOYD, M.D., M.P.H.  
COUNTY HEALTH OFFICER



BUREAU OF ENVIRONMENTAL HEALTH  
TIBER PLACE  
8308B FORREST STREET  
ELLCOTT CITY, MARYLAND 21043  
TELEPHONE: 902-2330

April 30, 1984

Mrs. Naomi C. Wyer  
6126 Tulane Drive  
Clarksville, Maryland 21029

Dear Mrs. Wyer:

On April 23, 1984, while investigating a complaint concerning a condition allegedly hazardous to health, Charles B. Streaker inspected your property known as Parcel 120, Tax Map 34 located at 6126 Tulane Drive, Clarksville, Maryland.

During that inspection he observed an apparent failing septic system - overflowing sewage near and along Route 32 down to Tulane Drive storm drain.

As the failing septic system creates a condition which is, or may be hazardous to the public health, you are hereby ordered to repair the system within thirty (30) days of receipt of this letter. To abate this unhealthy nuisance you must:

- (1) Secure a permit to repair the system. The fee for this permit is \$10.00.
- (2) Have ground opened up for inspection so Sanitarian can recommend the repair system.
- (3) Have the system repaired and inspected and approved by the Health Department.

If you believe that the condition described above is not and could not be a hazard to health, or that the Health Department is not acting in compliance with pertinent laws and regulations, you may request a formal hearing before the Board of Health within ten (10) days of receipt of this letter. If you wish to discuss the evidence, the regulations, or your individual circumstances, you are encouraged to request a meeting with us by calling 992-2330 and scheduling an appointment.

4090

Mrs. Naomi C. Wyer

- 2 -

April 30, 1984

The investigation of this complaint and the enforcement powers of the Health Department are set forth in Section 12 of the Howard County Code, a copy of which is available for your inspection at this office.

The policy of the Health Department is to cooperate with the citizens of the County in seeking solutions to public health problems. If voluntary compliance is not successful, we are required to take necessary action to protect the health and safety of our citizens. We hope you will agree that the corrective actions are reasonable, prudent, and in the best interests of all concerned.

Failure to comply with this office could result in legal action being initiated by this office.

In closing, may I restate our willingness to discuss the problem. Please feel free to contact us.

Very truly yours,

June S. Leete, Director  
Community Environmental Health Services

JSL/CBS:hs

Jerry ~~Thomas~~ w 792-4510  
5/10/84

Tulane Dr.

Frank # 4090

Shah

~~11 people x 2330~~  
~~for you~~

Frank  
Referred  
to C.B.D.

583

C.B.D.  
Returned  
call 5/10/84  
+ 5/11/84

FILE Sewage Complaint DATE REPORTED April 23, 1984  
 PROPERTY OWNER Mr. and Mrs. Shah 531-2627 Charged 5/1  
 P. O. ADDRESS 6126 Tulane Drive, Clarksville, Md. 21029 703-751-1943 in Virginia  
 DIRECTIONS TO PROPERTY "Heritage Heights"

INFORMANT Lady who called was a neighbor. Stated that she believed the above residence was having problems with their septic system. It is overflowing in the front yard in corner of lot and running into sewer drain on Route 32. Odor is becoming a problem. Also stated that this sewage is settling into corner of a neighbor's yard several doors down.

Mr. Thayer, 6118 Tulane Ave - 596-9065 4/30/84

4/30/84 - Two neighbors called concerning this problem. / hr

CONDITION FOUND: 4/23/84 Site check found - overflowing sewage along Rt 32 - grayish black liquid & odor this date. C.B.D.

5/1/84 - Mr. Joney, Housing, called this a.m. to inform us that he had received call from a resident in area concerning overflowing sewage on Route 32. / hr 5/10/84 Site ✓ - by C.B.D. late P.M.

ACTION TAKEN: See page 2 C.B.D. 4/23/84 check on old records for septic system; bill 33 prepared. 4/24 C.B.D.

P.M. 5/10/84 Telephone call to 531-2627 phone changed to Virginia # see above. C.B.D.

P.M. 5/11/84 T/c to Mr. Terry Thompson, spoke to his father at 792-4510 explained the slabs were to lower area of yard & close off the direct drain to storm drain; also they were to get a repair permit out on Monday 5/14/84. C.B.D.

FINAL DISPOSITION:

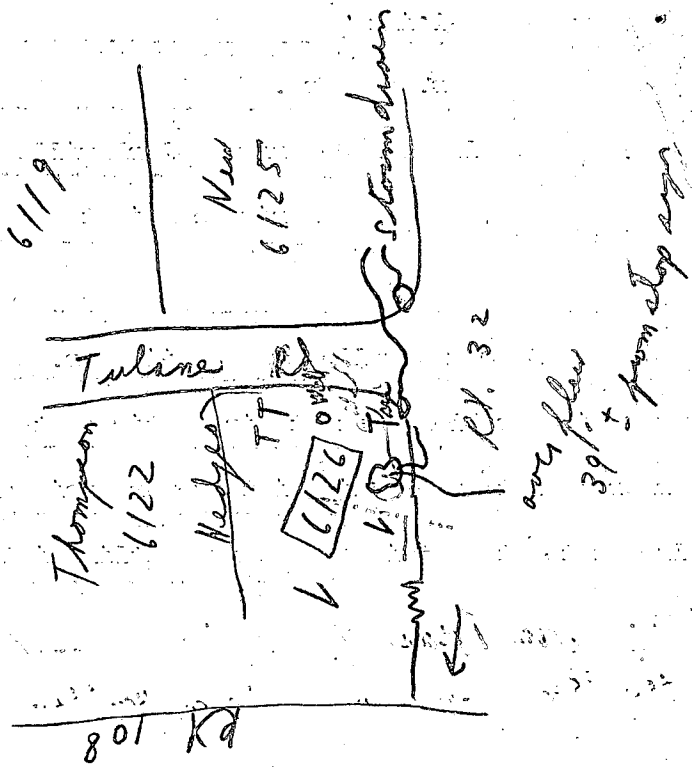

Church

4/23/84

Spoke to Mr. Thompson  
neighbor at site.

- ① Check old records for repair

EH - 24

**HOWARD COUNTY HEALTH DEPARTMENT**

**Bureau of Environmental Health**

**Ellicott City, Maryland 21043**

**Phone: 992-2330**

To:         *Busi*          
*please*  
*see me*

*Shah case*  
*(new informant)*  
*↓ yes*

*5/29/04*  
*App for*  
*Mr. Shah repairs*  
*referred to Mr. Call*  
*Wellman*

From:         *list of contractors*          
Date:         *Bus*

EH - 24

HOWARD COUNTY HEALTH DEPARTMENT

Bureau of Environmental Health

Ellicott City, Maryland 21043

Phone: 992-2330

To: \_\_\_\_\_

*Buran*

*Please see end*

*Bob*

[ 3:00<sup>pm</sup> T/c  
or later 5/25/84 ]

LIME

6126 Tubane

From: \_\_\_\_\_

*ps*

Date: \_\_\_\_\_

5/14/84 = 5 Call in A.M. T

For Bryan

Date 5/14/84 Time 9:50 A.M.

### WHILE YOU WERE OUT

M Leroy Thompson

From \_\_\_\_\_

Phone No. 792-4510

Area Code                      Number                      Extension

TELEPHONED	<input type="checkbox"/>	URGENT	<input type="checkbox"/>
PLEASE CALL	<input checked="" type="checkbox"/>	WANTS TO SEE YOU	<input type="checkbox"/>
WILL CALL AGAIN	<input type="checkbox"/>	CAME TO SEE YOU	<input type="checkbox"/>
RETURNED YOUR CALL	<input type="checkbox"/>		<input type="checkbox"/>

Message 5/14/84 call - A.S.A.P.

1:00's - Telephone call  
explained Mr. What  
in and repair permit  
out. C.R.O.      recall  
(5/16/84)

A.M. 5/25/84 T/C from lady whose husband sold <sup>Operator</sup> What is the property

DATA COM 9161 explained they need to call for opt.

5/25 for repair of 6126  
Tulane Pr.  
Possibly Mr. Fred Frommelt  
Mr. <sup>or</sup> Craig Wilkins

#4111

B.S. III

Recall 6/4/84

FILE Sewerage Complaint

DATE REPORTED 5/10/84

PROPERTY OWNER William Hill PHONE NO. 531-2286-H

P. O. ADDRESS 6215 Route 32 854-0054

DIRECTIONS TO PROPERTY Clarksville, Maryland 21029

INFORMANT Mr. Hill's complaint is that his neighbor, that lives at 6126 Tulane Drive, Clarksville, Maryland 21029, (does not know the name of the person who lives next door) his septic system is bubbling all over the place running on his driveway, and the children have to wait for the bus and he thinks that it is a health hazard - the odor is very bad and he would like someone from the health dept. to check it out and see if they are in violation.

CONDITION FOUND: 5/10/84 Site ✓ see #4090 complaint. 5/16/84 Area of shallow trench covered over; no strong odor this date; clearer effluent along Route 32 - appears spring or underground water flowing to surface. ? if lime being applied, other water near intersection of Rt 108 & 32 opposite new church along road way

ACTION TAKEN: 5/14/84 Mr. Shah has cleared the system out per office meeting; a repair permit for 6126 Tulane Dr. was taken out at the Health Department this date. Telephone call to above - Mr. Hill at 854-0054 explained action taken to this date. 5/21/84 Telephone call to Mr. Shah - he is getting a contractor for the repair - note per call he is contacting 2 or 3 contractors and getting the lowest bid. Hold for a call from contractor or letter from Mr. Shah.

FINAL DISPOSITION: 5/25/84 12:00 T/C 7; 5/25/84 03:00 call back for Mr. Shah who spoke to Mr. Shah's Brother. Took permit out per his brother and he can give us a name of his contractor. 5/25/84 4:45 Phone call to Mr. [unclear] Pg 1 of 2

Recall 6/4/84 also

# 4090

FILE Sewage Complaint DATE REPORTED 5/10/84  
 PROPERTY OWNER Mr. and Mrs. Shah PHONE NO. \_\_\_\_\_  
 P. O. ADDRESS 6126 Tulane Dr., Clarksville Md. 21029  
 DIRECTIONS TO PROPERTY \_\_\_\_\_

INFORMANT In house from Mr. Frank Skennes due to a telephone call on 5/10/84

CONDITION FOUND: 5/10/84 Located similar problem as addressed on April 23, 1984. Note a large number of adults and children were at the home this date 9<sup>+</sup> total noted; c.B. 5/11/84 No change from May 10, 1984 at site Recall 5/14/84; 5/15/84 Check at office. c.B.

ACTION TAKEN: 5/10/84 Kate p.m. - spoke to Mr. Shah at site; he is to remove area and close off the direct drain to the storm drain; on Monday, May 14, 1984, he is to come to our office and get a repair permit out for the septic system. Left card with directions to our office; c.B. 5/14/84 Mr. Shah secured a repaired permit at Health Department for 6126 Tulane Drive, Clarksville, Maryland 6/4/84 T/c from a Mr. Z. ego

FINAL DISPOSITION: about repair referred to Mr. Craig Williams of Water + Sewer program. c.B.

# PERMIT

P 33875

A REPAIR

SEWAGE DISPOSAL SYSTEM

MARYLAND STATE DEPARTMENT OF HEALTH

HOWARD COUNTY  
BUREAU OF ENVIRONMENTAL HEALTH  
992-2330

ELLICOTT CITY  
DISTRICT 5th.

DATE 5/14/84

Ashfao Hussain Shah IS PERMITTED TO INSTALL \_\_\_\_\_ ALTER X

ADDRESS 6126 Tulane Drive, Clarksville, Maryland PHONE 531-3084

SUBDIVISION \_\_\_\_\_ ROAD 6126 Tulane Drive LOT \_\_\_\_\_

PROPERTY OWNER Ashfao Hussain Shah PHONE: 531-3084

ADDRESS \_\_\_\_\_

IF GARBAGE GRINDER IS USED INCREASE SEPTIC TANK CAPACITY BY 50% AND ABSORPTION AREA BY 22%.

GARBAGE GRINDER? YES \_\_\_\_\_ NO \_\_\_\_\_

SEPTIC TANK CAPACITY \_\_\_\_\_ GALLONS NUMBER OF BEDROOMS \_\_\_\_\_

REPAIR - CALL FOR INSPECTION WHEN GROUND IS OPENED UP SO SANITARIAN CAN RECOMMEND REPAIR.

\_\_\_\_\_  
\_\_\_\_\_  
\_\_\_\_\_  
\_\_\_\_\_  
\_\_\_\_\_  
\_\_\_\_\_  
\_\_\_\_\_

PLANS APPROVED BY Frank Skinner DATE 5/14/84

COVER NO WORK UNTIL INSPECTED AND APPROVED.

NEITHER THE HOWARD COUNTY COUNCIL NOR THE HEALTH DEPARTMENT IS RESPONSIBLE FOR THE SUCCESSFUL OPERATION OF ANY SYSTEM.

NOTE: IF TRENCH IS USED CALL FOR INSPECTION BEFORE AND AFTER PLACING GRAVEL IN TRENCH.

NOTE: NO DRY WELL SHALL EXCEED 15 FOOT IN DIAMETER. NO ABSORPTION TRENCH TO EXCEED 100 FEET IN LENGTH.

NOTE: ALL PIPE FROM HOUSE TO SEPTIC TANK MUST BE CAST IRON OR SCHEDULE 40 PVC OR ABS.

PERMIT VOID AFTER THREE YEARS.

NOTE: INSTALL STAND PIPE ON SEPTIC TANK AND DRY WELL. STAND PIPES MUST BE 6 INCHES IN DIAMETER CAST IRON, CONCRETE OR TERRA COTTA, OR PVC OR ABS ACCEPTED. IF TOP OF SEPTIC TANK IS DEEPER THAN 3 FEET MANHOLE TO GRADE REQUIRED.

**\*INSTALLER IS RESPONSIBLE FOR OBTAINING FINAL APPROVAL ON THIS PERMIT**

\*CALL 992-2330 FOR INSPECTION OF SEPTIC SYSTEMS.

# PERMIT

SEWAGE DISPOSAL SYSTEM

MARYLAND STATE DEPARTMENT OF HEALTH

HOWARD COUNTY

ELLICOTT CITY

DISTRICT 5th

DATE 5/29/73

Christopher R. Spengler

IS PERMITTED TO INSTALL ALTER 2

ADDRESS 8928-F Town and Country Blvd., Ellicott City, Md. PHONE 465-9217

A SEWAGE DISPOSAL SYSTEM LOCATED AT \_\_\_\_\_

SUBDIVISION Heritage Heights

ROAD Corner 6126 Tulare Road  
Route 32 - Johnson Road LOT \_\_\_\_\_

PROPERTY OWNER Mr. Lee Wyner

286-2627

ADDRESS Route 32, Clarksville, Md.

### SPECIFICATIONS

DRAIN FIELD \_\_\_\_\_ DEPTH \_\_\_\_\_ FEET, BOTTOM AREA \_\_\_\_\_ SQ. FT.

SEEPAGE PITS \_\_\_\_\_ ABSORBENT SIDE-WALL AREA \_\_\_\_\_ SQ. FT.

SEPTIC TANK CAPACITY \_\_\_\_\_ GALLONS

FOR GARBAGE GRINDER, INCREASE DISPOSAL AREA 22% & TANK CAPACITY 50%.

OTHER REPAIR - Call for inspection when ground is opened up and Sanitarian  
will recommend repair system.

down to 11' -

1 1/2" 2 trunks - 50' long - 2' wide 4 1/2' to 5' deep with  
2 1/2" gravel under pipe - if only 1 1/2" gravel create them 80' long  
come off existing sys

PLANS APPROVED BY Palmer F. Wine

DATE 5/29/73

6/7/73

FILL SEPTIC TANK AND DISTRIBUTION BOX WITH WATER BEFORE CALLING FOR AN INSPECTION. COVER NO WORK UNTIL INSPECTED AND APPROVED.

NEITHER THE HOWARD COUNTY COMMISSIONERS NOR THE HEALTH DEPARTMENT IS RESPONSIBLE FOR THE SUCCESSFUL OPERATION OF ANY SYSTEM.

A-18541

6/11/73  
after 2 P.M.

app. 6-11-73

P 18541

**EXEMPTED**

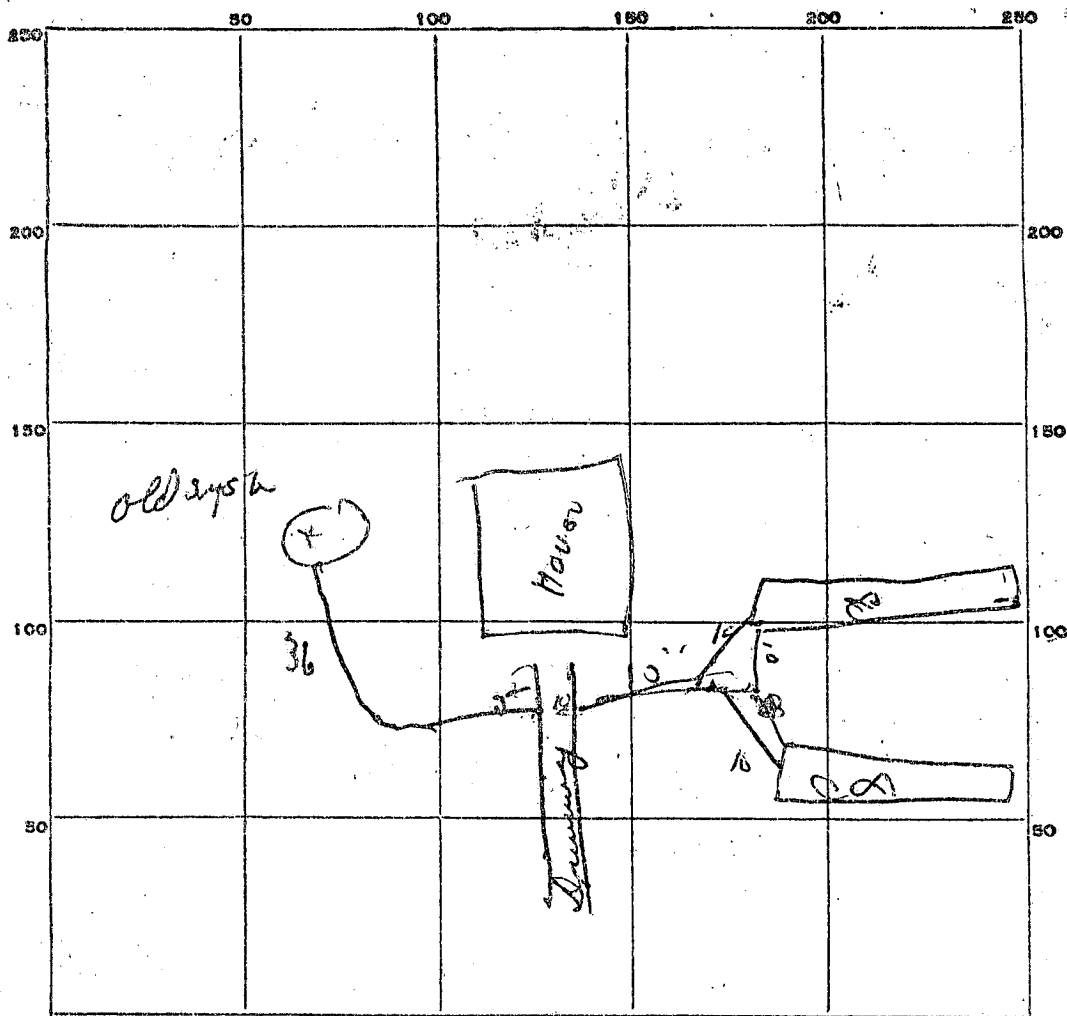

INDICATE NORTH. - NAME ADJOINING ROADWAY AS BASE LINE.

PERMIT CARD OK

12732

SEPTIC TANK, LEVEL \_\_\_\_\_

CLEANOUTS \_\_\_\_\_

DISTRIBUTION BOX, LEVEL \_\_\_\_\_

TILE FIELD, DEPTH 4 1/2 FT. TRENCH WIDTH 2 FT.

GRAVEL DEPTH 18 1/2 IN. TOTAL LENGTH 80 FT.

NUMBER OF TRENCHES 2 TOTAL BOTTOM AREA 160 sq ft trench

SEEPAGE PITS, INSIDE DIAMETER \_\_\_\_\_ FT. DEPTH BELOW INLET \_\_\_\_\_ FT.

ABSORBENT AREA 480 SQ. FT. side wall in

REMARKS trenches

DATE SYSTEM APPROVED 6-11-

INSPECTOR Jim M... ..

Recall May 30 6/4/84  
#4090

# HOWARD COUNTY HEALTH DEPARTMENT

JOYCE M. BOYD, M.D., M.P.H.  
COUNTY HEALTH OFFICER



BUREAU OF ENVIRONMENTAL HEALTH  
TIBER PLACE  
8308B FORREST STREET  
ELLICOTT CITY, MARYLAND 21043  
TELEPHONE: 602-2330

~~May 14~~  
April 30, 1984

~~MR. ASHFAQ SHAH AND FAMILY~~  
Mrs. Naomi C. Wyer  
6126 Tulane Drive  
Clarksville, Maryland 21029

Hold off  
permit out 5/14/84

Dear Mrs. Wyer:

On ~~April 28~~ <sup>May 10</sup>, 1984, while investigating a complaint concerning a condition allegedly hazardous to health, Charles B. Streaker inspected your property known as Parcel 120, Tax Map 34 located at 6126 Tulane Drive, Clarksville, Maryland.

During that inspection he observed an apparent failing septic system - overflowing sewage near and along Route 32 down to Tulane Drive storm drain.

As the failing septic system creates a condition which is, or may be hazardous to the public health, you are hereby ordered to repair the system within thirty (30) days of receipt of this letter. To abate this unhealthy nuisance you must:

- (1) Secure a permit to repair the system. The fee for this permit is \$10.00.
- (2) Have ground opened up for inspection so Sanitarian can recommend the repair system.
- (3) Have the system repaired and inspected and approved by the Health Department.

If you believe that the condition described above is not and could not be a hazard to health, or that the Health Department is not acting in compliance with pertinent laws and regulations, you may request a formal hearing before the Board of Health within ten (10) days of receipt of this letter. If you wish to discuss the evidence, the regulations, or your individual circumstances, you are encouraged to request a meeting with us by calling 992-2330 and scheduling an appointment.

Permit out 5/14/84.  
C.B.S.

Mrs. Naomi C. Wyer

- 2 -

May 14  
~~April 30~~, 1984

The investigation of this complaint and the enforcement powers of the Health Department are set forth in Section 12 of the Howard County Code, a copy of which is available for your inspection at this office.

The policy of the Health Department is to cooperate with the citizens of the County in seeking solutions to public health problems. If voluntary compliance is not successful, we are required to take necessary action to protect the health and safety of our citizens. We hope you will agree that the corrective actions are reasonable, prudent, and in the best interests of all concerned.

Failure to comply with this office could result in legal action being initiated by this office.

In closing, may I restate our willingness to discuss the problem. Please feel free to contact us.

Very truly yours,

June S. Loete, Director  
Community Environmental Health Services

JSL/CBS:hs

SENDER: Complete items 1, 2, 3, and 4.  
Add your address in the "RETURN TO" space on reverse.

**(CONSULT POSTMASTER FOR FEES)**  
 1. The following service is requested (check one).  
 Show to whom and date delivered.....  
 Show to whom, date, and address of delivery...  
 2.  RESTRICTED DELIVERY  
 (The restricted delivery fee is charged in addition to the return receipt fee.)

TOTAL \$

3. ARTICLE ADDRESSED TO:  
 Mrs. Naomi C. Wyer  
 6126 Tulane Drive  
 Clarksville, Maryland 21029

4. TYPE OF SERVICE:      ARTICLE NUMBER  
 REGISTERED     INSURED  
 CERTIFIED     COD  
 EXPRESS MAIL  
 4557849

(Always obtain signature of addressee or agent)

I have received the article described above.  
 SIGNATURE  Addressee     Authorized agent

5. *Naomi Wyer*

DATE OF DELIVERY      POSTMARK  
 5-4-84

6. ADDRESSEE'S ADDRESS (Only if requested)

7. UNABLE TO DELIVER BECAUSE:      7a. EMPLOYEE'S INITIALS  
 S

✓ on 5/11/84 4010 Recall May 30 6/4/84  
 C.B.V. Field copy 5/10/84

**HEALTH DEPARTMENT**



BUREAU OF ENVIRONMENTAL HEALTH  
 TIBER PLACE  
 8308B FORREST STREET  
 ELLICOTT CITY, MARYLAND 21043  
 TELEPHONE: 602-2330

April 30, 1984

Investigating a complaint concerning a condition al-  
 les B. Streaker inspected your property known as  
 6126 Tulane Drive, Clarksville, Maryland.

During that inspection he observed an apparent failing septic system - overflow-  
 ing sewage near and along Route 32 down to Tulane Drive storm drain.

As the failing septic system creates a condition which is, or may be hazardous  
 to the public health, you are hereby ordered to repair the system within thirty (30)  
 days of receipt of this letter. To abate this unhealthy nuisance you must:

- (1) Secure a permit to repair the system. The fee for this permit is \$10.00.
- (2) Have ground opened up for inspection so Sanitarian can recommend the repair system.
- (3) Have the system repaired and inspected and approved by the Health Department.

If you believe that the condition described above is not and could not be a hazard to health, or that the Health Department is not acting in compliance with pertinent laws and regulations, you may request a formal hearing before the Board of Health within ten (10) days of receipt of this letter. If you wish to discuss the evidence, the regulations, or your individual circumstances, you are encouraged to request a meeting with us by calling 992-2330 and scheduling an appointment.

5/11/84 ✓ on property found - no change Recheck 5/14/84  
 Property is now shake - since late March 1984  
 The shake Mr. - ASHFAQ - SHAH <sup>supported</sup> attorney name on 5/14/84  
 Repair to be out by 5/14/84 per Mr. Shah  
 Monday In meantime to lime & close off drain. To be done by 5/14/84. C.B.V.  
 5/10/84 4000 or  
 Still under warrants

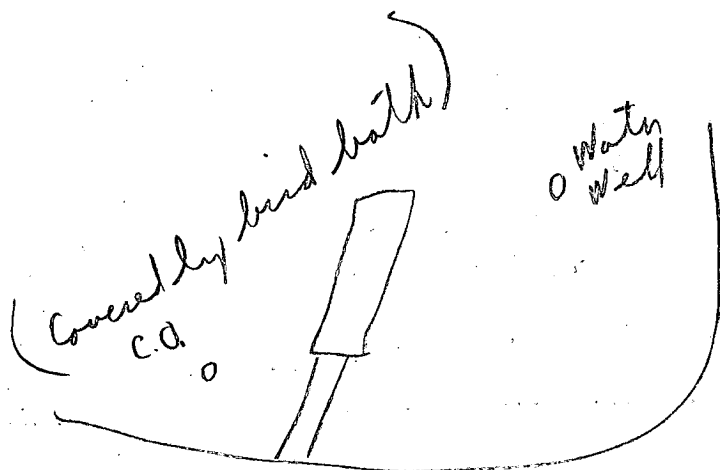

Recall May 30 6/4/84

# HOWARD COUNTY HEALTH DEPARTMENT

JOYCE M. BOYD, M.D., M.P.H.  
COUNTY HEALTH OFFICER



BUREAU OF ENVIRONMENTAL HEALTH  
TIGER PLACE  
83088 FORREST STREET  
ELLCOTT CITY, MARYLAND 21043  
TELEPHONE: 902-2330

April 30, 1984

Mrs. Naomi C. Wyer  
6126 Tulane Drive  
Clarksville, Maryland 21029

Dear Mrs. Wyer:

On April 23, 1984, while investigating a complaint concerning a condition allegedly hazardous to health, Charles B. Streaker inspected your property known as Parcel 120, Tax Map 34 located at 6126 Tulane Drive, Clarksville, Maryland.

During that inspection he observed an apparent failing septic system - overflowing sewage near and along Route 32 down to Tulane Drive storm drain.

As the failing septic system creates a condition which is, or may be hazardous to the public health, you are hereby ordered to repair the system within thirty (30) days of receipt of this letter. To abate this unhealthy nuisance you must:

- (1) Secure a permit to repair the system. The fee for this permit is \$10.00.
- (2) Have ground opened up for inspection so Sanitarian can recommend the repair system.
- (3) Have the system repaired and inspected and approved by the Health Department.

If you believe that the condition described above is not and could not be a hazard to health, or that the Health Department is not acting in compliance with pertinent laws and regulations, you may request a formal hearing before the Board of Health within ten (10) days of receipt of this letter. If you wish to discuss the evidence, the regulations, or your individual circumstances, you are encouraged to request a meeting with us by calling 992-2330 and scheduling an appointment.

Mrs. Naomi C. Wyer

- 2 -

April 30, 1984

The investigation of this complaint and the enforcement powers of the Health Department are set forth in Section 12 of the Howard County Code, a copy of which is available for your inspection at this office.

The policy of the Health Department is to cooperate with the citizens of the County in seeking solutions to public health problems. If voluntary compliance is not successful, we are required to take necessary action to protect the health and safety of our citizens. We hope you will agree that the corrective actions are reasonable, prudent, and in the best interests of all concerned.

Failure to comply with this office could result in legal action being initiated by this office.

In closing, may I restate our willingness to discuss the problem. Please feel free to contact us.

Very truly yours,

June S. Loete, Director  
Community Environmental Health Services

JSL/CBS:hs

FILE - Sewage Complaint DATE REPORTED April 23, 1984

PROPERTY OWNER Mr. and Mrs. Shah 531-2627 Changed

P. O. ADDRESS 6126 Tulane Drive, Clarksville, Md. 21029 703-751-1143 in Virginia

DIRECTIONS TO PROPERTY "Heritage Heights"

INFORMANT Lady who called was a neighbor. Stated that she believed the above residence was having problems with their septic system. It is overflowing in the front yard in corner of lot and running into sewer drain on Route 32. Odor is becoming a problem. Also stated that this sewage is settling into corner of a neighbor's yard several doors down.

Mr. Thayer, 6118 Tulane Rd - 596-9005 4/30/84

4/30/84 - Two neighbors called concerning this problem. / hr

CONDITION FOUND: 4/23/84 Site check found - overflow sewage along Rt 32 - proposed block liquid + for the date. C.B.D.

5/1/84 - Mr. Joney, Housing, called this a.m. to inform us that he had received call from a resident in area concerning overflowing sewage on Route 32. / hr 5/10/84 Site check by C.B.D. later P.M.

ACTION TAKEN: 4/23/84 check on old records for septic system; 4/24/84 bill 33 prepared. C.B.D.

5/10/84 Telephone call to 531-2627 phone changed to Virginia # see above. C.B.D.

FINAL DISPOSITION:

# HOWARD COUNTY HEALTH DEPARTMENT

JOYCE M. BOYD, M.D., M.P.H.  
COUNTY HEALTH OFFICER



BUREAU OF ENVIRONMENTAL HEALTH  
TIBER PLACE  
8308B FORREST STREET  
ELLCOTT CITY, MARYLAND 21043  
TELEPHONE: 892-2330

June 8, 1984

Mr. Ashfad Hussain Shah  
6126 Tulane Drive  
Clarksville, Maryland 21029

RE: Repair Inspection  
6126 Tulane Drive

Dear Mr. Shah:

In response to a previously documented (refer to letter of April 30, 1984) overflowing septic system, a repair inspection was conducted at the above referenced property on June 1, 1984 under the supervision of Craig Williams of this office. That inspection revealed a high water table and at least two other previously failing disposal systems on the property.

The overflowing sewage creates a situation which is, or may be, hazardous to the public health and the conditions described above prohibit the installation of an approvable soil based septic disposal system. Therefore, you are ordered to convert to a septic holding tank immediately. You must supply this office with a copy of a one year service contract for the pumping of this tank by a licensed scavenger. You must maintain this holding tank in a condition which eliminates sewage overflow until public sewage becomes available to the property.

The investigation of this complaint and the enforcement powers of the Health Department are set forth in Section 12 of the Howard County Code, a copy of which is available for your inspection at this office.

Failure to comply with this order could result in legal action being initiated by this Department.

If you have any questions relative to this matter, please call Craig Williams or me at 992-2330.

Very truly yours,

*Frank Skinner CW*

Frank Skinner, Director  
Water and Sewerage Program

FS/CW: jr

Original received by - *[Signature]*

on June 8, 1984

June 8, 1984 Original delivered to 6126 Tulane Drive by Sanitarian  
C.B.S.

SEPTIC INSPECTION

12-4-84

6126 TULANE DRIVE

OWILLIAMS & JOHN COVART

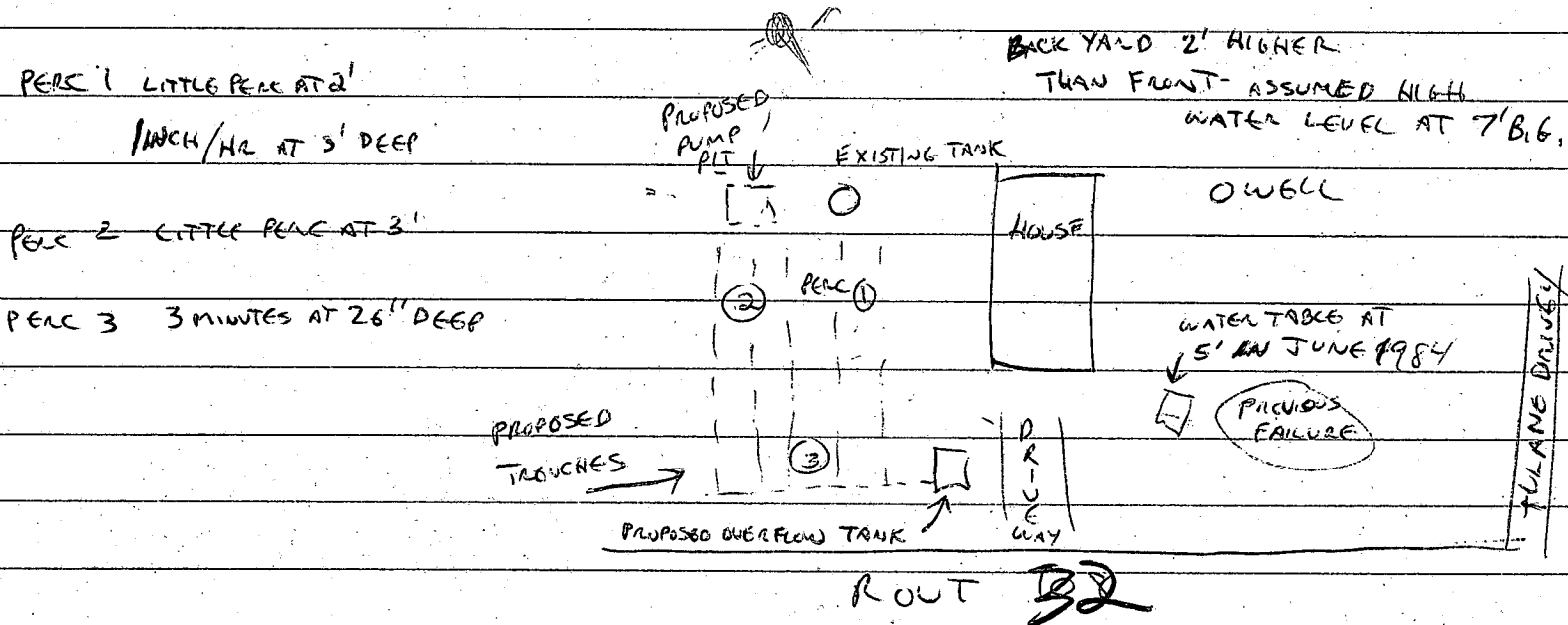

### RECOMMENDI

- 1) 500 GAL PUMP PIT WITH SUMP PUMP
- 2) 5 - 50' TRENCHES 3FT WIDE, INLET 1 1/2', BOTTOM 3'
- 3) CONNECT TRENCHES TO 2000 GAL SEALED OVERFLOW TANK
- 4) 2 MEDIUM SIZED MAPLES IN TRENCH AREA SUGGESTED TO BE REMOVED
- 5) INSTALL WATER SAVING DEVICES WHERE PRACTICAL.

DISCUSSED THESE RECOMMENDATIONS WITH MR SHATT  
THIS DATE. HE WILL GET ESTIMATES AND  
BE IN TOUCH IN ABOUT 2 WEEKS.

12/4/84 OWilliams



OFFICE OF ENVIRONMENTAL PROGRAMS  
DEPARTMENT OF HEALTH AND MENTAL HYGIENE

201 WEST PRESTON STREET • BALTIMORE, MARYLAND 21201 • AREA CODE 301 • 383-2054

TTY FOR DEAF: Balto. Area 383-7555  
D.C. Metro 565-0451

Adele Wilzack, R.N., M.S., Secretary

William M. Eichbaum, Assistant Secretary

November 27, 1984

Frank Skinner, Director  
Water and Sewerage Program  
Howard County Health  
3716 Court Place  
Elliott City, MD 21043

Dear Frank:

I just received your letter of November 2, 1984 concerning Mr. Ashfad Shah's request for consideration of an innovative/alternative system to serve his residence.

As we previously discussed, I will be in Howard County on December 4th and 5th, 1984. We will plan to visit Mr. Shah's property one of those days.

If you have any questions or wish to reschedule our visits, please call me at (301) 383-2054 or 2055.

Sincerely,

John F. Covalt, Jr., R.S.  
Regional Consultant  
Division of Residential Sanitation  
Inspection and Compliance Program

JFC:mew

cc: Dane S. Bauer  
Jack R. Holthaus, R.S.

John

RECEIVED

HOWARD COUNTY HEALTH DEPARTMENT NOV 7 1984

JOYCE M. BOYD, M.D., M.P.H.  
COUNTY HEALTH OFFICER



INSPECTION AND COMPLIANCE PROGRAM  
BUREAU OF ENVIRONMENTAL HEALTH  
TIBER PLACE  
8306B FORREST STREET  
ELLCOTT CITY, MARYLAND 21043  
TELEPHONE: 992-2330

November 2, 1984

RECEIVED

NOV 9 1984

DIVISION OF RESIDENTIAL SANITATION

Mr. John Covalt  
Office of Environmental Programs  
Division of Residential Sanitation  
Department of Health and Mental Hygiene  
201 West Preston Street  
Baltimore, Maryland 21201

Dear Mr. Covalt:

We have recently received a request from Mr. Ashfad Shah to assist him in developing an innovative or alternative septic system for his residence at 6126 Tulane Drive, Clarksville. We are forwarding this request for consideration by your office.

We first became aware that Mr. Shah was experiencing difficulty with his system when we received a complaint from a neighbor in April of 1984. A repair inspection on June 1, 1984 revealed a water table at 5(five) feet below grade. Based on that inspection and a history of at least two previous septic system failures on the lot, Mr. Shah was ordered to convert to a holding tank.

In response to that order, the septic tank was pumped and a temporary plug was placed in the septic tank outlet.

At the time the tank was plugged (June 15, 1984), Mr. Shah indicated that he thought there still should be some consideration given to an on-site disposal system. In response to this request, on-site soil borings were made this date by Craig Williams and yourself. Visual inspection revealed porous sandy soil at shallow depths (below 6 inches).

This soil shows promise for further investigation for a shallow system; but, there are a number of limiting factors that should be kept in mind when making a determination. These limitations are listed below:

1. There is an existing drilled well in the front yard with a history of bacterial contamination. This older well is apparently grouted poorly, if at all.

2. A high water table exists. Percolation tests revealed a water table at 5 (five) feet in the side yard. The back yard location is possibly at best 2 feet higher in elevation.
3. Previous failures exist at several locations on the property. The most recent failure was in the front yard near the site of the June repair test.
4. The system would be subject to heavy demands. Mr. Shah has told us that three people are occupying the house. We are aware of the presence of Mr. Shah, his two brothers, his father, and a number of women and children. Our estimate is that there are eleven people living in the house.

With these considerations in mind, we are requesting the assistance of your office in assisting in determining the suitability of this site for some type of innovative or alternative on-site sewage disposal system.

Very truly yours,



Frank Skinner, Director  
Water and Sewerage Program

FS/CW: jr

cc: Mr. Ashfad Shah

# HOWARD COUNTY HEALTH DEPARTMENT

JOYCE M. BOYD, M.D., M.P.H.  
COUNTY HEALTH OFFICER

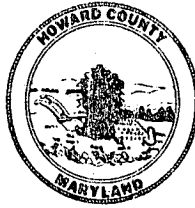

BUREAU OF ENVIRONMENTAL HEALTH  
TIBER PLACE  
8306B FORREST STREET  
ELLCOTT CITY, MARYLAND 21043  
TELEPHONE: 992-2330

November 2, 1984

Mr. John Covalt  
Office of Environmental Programs  
Division of Residential Sanitation  
Department of Health and Mental Hygiene  
201 West Preston Street  
Baltimore, Maryland 21201

Dear Mr. Covalt:

We have recently received a request from Mr. Ashfad Shah to assist him in developing an innovative or alternative septic system for his residence at 6126 Tulane Drive, Clarksville. We are forwarding this request for consideration by your office.

We first became aware that Mr. Shah was experiencing difficulty with his system when we received a complaint from a neighbor in April of 1984. A repair inspection on June 1, 1984 revealed a water table at 5(five) feet below grade. Based on that inspection and a history of at least two previous septic system failures on the lot, Mr. Shah was ordered to convert to a holding tank.

In response to that order, the septic tank was pumped and a temporary plug was placed in the septic tank outlet.

At the time the tank was plugged (June 15, 1984), Mr. Shah indicated that he thought there still should be some consideration given to an on-site disposal system. In response to this request, on-site soil borings were made this date by Craig Williams and yourself. Visual inspection revealed porous sandy soil at shallow depths (below 6 inches).

This soil shows promise for further investigation for a shallow system; but, there are a number of limiting factors that should be kept in mind when making a determination. These limitations are listed below:

1. There is an existing drilled well in the front yard with a history of bacterial contamination. This older well is apparently grouted poorly, if at all.

Mr. John Covalt (Continued)  
November 2, 1984

page 2

2. A high water table exists. Percolation tests revealed a water table at 5 (five) feet in the side yard. The back yard location is possibly at best 2 feet higher in elevation.
3. Previous failures exist at several locations on the property. The most recent failure was in the front yard near the site of the June repair test.
4. The system would be subject to heavy demands. Mr. Shah has told us that three people are occupying the house. We are aware of the presence of Mr. Shah, his two brothers, his father, and a number of women and children. Our estimate is that there are eleven people living in the house.

With these considerations in mind, we are requesting the assistance of your office in assisting in determining the suitability of this site for some type of innovative or alternative on-site sewage disposal system.

Very truly yours,



Frank Skinner, Director  
Water and Sewerage Program

FS/CW: jr

August 14, 1984

Mr. Ashfao Hussain Shah  
6126 Tulane Drive  
Clarksville, Maryland 21029

RE: Septic System Repair  
Permit Number 33875  
6126 Tulane Drive

Dear Mr. Shah:

In a letter dated June 8, 1984, you received a corrective order from this office requiring you to convert your septic disposal system to a holding tank. On June 15, your septic tank was pumped and a temporary plug was placed in its outlet pipe. This arrangement was considered satisfactory only as a short term correction to a potentially hazardous condition. Our letter of June 8 required that your tank be permanently sealed and a high water alarm device be installed. Additionally a one year maintenance contract was required to ensure that the system was to be properly serviced. As of this date, these conditions have not been met.

Please contact this office promptly to discuss the schedule for completion of these requirements. At that time, we would be happy to discuss water conservation measures to ease the burden on the system. If you request, we would also be willing to discuss with you the possibility of installing, with our assistance, some type of experimental innovative and alternative disposal system.

Please contact myself, or Craig Williams, at our new number 461-9933 so that we may attempt to bring this matter to a satisfactory conclusion.

Very truly yours,

*Frank Skinner*

Frank Skinner, Director  
Water and Sewerage Program

FS: jr

SHAH

50% TOTAL FUNDING

RIGHT NOW - INTERIM

NEEDS TANK SEAL

CONTRACT TO PUMP

~~PERMANENT~~

ALARM DEVICE

PERMANENT SEAL

BUREAU OF ENVIRONMENT

HEALTH DEPT.

P.O. Box 476 - EC. MD.

ATT. FRANK SKINNER

It is in your knowledge that we had a problem with septic system. as health dept told us that this house does have a previously problem. you did the Punta Test but did not pass. There fore you request to seal the holding tanks. we call the plumber he did seal the holding tanks in front of you. we keep cleaning the holding tanks every time when as soon as it needs. Even it is very expensive and not a practically County health dept. suggest to put a shallow disposal system, standard or experimental system, we requesting you to please help us to solve this problem. which one is permanent and worth full.

Thanks

A. H. Sheh.

6126. Tulare Dr.

Charlesville, MD.

21029

Dated. 9.18.84

# SHAH CHRONOLOGY

~~APR 23~~ <sup>4/</sup> 23, 1984 <sup>WAS</sup> COMPLAINT RECEIVED CONCERNING SEWAGE OVERFLOW FROM 6126 TULANE DRIVE, (PARCEL 120, TAX MAP 34)

~~APR 23~~ <sup>4/</sup> 23 CBS STREAKE INVESTIGATED, NOTED SEWAGE OVERFLOW ALONG RT 32.  
ORIGINAL INQUIRY FROM CBS WENT TO OWNER OF RECORD.  
REPLY RECEIVED THAT NEW OWNER WAS

~~APR 30~~ <sup>4/</sup> 30 ENFORCEMENT LETTER DRAFTED TO OWNER OF RECORD, NAOMI WYMER

4/30 5/1 ADDITIONAL COMPLAINTS RECEIVED

5/1 ADDITIONAL COMPLAINTS

5/10 ADDITIONAL COMPLAINT

5/10 CBS INSPECTION REVEAL SIMILAR RESULTS AS 4/23

CBS SPOKE TO OWNER <sup>(SHAH)</sup> WHO AGREED TO LIME THE SITE AND SECURE A REPAIR PERMIT.

5/14 SHAH TOOK OUT REPAIR PERMIT

5/16 INSPECTION BY CBS INDICATED SYSTEM HAD BEEN CLEANED OUT, NEW SOIL HAD BEEN SPREAD ON SITE OF OVERFLOW, UNCERTAIN IF LIME HAD BEEN APPLIED. PLEASANT EFFLUENT ALONG ROAD INDICATING WATER FLOWING TO SURFACE.

6/1 REPAIR INSPECTION FAILED. REASONS - HIGH WATER TABLE (5" IN FRONT YARD, PREVIOUSLY FAILING SYSTEM(S) OCCUPIED BULK OF USABLE AREAS

IN BACK YARD, SHAH INFORMED, IN AGREEMENT TO TEST NO MORE,

6/8 LETTER DRAFTED, ADVISING SHAH OF DECISION, ORDERING HIM TO CONVERT TO HOLDING TANK,

6/15 TANK PUMPED, TEMPORARILY <sup>PLUGGED UP</sup> GAPPED, AS CONTRACTOR'S BACKHOE WAS TEMPORARILY UNAVAILABLE, SHAH INFORMED OF NEED TO SEAL PERMANENTLY AND ADD ALARM DEVICE. SHAH REPEATED HIS <sup>RESOLVE</sup>

6/15 CONTINUED - SOIL BORINGS PERFORMED AT SHALLOW DEATHS WITH JOHN COURT IN AREA OUTTOP WHERE PREVIOUS SYSTEMS HAD BEEN INSTALLED. SANDY SOIL ENCOUNTERED QUICKLY

8/14 LETTER DRAFTED ~~REQUESTING~~ ~~ADVISING THAT~~ ~~SHAH~~ ~~COMPLY~~ WITH PREVIOUS ORDER AND <sup>PROBABLY</sup> COMPLETE HIS REPAIR TO HOLDING TANK.

7/9 COMPLAINT RECEIVED RE: SEWAGE OVERFLOW AT #126 JULANE.

7/11 INSPECTION BY R.H. - NO OVERFLOW FROM SYSTEM BUT LAUNDRY EFFLUENT WAS BEING PUMPED ONTO SURFACE. R.H. INFORMED SHAH'S FATHER TO DISCONTINUE THIS PRACTICE. NOT SURE FATHER UNDERSTOOD REQUEST. R.H. ALSO NOTED THAT NO FURTHER REPAIRS HAD BEEN MADE.

7/16 ~~THE~~ ~~ALL~~ C.W. TALKED BY PHONE TO SHAH'S BROTHER WHO SAID PUMPING OF LAUNDRY EFFLUENT HAD BEEN DISCONTINUED. I REQUESTED THAT MR SHAH CALL ME TO DISCUSS NEEDED REPAIRS.

8/14 LETTER DRAFTED REQUESTING SHAH CONTACT OFC TO ARRANGE FOR COMPLETION OF REPAIR

9/12 C.W. STOPPED AT SITE AND DISCUSSED SITUATION WITH SHAH'S BROTHER. ~~SHAH'S BROTHER~~ <sup>HIS</sup> EXPLAINED THE ~~FREQUENCY~~ AND EXPENSE OF PUMPING. HE EXPLAINED THAT ~~BECAUSE~~ AND INCONVENIENCE OF MAINTAINING THE HOLDING TANK WAS GREAT AND THAT HE WANTED PERMISSION TO INSTALL A NEW ON-SITE DISPOSAL SYSTEM. I EXPLAINED THAT IT WAS MY FUNCTION TO SEE THAT HE COMPLETES THE REQUESTED REPAIR. IF HE FELT THAT THE ~~ORDER~~ WAS UNREASONABLE, HE SHOULD WRITE A LETTER EXPLAINING HIS POSITION TO FRANK SKINNER.

10/1 LETTER RECEIVED FROM SHAR REQUESTING RECONSIDERATION OF  
NIS COST FOR STANDARD OR ALTERNATIVE SOL BASED DISPOSAL SYSTEM

10/3 LETTER DRAFTED REQUESTING INX CONSIDERATION.

For Mr. Hodges  
Date 7/10/84 Time 4:15

# WHILE YOU WERE OUT

M. Shah

From \_\_\_\_\_

Phone No. 531-3084

Area Code \_\_\_\_\_ Number \_\_\_\_\_ Extension \_\_\_\_\_

TELEPHONED	<input checked="" type="checkbox"/>	URGENT	
PLEASE CALL	<input checked="" type="checkbox"/>	WANTS TO SEE YOU	
WILL CALL AGAIN		CAME TO SEE YOU	
RETURNED YOUR CALL			

Message \_\_\_\_\_

\_\_\_\_\_  
\_\_\_\_\_  
\_\_\_\_\_  
\_\_\_\_\_  
\_\_\_\_\_  
\_\_\_\_\_

[Signature]  
Operator

MAGN

N-836-3058



7/1  
A SHAH PROPERTY  
6126 TULANE DRIVE  
CLARKSVILLE

7/11/84 - VISITED A SHAH PROP THIS AM  
BECAUSE OF COMPLAINT THAT  
SEWAGE WAS OVERFLOWING  
TALKED TO SHAH'S FATHER BUT  
HE SAID HE HAD PROBLEM WITH  
ENGLISH. OBSERVED  
NO WORK DONE ON PROPOSED  
SEALED TANK  
OBSERVED HOSE RUNNING  
FROM LAUNDRY TUB  
TO SURFACE OF THE GROUND  
LEFT NOTE FOR SHAH TO  
CALL RH

---

7/16/84

TALKED TO SHAH'S BROTHER ON THE PHONE  
WHO SAID PUMPING OF LAUNDRY EFFLUENT HAD BEEN  
DISCONTINUED. I LEFT MESSAGE REQUESTING MR SHAH  
TO CALL ME TO DISCUSS SITUATION FURTHER

Cay Williams

SOIL DESCRIPTION

NAME Shah 6126 Tulane Drive COUNTY Howard FILE NO P 34757 Upper

SOIL MAP UNIT \_\_\_\_\_ MAP SYMBOL \_\_\_\_\_ DATE 2/18/99

GEOLOGIC MATERIAL \_\_\_\_\_ DESCRIBED BY R.P. Bales ELEVATION \_\_\_\_\_ GRID NO \_\_\_\_\_ E \_\_\_\_\_

NO. (A)

Horizon	Depth in.	Color		Texture	Structure		Z Rock Fragments	Notes (Moisture, Density, Biopores, Seepage)	
		Matrix	Mottles		Grade	Type			
	0-6"	dark brn.	—	loam	2L	Sbk	—	Moist brownish m. br.	
	6-11"	yellow-brown - sub-brn.	—	cl	1 m-f	Sbk	—	Moist m. br. - m. f.	
	11-48"	red brn.	—	cl-ll	2m	Sbk	—	Moist m. f.	
	4' to 6 to 7'	maroon-brown dark brown + grey C2d	micro siliceous siliceous + grey C2d	mic loam	—	Passive	—	Spottle moist loose	
	7-8 1/2'	dark brn white + brownish tan	—	mic loam	—	Passive	—	Moist - Moist	
	8 1/2 - 10'	light grey brownish red	lighter brownish red	mic loam	—	Passive	—	v. Moist - Structured owing to water seepage below 2' in level 10'	
<p>System gravel is clay - system is being flushed by water on ground surface.</p> <p>Water table is fluctuating - seasonal variation due to irrigation.</p> <p>Water table is 6 to 8' below ground surface.</p>									

LANDSCAPE Static water level in abandoned drilled well at 6 ft below grade (2 1/2 ft lower elevation than T. Hill #1)

Position 6 ft below grade (2 1/2 ft lower elevation than T. Hill #1)

Summit \_\_\_\_\_ Depression \_\_\_\_\_

Shoulder \_\_\_\_\_ Upland \_\_\_\_\_

Sideslope \_\_\_\_\_ Terrace \_\_\_\_\_

Footslope \_\_\_\_\_ Floodplain \_\_\_\_\_

WATER TABLE probably 6 1/2 to 8 1/2 (observed)

SOIL DRAINAGE CLASS WD MWD PD SPD VPD

LIMITING ZONE Being studied

SOIL CLASSIFICATION (Water Tables at 8 1/2 - 10' range 6 to 8' above T. Hill #1)



---

## HOWARD COUNTY HEALTH DEPARTMENT

---

*Joyce M. Boyd, M.D., County Health Officer*  
February 23, 1998

Louise McLaughlin  
Carol Culler  
9457 Farewell Road  
Columbia, Maryland 21045

RE: Former Shah Property  
6126 Tulane Drive  
Tax Map: 34, Grid: 12, Parcel: 120

Dear Ms. McLaughlin & Culler:

On February 18, 1998 we met at the above referenced property site to evaluate a reported problem with the proper functioning of your existing septic system.

Conditions observed were soggy surface soil conditions (from recent rainfall events) and minor erosion conditions indicative of surface water runoff from neighboring properties across the approximate location of the existing septic system. An observation test pit was dug beside one of the septic trenches. This test hole revealed ground water seepage at 8.5 feet below the surface, (i.e., 4.5 feet deeper than the bottom of the existing septic trenches). Accounts from the septic contractor, stated the septic tank did not fill up after pumping, until heavy rains again fell.

Based on these reports and observations, I do not believe the septic system is failing. Rather it appears to be flooded out periodically by heavy rainfall activity seeping into the gravel filled trenches and back into the septic tank.

Rather than recommend any septic repair to this property, it is my opinion a curtain drain and soil berm placed uphill of and along the northwest and northeast lot line would be a better solution to this problem. Such a curtain drain/soil berm would divert future rainfall around and away from the septic system, and redirect that surface water to the storm water control devices along the two facing roadways.

Although you do not need a septic permit for such work, we would appreciate your notifying us when this berm/drain system is installed so we may have an opportunity to update our records, just in case future problems occur.

If you have any questions please contact me at the address or phone number below.

Respectively yours,

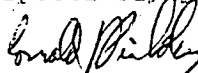
  
Ronald J. Pinkley, R.S.  
Water and Sewerage Program

RJP:tl  
cc: Ken Hatfield  
File