

12/19/83  
a. m. please

# PERMIT

P 33401  
A REPAIR

SEWAGE DISPOSAL SYSTEM

MARYLAND STATE DEPARTMENT OF HEALTH\*

HOWARD COUNTY  
BUREAU OF ENVIRONMENTAL HEALTH  
992-2330

03-289982

ELLICOTT CITY  
DISTRICT 3rd  
DATE 12/19/83  
~~Nov. 30, 1985~~

INDEX

Jack Fyock, Jr. IS PERMITTED TO INSTALL \_\_\_\_\_ ALTER X

ADDRESS 13775 Triadelphia Road, ylenelg, MD 21737 PHONE 988-9270

SUBDIVISION \_\_\_\_\_ ROAD 12018 Triadelphia Rd. LOT \_\_\_\_\_

PROPERTY OWNER James Leith

ADDRESS 12018 Triadelphia Road, Ellicott City, MD Phone: 531-3218

IF GARBAGE GRINDER IS USED INCREASE SEPTIC TANK CAPACITY BY 50% AND ABSORPTION AREA BY 22%.

GARBAGE GRINDER? YES \_\_\_\_\_ NO \_\_\_\_\_

SEPTIC TANK CAPACITY \_\_\_\_\_ GALLONS NUMBER OF BEDROOMS \_\_\_\_\_

REPAIR-CALL FOR INSPECTION WHEN GROUND IS OPENED UP SO SANITARIAN CAN RECOMEND REPAIR.

\_\_\_\_\_  
\_\_\_\_\_  
\_\_\_\_\_  
\_\_\_\_\_  
\_\_\_\_\_  
\_\_\_\_\_  
\_\_\_\_\_

PLANS APPROVED BY Frank Skinner DATE November 29, 1983

COVER NO WORK UNTIL INSPECTED AND APPROVED.

NEITHER THE HOWARD COUNTY COUNCIL NOR THE HEALTH DEPARTMENT IS RESPONSIBLE FOR THE SUCCESSFUL OPERATION OF ANY SYSTEM.

NOTE: IF TRENCH IS USED CALL FOR INSPECTION BEFORE AND AFTER PLACING GRAVEL IN TRENCH.

NOTE: NO DRY WELL SHALL EXCEED 15 FOOT IN DIAMETER. NO ABSORPTION TRENCH TO EXCEED 100 FEET IN LENGTH.

NOTE: ALL PIPE FROM HOUSE TO SEPTIC TANK MUST BE CAST IRON OR SCHEDULE 40 PVC OR ABS.

PERMIT VOID AFTER THREE YEARS.

NOTE: INSTALL STAND PIPE ON SEPTIC TANK AND DRY WELL. STAND PIPES MUST BE 6 INCHES IN DIAMETER. CAST IRON, CONCRETE OR TERRA COTTA, OR PVC OR ABS ACCEPTED. IF TOP OF SEPTIC TANK IS DEEPER THAN 3 FEET MANHOLE TO GRADE REQUIRED.

**\*INSTALLER IS RESPONSIBLE FOR OBTAINING FINAL APROVAL ON THIS PERMIT**

\*CALL 992-2330 FOR INSPECTION OF SEPTIC SYSTEMS.

EH - 2-1082

P 33401

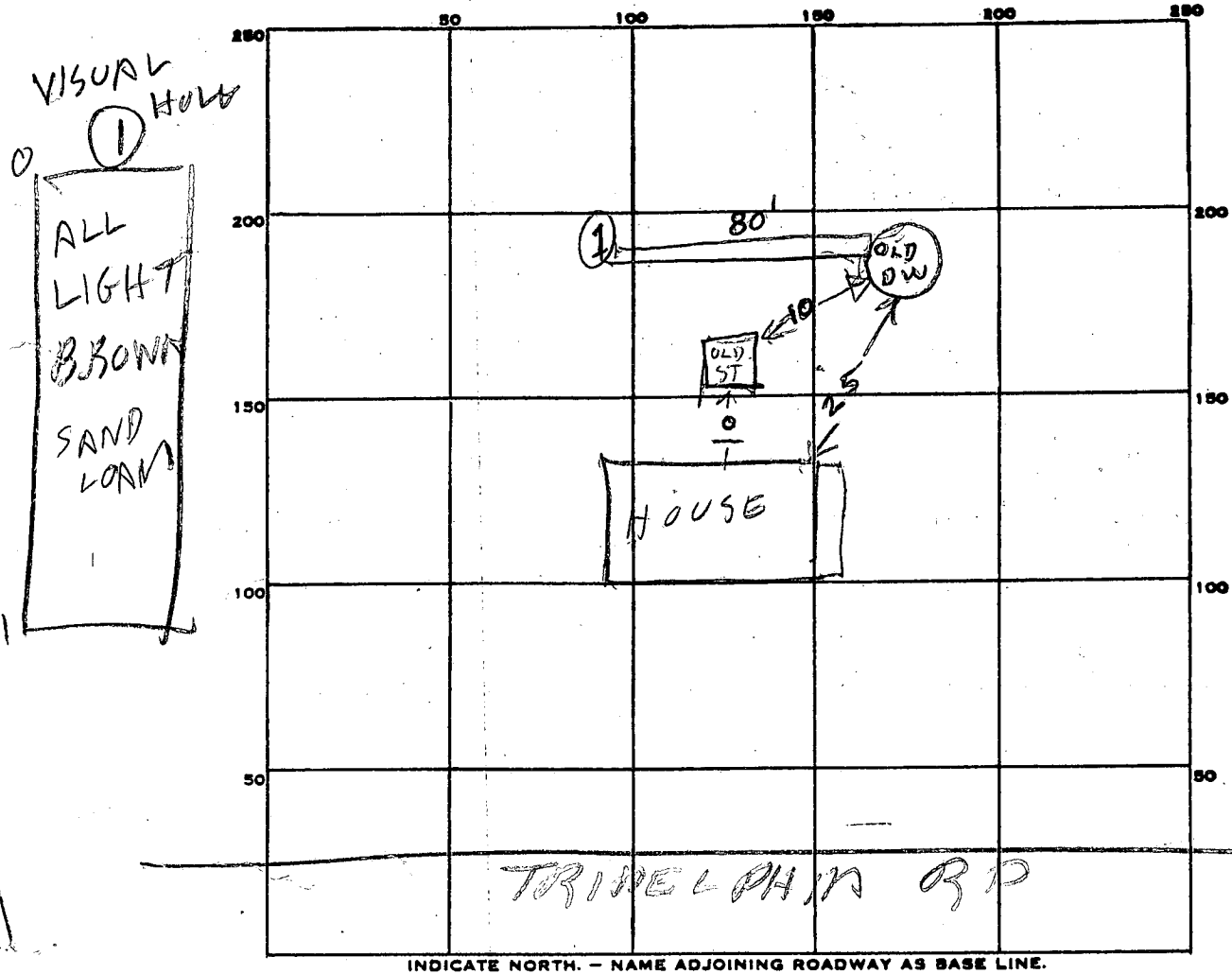

INDICATE NORTH. - NAME ADJOINING ROADWAY AS BASE LINE.

PERMIT CARD \_\_\_\_\_

SEPTIC TANK, LEVEL \_\_\_\_\_ CLEANOUTS \_\_\_\_\_

DISTRIBUTION BOX, LEVEL \_\_\_\_\_

TRENCH TILE FIELD, DEPTH 10 FT. TRENCH WIDTH 2 FT.

GRAVEL DEPTH 7 FT IN. TOTAL LENGTH 80 FT.

NUMBER OF TRENCHES 1 TOTAL BOTTOM AREA 560

SEEPAGE PITS, INSIDE DIAMETER \_\_\_\_\_ FT. DEPTH BELOW INLET \_\_\_\_\_ FT.

ABSORBENT AREA \_\_\_\_\_ SQ. FT.

REMARKS 12/19/83 VISUAL HOLE O.K. OWNER MEASURED  
DEPTH OF DITCH BEFORE STONE ADDED SEE  
ATTACHED NOTE RH

DATE SYSTEM APPROVED 12/19/83 INSPECTOR Raymond Hodge

AMES  
LEITH

P 33401

Cecilia S. Leith  
1201 Truadelphia Rd.  
Ellicott City, Md.

I verify that the septic  
trench dug by Fryock Co.  
is at least 10 ft deep.

Cecilia S. Leith

9/25/67  
Landy

# PERMIT

SEWAGE DISPOSAL SYSTEM

app  
9-35-67  
- *Landy*

P 12721  
A 10135

MARYLAND STATE DEPARTMENT OF HEALTH

HOWARD COUNTY

*Repair 83'*  
**INDEXED**

ELLICOTT CITY  
DISTRICT 3  
DATE 6/5/67

John F. Hornick, Inc. IS PERMITTED TO INSTALL  ALTER  
ADDRESS 14 Belleview Dr., Ellicott City, Md. PHONE 531-5661

A SEWAGE DISPOSAL SYSTEM LOCATED AT \_\_\_\_\_

SUBDIVISION Green Henge ROAD Triadelphia LOT 3  
PROPERTY OWNER Carwell, Inc.  
ADDRESS \_\_\_\_\_

SPECIFICATIONS - 3 bedrooms

DRAIN FIELD \_\_\_\_\_ DEPTH \_\_\_\_\_ FEET, BOTTOM AREA \_\_\_\_\_ SQ. FT.  
SEEPAGE PITS \_\_\_\_\_ ABSORBENT SIDE-WALL AREA \_\_\_\_\_ SQ. FT.  
SEPTIC TANK CAPACITY 750 GALLONS

FOR GARBAGE GRINDER, INCREASE DISPOSAL AREA 22% & TANK CAPACITY 80%.

OTHER Dry well - 300 sq. ft. absorbent sidewall area below the inlet pipe  
located 135 ft. from front lot line and 37 ft. from right side lot line as seen  
when facing lot from Triadelphia Rd.

MAXIMUM DEPTH PERMITTED 12' below original grade.

PERMIT VOID AFTER THREE YEARS.

PLANS APPROVED BY J. H. Kilmore DATE 3/9/66

FILL SEPTIC TANK AND DISTRIBUTION BOX WITH WATER BEFORE CALLING FOR AN INSPECTION. COVER NO WORK UNTIL INSPECTED AND APPROVED.

NEITHER THE HOWARD COUNTY COMMISSIONERS NOR THE HEALTH DEPARTMENT IS RESPONSIBLE FOR THE SUCCESSFUL OPERATION OF ANY SYSTEM.

## NOTIFY THE HEALTH DEPARTMENT 48 HOURS BEFORE EXCAVATIONS ARE TO BE BACK FILLED.

*L 10135*

A10135

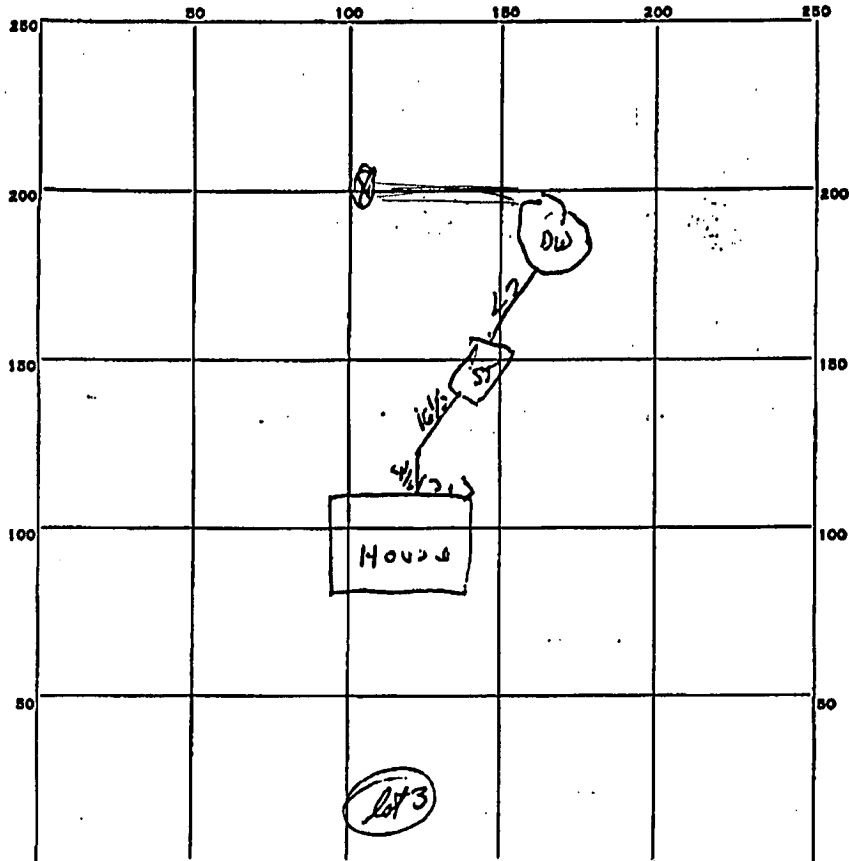

INDICATE NORTH. - NAME ADJOINING ROADWAY AS BASE LINE.

Madeline Rd

PERMIT CARD 014

SEPTIC TANK, LEVEL 012

CLEANOUTS 012

DISTRIBUTION BOX, LEVEL \_\_\_\_\_

TILE FIELD, DEPTH \_\_\_\_\_ FT. TRENCH WIDTH \_\_\_\_\_ FT.

GRAVEL DEPTH \_\_\_\_\_ IN. TOTAL LENGTH \_\_\_\_\_ FT.

NUMBER OF TRENCHES \_\_\_\_\_ TOTAL BOTTOM AREA \_\_\_\_\_

SEEPAGE PITS, <sup>outside</sup> INSIDE DIAMETER 12 FT. DEPTH BELOW INLET 10 FT.

ABSORBENT AREA 376 SQ. FT.

REMARKS 9/15/67 - well not drilled (could not locate)

6/65 test at D.W. 3 min at 7 & 8 1/2 ft.

A10135 2nd test @ 2 min at 8 1/2 ft, 7 min at 9 1/2 ft. JHK sandy soil

DATE SYSTEM APPROVED 9/25/67 INSPECTOR Dumoney