

4/19/84
12:10 noon
Trench

05-370767

approved 4/19/84
Stayed

PERMIT

P 33801

A Repair

SEWAGE DISPOSAL SYSTEM

MARYLAND STATE DEPARTMENT OF HEALTH

HOWARD COUNTY
BUREAU OF ENVIRONMENTAL HEALTH
992-2330

INDEX

ELLICOTT CITY

DISTRICT 5th

DATE 4/18/84

Olen Ketterman IS PERMITTED TO INSTALL _____ ALTER

ADDRESS 14960 Frederick Road, Woodbine, Md. 21797 PHONE 442-1336

SUBDIVISION Criswood Manor ROAD 5421 Trotter Road LOT _____

PROPERTY OWNER Charles M. Walter

ADDRESS 5421 Trotter Road, Clarksville, Md. 21029

IF GARBAGE GRINDER IS USED INCREASE SEPTIC TANK CAPACITY BY 50% AND ABSORPTION AREA BY 22%.

GARBAGE GRINDER? YES _____ NO _____

SEPTIC TANK CAPACITY _____ GALLONS NUMBER OF BEDROOMS _____

REPAIR - Call for inspection when ground is opened up and Sanitarian will
recommend the repair system.

PLANS APPROVED BY Frank A. Skinner DATE 4/18/84

COVER NO WORK UNTIL INSPECTED AND APPROVED.

NEITHER THE HOWARD COUNTY COUNCIL NOR THE HEALTH DEPARTMENT IS RESPONSIBLE FOR THE SUCCESSFUL OPERATION OF ANY SYSTEM.

NOTE: IF TRENCH IS USED CALL FOR INSPECTION BEFORE AND AFTER PLACING GRAVEL IN TRENCH.

NOTE: NO DRY WELL SHALL EXCEED 15 FOOT IN DIAMETER. NO ABSORPTION TRENCH TO EXCEED 100 FEET IN LENGTH.

NOTE: ALL PIPE FROM HOUSE TO SEPTIC TANK MUST BE CAST IRON OR SCHEDULE 40 PVC OR ABS.

PERMIT VOID AFTER THREE YEARS.

NOTE: INSTALL STAND PIPE ON SEPTIC TANK AND DRY WELL. STAND PIPES MUST BE 6 INCHES IN DIAMETER. CAST IRON, CONCRETE OR TERRA COTTA, OR PVC OR ABS ACCEPTED. IF TOP OF SEPTIC TANK IS DEEPER THAN 3 FEET MANHOLE TO GRADE REQUIRED.

***INSTALLER IS RESPONSIBLE FOR OBTAINING FINAL APPROVAL ON THIS PERMIT**

*CALL 992-2330 FOR INSPECTION OF SEPTIC SYSTEMS.

EH - 2-1082

33801

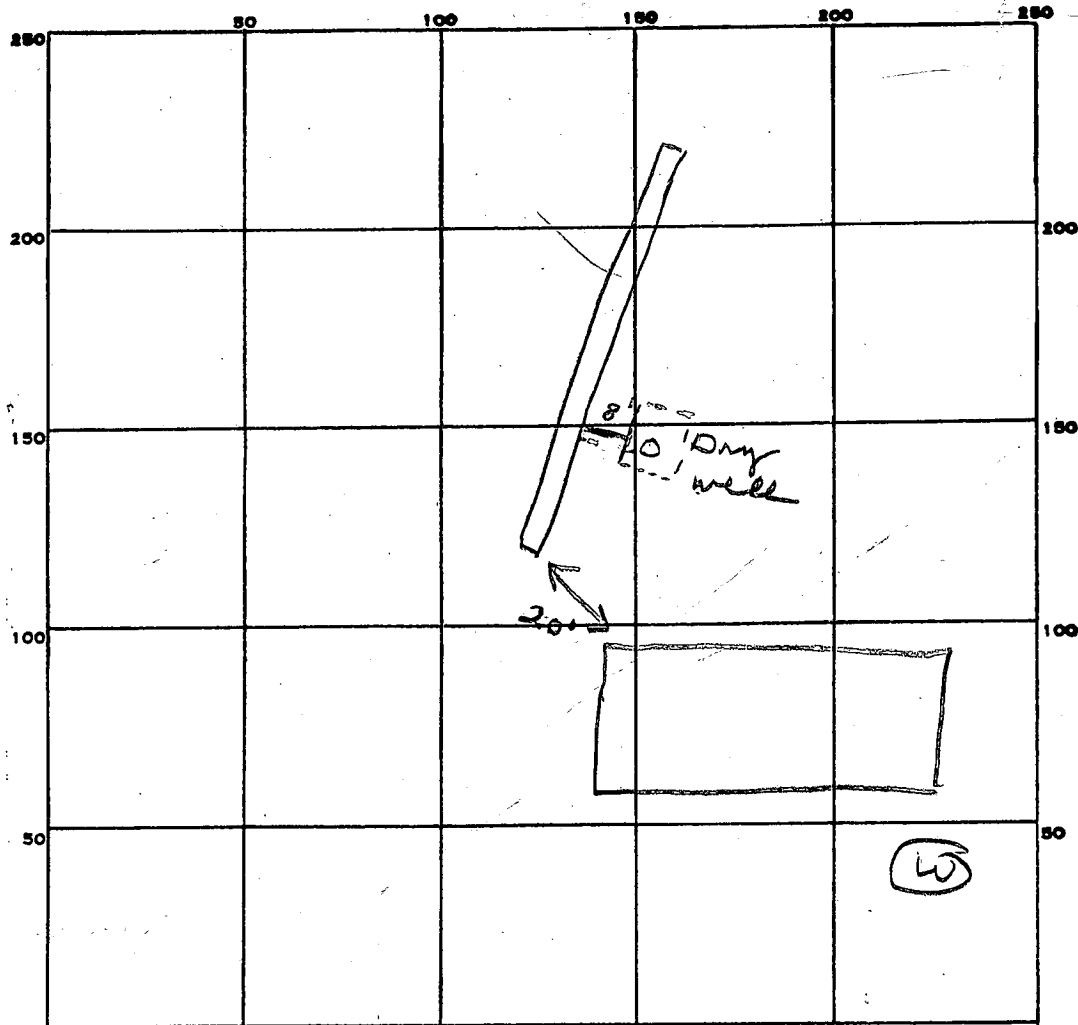

INDICATE NORTH. - NAME ADJOINING ROADWAY AS BASE LINE.

PERMIT CARD ✓ Trotter Rd

SEPTIC TANK, LEVEL _____ CLEANOUTS _____

DISTRIBUTION BOX, LEVEL _____

TILE FIELD, DEPTH 10 FT. TRENCH WIDTH 2 FT.

GRAVEL DEPTH 7 IN. TOTAL LENGTH 72 FT.

NUMBER OF TRENCHES 1 TOTAL BOTTOM AREA 504

SEEPAGE PITS, INSIDE DIAMETER _____ FT. DEPTH BELOW INLET _____ FT.

ABSORBENT AREA 504 SQ. FT.

REMARKS 4/19/84 OK to add stone in trench. jf

4/19/84 OK to cover all work. jf

DATE SYSTEM APPROVED 4/19/84 INSPECTOR Stayer