

7/6/82
Before noon

APPROVED
7/6/82
RHCW
32001

PERMIT

SEWAGE DISPOSAL SYSTEM

MARYLAND STATE DEPARTMENT OF HEALTH

HOWARD COUNTY

ELLICOTT CITY

INDEX

05-355796

DISTRICT 5th

DATE 6/29/82

A Repair

Jack Fyock

IS PERMITTED TO INSTALL ALTER X

ADDRESS 13775 Triadelphia Road, Glenelg, Md. 21737 PHONE 988-9270

SUBDIVISION Forest Hill ROAD 5858 Trotter Road LOT 9

PROPERTY OWNER Mr. Judd

ADDRESS 5858 Trotter Road, Clarksville, Md. 21029

SPECIFICATIONS

SEPTIC TANK CAPACITY _____ GALLONS

DRAIN FIELD _____ DEPTH _____ FEET, BOTTOM AREA _____ SQ. FT.

DEEP TRENCH _____ DEPTH _____ FEET, BOTTOM AREA _____ SQ. FT.

SEEPAGE PITS _____ ABSORBENT SIDE-WALL AREA _____ SQ. FT.

INLET PIPE _____ FT. BELOW ORIGINAL GRADE. MAXIMUM DEPTH _____ FT. BELOW ORIGINAL GRADE

EFFECTIVE DEPTH AT _____ FT. BELOW ORIGINAL GRADE.

LOCATE DISPOSAL AREA _____ FT. FROM _____ LOT LINE AND _____ FT. FROM _____ LOT LINE AS SEEN WHEN FACING LOT FROM

REPAIR - Call for an appointment when ground is opened up and Sanitarian will

recommend the repair system. USE EXISTING SEPTIC TANK & DRYWELL.

ADD SHALLOW DRAINFIELD. 60 FT LONG X 6 FT WIDE. 4 FT DEEP, PIPES AT 2 FT;

OVER 2 FT OF #2 STONE. PLACE DITCH 5 FT

PLANS APPROVED BY Palmer F. Wine DATE 6/29/82

COVER NO WORK UNTIL INSPECTED AND APPROVED.

OFF OLD DRY WELL

NEITHER THE HOWARD COUNTY COUNCIL NOR THE HEALTH DEPARTMENT IS RESPONSIBLE FOR THE SUCCESSFUL OPERATION OF ANY SYSTEM.

NOTE: IF TRENCH IS USED CALL FOR INSPECTION BEFORE PLACING GRAVEL IN TRENCH.

NOTE: NO DRY WELL SHALL EXCEED 15 FOOT IN DIAMETER.

NOTE: ALL PIPE FROM HOUSE TO DISPOSAL AREA MUST BE CAST IRON.

PERMIT VOID AFTER THREE YEARS.

NOTE: INSTALL STAND PIPE ON SEPTIC TANK AND DRY WELL. STAND PIPES MUST BE 6 INCHES IN DIAMETER. CAST IRON, CONCRETE OR TERRAZO ACCEPTED.

*INSTALLER IS RESPONSIBLE FOR OBTAINING FINAL APPROVAL ON THIS PERMIT.

XF 32001

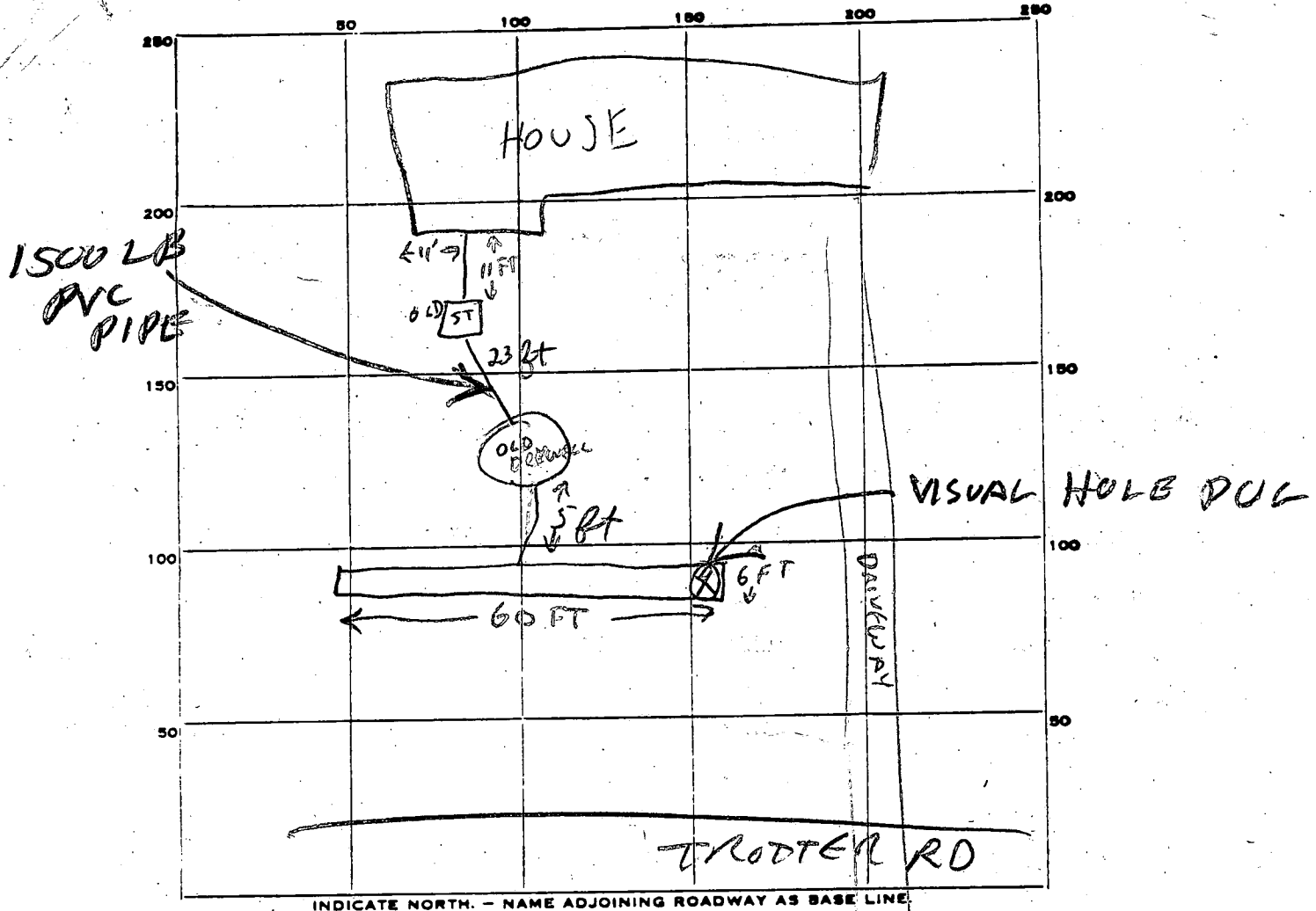

PERMIT CARD _____

SEPTIC TANK, LEVEL _____ CLEANOUTS ST & DW

DISTRIBUTION BOX, LEVEL _____

TILE FIELD, DEPTH 4 FT. TRENCH WIDTH 6 FT.

GRAVEL DEPTH 2 FT IN. TOTAL LENGTH 60 FT.

NUMBER OF TRENCHES 1 TOTAL BOTTOM AREA 360 FT²

SEEPAGE PITS, INSIDE DIAMETER _____ FT. DEPTH BELOW INLET _____ FT.

ABSORBENT AREA _____ SQ. FT.

REMARKS 7-6-82 CW & RH 11:15 AM

SOIL - ALL SAND, VISUAL TO 9'. ADD STONE & PIPE

TO DITCH

7-6-82 1:30 PM PIPE & STONE ADDED OK TO COVER ALL WORK RH & CW

DATE SYSTEM APPROVED 7-6-82 INSPECTOR CW & RH