

PERMIT

SEWAGE DISPOSAL SYSTEM

MARYLAND STATE DEPARTMENT OF HEALTH

HOWARD COUNTY

ELLICOTT CITY

DISTRICT 4th

DATE 5/11/81

INDEXED

Mr. Herman Sirk IS PERMITTED TO INSTALL ALTER X

ADDRESS 25555 Jennings Chapel Road PHONE 489-4724

SUBDIVISION ROAD 14584 Triadelphia Rd LOT

PROPERTY OWNER Mr. Thomas A. & Margaret A. Howell

ADDRESS 14584 Triadelphia Rd

SPECIFICATIONS 3 Bedrooms

SEPTIC TANK CAPACITY GALLONS

DRAIN FIELD DEPTH FEET, BOTTOM AREA SQ. FT.

DEEP TRENCH DEPTH FEET, BOTTOM AREA SQ. FT.

SEEPAGE PITS ABSORBENT SIDE-WALL AREA SQ. FT.

INLET PIPE FT. BELOW ORIGINAL GRADE, MAXIMUM DEPTH FT. BELOW ORIGINAL GRADE

EFFECTIVE DEPTH AT FT. BELOW ORIGINAL GRADE.

LOCATE DISPOSAL AREA FT. FROM LOT LINE AND FT. FROM LOT LINE AS SEEN WHEN

FACING LOT FROM

REPAIR - Call for an appointment when ground is opened up and Sanitarian will recommend the repair system.

Two (2) 40 ft trenches, max 11 ft deep, inlet 3 ft below orig. grade, with 8 ft of stone. Each trench to have 5 ft buffers.

PLANS APPROVED BY Palmer F. Wine DATE 5/11/81

COVER NO WORK UNTIL INSPECTED AND APPROVED.

NEITHER THE HOWARD COUNTY COUNCIL NOR THE HEALTH DEPARTMENT IS RESPONSIBLE FOR THE SUCCESSFUL OPERATION OF ANY SYSTEM.

NOTE: IF TRENCH IS USED CALL FOR INSPECTION BEFORE PLACING GRAVEL IN TRENCH.

NOTE: NO DRY WELL SHALL EXCEED 15 FOOT IN DIAMETER.

NOTE: ALL PIPE FROM HOUSE TO DISPOSAL AREA MUST BE CAST IRON.

PERMIT VOID AFTER THREE YEARS.

NOTE: INSTALL STAND PIPE ON SEPTIC TANK AND DRY WELL. STAND PIPES MUST BE 6 INCHES IN DIAMETER, CAST IRON, CONCRETE OR TERRA COTTA ACCEPTED.

***INSTALLER IS RESPONSIBLE FOR OBTAINING FINAL APPROVAL ON THIS PERMIT.**

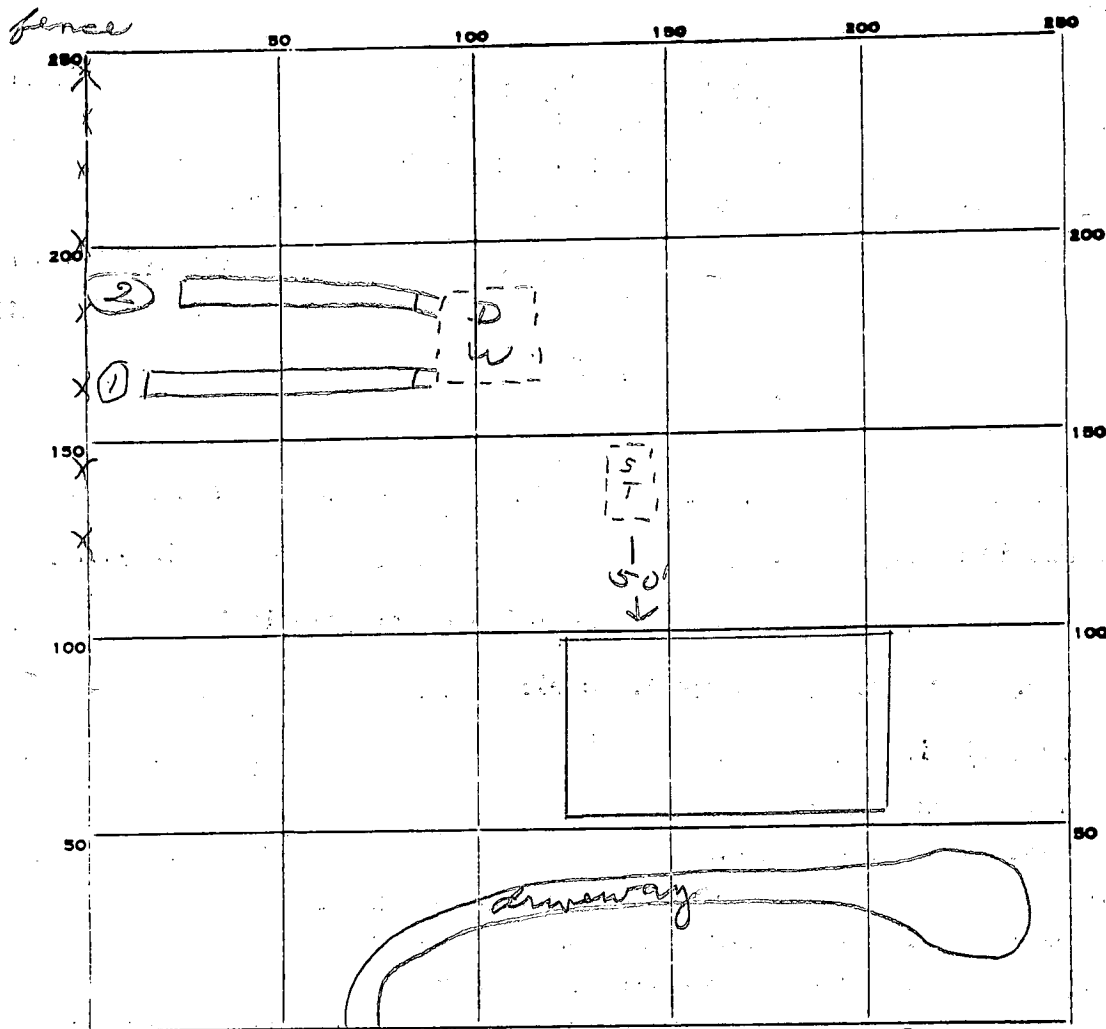

Philadelphia Rd.

PERMIT CARD ☒

SEPTIC TANK, LEVEL _____

CLEANOUTS _____

DISTRIBUTION BOX, LEVEL _____

TILE FIELD, DEPTH ⁽²⁾ 11 FT. TRENCH WIDTH ⁽²⁾ 2 FT.

GRAVEL DEPTH ⁽²⁾ 8 IN. TOTAL LENGTH ⁽²⁾ 40 ⁽¹⁾ 40 FT.

NUMBER OF TRENCHES ⁽²⁾ 2 TOTAL BOTTOM AREA ⁽²⁾ 640

SEEPAGE PITS, INSIDE DIAMETER _____ FT. DEPTH BELOW INLET _____ FT.

ABSORBENT AREA ⁽²⁾ 640 SQ. FT.

REMARKS *5/12/81 OK to add gravel in No#1 trench. j2*
5/14/81 OK to cover all work

DATE SYSTEM APPROVED *5/14/81* INSPECTOR *Stayer*